

# FRONT WIPER MOTOR

## INSPECTION

### 1. INSPECT FRONT WIPER MOTOR

#### (a) Check the LO operation.

- (1) Connect the battery's positive (+) lead to terminal 5 (+1) and the negative (-) lead to terminal 4 (E), and check that the front wiper motor operates at low speed (LO).

**OK:**

**Front wiper motor operates at low speed (LO).**

If the result is not as specified, replace the motor.

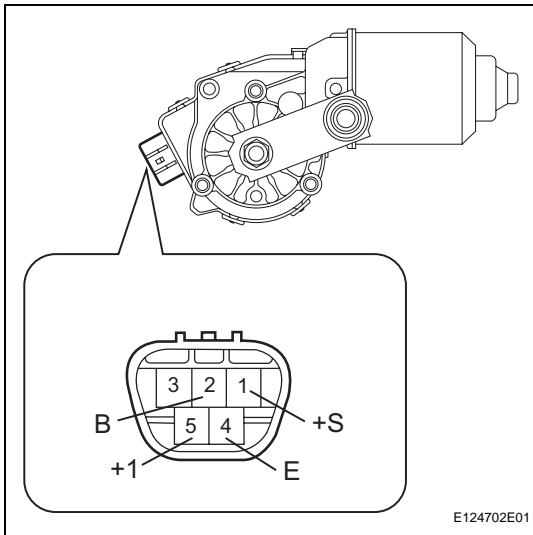

#### (b) Check the HI operation.

- (1) Connect the battery's positive (+) lead to terminal 3 (+2) and the negative battery (-) lead to terminal 4 (E), and check that the front wiper motor operates at high speed (HI).

**OK:**

**Front wiper motor operates at high speed (HI).**

If the result is not as specified, replace the motor.

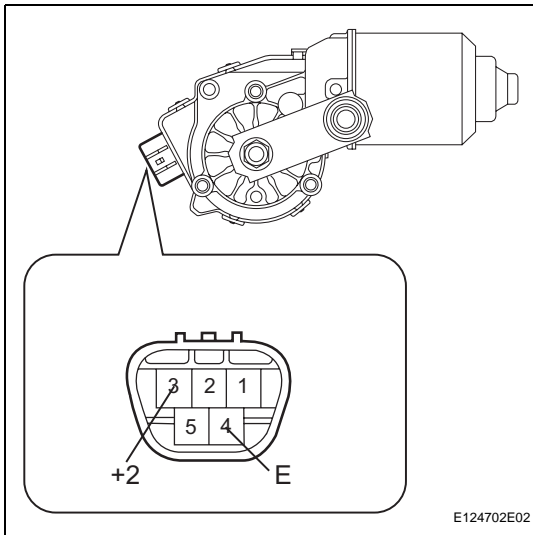

#### (c) Check the automatic stop operation.

- (1) Connect the battery's positive (+) lead to terminal 5 (+1) and the negative (-) lead to terminal 4 (E). With the motor rotating at low speed (LO), disconnect the lead from terminal 5 (+1) to stop the wiper motor operation at any position other than the automatic stop position.
- (2) Using SST, connect the terminals 1 (+S) and 5 (+1). Then connect the battery's positive (+) lead to terminal 2 (B) to restart the motor operation at low speed (LO).

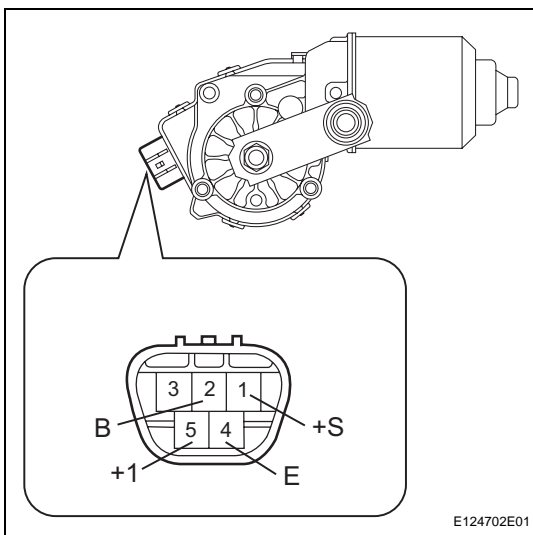

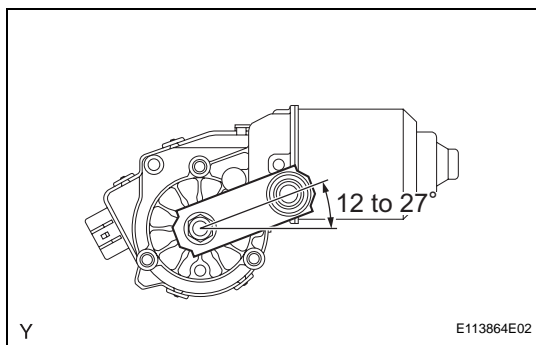

- (3) Check that the motor stops automatically at the automatic stop position.

**OK:**

**Refer to the illumination.**

If the result is not as specified, replace the motor.