

## REMOVAL

1. **DISCONNECT CABLE FROM NEGATIVE BATTERY TERMINAL**

**CAUTION:**

Wait at least 90 seconds after disconnecting the cable from the negative (-) battery terminal to prevent airbag and seat belt pretensioner activation.

2. **REMOVE FRONT WIPER ARM HEAD CAP**

(a) Remove the 2 caps.

3. **REMOVE FRONT WIPER ARM AND BLADE ASSEMBLY LH**

(a) Remove the nut and arm and blade.

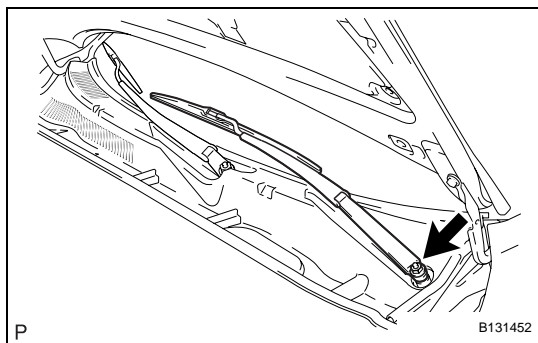

4. **REMOVE FRONT WIPER ARM AND BLADE ASSEMBLY RH**

(a) Remove the nut and arm and blade.

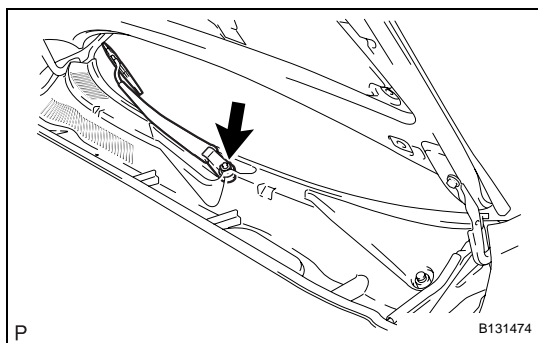

5. **REMOVE FRONT FENDER TO COWL SIDE SEAL LH**

(a) Detach the claw and remove the front fender to cowl side seal.

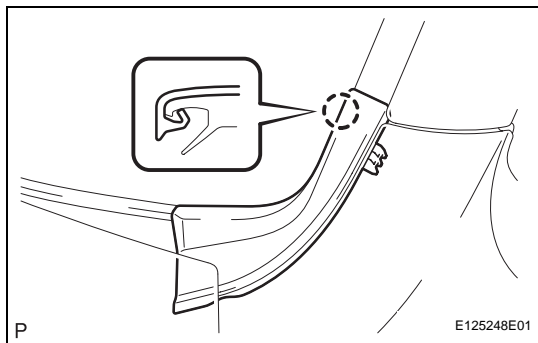

6. **REMOVE FRONT FENDER TO COWL SIDE SEAL RH**

(a) Detach the claw and remove the front fender to cowl side seal.

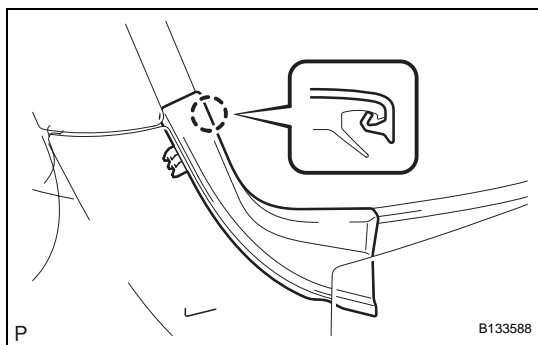

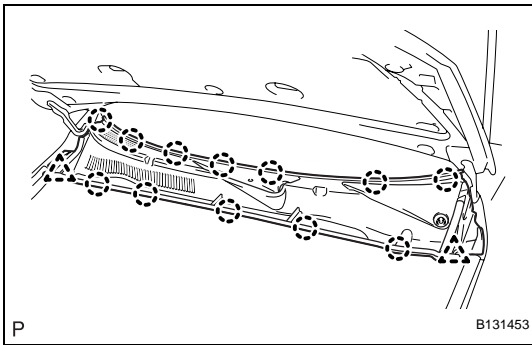
**7. REMOVE COWL TOP VENTILATOR LOUVER**

- (a) Remove the 2 clips.
- (b) Detach the 12 claws and remove the louver.

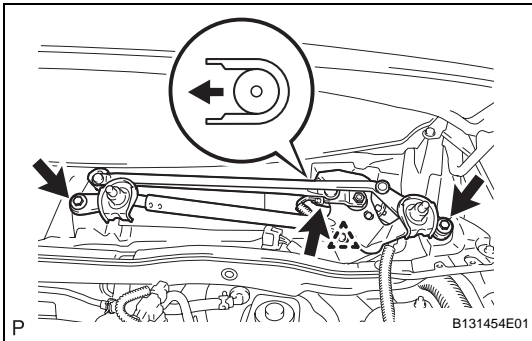
**8. REMOVE WINDSHIELD WIPER MOTOR AND LINK ASSEMBLY**

- (a) Remove the 2 bolts.
- (b) Move the wiper cushion in the direction shown by the arrow in the illustration to detach the wiper cushion from the body, and remove the wiper motor and link.
- (c) Disconnect the connector and detach the clamp.

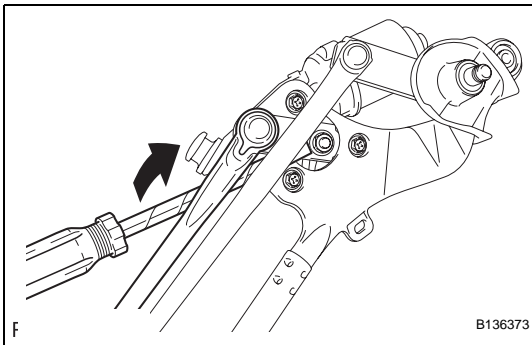
**9. REMOVE WINDSHIELD WIPER MOTOR ASSEMBLY**

- (a) Using a screwdriver, disconnect the rod of the wiper link from the wiper motor as shown in the illustration.

**HINT:**

Tape the screwdriver tip before use.

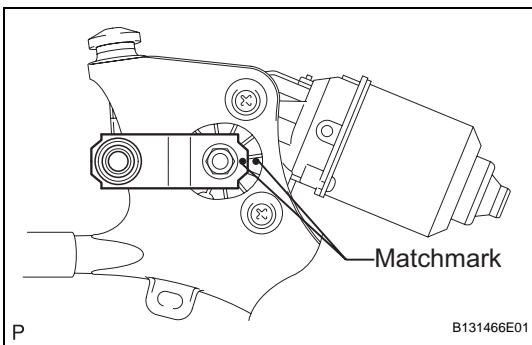

- (b) Put matchmarks on the crank arm and motor, as shown in the illustration.

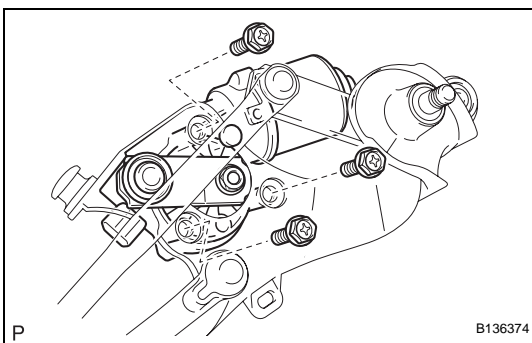

- (c) Remove the 3 bolts and wiper motor.