

FRONT LOWER BALL JOINT

COMPONENTS

SP

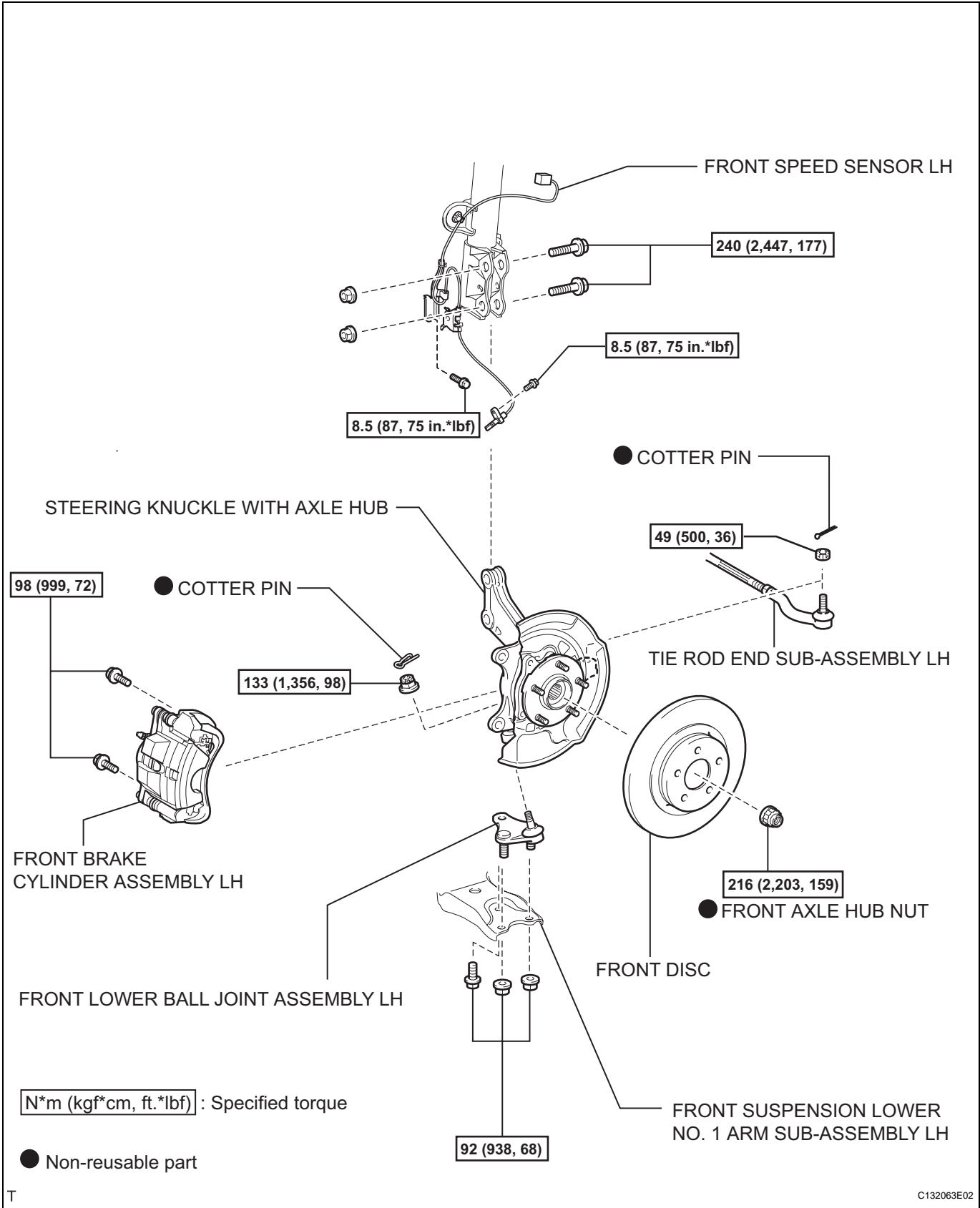

REMOVAL

HINT:

- Use the same procedures for the RH side and LH side.
- The procedures listed below are for the LH side.

1. REMOVE FRONT WHEEL
2. REMOVE FRONT SPEED SENSOR LH (for 2WD) (See page [BC-191](#))
3. REMOVE FRONT BRAKE CYLINDER ASSEMBLY LH (See page [BR-40](#))
4. REMOVE FRONT DISC (See page [BR-42](#))
5. REMOVE FRONT AXLE HUB NUT (See page [AH-6](#))
6. DISCONNECT FRONT SUSPENSION LOWER NO. 1 ARM SUB-ASSEMBLY LH (See page [AH-7](#))
7. DISCONNECT TIE ROD END SUB-ASSEMBLY LH (See page [PS-42](#))
8. REMOVE STEERING KNUCKLE WITH AXLE HUB (See page [AH-7](#))
9. REMOVE FRONT LOWER BALL JOINT ASSEMBLY LH
 - (a) Remove the cotter pin and nut.
 - (b) Using SST, remove the lower ball joint.
SST 09628-62011

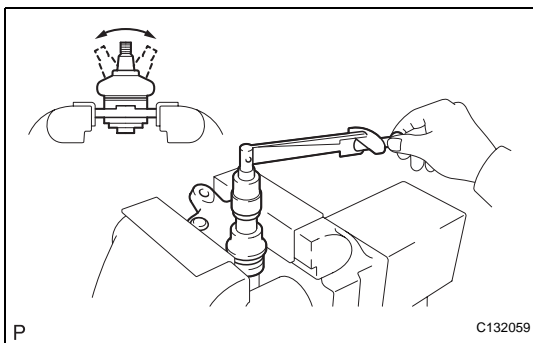
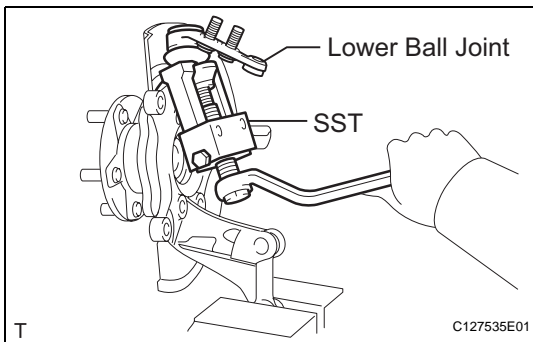

INSPECTION

1. INSPECT FRONT LOWER BALL JOINT ASSEMBLY LH
 - (a) As shown in the illustration, move the ball joint stud back and forth 5 times before installing the nut.
 - (b) Using a torque wrench, turn the nut continuously at a rate of 3 to 5 seconds per turn and take the torque reading on the fifth turn.
Standard turning torque:
0.98 to 3.43 N*m (10 to 35 kgf*cm, 9 to 30 in.*lbf) or less
 - (c) Check for any cracks and grease leaks on the ball joint dust cover.