

CENTER AIRBAG SENSOR ASSEMBLY

COMPONENTS

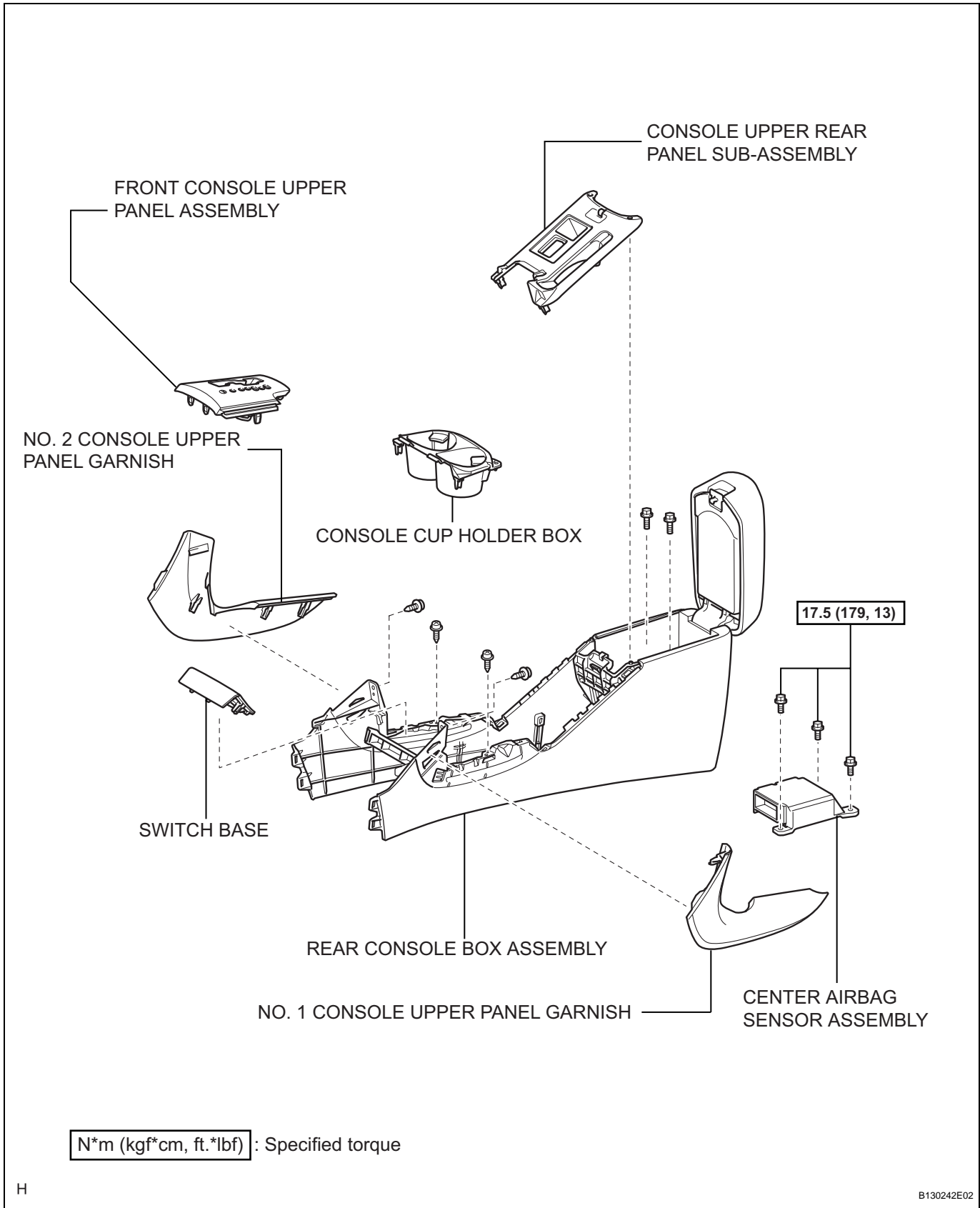

17.5 (179, 13)
N*m (kgf*cm, ft.*lbf) : Specified torque

RS

ON-VEHICLE INSPECTION

1. **CHECK CENTER AIRBAG SENSOR ASSEMBLY
(VEHICLE NOT INVOLVED IN COLLISION AND
AIRBAG NOT DEPLOYED)**
 - (a) Perform a diagnostic system check (see page [RS-49](#)).
2. **CHECK CENTER AIRBAG SENSOR ASSEMBLY
(VEHICLE INVOLVED IN COLLISION AND AIRBAG
NOT DEPLOYED)**
 - (a) Perform a diagnostic system check (see page [RS-49](#)).
3. **CHECK CENTER AIRBAG SENSOR ASSEMBLY
(VEHICLE INVOLVED IN COLLISION AND AIRBAG
DEPLOYED)**
 - (a) Replace the center airbag sensor.
CAUTION:
For removal and installation of the center airbag sensor, be sure to follow the correct procedures.