

## INSPECTION

1. **CHECK TORQUE SENSOR**
  - (a) Check the torque sensor (see page [PS-19](#)).
2. **CHECK POWER STEERING MOTOR**
  - (a) Check the power steering motor (see page [PS-22](#)).
3. **CHECK MOTOR ROTATION ANGLE SENSOR**
  - (a) Check the motor rotation angle sensor (see page [PS-25](#)).

## REASSEMBLY

### 1. INSTALL IGNITION OR STARTER SWITCH ASSEMBLY

- (a) Attach the 2 claws to install the ignition switch onto the steering column bracket upper.

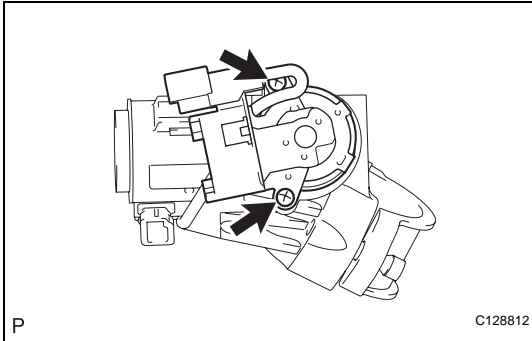

### 2. INSTALL KEY INTERLOCK SOLENOID

- (a) for Automatic Transaxle:
  - (1) Install the key interlock solenoid onto the steering column bracket upper with the 2 screws.

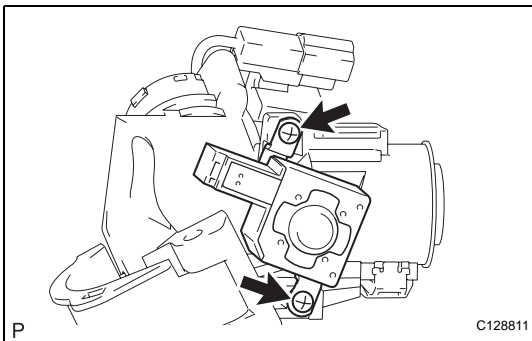

### 3. INSTALL UNLOCK WARNING SWITCH ASSEMBLY

- (a) Attach the 2 claws to install the unlock warning switch onto the steering column bracket upper.  
 HINT:  
 Slide the unlock warning switch in the direction shown by the arrow in the illustration to install it.

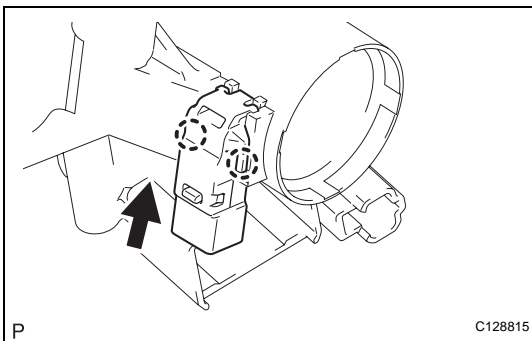

### 4. INSTALL IGNITION SWITCH LOCK CYLINDER ASSEMBLY

- (a) Turn the ignition switch to ON (ACC).
- (b) Install the ignition switch lock cylinder into the steering column bracket upper.
- (c) Make sure that the ignition switch lock cylinder is securely fixed onto the ignition switch lock cylinder.

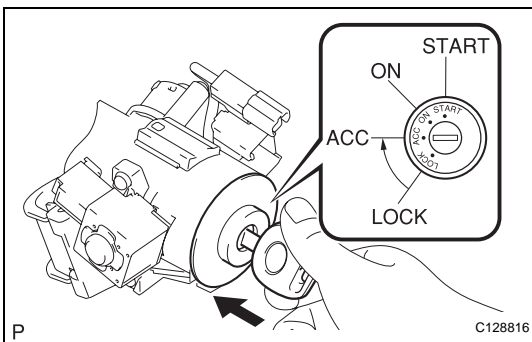

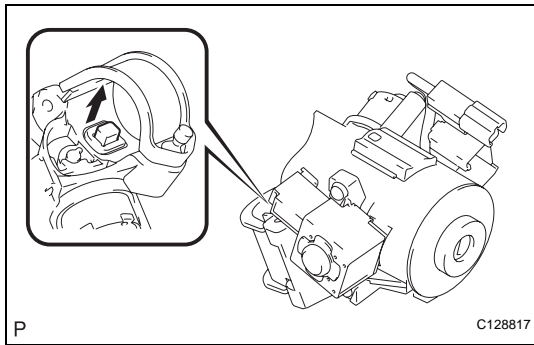

## 5. INSPECT STEERING LOCK OPERATION

- (a) Remove the key and check that the steering lock function is activated.

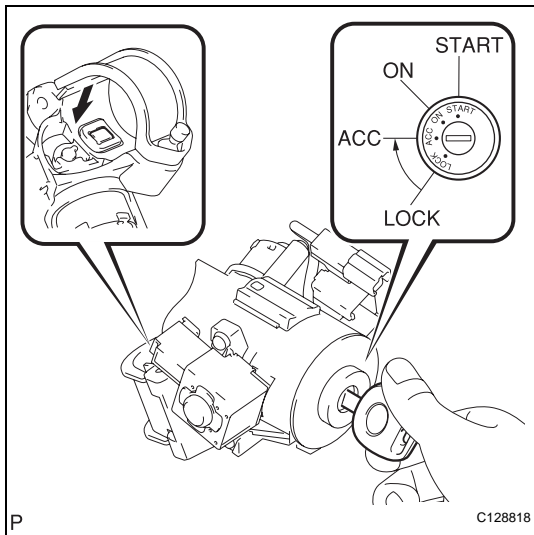

- (b) Insert the key, turn the ignition switch ON (ACC) and check that the steering lock function is deactivated.

## 6. INSTALL STEERING COLUMN UPPER W/ SWITCH BRACKET ASSEMBLY

- (a) Fix the steering column assembly in a vise between aluminum plates.

**NOTICE:**

**Do not overtighten the vise.**

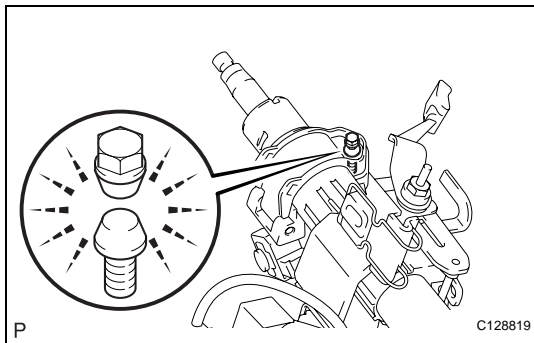

- (b) Install the steering column upper with switch bracket and steering column clamp upper with new steering lock set bolt, and then tighten the bolts until their heads come off.

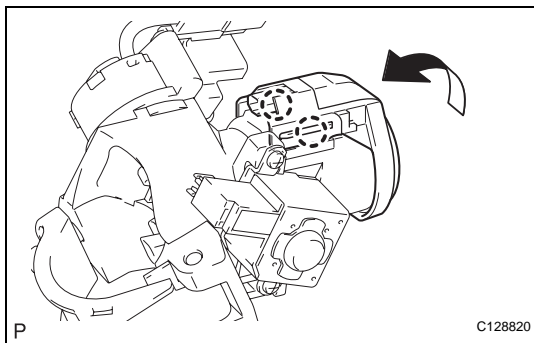

## 7. INSTALL TRANSPONDER KEY AMPLIFIER

- (a) Attach the 2 claws and install the transponder key amplifier onto the steering column upper with the switch bracket.