

## DISASSEMBLY

### 1. REMOVE TRANSPONDER KEY AMPLIFIER

- (a) Detach the 2 claws and slide the transponder key amplifier in the direction shown in the illustration, to detach it from the steering column upper with switch bracket.

### 2. REMOVE STEERING COLUMN UPPER WITH SWITCH BRACKET ASSEMBLY

- (a) Fix the steering post in a vise between aluminum plates.

**NOTICE:**

**Do not overtighten the vise.**

- (b) Using a drill, drill a hole in each of the steering lock set bolt to insert a screw extractor.
- (c) Using a screw extractor, remove the steering lock set bolt and remove the steering column upper with switch bracket and steering column clamp upper.

### 3. REMOVE IGNITION SWITCH LOCK CYLINDER ASSEMBLY

- (a) Turn the ignition switch to ON (ACC).

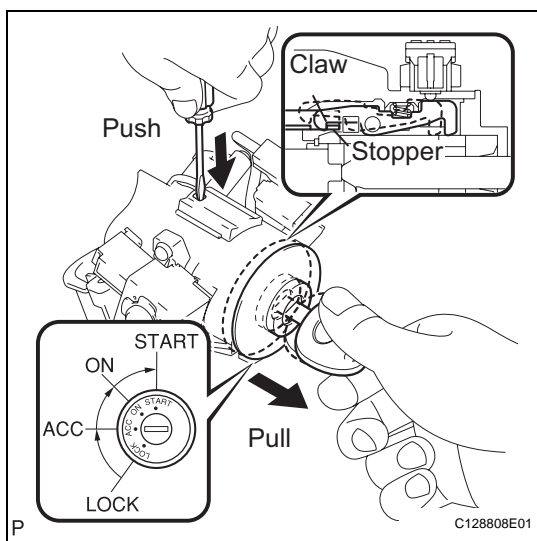
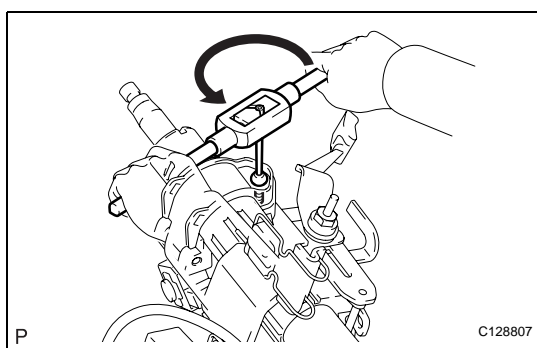

- (b) Insert the tip of a screwdriver into the hole in the steering column bracket upper, as shown in the illustration, and pull the ignition switch lock cylinder out until its claw comes into contact with the stopper of the steering column bracket upper.

**NOTICE:**

**Pull the ignition switch lock cylinder assembly out until its claw comes into contact with the stopper of the steering column bracket assembly upper. Otherwise, the following procedure cannot be conducted properly.**

**SR**

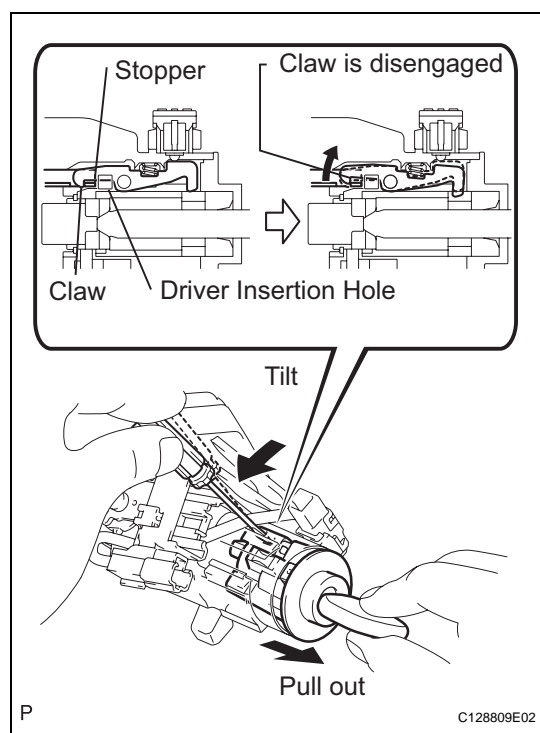

- (c) Insert the tip of a screwdriver into the hole in the steering column bracket and tilt it downward, as shown in the illustration, to disengage the claw of the ignition switch lock cylinder. Then pull out the ignition switch lock cylinder.

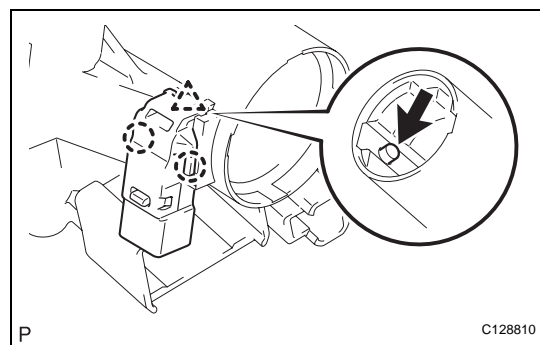

#### 4. REMOVE UNLOCK WARNING SWITCH ASSEMBLY

- (a) Push up the unlock warning switch center portion to disengage the 2 claws.

HINT:

Slide the unlock warning switch in the direction shown by the arrow in the illustration to remove it.

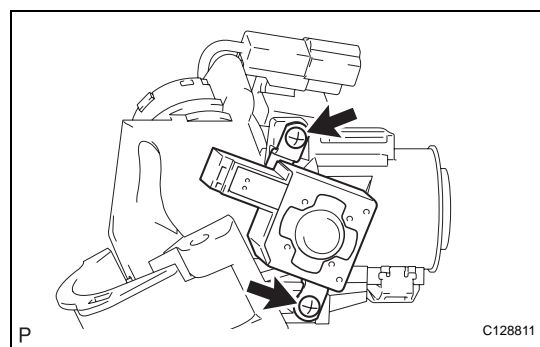

#### 5. REMOVE KEY INTERLOCK SOLENOID

- (a) for Automatic Transaxle:
- (1) Remove the 2 screws and remove the key interlock solenoid from the steering column bracket upper.

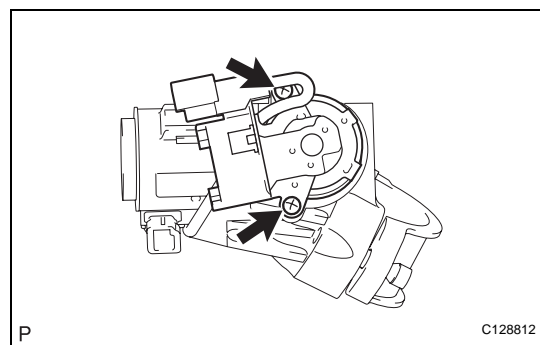

#### 6. REMOVE IGNITION OR STARTER SWITCH ASSEMBLY

- (a) Detach the 2 claws and remove the ignition (starter) switch from the steering column bracket upper.