

REMOVAL

HINT:

- Use the same procedures for the RH side and LH side.
- The procedures listed below are for the LH side.

1. DISCONNECT CABLE FROM NEGATIVE BATTERY TERMINAL

CAUTION:

Wait at least 90 seconds after disconnecting the cable from the negative (-) battery terminal to prevent airbag and seat belt pretensioner activation.

2. REMOVE REAR DOOR SCUFF PLATE LH (See page [IR-26](#))
3. REMOVE REAR DOOR OPENING TRIM WEATHERSTRIP LH
4. REMOVE PACKAGE TRAY TRIM POCKET SUB-ASSEMBLY (w/o Rear No. 2 Seat)
5. REMOVE TONNEAU COVER ASSEMBLY (w/o Rear No. 2 Seat)
6. REMOVE REAR FLOOR NO. 1 BOARD (w/o Rear No. 2 Seat)
7. REMOVE DECK BOARD ASSEMBLY (w/o Rear No. 2 Seat)
8. REMOVE NO. 2 SEAT HINGE COVER LH (w/ Rear No. 2 Seat) (See page [SE-109](#))
9. REMOVE NO. 2 SEAT HINGE COVER RH (w/ Rear No. 2 Seat) (See page [IR-30](#))
10. REMOVE NO. 2 SEAT LEG COVER LH (w/ Rear No. 2 Seat) (See page [SE-109](#))
11. REMOVE NO. 2 SEAT LEG COVER RH (w/ Rear No. 2 Seat) (See page [IR-30](#))
12. REMOVE REAR NO. 2 SEAT ASSEMBLY LH (w/ Rear No. 2 Seat) (See page [SE-110](#))
13. REMOVE REAR NO. 2 SEAT ASSEMBLY RH (w/ Rear No. 2 Seat) (See page [SE-110](#))
14. REMOVE REAR FLOOR NO. 2 BOARD
15. REMOVE REAR FLOOR NO. 3 BOARD
16. REMOVE REAR NO. 1 FLOOR MAT SUPPORT SIDE PLATE (See page [IR-31](#))
17. REMOVE BACK DOOR WEATHERSTRIP
18. REMOVE REAR FLOOR FINISH PLATE (See page [IR-31](#))
19. REMOVE REAR DECK TRIM COVER (w/ Rear No. 2 Seat)
20. REMOVE RECLINING REMOTE CONTROL LEVER BEZEL LH (w/o Rear No. 2 Seat)

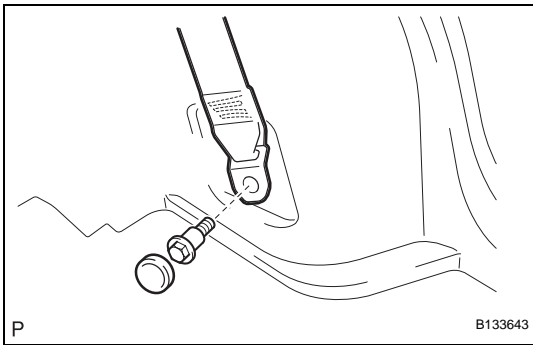

21. DISCONNECT REAR NO. 1 SEAT OUTER BELT ASSEMBLY RH

- (a) Remove the lap belt outer anchor cover.
- (b) Remove the bolt and disconnect the floor anchor.

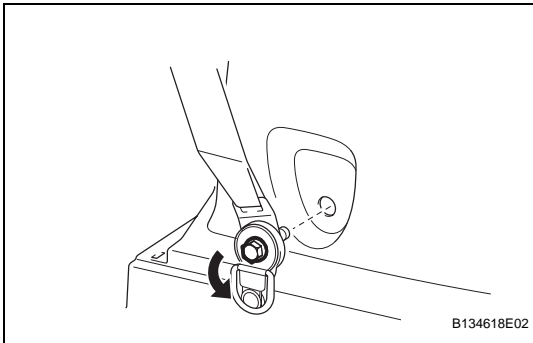

22. DISCONNECT REAR NO. 2 SEAT OUTER BELT ASSEMBLY LH (w/ Rear No. 2 Seat)

- (a) Open the cover.
- (b) Remove the bolt and disconnect the floor anchor.

23. REMOVE DECK TRIM SIDE PANEL ASSEMBLY LH (w/o Rear No. 2 Seat) (See page IR-32)

24. REMOVE DECK TRIM SIDE PANEL ASSEMBLY LH (w/ Rear No. 2 Seat) (See page IR-32)

25. REMOVE INNER ROOF SIDE GARNISH ASSEMBLY LH (w/o Rear No. 2 Seat) (See page IR-34)

26. REMOVE REAR NO. 2 SEAT OUTER BELT ASSEMBLY LH (w/ Rear No. 2 Seat)

- (a) Using a screwdriver, detach the 2 claws and open the seat belt anchor cover as shown in the illustration.

HINT:

Tape the screwdriver tip before use.

- (b) Remove the bolt and disconnect the seat belt's shoulder anchor.

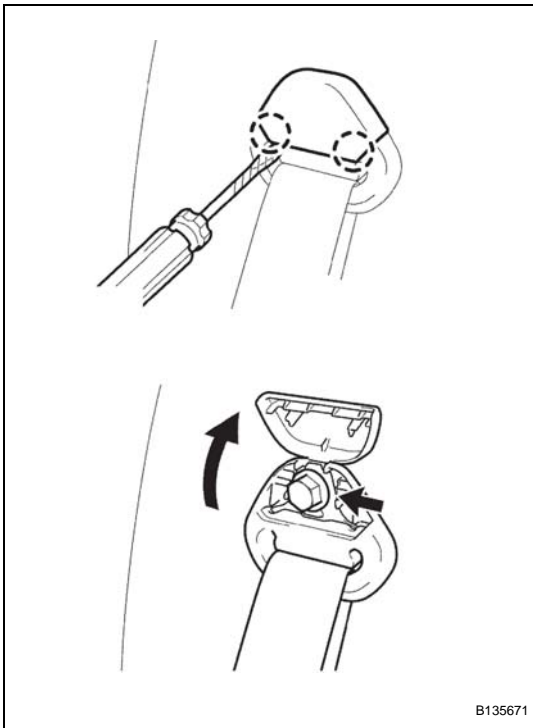

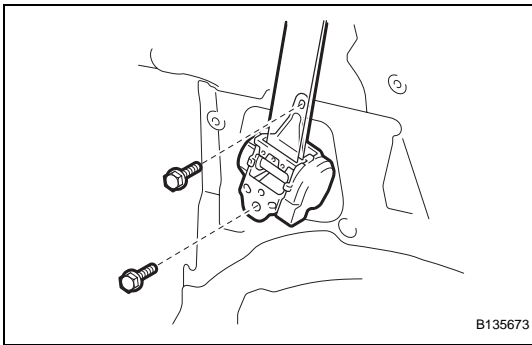

(c) Remove the 2 bolts and seat belt.

27. REMOVE INNER ROOF SIDE GARNISH ASSEMBLY LH (w/ Rear No. 2 Seat) (See page IR-35)

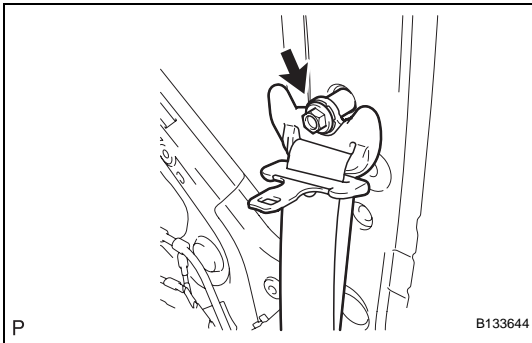

28. REMOVE REAR NO. 1 SEAT OUTER BELT ASSEMBLY LH

(a) Remove the bolt and disconnect the seat belt's shoulder anchor.

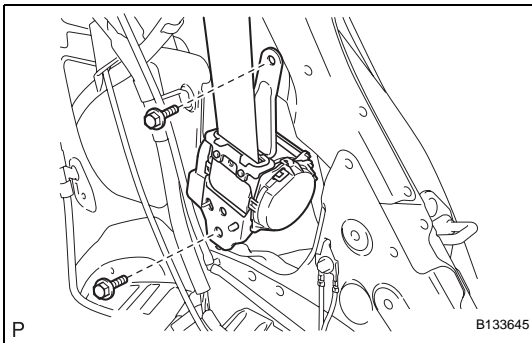

(b) Remove the 2 bolts and seat belt.

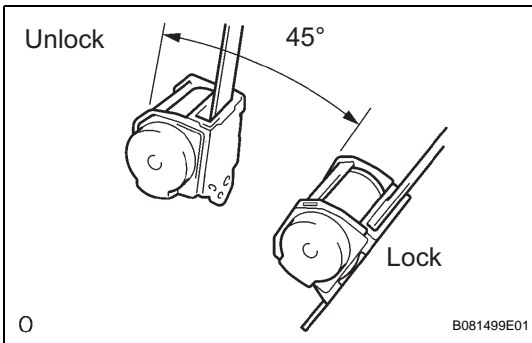

INSPECTION

1. INSPECT REAR NO. 1 SEAT BELT ASSEMBLY OUTER

NOTICE:

Do not disassemble the retractor.

- (a) When the inclination of the retractor is 15° or less, check that the belt can be pulled from the retractor. When the inclination of the retractor is over 45°, check that the belt locks. If the operation is not as specified, replace the belt.

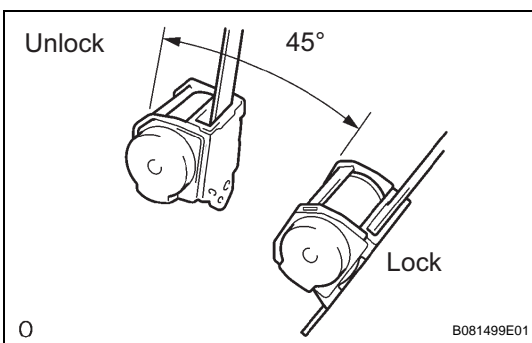

2. INSPECT REAR NO. 2 SEAT BELT ASSEMBLY OUTER

NOTICE:

Do not disassemble the retractor.

- (a) When the inclination of the retractor is 15° or less, check that the belt can be pulled from the retractor. When the inclination of the retractor is over 45°, check that the belt locks. If the operation is not as specified, replace the belt.