

PARKING BRAKE LEVER

COMPONENTS

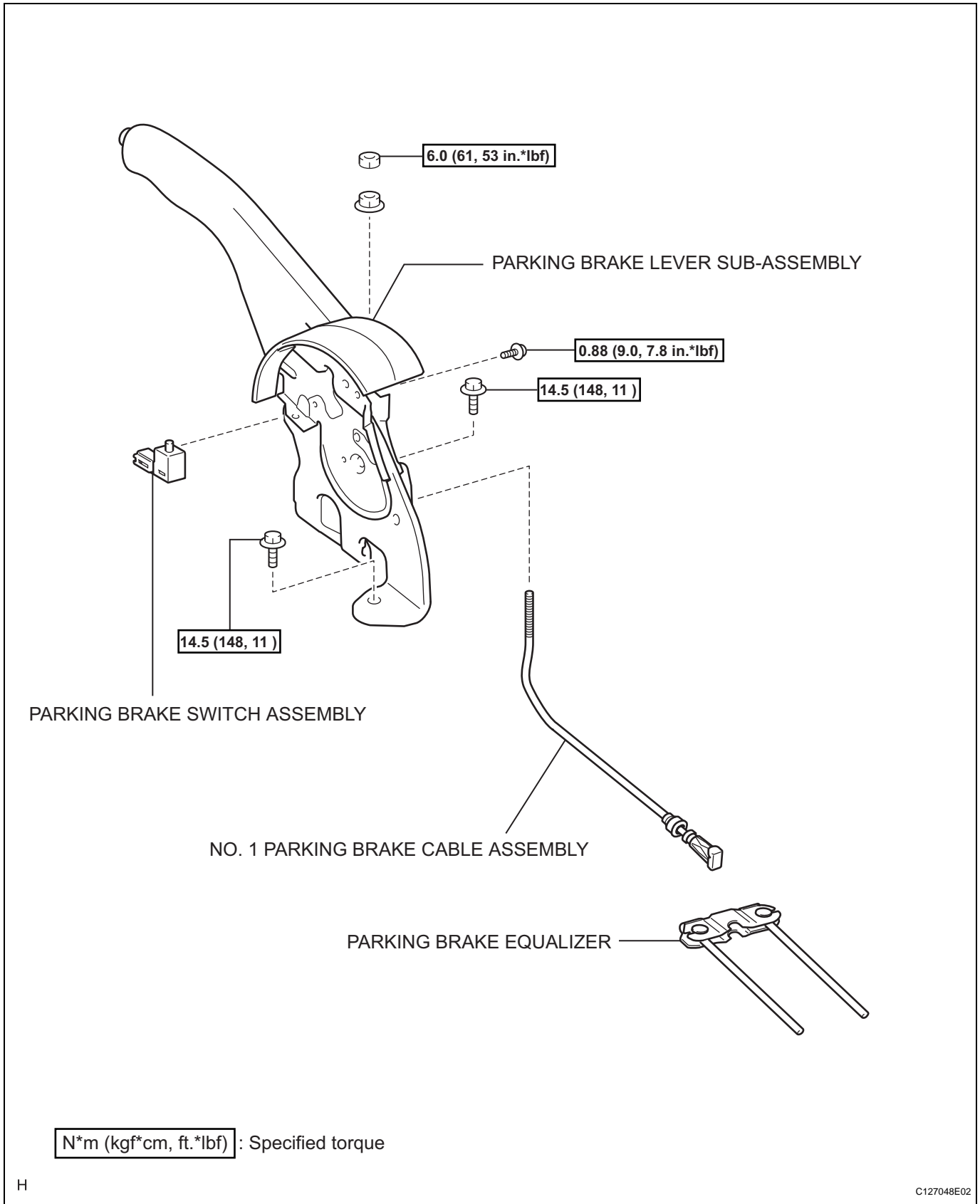

PB

ON-VEHICLE INSPECTION

1. CHECK PARKING BRAKE SWITCH ASSEMBLY

- (a) Remove the rear console box (see page [IP-16](#)).

HINT:

Refer to the procedures from the removal of the No. 1 console upper panel garnish up until the removal of the rear console box sub-assembly.

- (b) Disconnect the parking brake switch connector.

- (c) Measure the resistance of the switch.

Standard resistance

Tester Connection	Condition	Specified Condition
1 - Body ground	Parking brake switch ON (Switch pin released)	Below 1 Ω
1 - Body ground	Parking brake switch OFF (Switch pin pushed in)	10 k Ω or higher

If the result is not as specified, replace the switch assembly.

