

MI

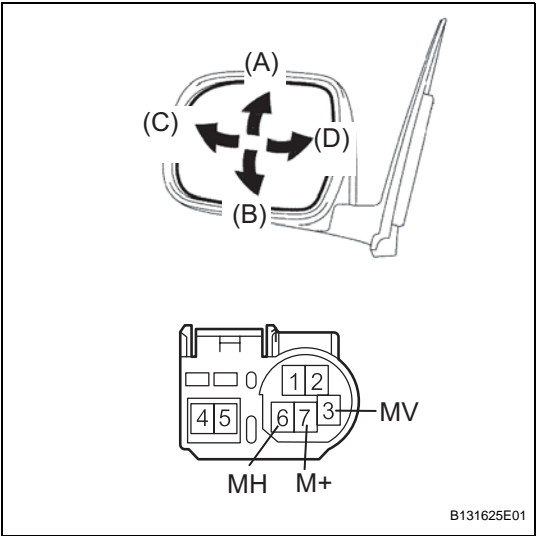

INSPECTION

1. INSPECT OUTER REAR VIEW MIRROR ASSEMBLY LH

- (a) Disconnect the mirror connector.
- (b) Apply battery voltage and check the operation of the mirror.

OK

Measurement Condition	Specified Condition
Battery positive (+) → Terminal 3 (MV) Battery negative (-) → Terminal 7 (M+)	Turns upward (A)
Battery positive (+) → Terminal 7 (M+) Battery negative (-) → Terminal 3 (MV)	Turns downward (B)
Battery positive (+) → Terminal 6 (MH) Battery negative (-) → Terminal 7 (M+)	Turns left (C)
Battery positive (+) → Terminal 7 (M+) Battery negative (-) → Terminal 6 (MH)	Turns right (D)

If the result is not as specified, replace the mirror assembly.

- (c) w/ Mirror Heater:
Check the resistance.
- (1) Measure the resistance between the terminals.

Standard resistance

Tester connection	Condition	Specified Condition
4 (H-) - 5 (H+)	65°C (149°F)	4 to 12 Ω

If the result is not as specified, replace the outer rear view mirror.

- (2) Connect the cable from the negative battery (-) terminal to terminal 5 and the positive battery (+) terminal to terminal 4, then check that the mirror becomes warm.

OK:

Mirror becomes warm.

HINT:

It takes a short time for the mirror to become warm.

If the result is not as specified, replace the outer rear view mirror.

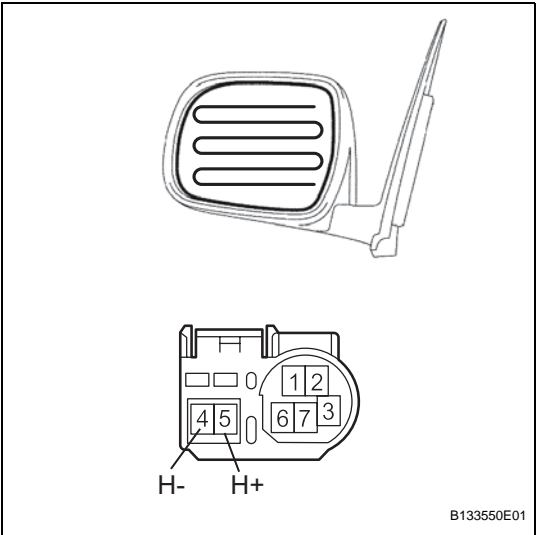

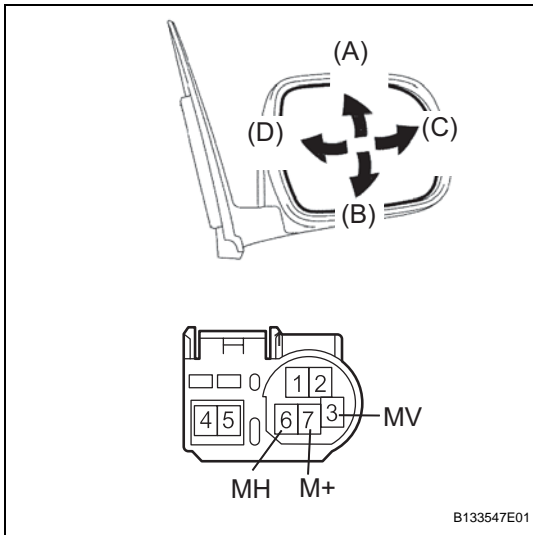

2. INSPECT OUTER REAR VIEW MIRROR ASSEMBLY RH

- Disconnect the mirror connector.
- Apply battery voltage and check the operation of the mirror.

OK

Measurement Condition	Specified Condition
Battery positive (+) → Terminal 3 (MV) Battery negative (-) → Terminal 7 (M+)	Turns upward (A)
Battery positive (+) → Terminal 7 (M+) Battery negative (-) → Terminal 3 (MV)	Turns downward (B)
Battery positive (+) → Terminal 6 (MH) Battery negative (-) → Terminal 7 (M+)	Turns left (D)
Battery positive (+) → Terminal 7 (M+) Battery negative (-) → Terminal 6 (MH)	Turns right (C)

If the result is not as specified, replace the mirror assembly.

- w/ Mirror Heater:

Check the resistance.

- Measure the resistance between the terminals.

Standard resistance

Tester connection	Condition	Specified Condition
4 (H-) - 5 (H+)	65°C (149°F)	4 to 12 Ω

If the result is not as specified, replace the outer rear view mirror.

- Connect the cable from the negative battery (-) terminal to terminal 5 and the positive battery (+) terminal to terminal 4, then check that the mirror becomes warm.

OK:

Mirror becomes warm.

HINT:

It takes a short time for the mirror to become warm.

If the result is not as specified, replace the outer rear view mirror.

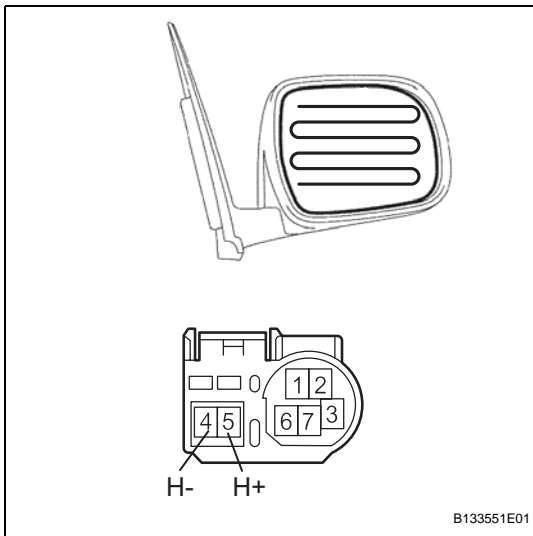

INSTALLATION

1. INSTALL OUTER MIRROR COVER LH

- Attach the 8 claws and install the mirror cover.
- After installing the outer mirror cover, check that there is no gap between the cover and mirror body.

HINT:

If there is a gap between the cover and body, noise will occur during driving.

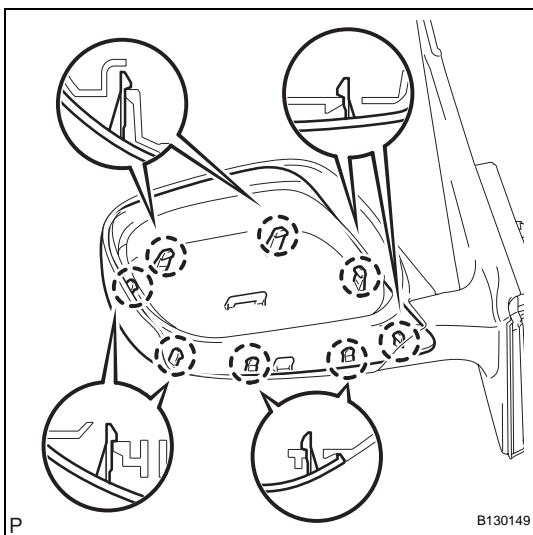

MI

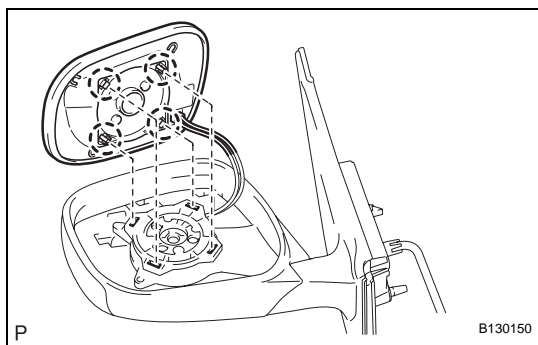

- (c) w/ Mirror Heater:
Connect the 2 connectors. Attach the 4 claws to install the mirror.

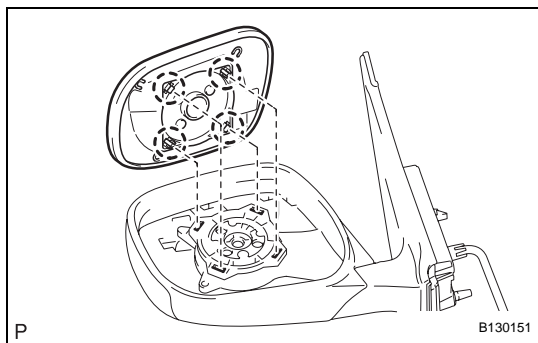

- (d) w/o Mirror Heater:
Attach the 4 claws to install the mirror.

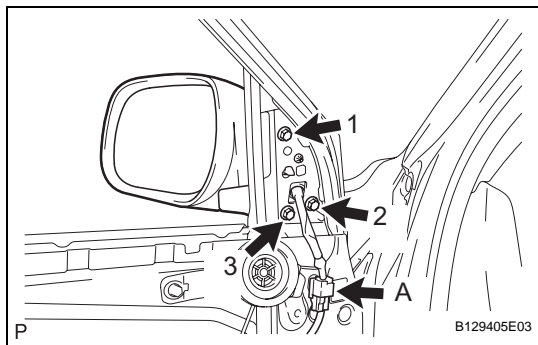

2. INSTALL OUTER REAR VIEW MIRROR ASSEMBLY LH

- Pass the connector labeled A and wire harness of the mirror through the wire harness hole.
- Temporarily install the mirror by inserting the bosses on the mirror into the holes on the vehicle.
- Tighten the 3 screws in the sequence shown in the illustration and Install the mirror.
Torque: 9.0 N*m (92 kgf*cm, 80 in.*lbf)
- Connect the connector labeled A.

3. INSTALL FRONT DOOR TRIM BOARD SUB-ASSEMBLY LH (See page [ED-33](#))

4. INSTALL FRONT DOOR LOWER FRAME BRACKET GARNISH LH (See page [ED-35](#))