

# IGNITION KEY CYLINDER LIGHT

## COMPONENTS

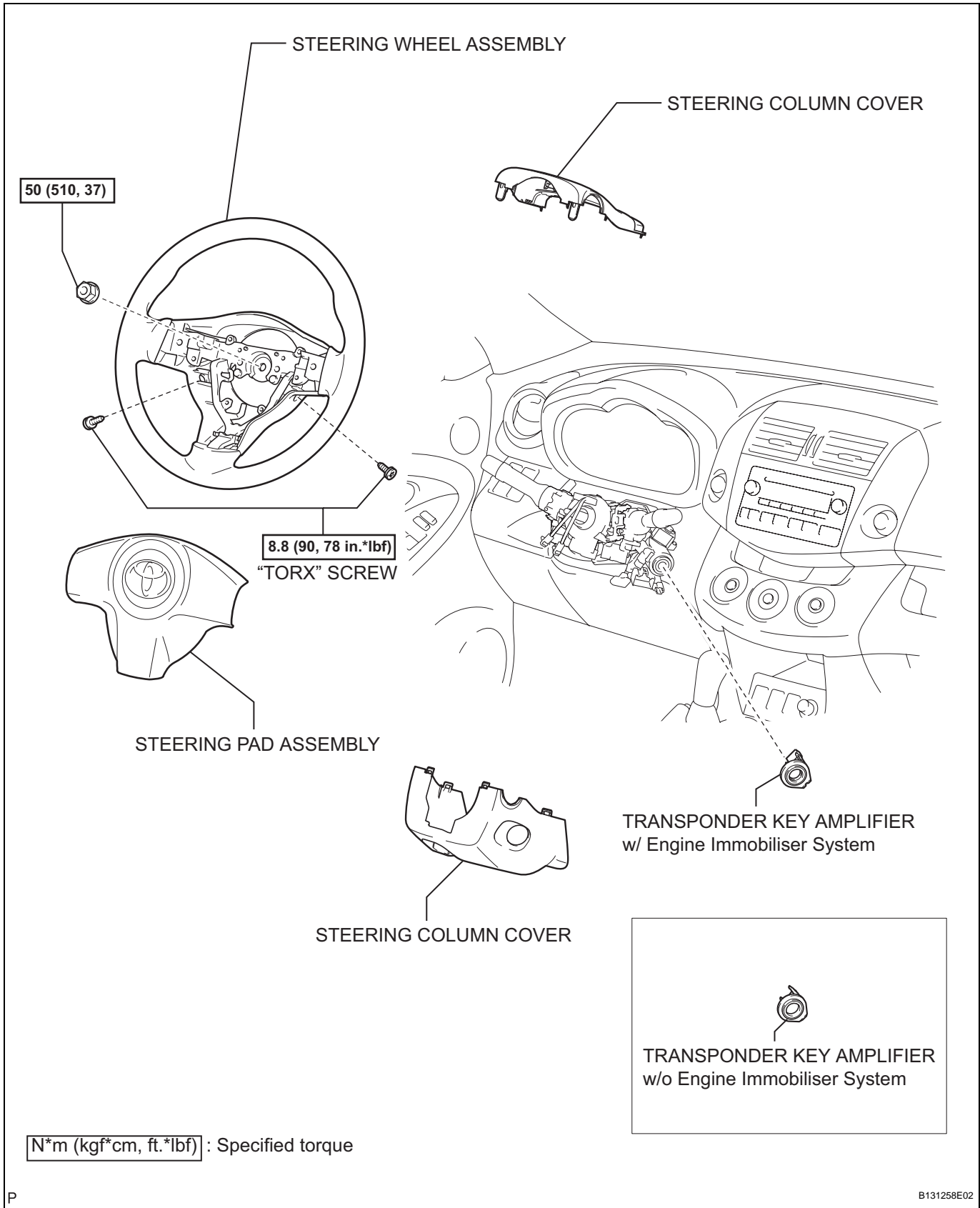

## REMOVAL

1. **DISCONNECT CABLE FROM NEGATIVE BATTERY**  
**CAUTION:**  
 Wait at least 90 seconds after disconnecting the cable from the negative (-) battery terminal to prevent airbag and seat belt pretensioner activation.
2. **PLACE FRONT WHEELS FACING STRAIGHT AHEAD**
3. **REMOVE STEERING PAD ASSEMBLY (See page RS-336)**
4. **REMOVE STEERING WHEEL ASSEMBLY (See page SR-12)**
5. **REMOVE STEERING COLUMN COVER (See page SR-12)**
6. **REMOVE TRANSPONDER KEY AMPLIFIER (See page SR-14)**

## INSPECTION

1. **INSPECT TRANSPONDER KEY AMPLIFIER**
  - (a) w/ Engine immobiliser system:
    - (1) Connect the battery's positive (+) lead to terminal 2 and the negative (-) lead to terminal 6, and then check that the light comes on.  
**OK:**  
**LED illuminates.**  
 If the result is not as specified, replace the transponder key amplifier.
  - (b) w/o Engine immobiliser system:
    - (1) Connect the battery's positive (+) lead to terminal 2 and the negative (-) lead to terminal 1, and then check that the light comes on.  
**OK:**  
**LED illuminates.**  
 If the result is not as specified, replace the transponder key amplifier.

