

TRANSFER CASE OIL SEAL (for LH Side)

COMPONENTS

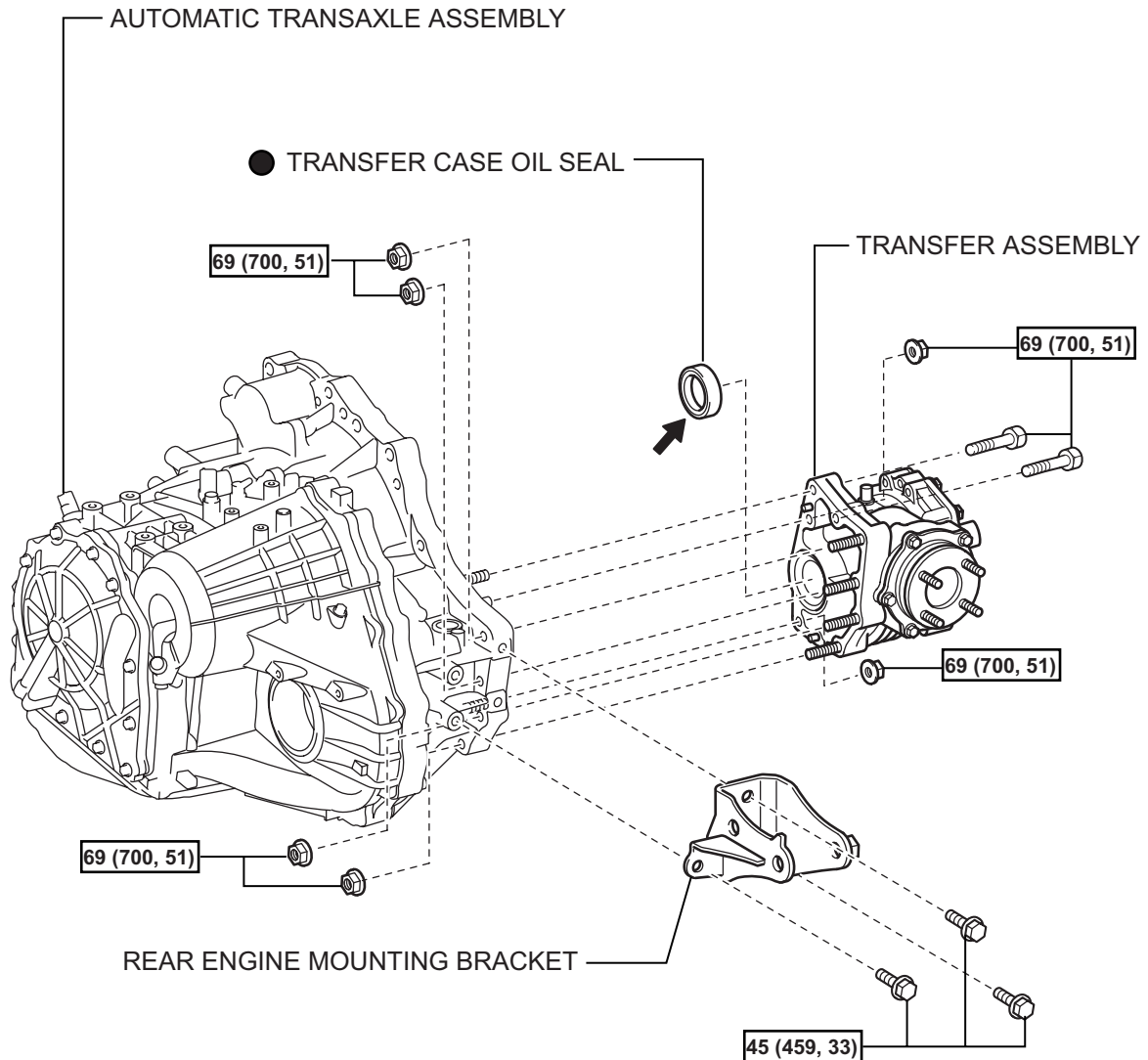

N*m (kgf*cm, ft.*lbf) : Specified torque

● Non-reusable part

← Apply MP grease

REPLACEMENT

1. **DISCONNECT CABLE FROM NEGATIVE BATTERY TERMINAL**

CAUTION:

Wait at least 90 seconds after disconnecting the cable from the negative (-) battery terminal to prevent airbag and seat belt pretensioner activation.

2. **DRAIN AUTOMATIC TRANSAXLE FLUID**

- (a) Remove the drain plug and gasket, and drain ATF.
- (b) Install a new gasket and drain plug.

Torque: 47 N*m (479 kgf*cm, 35 ft.*lbf)

3. **DRAIN TRANSAXLE OIL**

- (a) Remove the filler plug and gasket.
- (b) Remove the drain plug and gasket, and drain the oil.
- (c) Install a new gasket and the drain plug.

Torque: 39 N*m (398 kgf*cm, 28 ft.*lbf)

4. **DRAIN TRANSFER OIL**

- (a) Remove the drain plug and gasket, and drain the oil.
- (b) Install a new gasket and drain plug.

Torque: 39 N*m (398 kgf*cm, 28 ft.*lbf)

5. **REMOVE PROPELLER WITH CENTER BEARING SHAFT ASSEMBLY (See page [PR-3](#))**

6. **REMOVE REAR ENGINE MOUNTING BRACKET**

- (a) Remove the 3 bolts and mounting bracket.

7. **REMOVE AUTOMATIC TRANSAXLE ASSEMBLY**

- (a) Remove the automatic transaxle (see page [EM-98](#)).

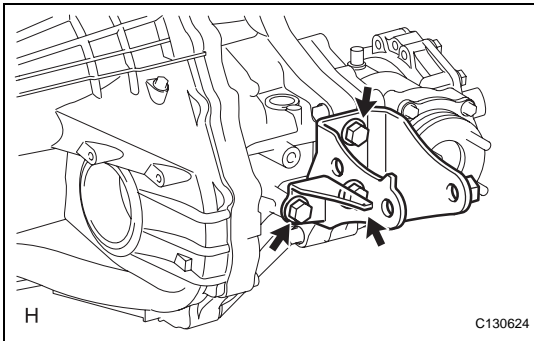

TF

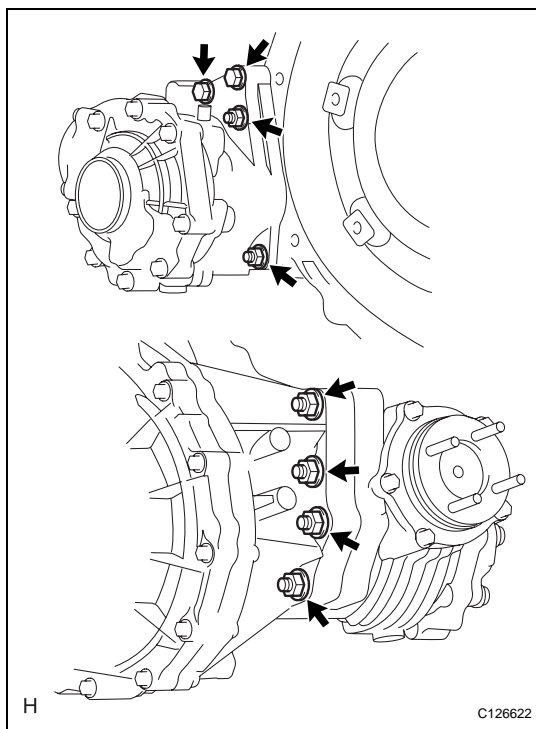
**8. REMOVE TRANSFER ASSEMBLY**

- (a) Remove the 2 bolts, 6 nuts and transfer from the manual transaxle.

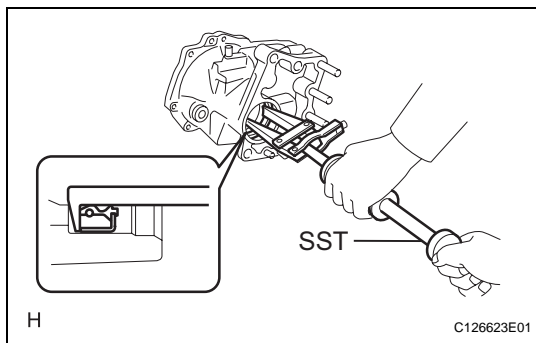
**9. REMOVE TRANSFER CASE OIL SEAL**

- (a) Using SST, tap out the transfer case oil seal.
SST 09308-00010

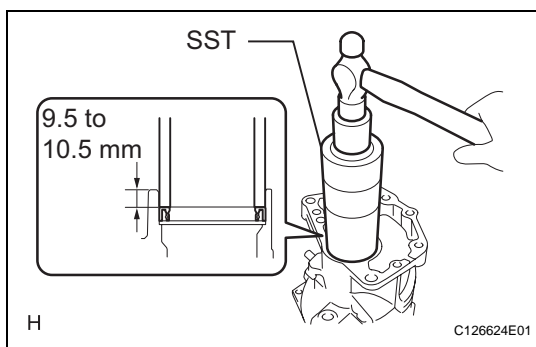
**10. INSTALL TRANSFER CASE OIL SEAL**

- (a) Coat a new oil seal lip with MP grease.
(b) Using SST and a hammer, tap in the transfer case oil seal.

SST 09316-60011 (09316-00011)

Standard depth:

9.5 to 10.5 mm (0.37 to 0.41 in.)

NOTICE:

Do not damage the oil seal lip.

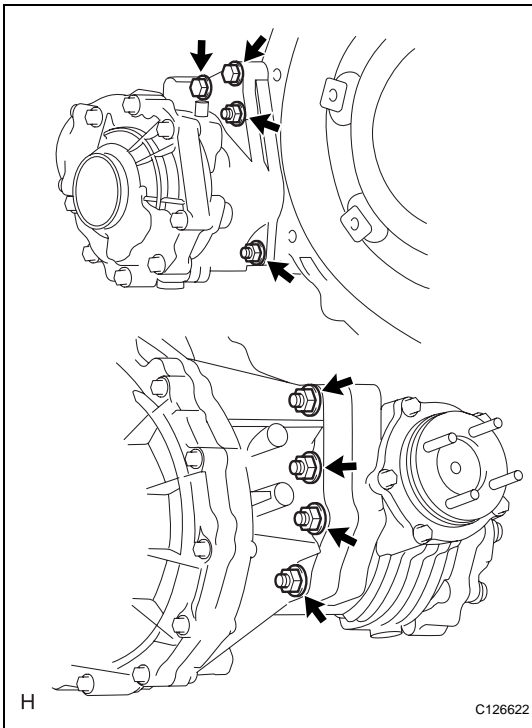
**11. INSTALL TRANSFER ASSEMBLY**

- (a) Install the transfer with the 6 nuts and 2 bolts.
Torque: 69 N*m (700 kgf*cm, 51 ft.*lbf)

12. INSTALL AUTOMATIC TRANSAXLE ASSEMBLY

- (a) Install automatic transaxle (see page [EM-105](#)).

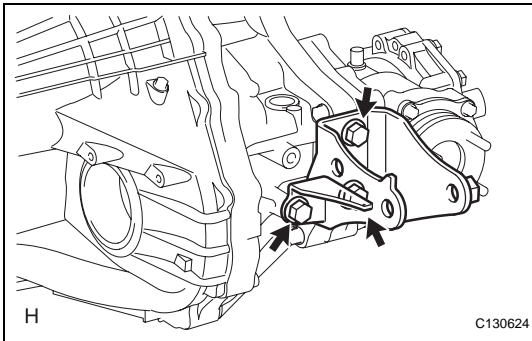
**13. INSTALL REAR ENGINE MOUNTING BRACKET**

- (a) Install the mounting bracket with the 3 bolts.
Torque: 45 N*m (459 kgf*cm, 33 ft.*lbf)

14. INSTALL PROPELLER WITH CENTER BEARING SHAFT ASSEMBLY (See page [PR-5](#))**15. ADD AUTOMATIC TRANSAXLE FLUID****16. INSPECT AUTOMATIC TRANSAXLE FLUID (See page [AX-102](#))****17. ADD TRANSFER OIL****18. INSPECT TRANSFER OIL (See page [TF-45](#))****19. CONNECT CABLE TO NEGATIVE BATTERY TERMINAL****20. INSPECT SRS WARNING LIGHT**

- (a) Check the SRS warning light (see page [RS-37](#)).