

FRONT DOOR BELT MOULDING

COMPONENTS

ET

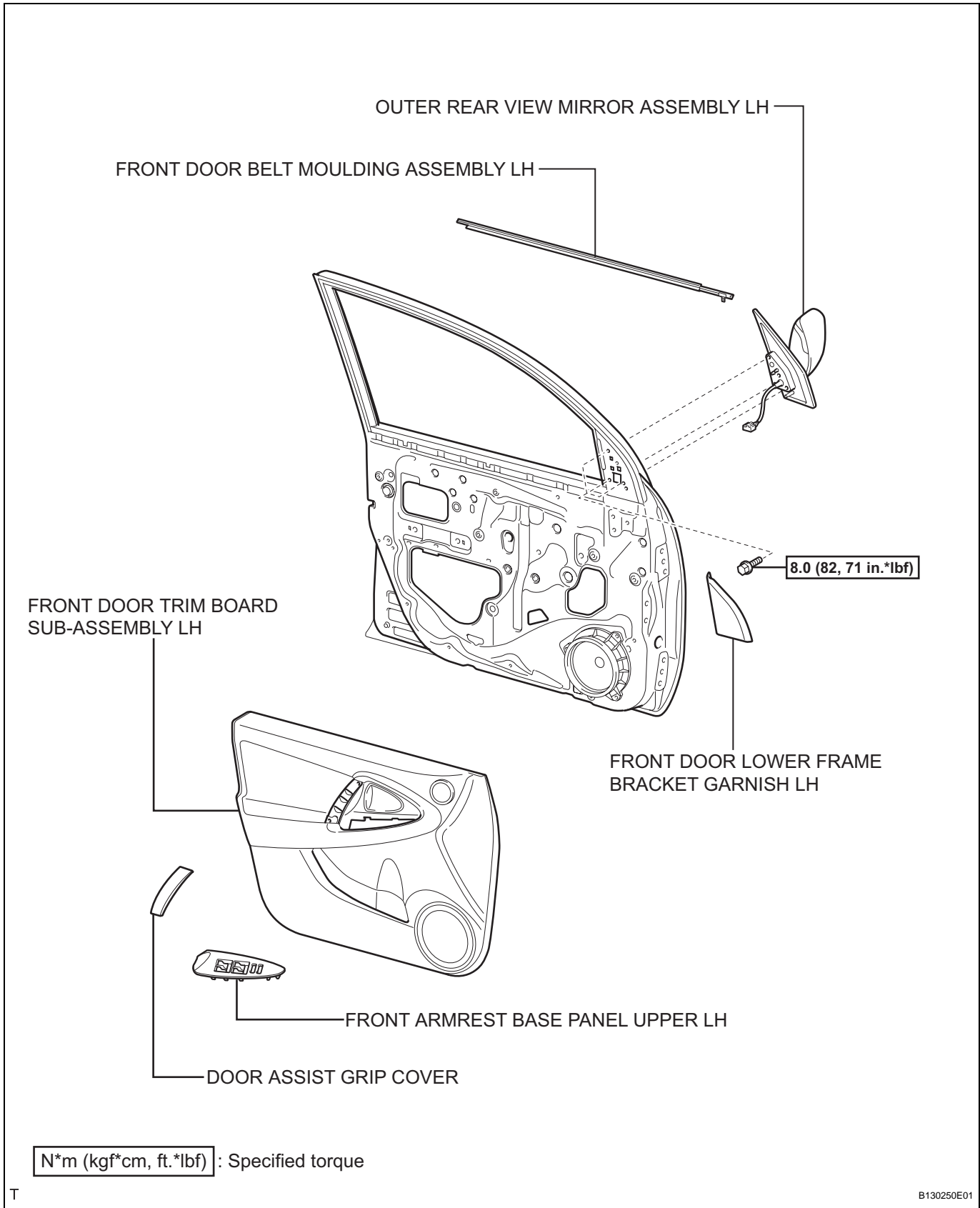

REMOVAL

HINT:

- Use the same procedures for the RH side and LH side.
- The procedures listed below are for the LH side.

1. DISCONNECT CABLE FROM NEGATIVE BATTERY TERMINAL

NOTICE:

Wait at least 90 seconds after disconnecting the cable from the negative (-) battery terminal to prevent airbag and seat belt pretensioner activation.

2. REMOVE FRONT DOOR LOWER FRAME BRACKET GARNISH LH (See page ED-19)

3. REMOVE FRONT ARMREST BASE PANEL UPPER LH (See page ED-19)

4. REMOVE FRONT DOOR TRIM BOARD SUB-ASSEMBLY LH (See page ED-20)

5. REMOVE OUTER REAR VIEW MIRROR ASSEMBLY LH (See page MI-8)

6. REMOVE FRONT DOOR BELT MOULDING ASSEMBLY LH

- Put protective tape under the belt moulding.
- Using a moulding remover, detach the claws to remove the belt moulding as shown in the illustration.

HINT:

Tap the remover tip before use.

NOTICE:

Be careful when removing the belt moulding as there are claws attached to the front and rear ends of the belt moulding.

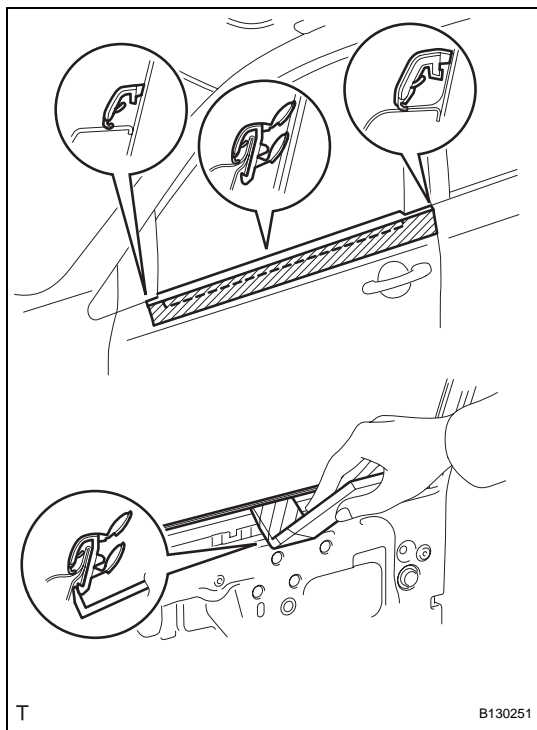

T

B130251

ET