

## DISASSEMBLY

(2005/11-2006/01)

### 1. REMOVE FRONT AXLE INBOARD JOINT BOOT NO. 2 CLAMP LH

- (a) One touch type:
  - (1) Using a screwdriver, remove the No. 2 inboard joint boot clamp, as shown in the illustration.
- (b) Claw engagement type:
  - (1) Using needle-nose pliers, remove the No. 2 inboard joint boot clamp, as shown in the illustration.

### 2. REMOVE FRONT AXLE INBOARD JOINT BOOT NO. 2 CLAMP RH

HINT:

Using needle-nose pliers, remove the No. 2 inboard joint boot clamp, as shown in the illustration.

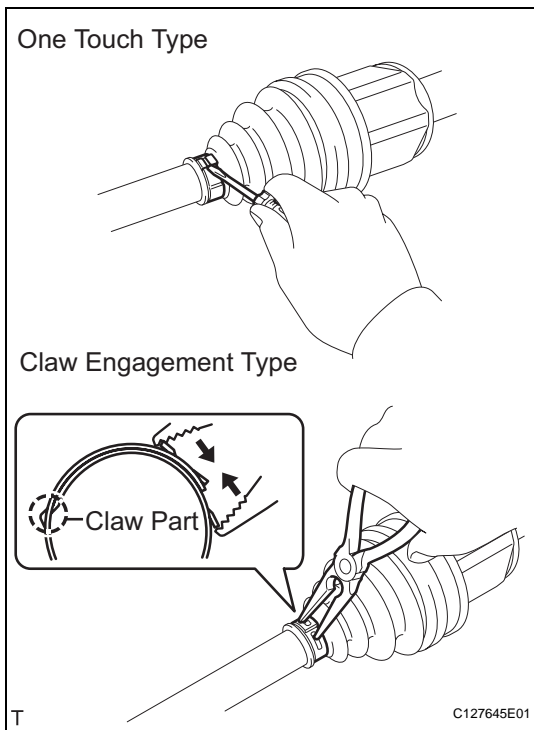

### 3. REMOVE FRONT AXLE INBOARD JOINT BOOT CLAMP LH

- (a) One touch type:
  - (1) Using a screwdriver, remove the inboard joint boot clamp, as shown in the illustration.
- (b) Claw engagement type:
  - (1) Using needle-nose pliers, remove the inboard joint boot clamp, as shown in the illustration.

### 4. REMOVE FRONT AXLE INBOARD JOINT BOOT CLAMP RH

HINT:

Use the same procedures described for the LH side.

### 5. REMOVE FRONT AXLE INBOARD JOINT BOOT

- (a) Remove the boot from the inboard joint.

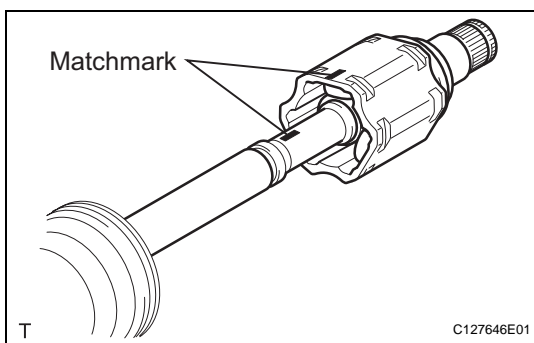

### 6. REMOVE FRONT DRIVE INBOARD JOINT ASSEMBLY LH

- (a) Remove any old grease from the inboard joint.
- (b) Put matchmarks on the inboard joint and outboard joint shaft.

**NOTICE:**

**Do not punch the marks.**

- (c) Remove the inboard joint from the outboard joint shaft.

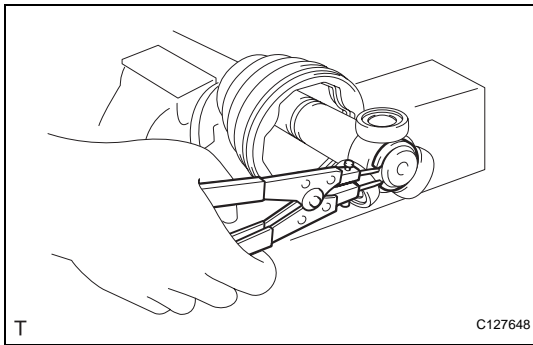

- (d) Using a snap ring expander, remove the shaft snap ring.

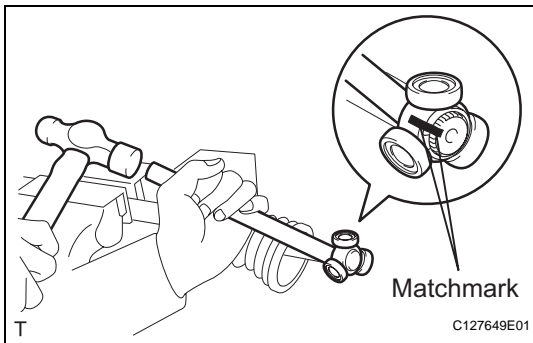

- (e) Put matchmarks on the outboard joint shaft and tripod joint.  
**NOTICE:**  
**Do not punch the marks.**
- (f) Using a brass bar and hammer, tap out the tripod joint from the outboard joint shaft.  
**NOTICE:**  
**Do not tap the rollers.**
- (g) Remove the inboard joint boot.

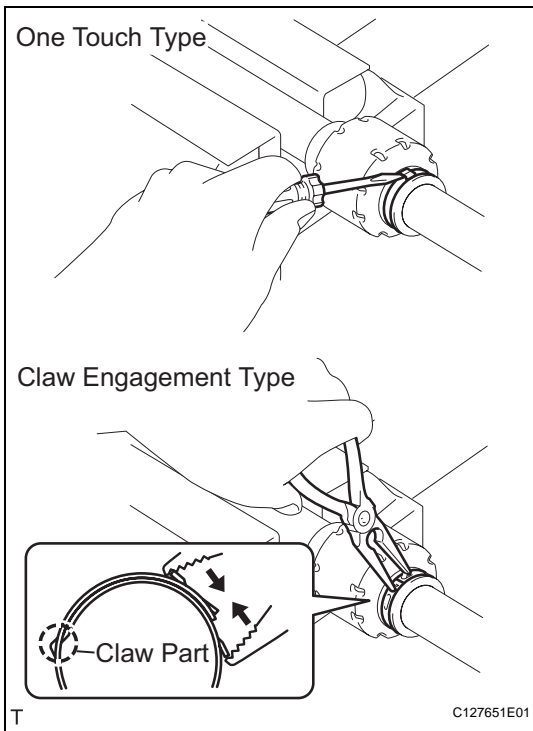

#### 7. REMOVE FRONT DRIVE SHAFT DAMPER CLAMP LH

- (a) One touch type:  
 (1) Using a screwdriver, remove the drive shaft damper clamp, as shown in the illustration.
- (b) Claw engagement type:  
 (1) Using needle-nose pliers, remove the drive shaft damper clamp, as shown in the illustration.

#### 8. REMOVE FRONT DRIVE SHAFT DAMPER LH

- (a) Remove the front drive shaft damper.

#### 9. REMOVE FRONT DRIVE SHAFT DAMPER CLAMP RH

- HINT:**  
 Use the same procedures described for the LH side.

#### 10. REMOVE FRONT DRIVE SHAFT DAMPER RH

- HINT:**  
 Use the same procedures described for the LH side.

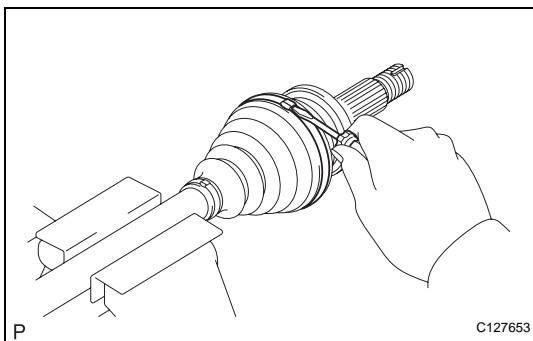

#### 11. REMOVE FRONT AXLE OUTBOARD JOINT BOOT NO. 2 CLAMP LH

- (a) Using a screwdriver, remove the No. 2 outboard joint boot clamp, as shown in the illustration.

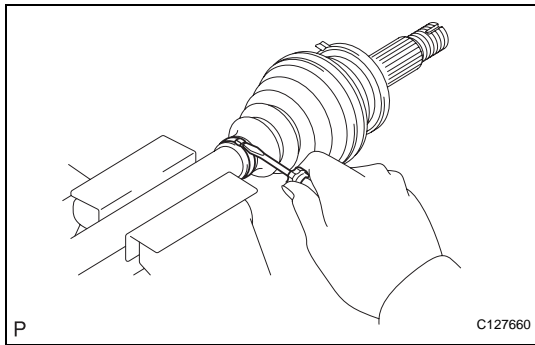

## 12. REMOVE FRONT AXLE OUTBOARD JOINT BOOT CLAMP LH

- (a) Using a screwdriver, remove the outboard joint boot clamp, as shown in the illustration.

## 13. REMOVE FRONT AXLE OUTBOARD JOINT BOOT LH

- (a) Remove the outboard joint boot from the outboard joint shaft.  
 (b) Remove any old grease from the outboard joint.

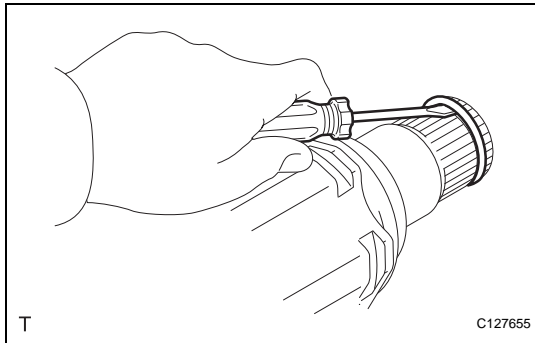

## 14. REMOVE FRONT DRIVE SHAFT HOLE SNAP RING LH

- (a) Using a screwdriver, remove the hole snap ring.

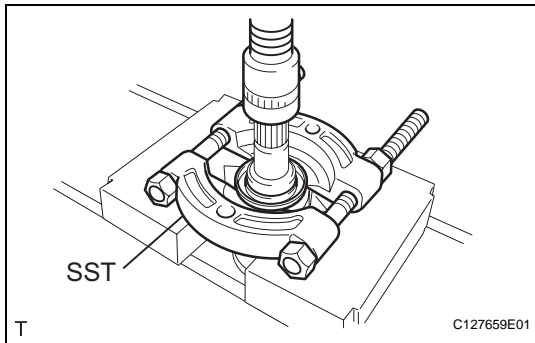

## 15. REMOVE FRONT DRIVE SHAFT DUST COVER LH

- (a) Using SST and a press, press out the front drive shaft dust cover.

**SST 09950-00020**

**NOTICE:**

**Be careful not to drop the inboard joint**

## 16. REMOVE FRONT DRIVE SHAFT DUST COVER RH

- (a) Using a press, press out the drive shaft dust cover.

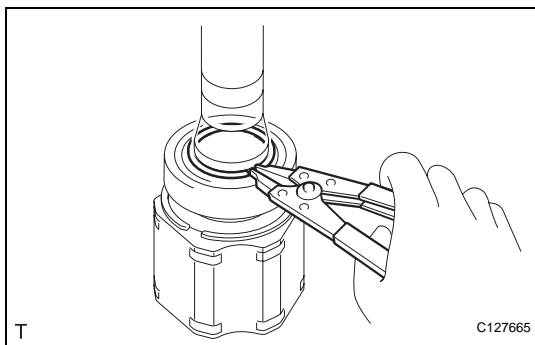

## 17. REMOVE FRONT DRIVE SHAFT BEARING

- (a) Using a snap ring expander, remove the drive shaft hole snap ring.

- (b) Using SST and a press, press out the drive shaft bearing.

**SST 09527-10011**

- (c) Remove the snap ring.

