

REASSEMBLY

HINT:

- Use the same procedures for the LH side and RH side.
- The procedures listed below are for the LH side.

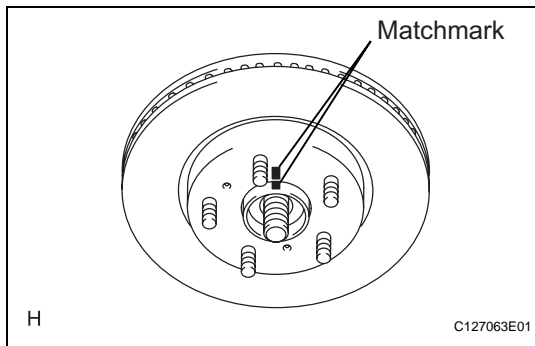

1. INSTALL FRONT DISC

- (a) Align the matchmarks and install the disc.

HINT:

When replacing the disc with a new one, select the installation position where the disc has the minimum runout.

2. CHECK DISC RUNOUT (See page BR-43)

3. TEMPORARILY TIGHTEN FRONT DISC BRAKE BLEEDER PLUG

- (a) Install the bleeder plug to the cylinder.

HINT:

The bleeder plug will be tightened to a torque specification in the "BLEED AIR FROM BRAKE LINE" procedures.

- (b) Install the bleeder plug cap.

4. INSTALL PISTON SEAL

- (a) Apply lithium soap base glycol grease to a new seal.
 (b) Install the seal to the cylinder.

NOTICE:

Securely install the piston seal into the groove of the disc brake cylinder.

5. INSTALL FRONT DISC BRAKE PISTON

- (a) Apply lithium soap base glycol grease to the piston and a new cylinder boot.
 (b) Install the boot to the piston.
 (c) Install the piston (with boot) to the cylinder.

NOTICE:

Do not forcibly install the piston to the cylinder.

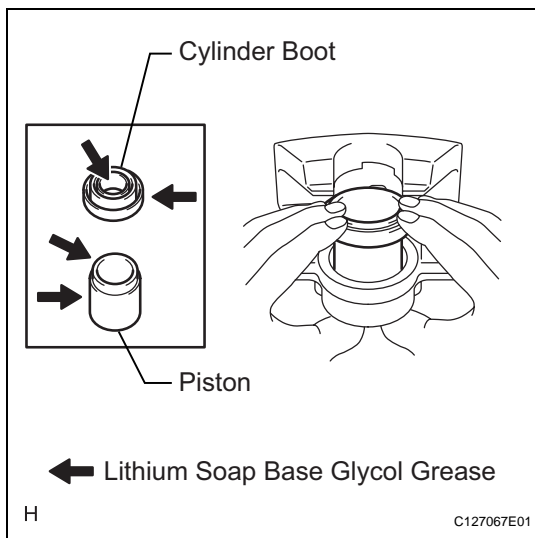

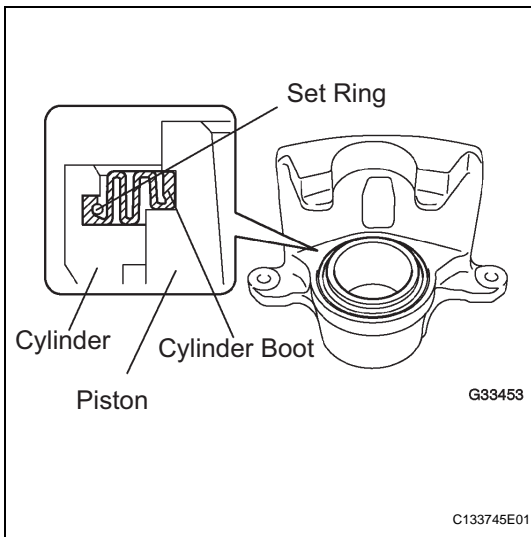

6. INSTALL CYLINDER BOOT

- (a) Install the cylinder boot to the cylinder.

NOTICE:

Securely install the cylinder boot into the groove of the disc brake cylinder.

- (b) Using a screwdriver, install a new set ring.

NOTICE:

Do not damage the cylinder boot.

HINT:

Tape the screwdriver tip before use.

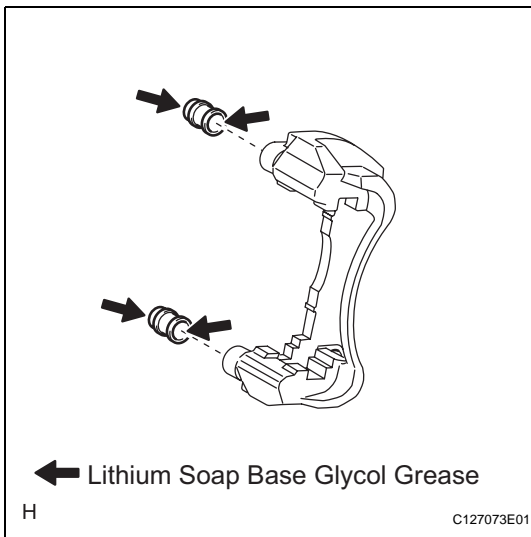

7. INSTALL FRONT DISC BRAKE BUSH DUST BOOT

- (a) Apply lithium soap base glycol grease to 2 new boots.

- (b) Install the 2 boots to the mounting.

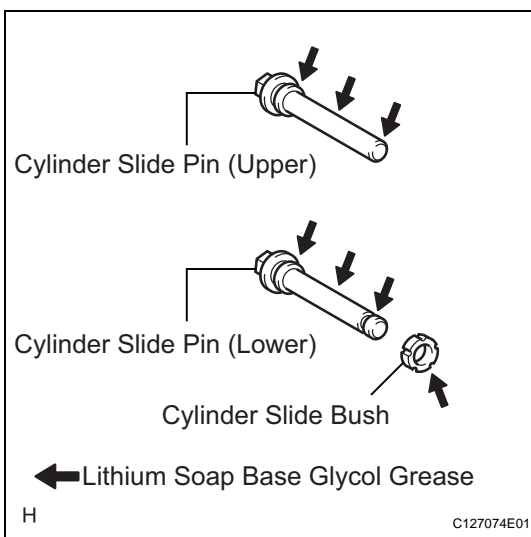

8. INSTALL FRONT DISC BRAKE CYLINDER SLIDE PIN

- (a) Apply lithium soap base glycol grease to the pins and a new bush as shown in the illustration.

- (b) Install the bush to the pin (lower).

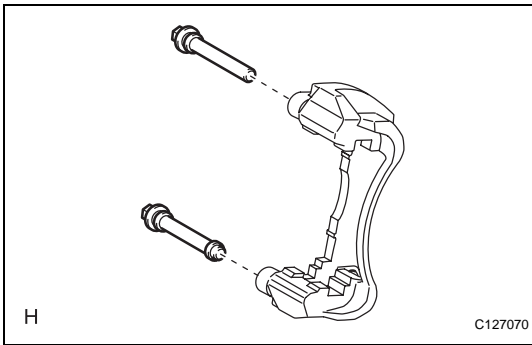

(c) Install the 2 pins (upper and lower) to the mounting.

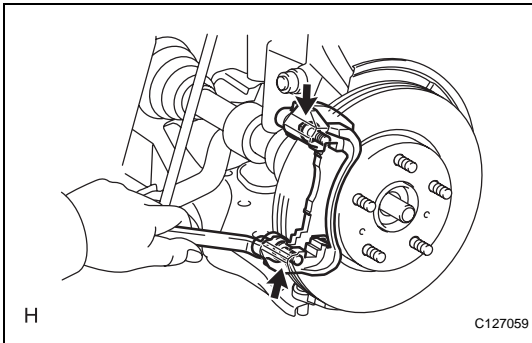

9. INSTALL FRONT DISC BRAKE CYLINDER MOUNTING LH

(a) Install the cylinder mounting with the 2 bolts.
Torque: 98 N*m (999 kgf*cm, 72 ft.*lbf)

10. INSTALL FRONT DISC BRAKE PAD SUPPORT PLATE

(a) Install the 4 plates to the mounting.

11. INSTALL NO. 1 PAD WEAR INDICATOR PLATE

(a) Install the 2 indicator plates to the upper side of each pad.

12. INSTALL ANTI-SQUEAL SHIM KIT FRONT

(a) w/ ϕ 275 disc brake:

- (1) Apply disc brake grease to both sides of each No. 1 shim.
- (2) Install the No. 1 and No. 2 shims to each pad.

NOTICE:

- When replacing a worn pad, the shims must be replaced together with the pads.
- Install the shims in the correct positions and direction as shown in the illustration.

BR

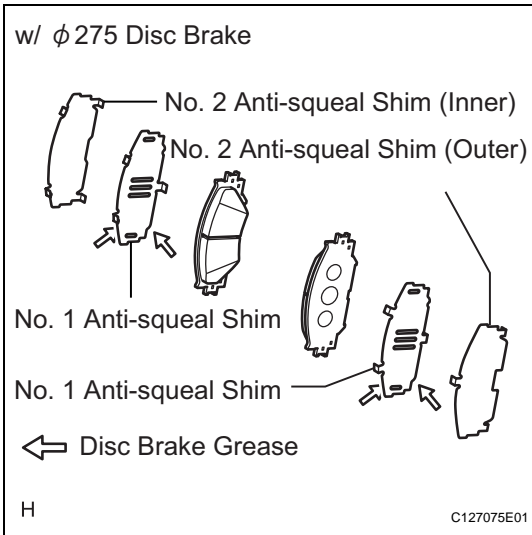

(b) w/ ϕ 296 disc brake:

- (1) Install the No. 1 and No. 2 shims to each pad.

NOTICE:

- When replacing a worn pad, the shims must be replaced together with the pads.
- Install the shims in the correct positions and direction as shown in the illustration.

13. INSTALL FRONT DISC BRAKE PAD

(a) Install the 2 disc brake pads to the mounting.

NOTICE:

There should be no oil or grease on the friction surface of the pads and disc.

