

SOLAR SENSOR (for Automatic Air Conditioning System)

COMPONENTS

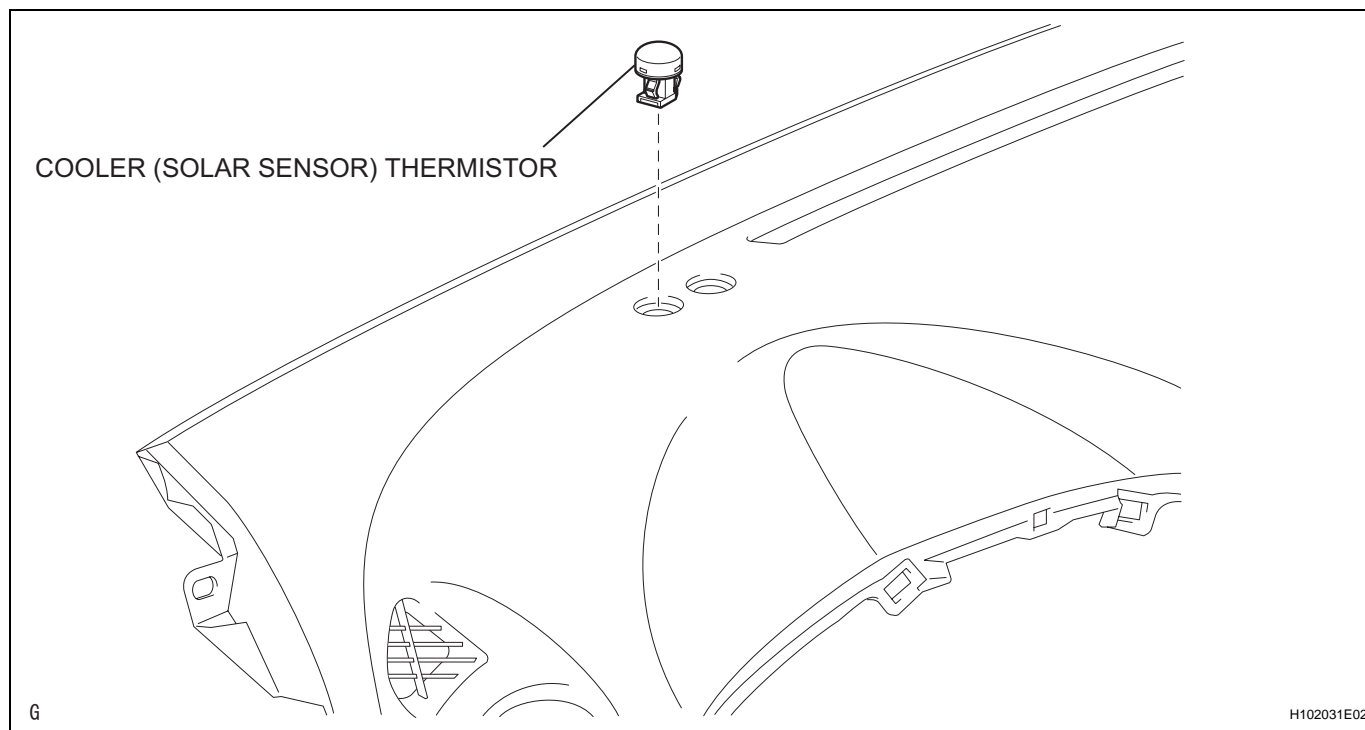

REMOVAL

1. DISCONNECT CABLE FROM NEGATIVE BATTERY TERMINAL
- CAUTION:
- Wait at least 90 seconds after disconnecting the cable from the negative (-) battery terminal to prevent airbag and seat belt pretensioner activation.
2. REMOVE SOLAR SENSOR
- (a) Using a screwdriver, pull out the solar sensor, then disconnect the connector.
- HINT:
- Tape the screwdriver tip before use.

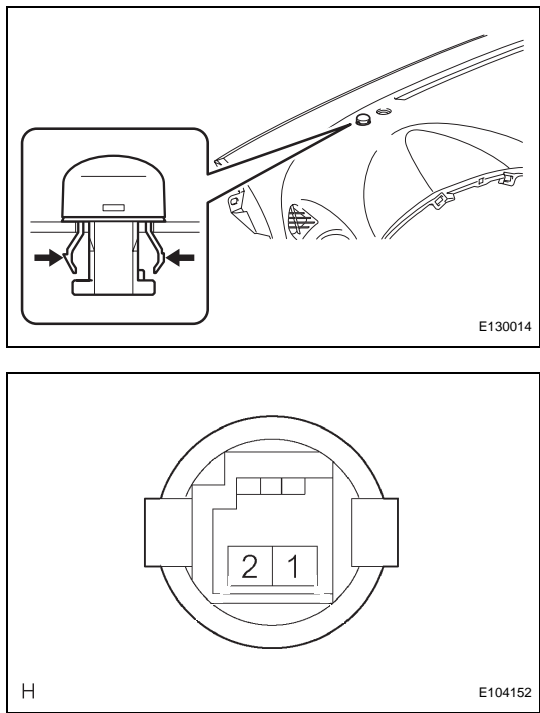

INSPECTION

1. INSPECT SOLAR SENSOR
- (a) Using an ohmmeter, connect the positive lead to terminal 2 and the negative lead to terminal 1, then measure the resistance between the terminals.
- Standard resistance

Tester Connection	Connection	Specified Condition
1 - 2	Sensor subject to electric light	Except $\infty \Omega$
1 - 2	Sensor covered with a cloth	$\infty \Omega$

NOTICE:
The connection procedure for using a digital tester such as a TOYOTA electrical tester is shown above. When using an analog tester, connect the positive (+) lead to terminal 1 and the negative (-) lead to terminal 2 of the A/C solar sensor.

HINT:

- As the inspection light is moved away from the sensor, the voltage increases.
- Use an incandescent lamp for inspection. Bring it within 30 cm (11.8 in.) of the A/C solar sensor.

If the result is not as specified, replace the solar sensor.