

AIR CONDITIONING CONTROL ASSEMBLY (for Manual Air Conditioning System)

COMPONENTS

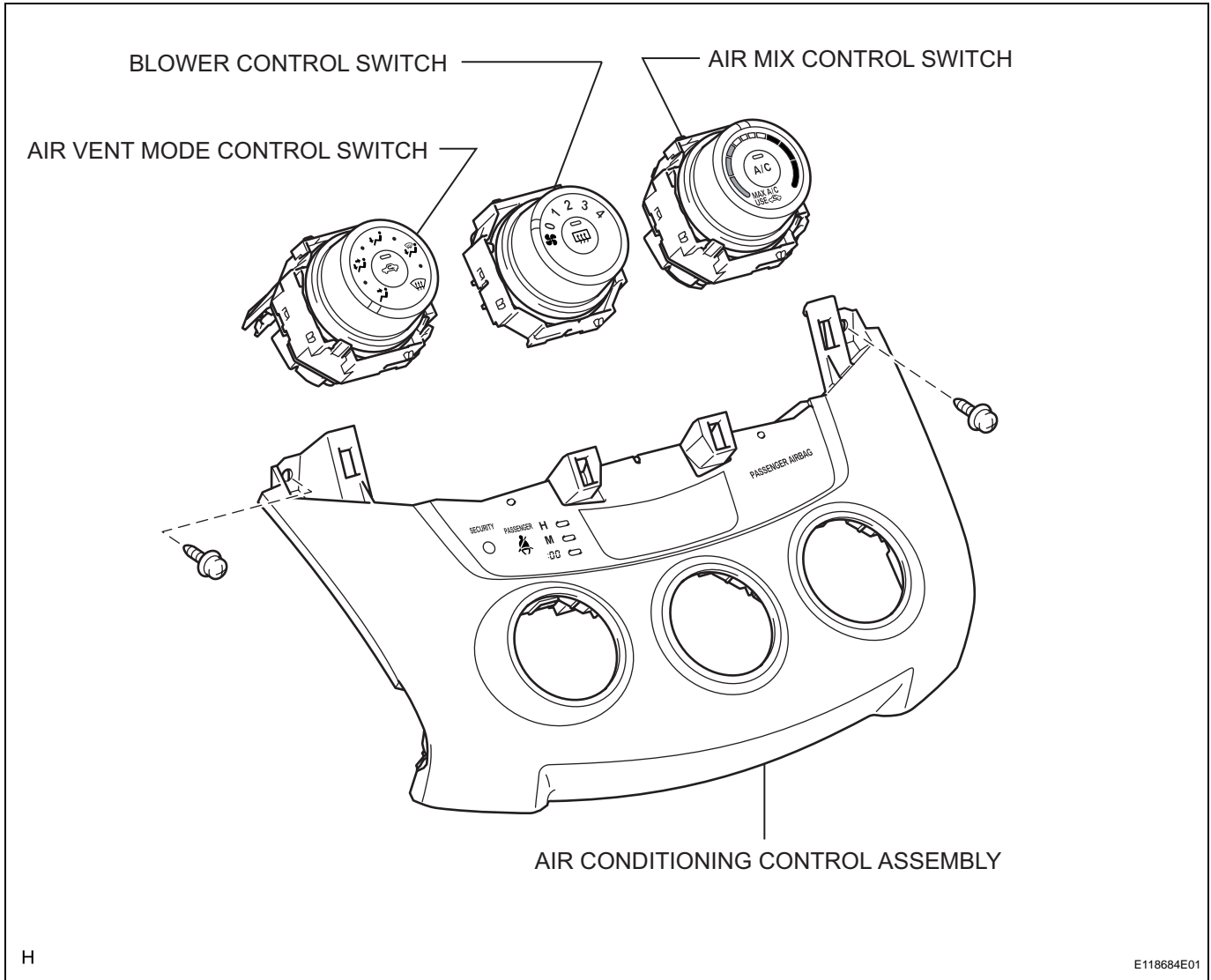

AC

REMOVAL

1. **DISCONNECT CABLE FROM NEGATIVE BATTERY TERMINAL**

NOTICE:

Wait at least 90 seconds after disconnecting the cable from the negative (-) battery terminal to prevent airbag and seat belt pretensioner activation.

2. **REMOVE NO. 2 INSTRUMENT CLUSTER FINISH PANEL CENTER** (See page [IP-5](#))

3. **REMOVE NO. 1 INSTRUMENT CLUSTER FINISH PANEL CENTER** (See page [IP-5](#))

4. **REMOVE RADIO RECEIVER ASSEMBLY** (See page [IP-5](#))

5. **REMOVE AIR CONDITIONING CONTROL ASSEMBLY**

- (a) Remove the 2 screws.
- (b) Using a screwdriver, detach the 3 clips.

HINT:

Tape the screwdriver tip before use.

- (c) Disconnect the connectors and remove the air conditioning control.

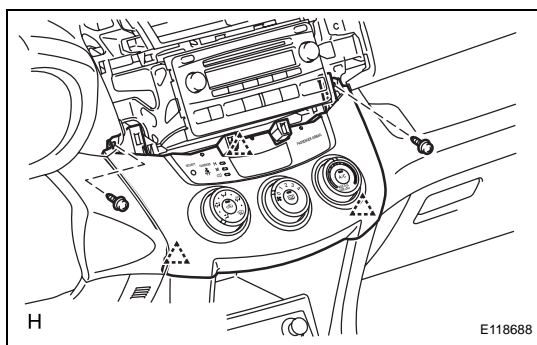

6. **REMOVE AIR MIX CONTROL SWITCH**

- (a) Detach the 2 claws and remove the air mix control switch.

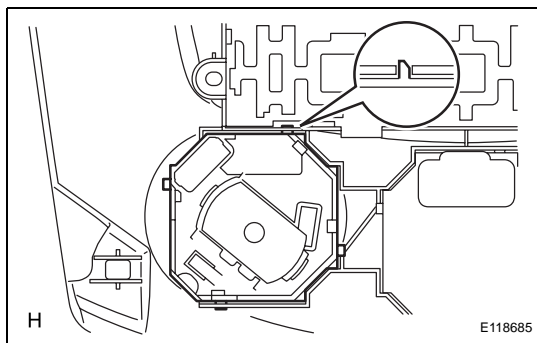

7. **REMOVE BLOWER CONTROL SWITCH**

- (a) Detach the 2 claws and remove the blower control switch.

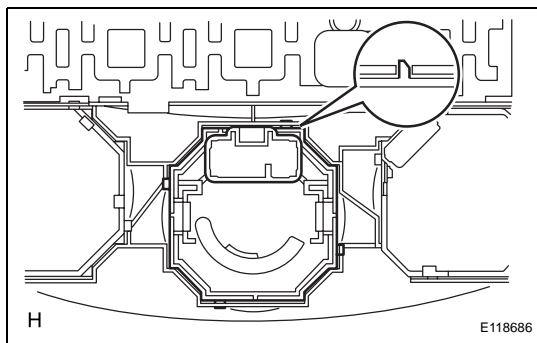

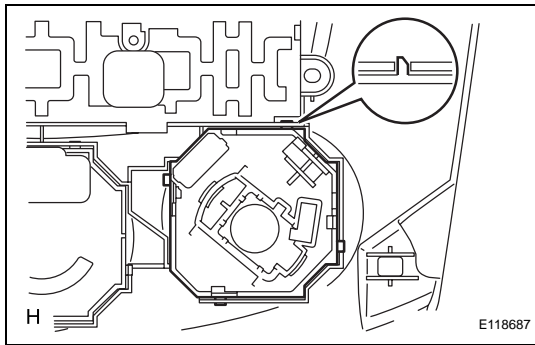

- 8. REMOVE AIR VENT MODE CONTROL SWITCH**
- (a) Detach the 2 claws and remove the mode control switch.