

KNOCK SENSOR

COMPONENTS

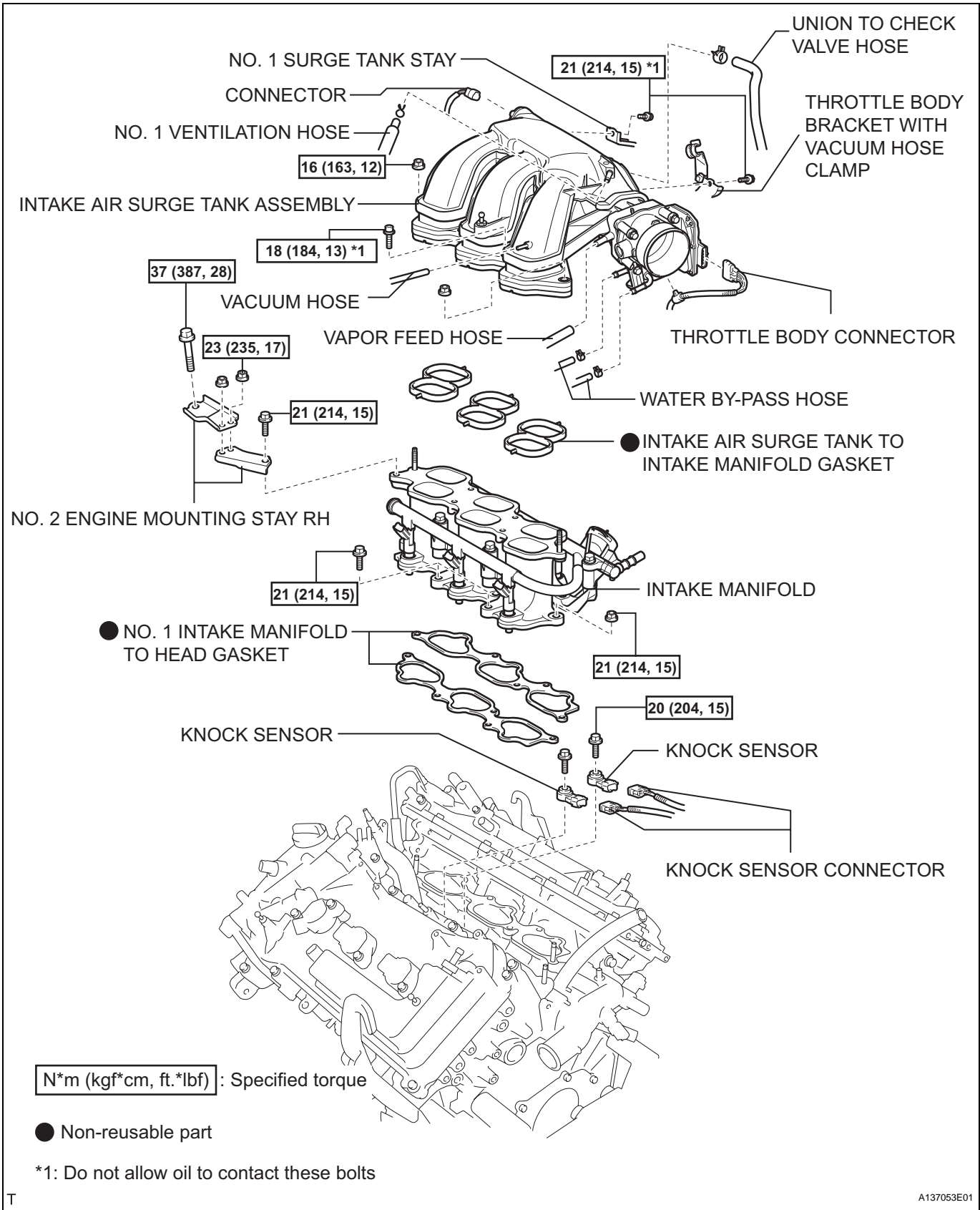

REMOVAL

1. **DISCONNECT CABLE FROM NEGATIVE BATTERY TERMINAL**
CAUTION:
 Wait at least 90 seconds after disconnecting the cable from the negative (-) battery terminal to prevent airbag and seat belt pretensioner activation.
2. **REMOVE ENGINE ASSEMBLY**
 (a) Remove the engine (see page [EM-21](#)).
3. **REMOVE INTAKE AIR SURGE TANK ASSEMBLY**
 (See page [EM-27](#))
4. **REMOVE INTAKE MANIFOLD** (See page [EM-28](#))
5. **REMOVE KNOCK SENSOR**
 (a) Disconnect the 2 sensor connectors.
 (b) Remove the 2 bolts and 2 sensors.

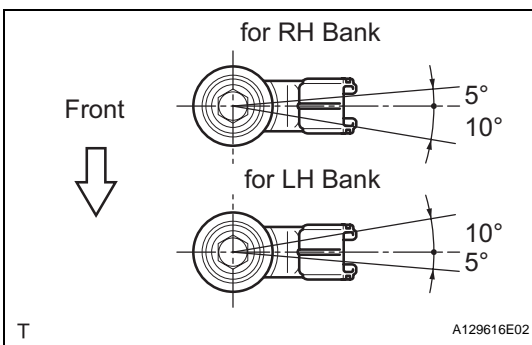
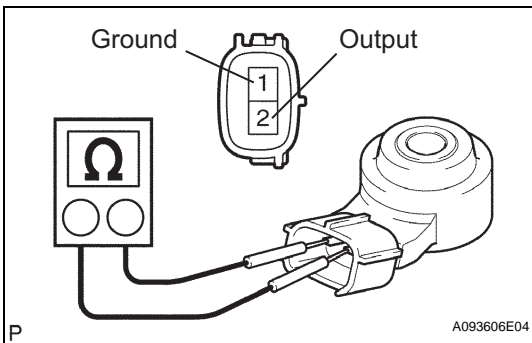
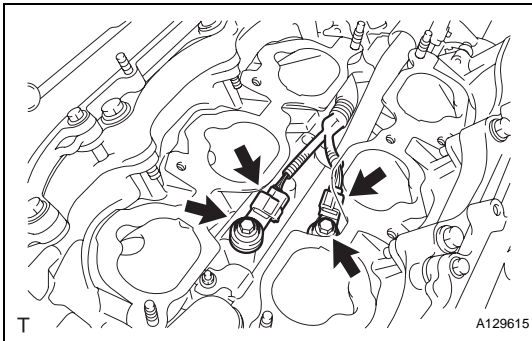

INSPECTION

1. **INSPECT KNOCK SENSOR**
 (a) Measure the resistance of the sensor.

Standard resistance

Tester Connection	Condition	Specified Condition
1 (Ground) - 2 (Output)	20°C (68°F)	120 to 280 kΩ

If the result is not as specified, replace the knock sensor.

INSTALLATION

1. **INSTALL KNOCK SENSOR**
 (a) Install the 2 sensors with the 2 bolts as shown in the illustration.
Torque: 20 N*m (205 kgf*cm, 15 ft.*lbf)
NOTICE:
Make sure that the knock sensor is in the correct position.
 (b) Connect the 2 sensor connectors.
2. **INSTALL INTAKE MANIFOLD** (See page [EM-33](#))
3. **INSTALL INTAKE AIR SURGE TANK ASSEMBLY** (See page [EM-34](#))
4. **INSTALL ENGINE ASSEMBLY**
 (a) Install the engine (see page [EM-31](#)).
5. **CONNECT CABLE TO NEGATIVE BATTERY TERMINAL**

6. CHECK FOR ENGINE COOLANT LEAKS (See page [CO-1](#))
7. CHECK FOR FUEL LEAKS
8. CHECK FOR ENGINE OIL LEAKS (See page [LU-6](#))