

CIRCUIT OPENING RELAY

ON-VEHICLE INSPECTION

1. DISCONNECT CABLE FROM NEGATIVE BATTERY TERMINAL

CAUTION:

Wait at least 90 seconds after disconnecting the cable from the negative (-) battery terminal to prevent airbag and seat belt pretensioner activation.

2. INSPECT INSTRUMENT PANEL JUNCTION BLOCK

NOTICE:

The circuit opening (C/OPN) relay is built into the instrument panel junction block.

- (a) Measure the resistance between the terminals.

ES

Instrument Panel Junction Block (Front View)

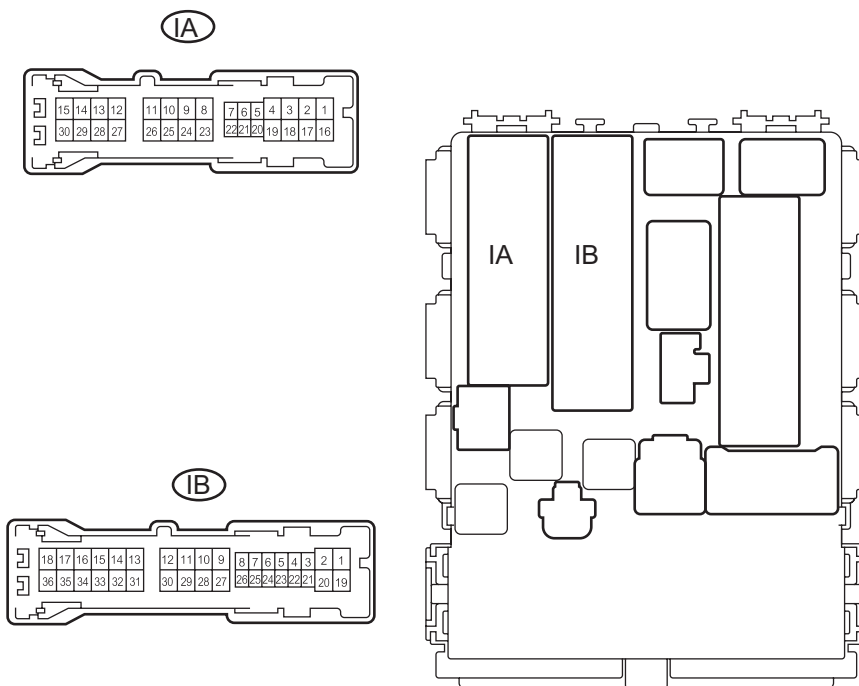

Standard resistance

Tester Connection	Specified Condition
1B-11 - 1A-8	10 k Ω or higher
1B-11 - 1A-8	Below 1 Ω (when battery voltage is applied to terminals 1E-5 and 1D-1)

If the result is not as specified, replace the instrument panel junction block.

3. CONNECT CABLE TO NEGATIVE BATTERY TERMINAL