

REMOVAL

1. **DISCONNECT CABLE FROM NEGATIVE BATTERY TERMINAL**

CAUTION:

Wait at least 90 seconds after disconnecting the cable from the negative (-) battery terminal to prevent airbag activation.

2. **REMOVE BATTERY CLAMP SUB-ASSEMBLY** (See page [ST-6](#))
3. **REMOVE BATTERY INSULATOR**
4. **REMOVE BATTERY**
5. **REMOVE NO. 1 ENGINE UNDER COVER** (See page [EM-21](#))
6. **DRAIN ENGINE COOLANT** (See page [CO-8](#))
7. **REMOVE V-BANK COVER SUB-ASSEMBLY** (See page [EM-21](#))
8. **REMOVE RADIATOR SUPPORT OPENING COVER** (See page [EM-22](#))
9. **REMOVE RADIATOR GRILLE SUB-ASSEMBLY** (See page [ET-6](#))
10. **DISCONNECT HOOD LOCK SWITCH CONNECTOR**
11. **DISCONNECT NO. 1 WATER BY-PASS HOSE**
(a) Disconnect the hose from the radiator reservoir.
12. **DISCONNECT NO. 5 WATER BY-PASS HOSE**
(a) Disconnect the hose from the radiator.
13. **REMOVE NO. 1 WATER BY-PASS PIPE**
(a) Disconnect the pipe from the No. 1 radiator hose.

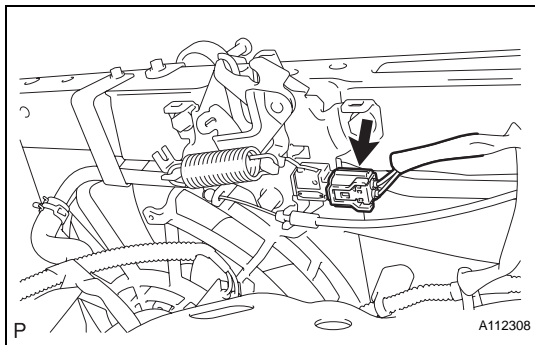

(b) Remove the 2 bolts and pipe.

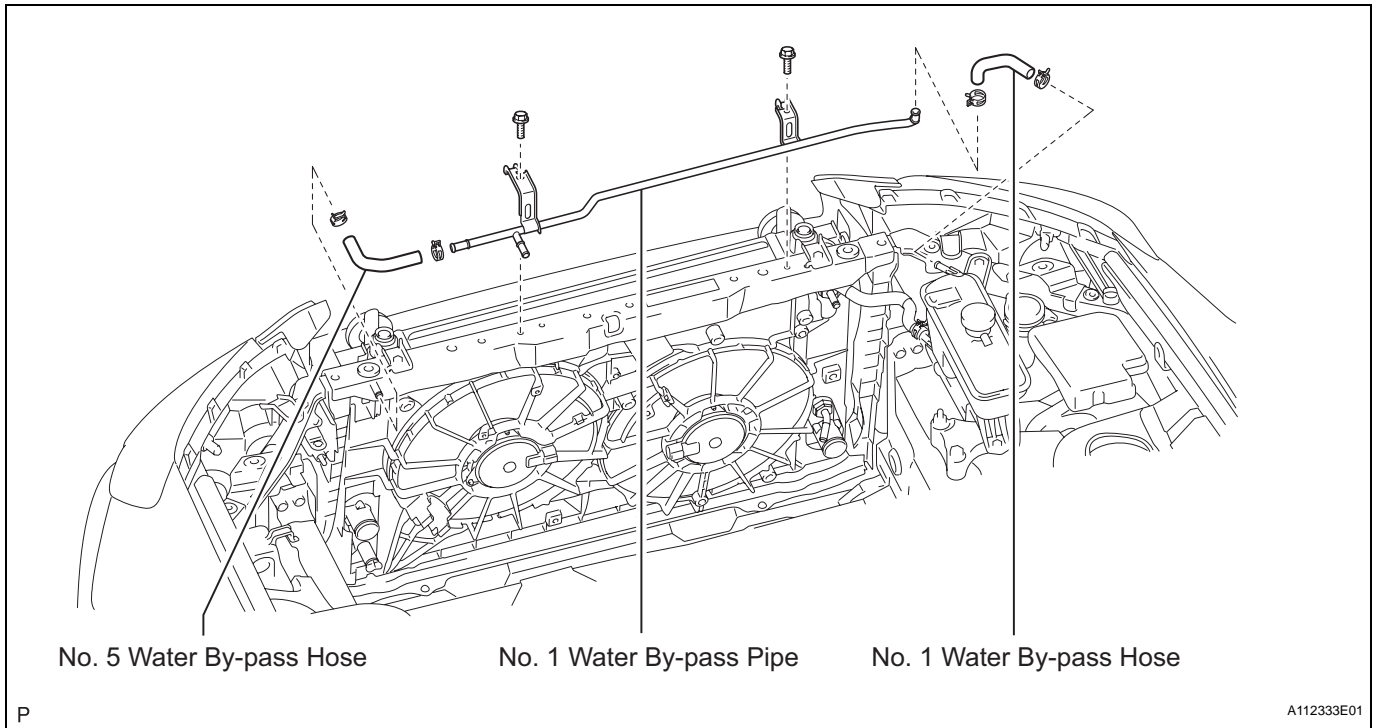

14. DISCONNECT COOLING FAN ECU HARNESS (w/o Trailer Towing System)

- (a) Disconnect the fan ECU connector.
- (b) Detach the 3 harness clamps from the fan shroud and upper radiator support.

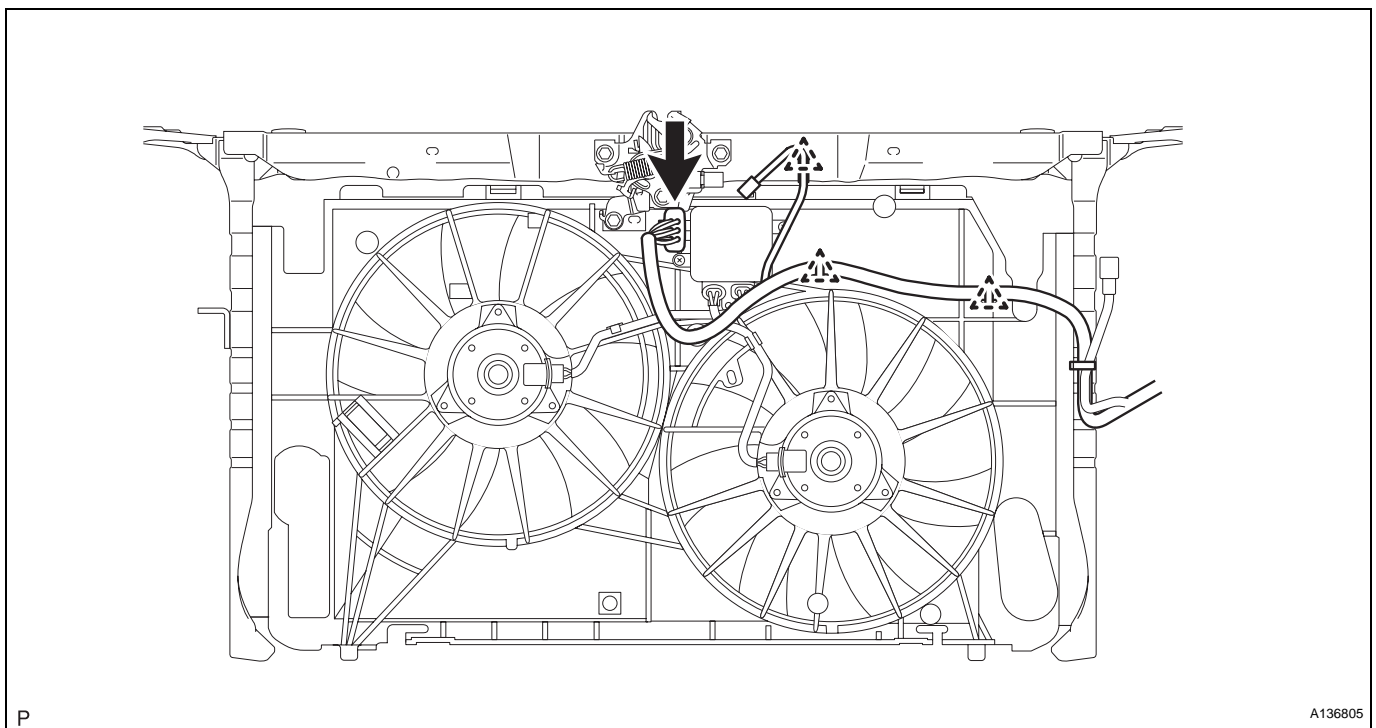

CO

15. DISCONNECT COOLING FAN ECU HARNESS (w/ Trailer Towing System)

- (a) Disconnect the 2 fan ECU connectors.

- (b) Detach the 3 harness clamps from the fan shroud and upper radiator support.

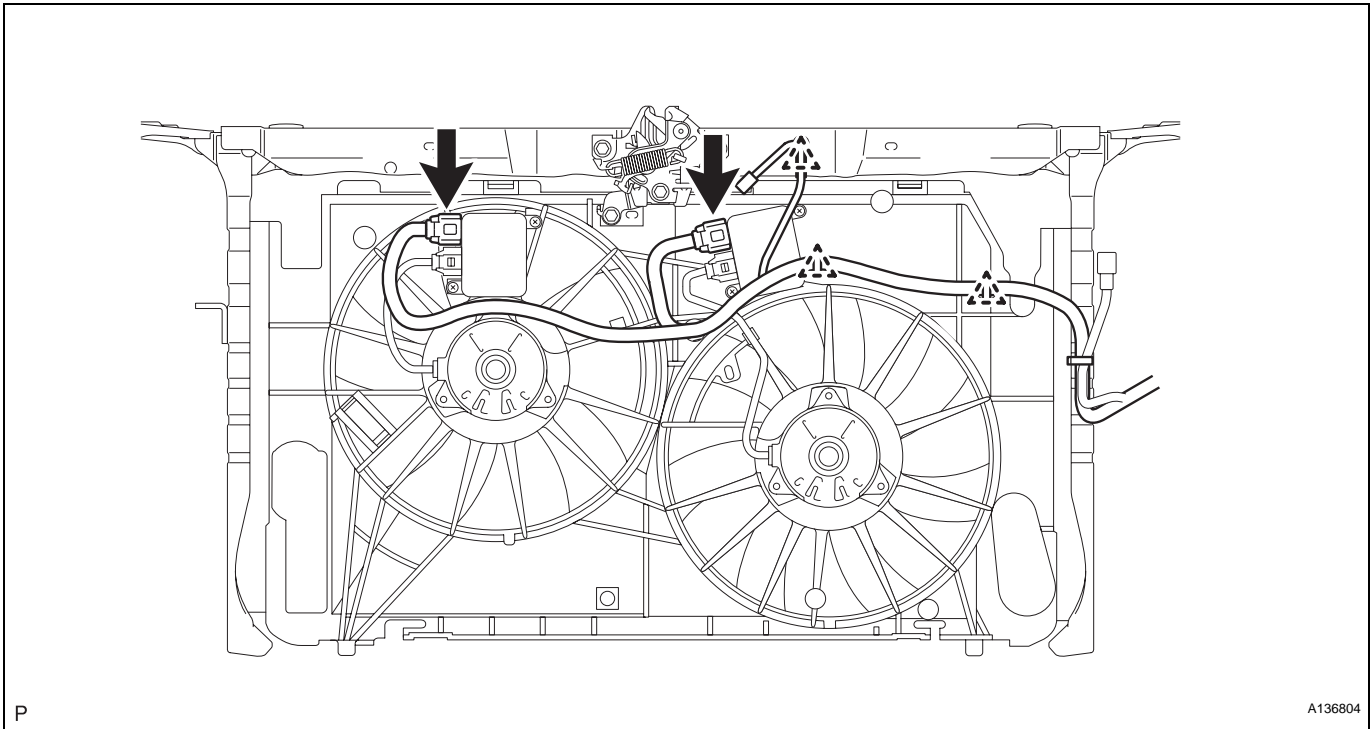

16. DISCONNECT HORN CONNECTOR

- (a) Disconnect the 2 horn connectors.

17. REMOVE UPPER RADIATOR SUPPORT BRACKET

- (a) Remove the 2 bolts and 2 upper radiator support brackets.

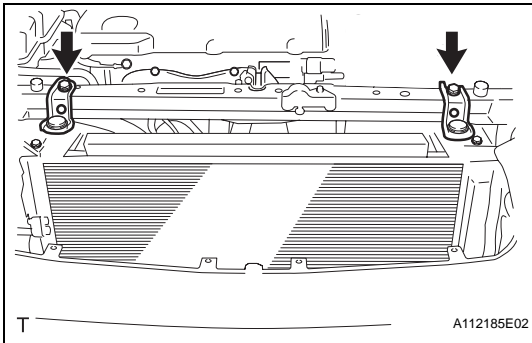

18. REMOVE NO. 2 FAN SHROUD

- (a) Remove the 2 bolts.
(b) Detach the 2 claws and No. 2 shroud.

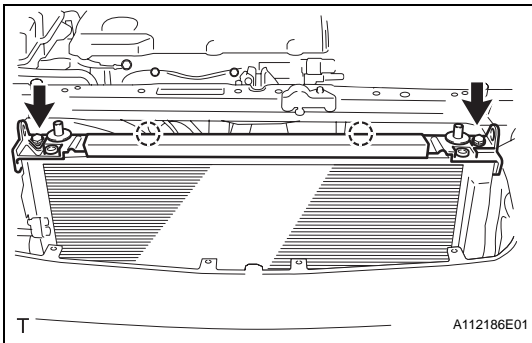

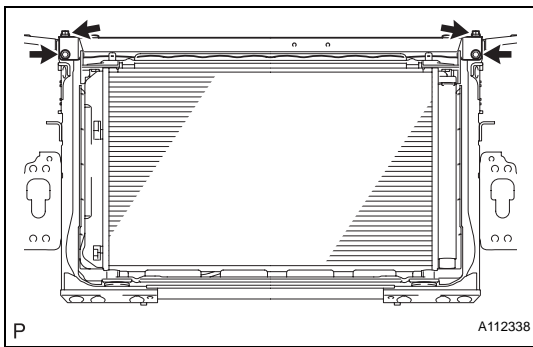

19. REMOVE UPPER RADIATOR SUPPORT SUB-ASSEMBLY

- (a) Remove the 4 bolts and upper radiator support with hood lock.

20. DISCONNECT OIL COOLER INLET HOSE

21. DISCONNECT OIL COOLER OUTLET HOSE

22. DISCONNECT NO. 1 RADIATOR HOSE

23. DISCONNECT NO. 2 RADIATOR HOSE

24. DISCONNECT NO. 2 WATER BY-PASS HOSE

- (a) Disconnect the by-pass hose from the radiator reservoir and radiator.

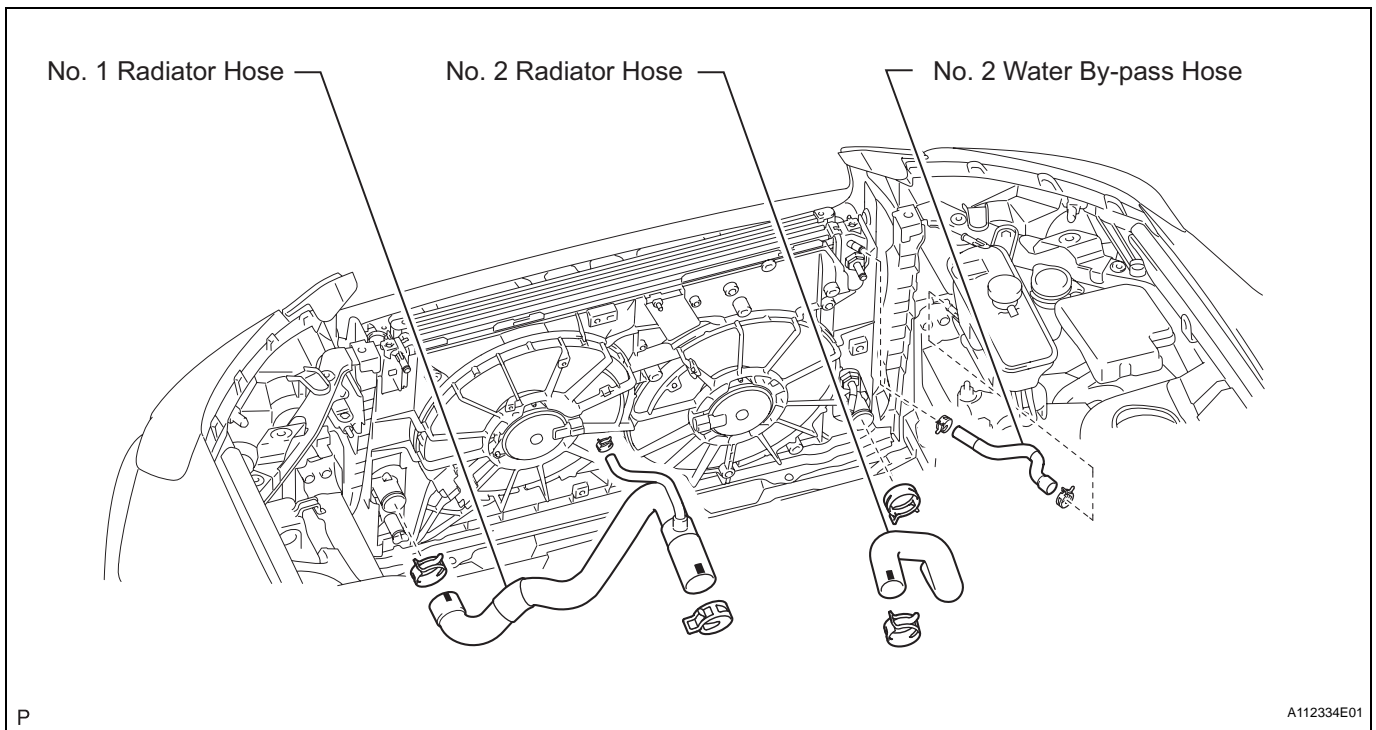

25. REMOVE RADIATOR ASSEMBLY

- (a) Detach the cooler condenser from the radiator.

HINT:

After detaching the condenser, make sure that all 4 fan shroud cushions are present.

- (b) Remove the radiator with the 2 radiator support lower cushions.

HINT:

After detaching the radiator, make sure that all 2 radiator support lowers are present.

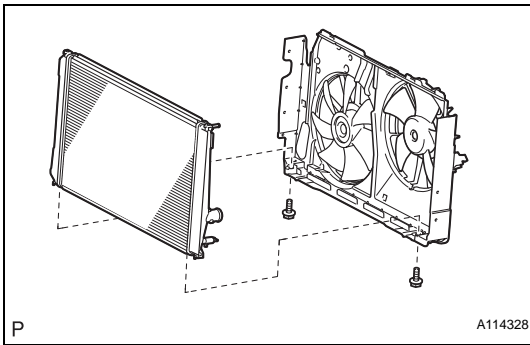

26. REMOVE FAN SHROUD WITH COOLING FAN

- (a) Remove the 2 bolts and fan shroud with cooling fan from the radiator.

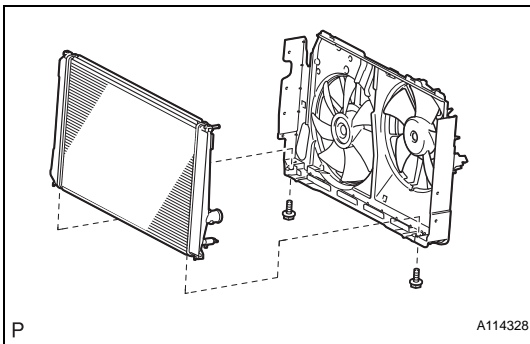

INSTALLATION

1. INSTALL FAN SHROUD WITH COOLING FAN

- (a) Install the fan shroud with cooling fan to the radiator with the 2 bolts.

Torque: 10.5 N*m (107 kgf*cm, 8 ft.*lbf)

2. INSTALL RADIATOR ASSEMBLY

- (a) Install the 4 fan shroud cushions to the cooler condenser.

- (b) Set the cooler condenser into the fan shroud.

- (c) Install the 2 radiator support lower cushions to the fan shroud.

- (d) Install the radiator with cooler condenser and fan shroud to the radiator support lowers.

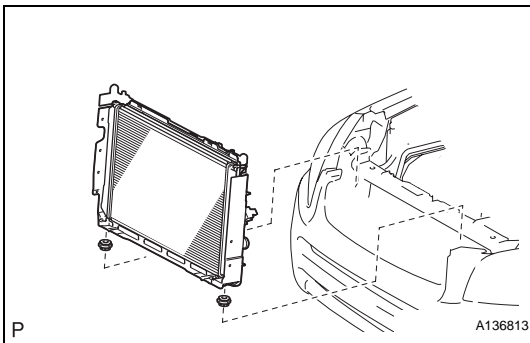

3. INSTALL UPPER RADIATOR SUPPORT SUB-ASSEMBLY

- (a) Install the upper radiator support with the 4 bolts.

Torque: 29 N*m (296 kgf*cm, 21 ft.*lbf)

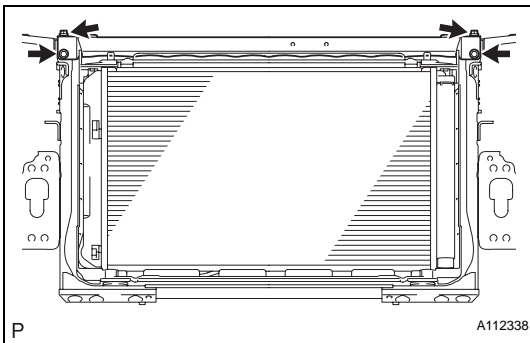

4. INSTALL NO. 2 FAN SHROUD

- (a) Attach the 2 claws to install the No. 2 fan shroud, and install the 2 bolts.

Torque: 10.5 N*m (107 kgf*cm, 8 ft.*lbf)

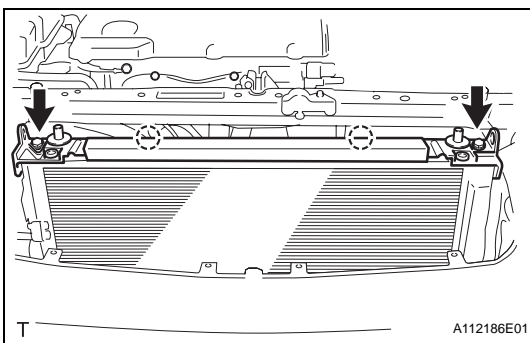

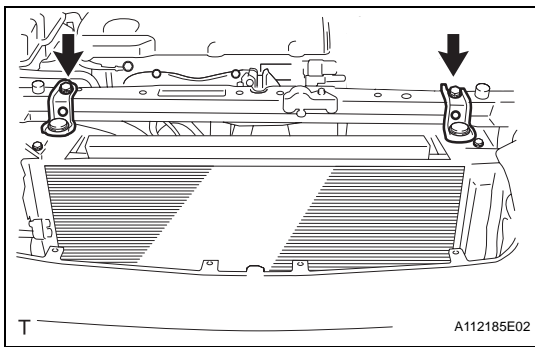

5. **INSTALL UPPER RADIATOR SUPPORT BRACKET**
 - (a) Install the brackets with the 2 bolts.
Torque: 19 N*m (194 kgf*cm, 14 ft.*lbf)
6. **CONNECT HORN CONNECTOR**
 - (a) Connect the 2 horn connectors.
7. **CONNECT NO. 2 WATER BY-PASS HOSE**
 - (a) Connect the by-pass hose to the radiator and radiator reservoir.
HINT:
The direction of the hose clamp is indicated in the illustration.
8. **CONNECT NO. 2 RADIATOR HOSE**
 - HINT:
The direction of the hose clamp is indicated in the illustration.
9. **CONNECT NO. 1 RADIATOR HOSE**
 - HINT:
The direction of the hose clamp is indicated in the illustration.

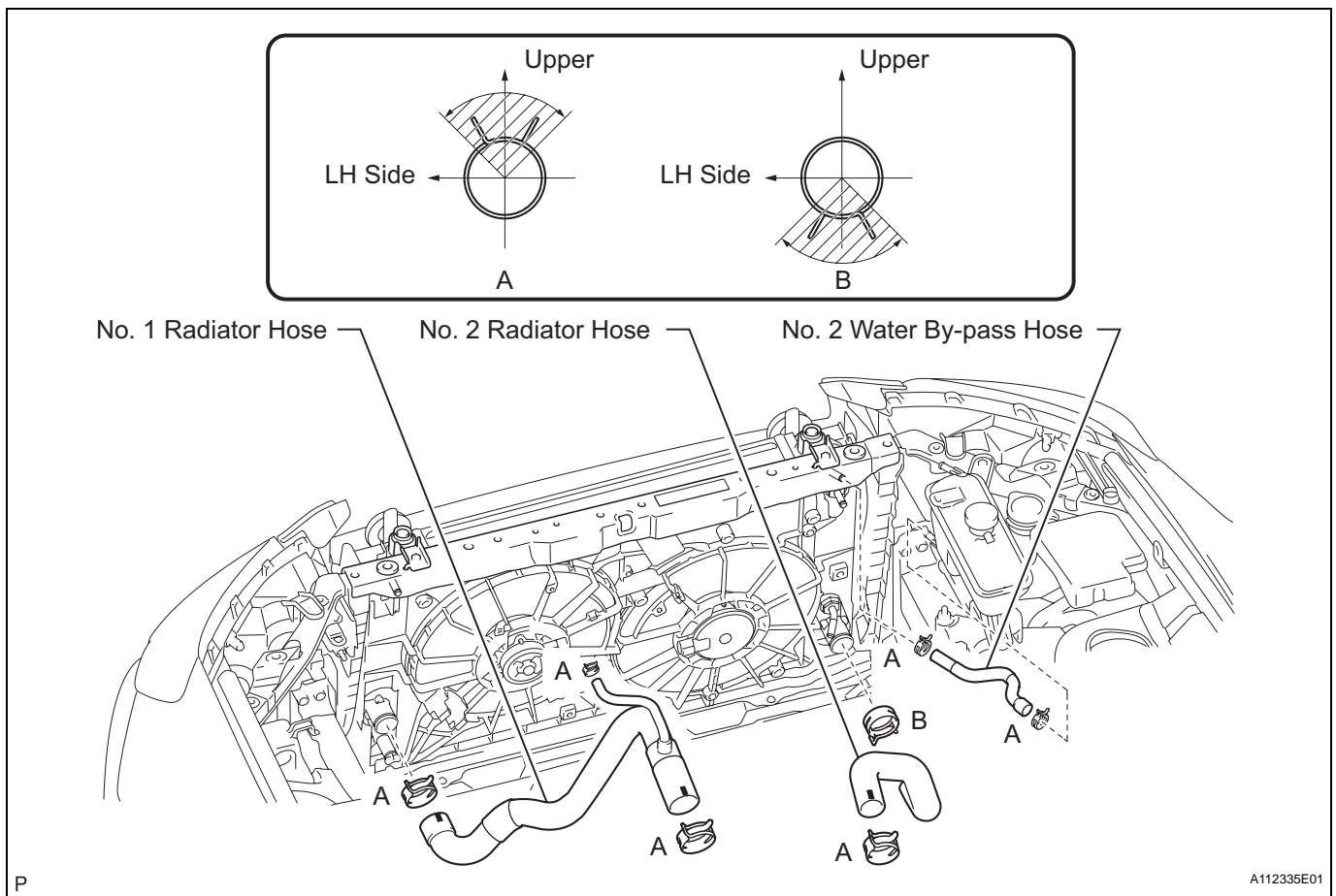

10. **CONNECT OIL COOLER OUTLET HOSE**
11. **CONNECT OIL COOLER INLET HOSE**
12. **CONNECT COOLING FAN ECU HARNESS (w/ Trailer Towing System)**
 - (a) Attach the harness with the 3 clamps.

(b) Connect the 2 fan ECU connectors.

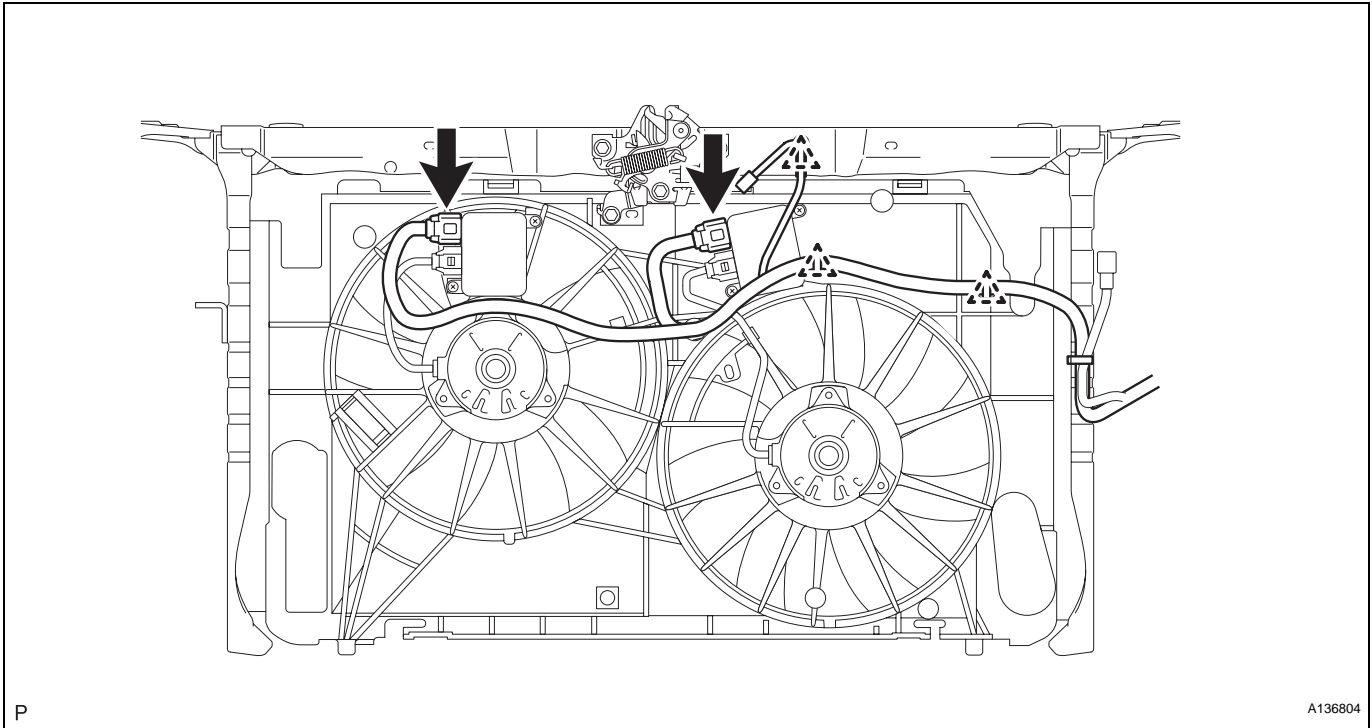

13. CONNECT COOLING FAN ECU HARNESS (w/o Trailer Towing System)

- (a) Attach the harness with the 3 clamps.
- (b) Connect the fan ECU connector.

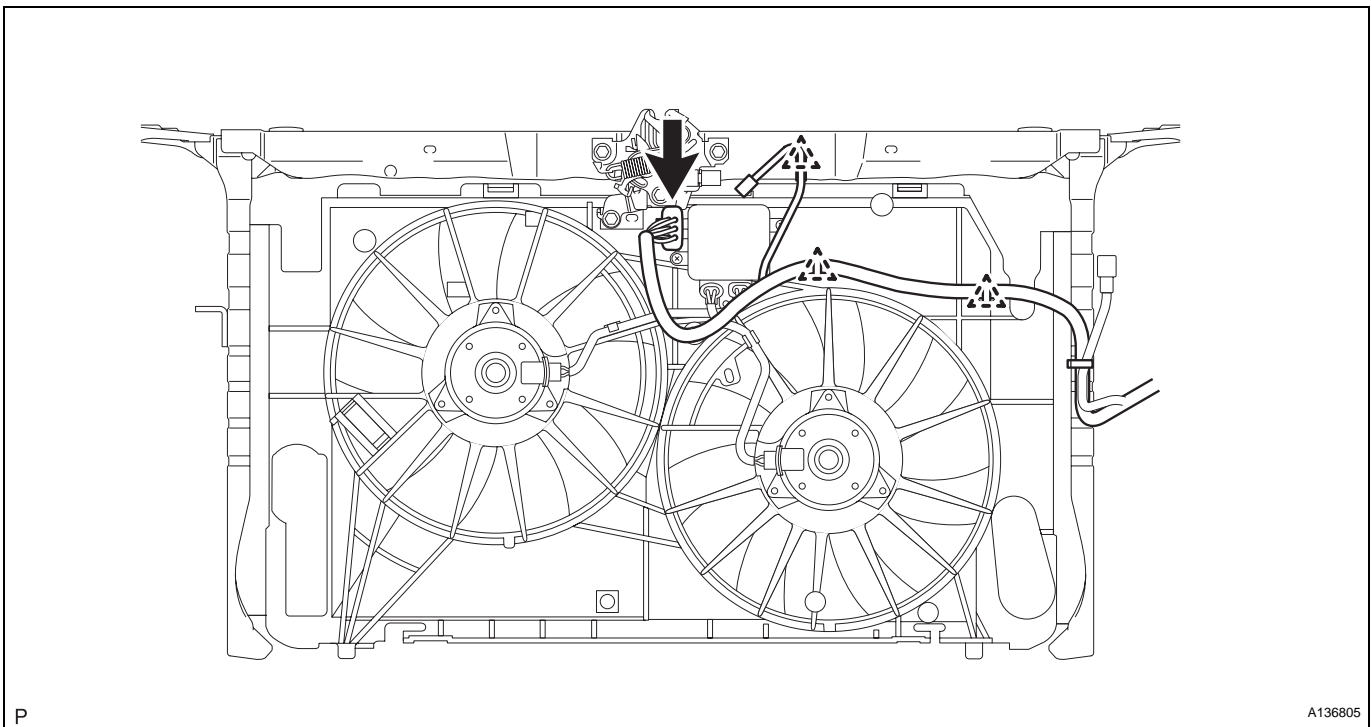

14. INSTALL NO. 1 WATER BY-PASS PIPE

- (a) Install the by-pass pipe with the 2 bolts to the upper radiator support.
Torque: 5.0 N*m (51 kgf*cm, 44 in.*lbf)
- (b) Connect the No. 1 radiator hose to the pipe.

15. CONNECT NO. 5 WATER BY-PASS HOSE

(a) Connect the by-pass hose to the radiator.

16. CONNECT NO. 1 WATER BY-PASS HOSE

(a) Connect the by-pass hose to the radiator reservoir.

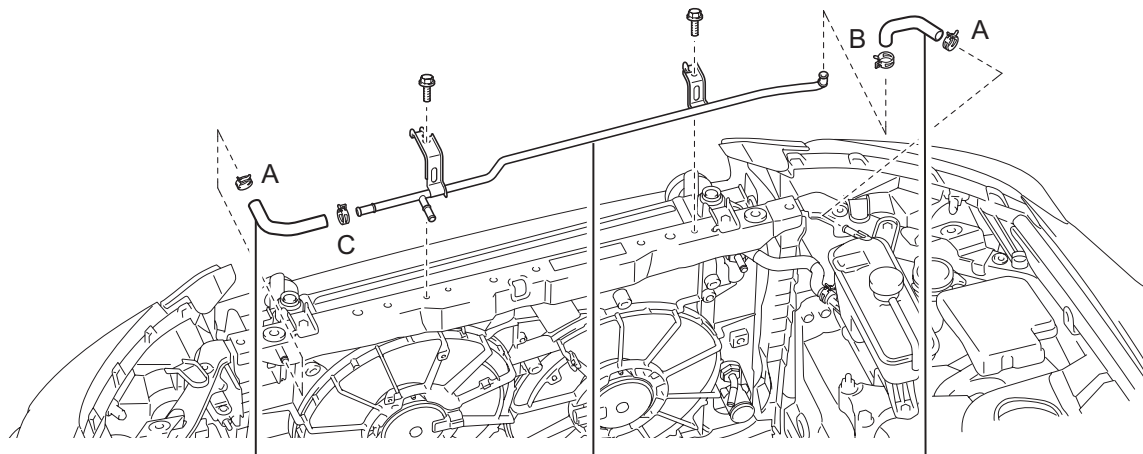
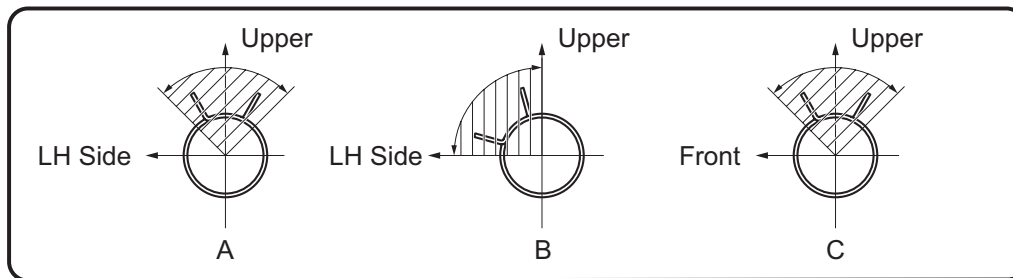

No. 5 Water By-pass Hose No. 1 Water By-pass Pipe No. 1 Water By-pass Hose

A114367E03

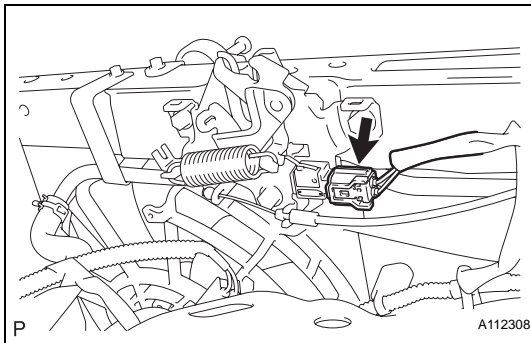
**17. CONNECT HOOD LOCK SWITCH CONNECTOR****18. INSTALL RADIATOR GRILLE SUB-ASSEMBLY** (See page [ET-10](#))**19. INSTALL BATTERY****20. INSTALL BATTERY INSULATOR****21. INSTALL BATTERY CLAMP SUB-ASSEMBLY** (See page [ST-15](#))**22. CONNECT CABLE TO NEGATIVE BATTERY TERMINAL****23. INSTALL RADIATOR SUPPORT OPENING COVER** (See page [EM-42](#))**24. INSTALL V-BANK COVER SUB-ASSEMBLY** (See page [EM-42](#))**25. ADD ENGINE COOLANT** (See page [CO-8](#))**26. CHECK FOR ENGINE COOLANT LEAKS** (See page [CO-1](#))

27. INSTALL NO. 1 ENGINE UNDER COVER (See page [EM-41](#))