

# OIL PUMP COMPONENTS

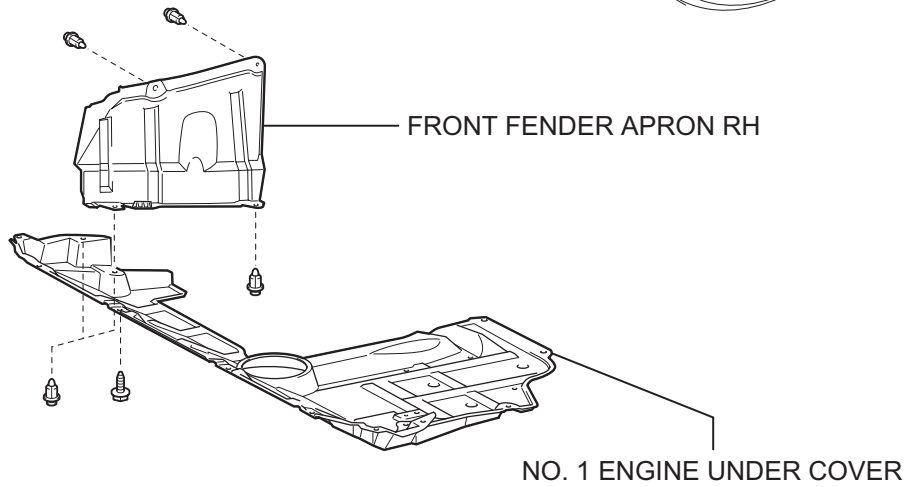
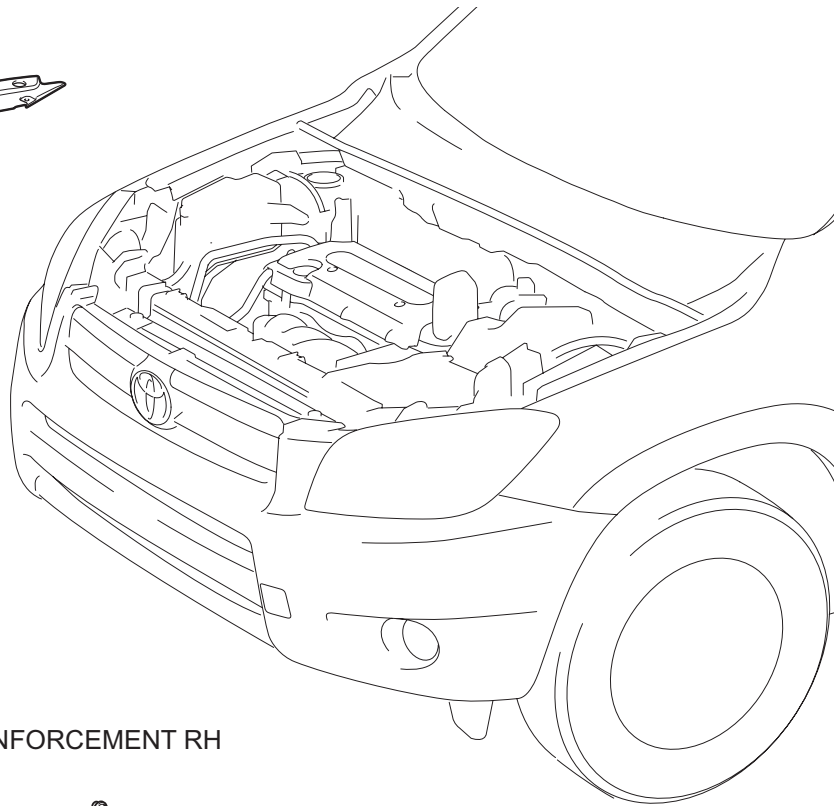
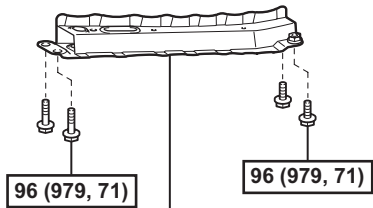
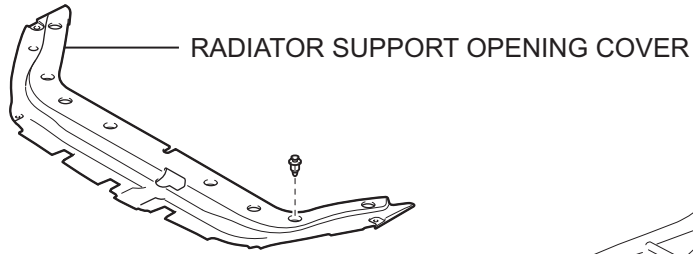

**N\*m (kgf\*cm, ft.\*lbf)** : Specified torque

LU

5.0 (51, 44 in.\*lbf)

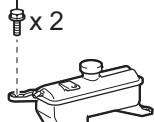

RADIATOR RESERVOIR

FAN AND GENERATOR V BELT

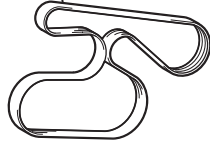

7.0 (71, 62 in.\*lbf)

x 2

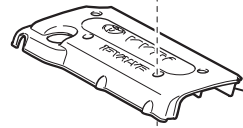

NO. 1 ENGINE COVER

60 (612, 44)

x 2



IDLER PULLEY ASSEMBLY

95 (969, 70)

x 4

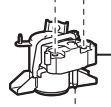

ENGINE MOUNTING INSULATOR RH

52 (530, 38)



8.4 (86, 74 in.\*lbf)



9.8 (100, 7)



HEATED OXYGEN SENSOR CONNECTOR



52 (530, 38)



21 (215, 15)



GENERATOR ASSEMBLY

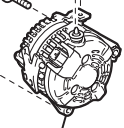

GASKET



FRONT EXHAUST PIPE



GASKET



43 (438, 32)



43 (438, 32)



x 2

43 (438, 32)

N\*m (kgf\*cm, ft.\*lbf) : Specified torque

● Non-reusable part

LU

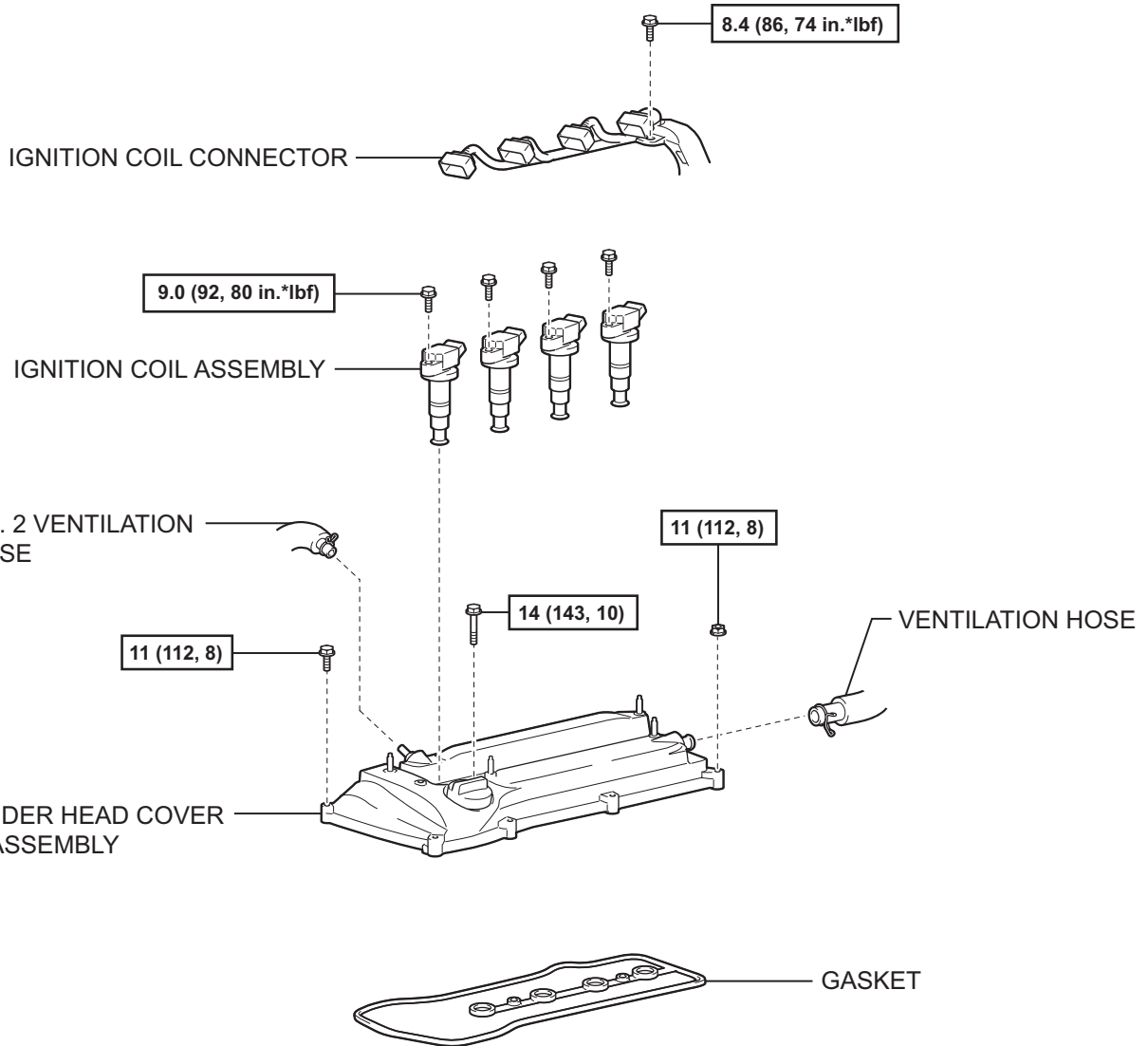

**N\*m (kgf\*cm, ft.\*lbf)** : Specified torque

LU

NO. 1 CHAIN TENSIONER ASSEMBLY

GASKET

9.0 (92, 80 in.\*lbf)

11 (112, 8)

11 (112, 8)

55 (561, 41)

ENGINE MOUNTING BRACKET RH

55 (561, 41)

55 (561, 41)

59.5 (607, 44)

9.0 (92, 80 in.\*lbf)

21.5 (219, 16)

TIMING CHAIN COVER SUB-ASSEMBLY

V-RIBBED BELT TENSIONER ASSEMBLY

180 (1,835, 133)

CRANKSHAFT PULLEY

TIMING CHAIN COVER OIL SEAL

25 (255, 18)

9.0 (92, 80 in.\*lbf)

x 8

9.0 (92, 80 in.\*lbf)

CRANKSHAFT POSITION SENSOR

N\*m (kgf\*cm, ft.\*lbf) : Specified torque

● Non-reusable part

LU

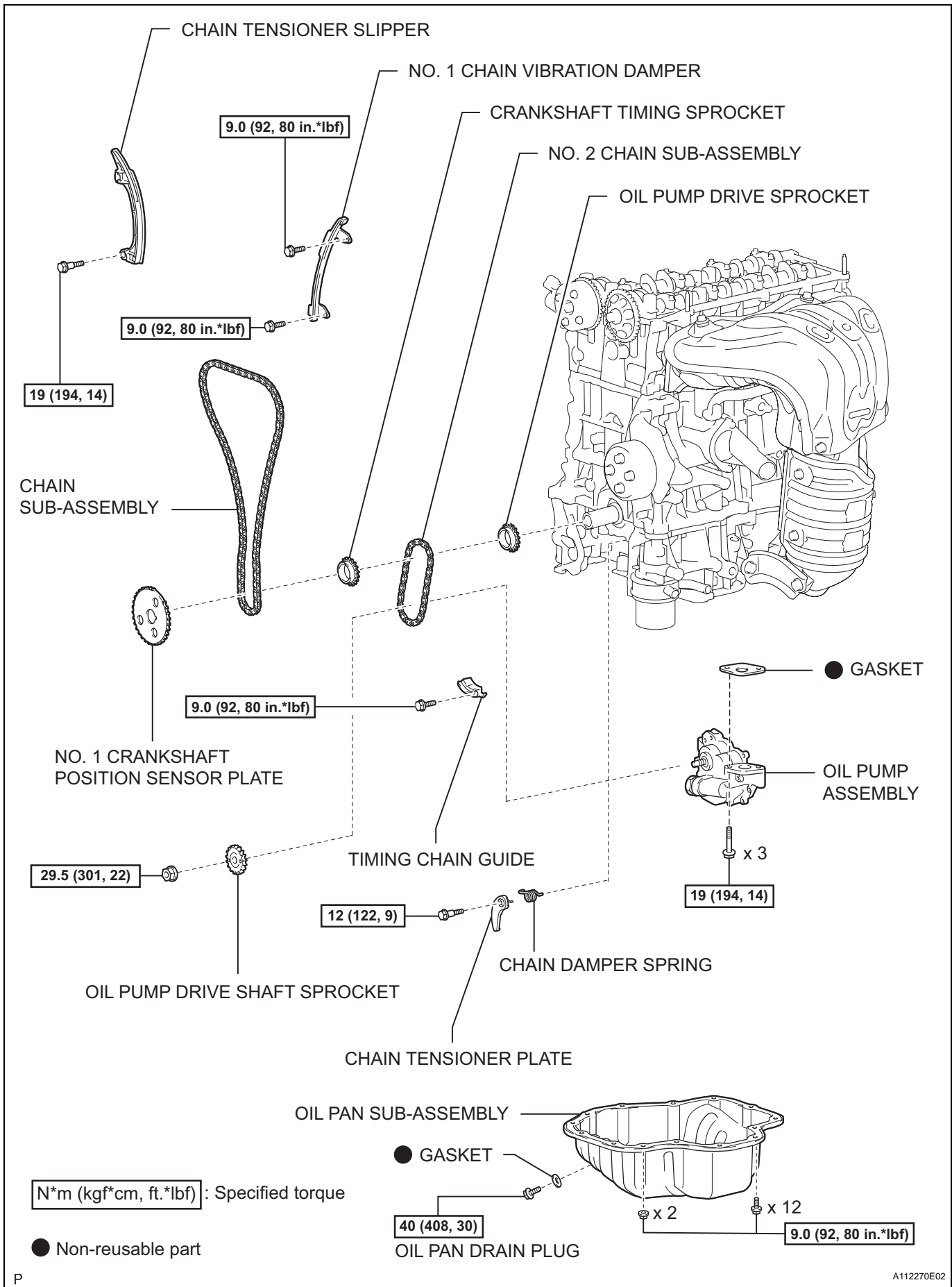

LU

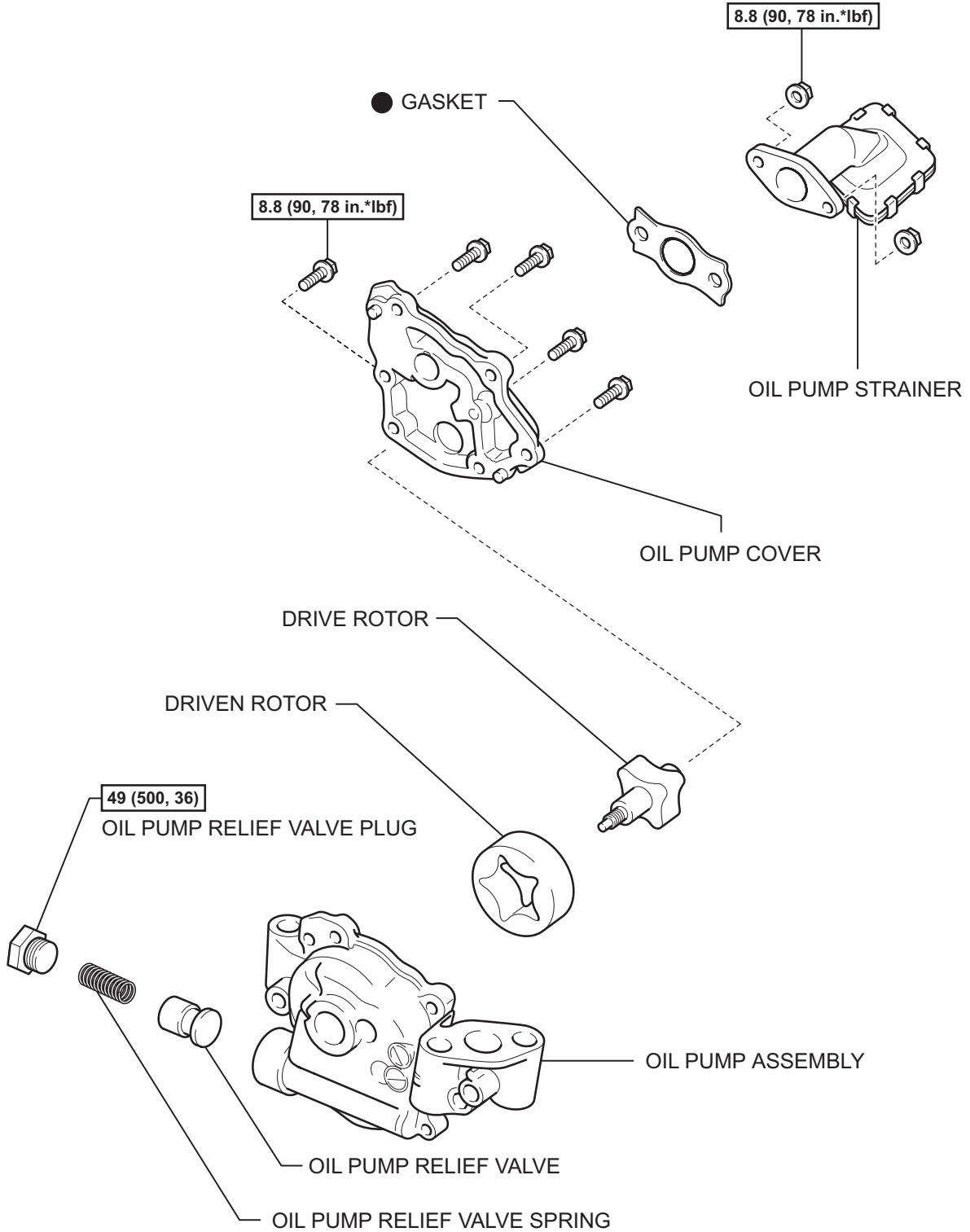

**N\*m (kgf\*cm, ft.\*lbf)** : Specified torque

● Non-reusable part

T

LU