

ENGINE UNIT

COMPONENTS

EM

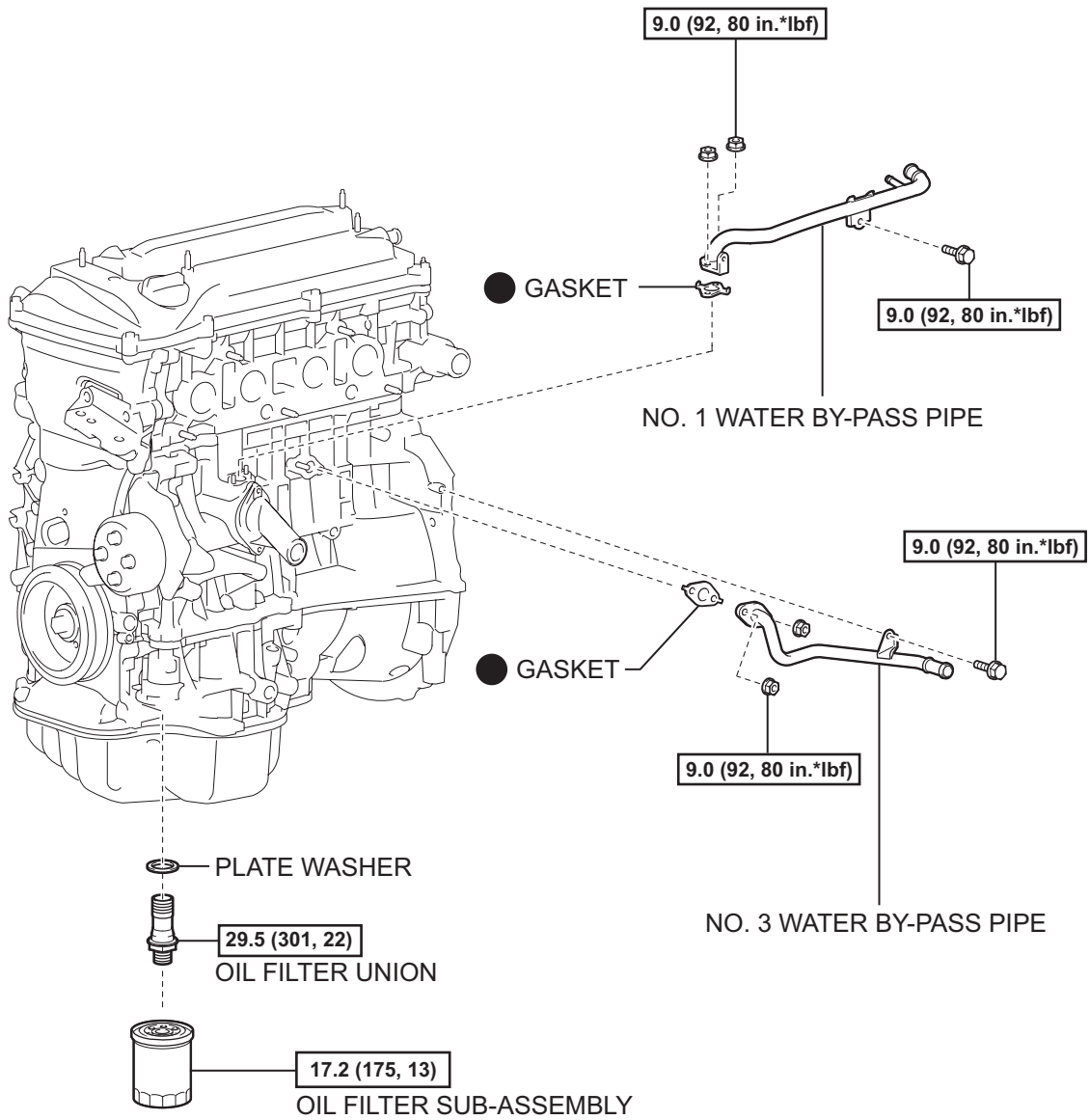

$N*m$ (kgf*cm, ft.*lbf) : Specified torque

● Non-reusable part

EM

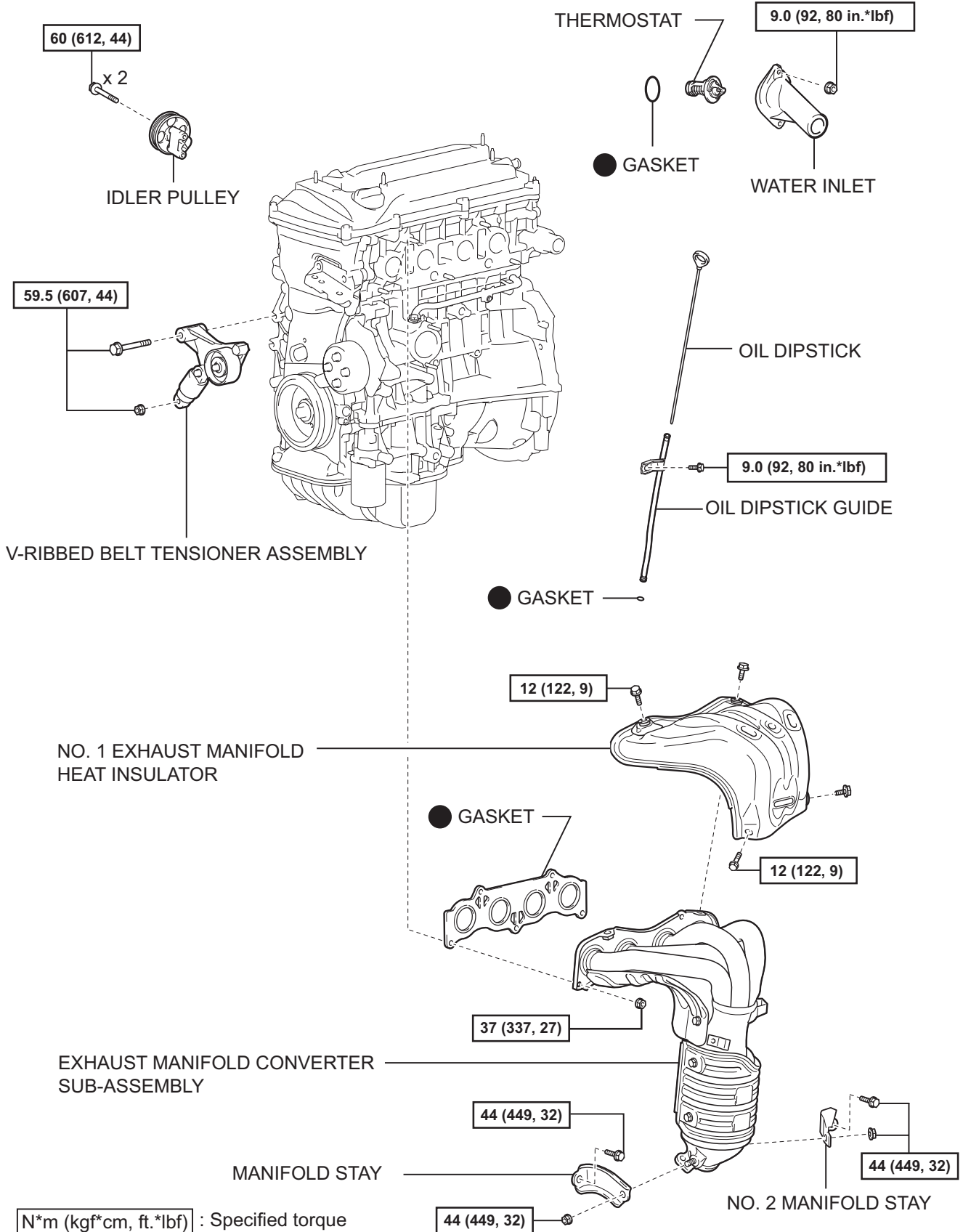

N*m (kgf*cm, ft.*lbf) : Specified torque

● Non-reusable part

EM

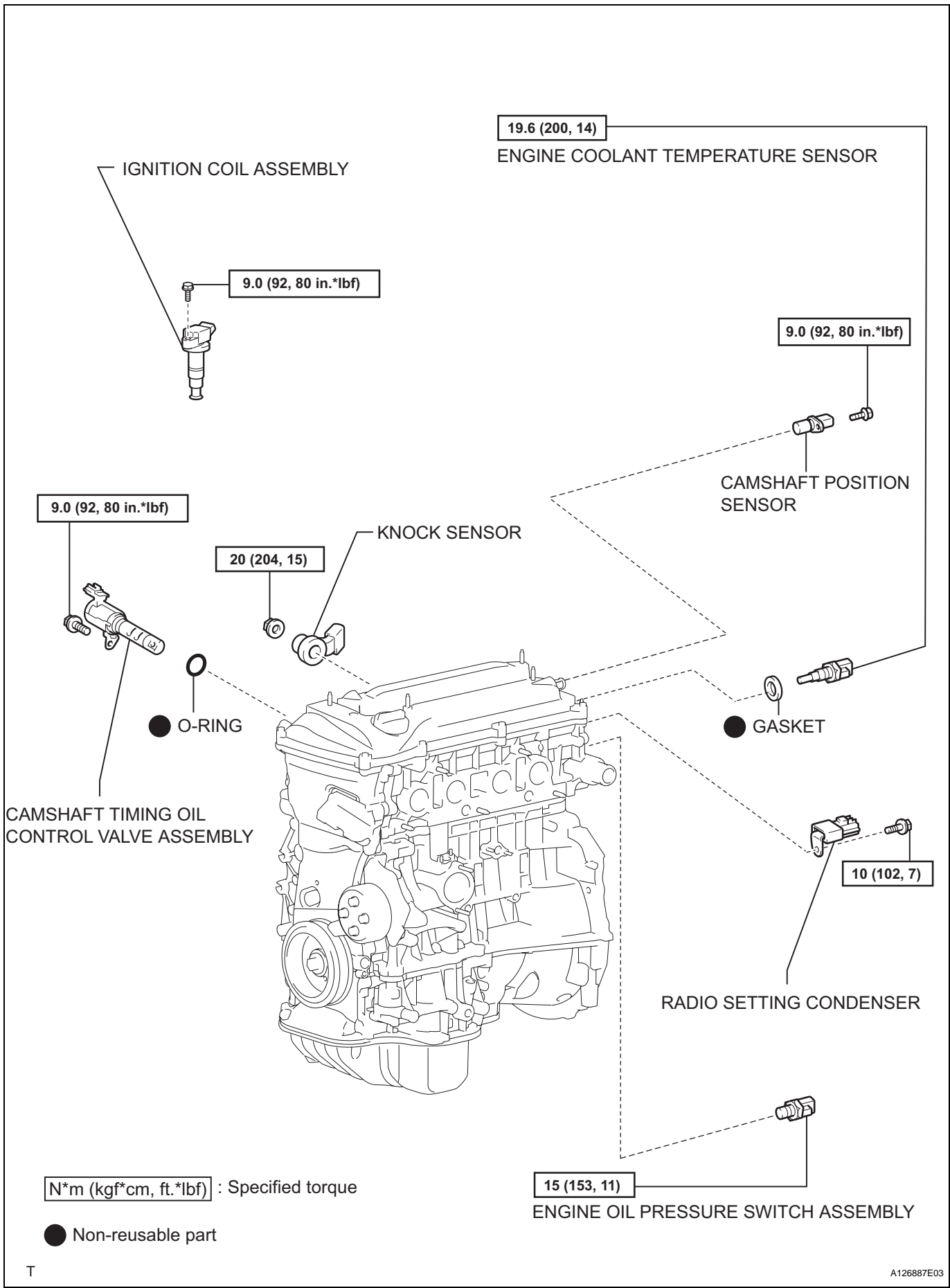

EM

3.0 (31, 26 in.*lbf)
OIL FILLER CAP SUB-ASSEMBLY

OIL FILLER CAP GASKET

14 (143, 10)
x 2

19 (194, 14)
VENTILATION VALVE
SUB-ASSEMBLY

11 (112, 8)
x 6

11 (112, 8)
x 2

CYLINDER HEAD COVER
SUB-ASSEMBLY

CYLINDER HEAD COVER
GASKET

25 (255, 18)
SPARK PLUG

43 (438, 32)

55 (561, 41)

ENGINE MOUNTING BRACKET RH

N*m (kgf*cm, ft.*lbf) : Specified torque

T

EM

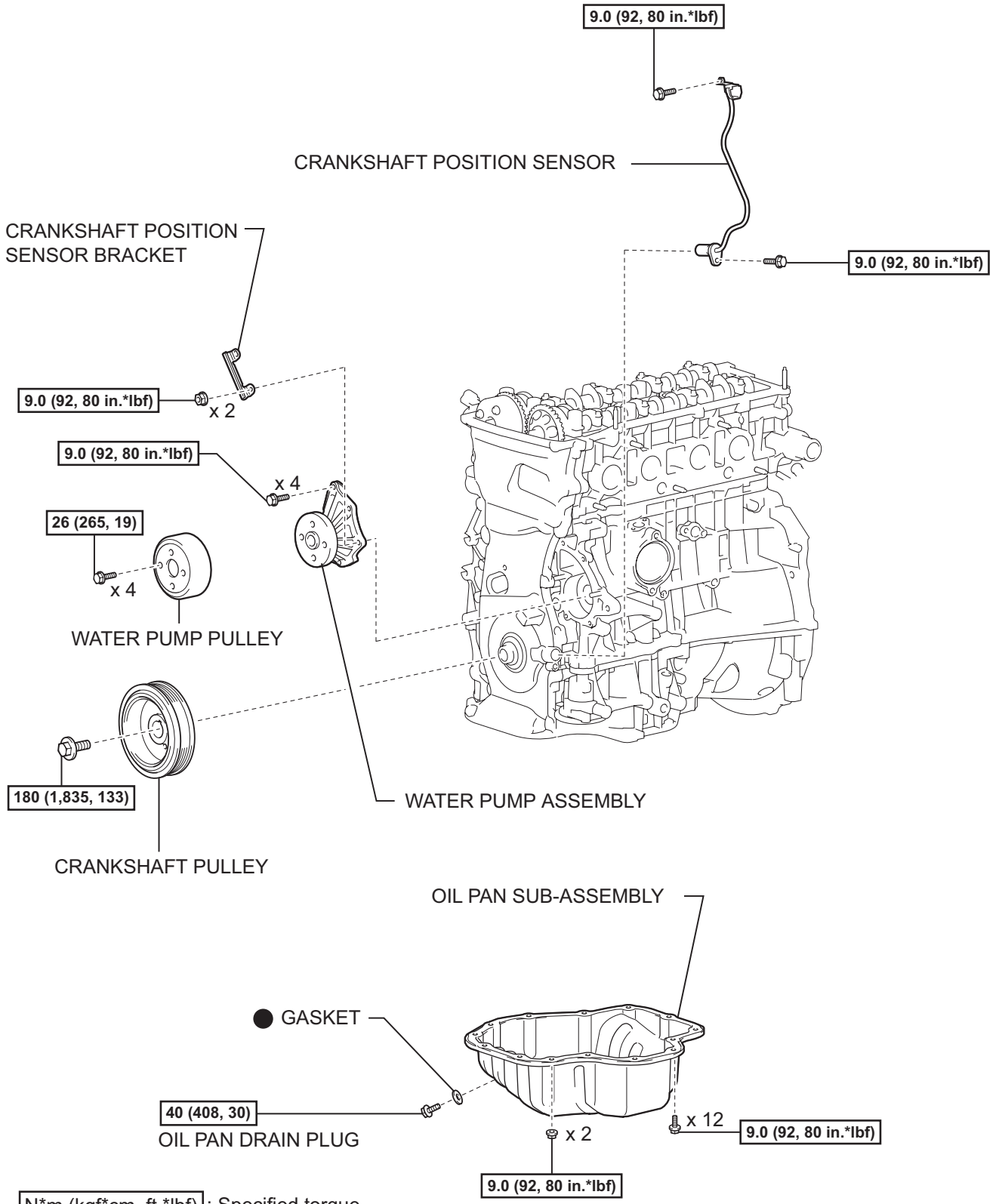

N*m (kgf*cm, ft.*lbf) : Specified torque

● Non-reusable part

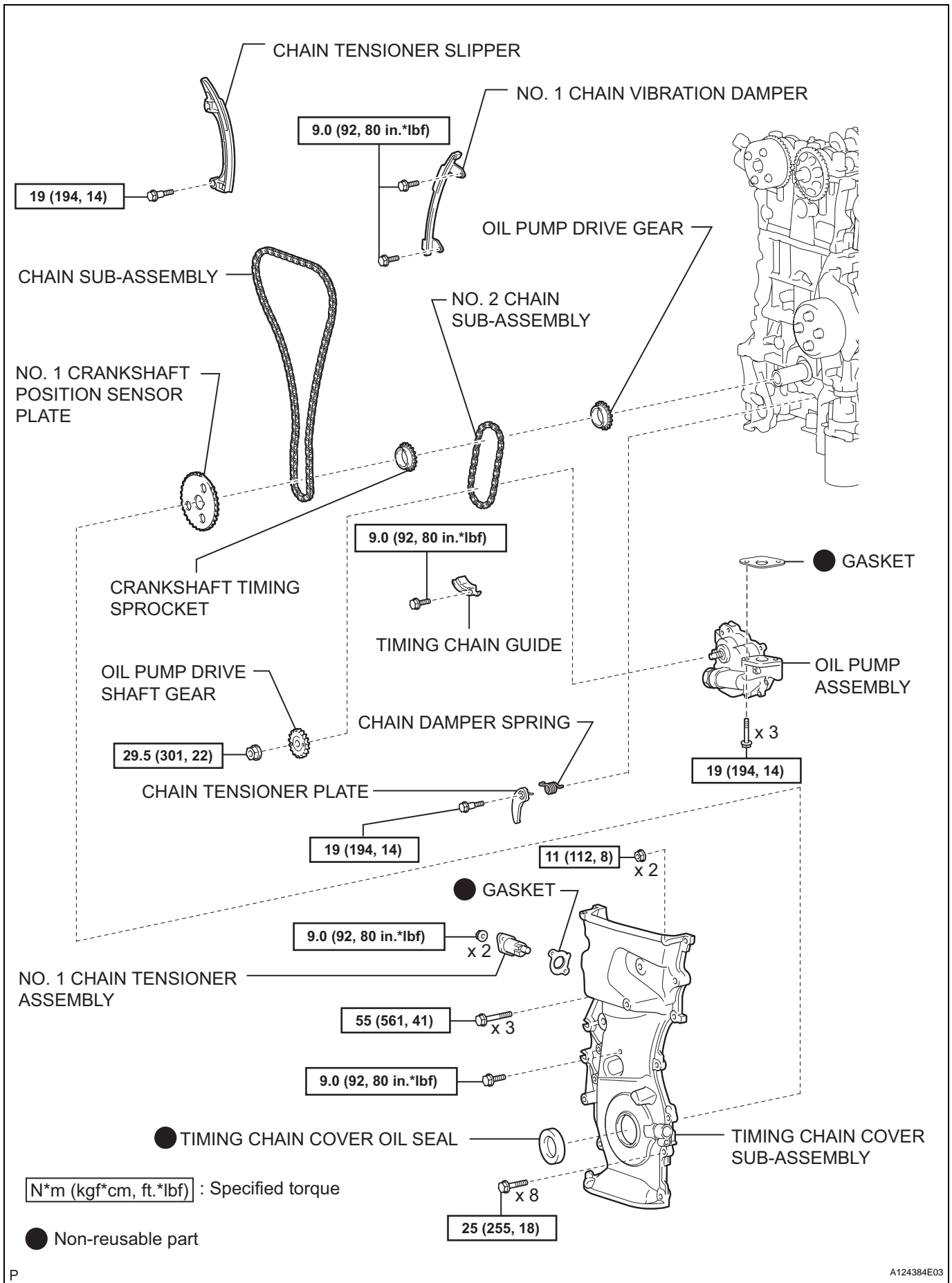

EM

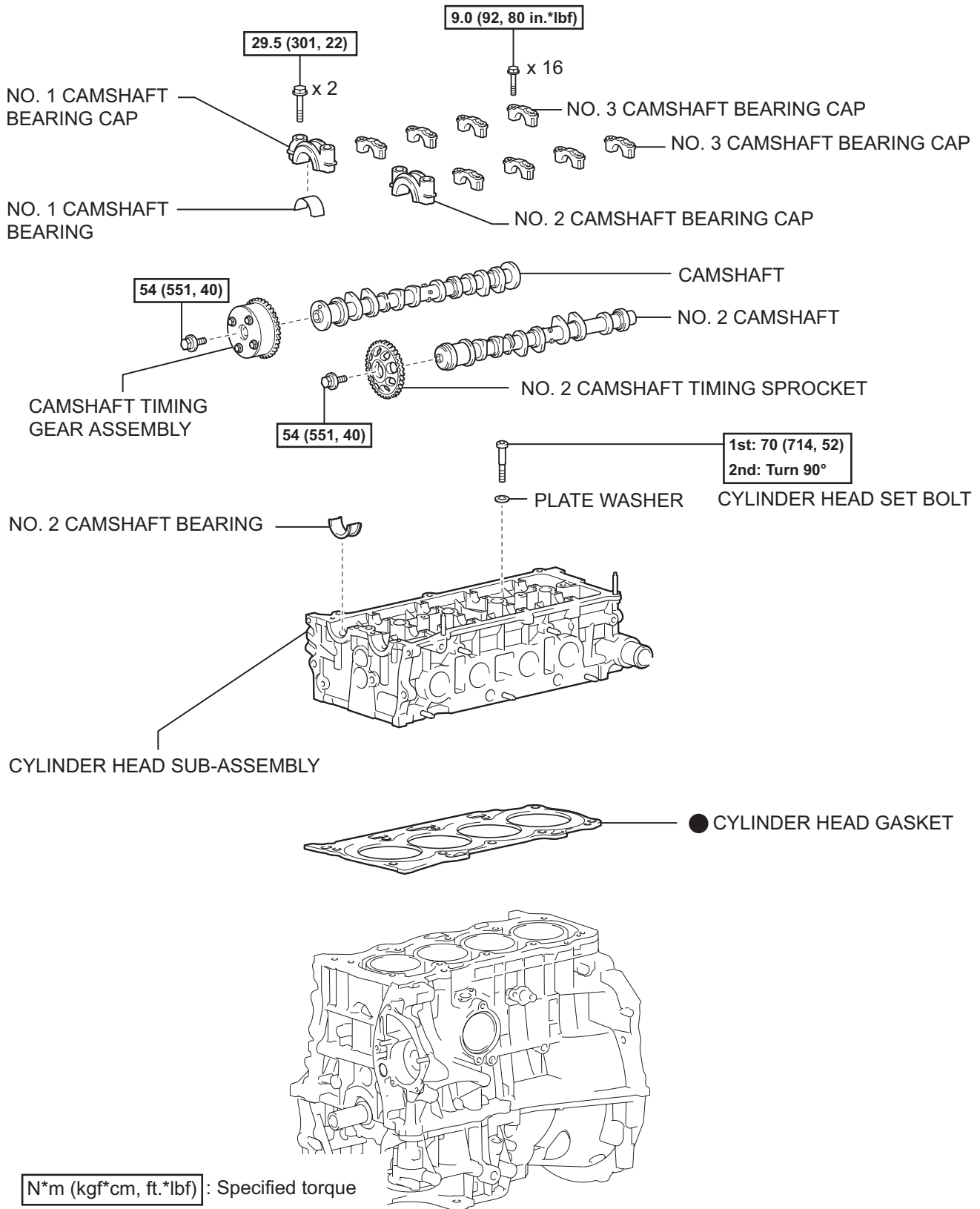

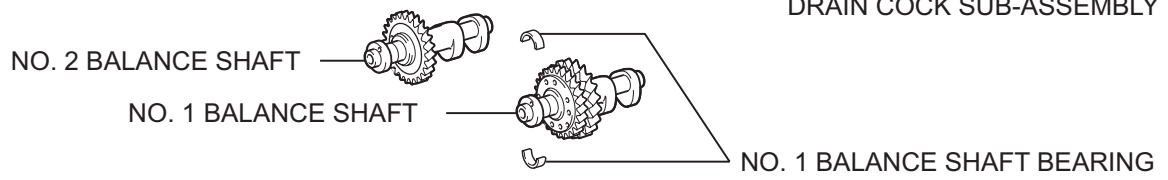
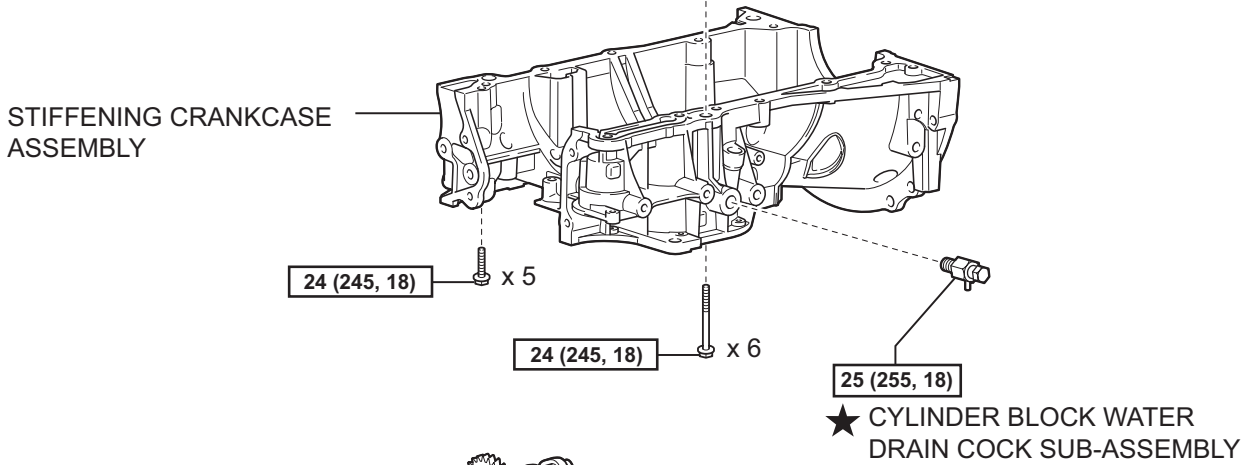
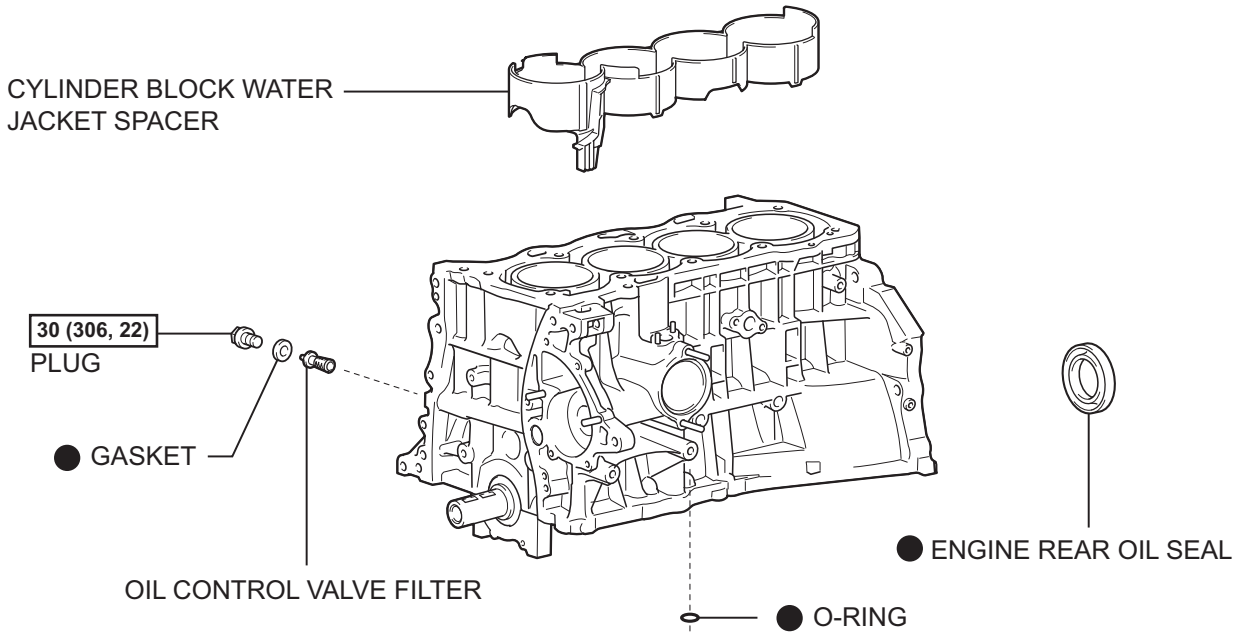

N*m (kgf*cm, ft.*lbf) : Specified torque

● Non-reusable part

★ Precoated part

1st: 21.6 (220, 16)
2nd: Turn 90°

BALANCE SHAFT HOUSING BOLT

EM

EM

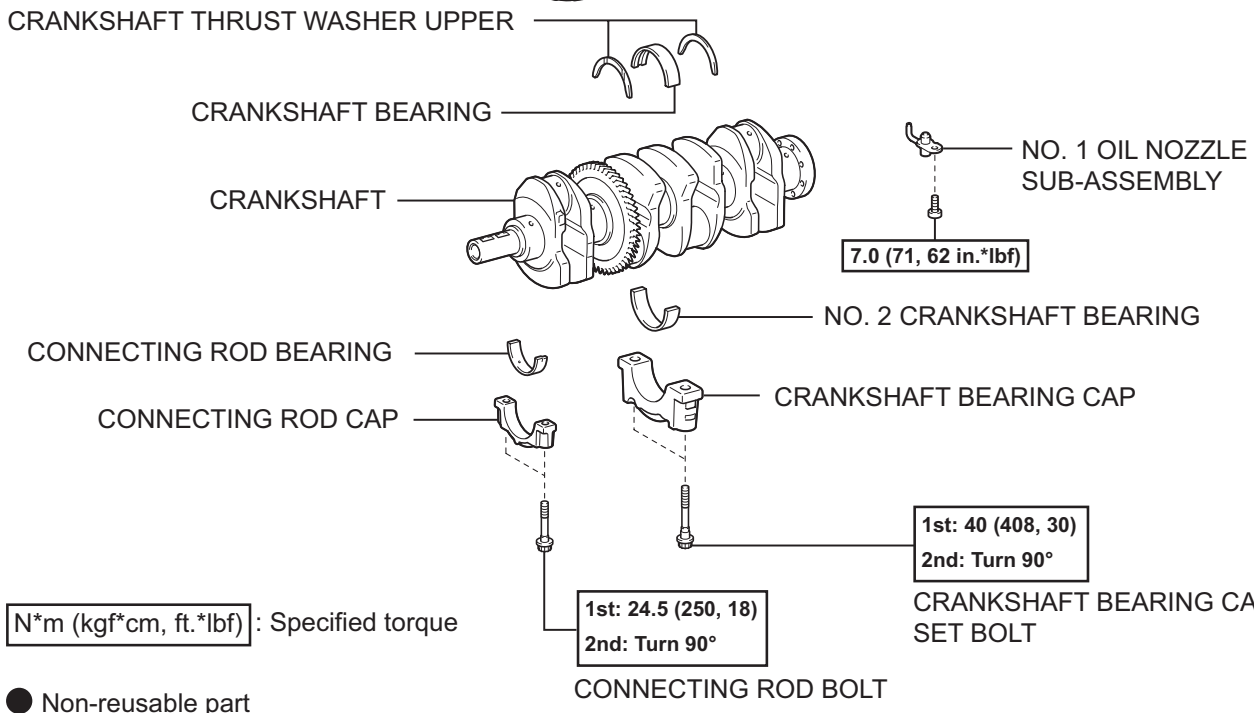
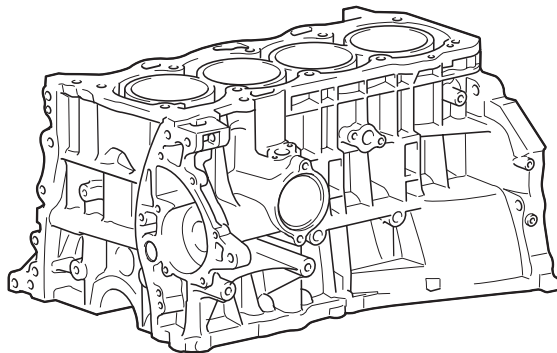
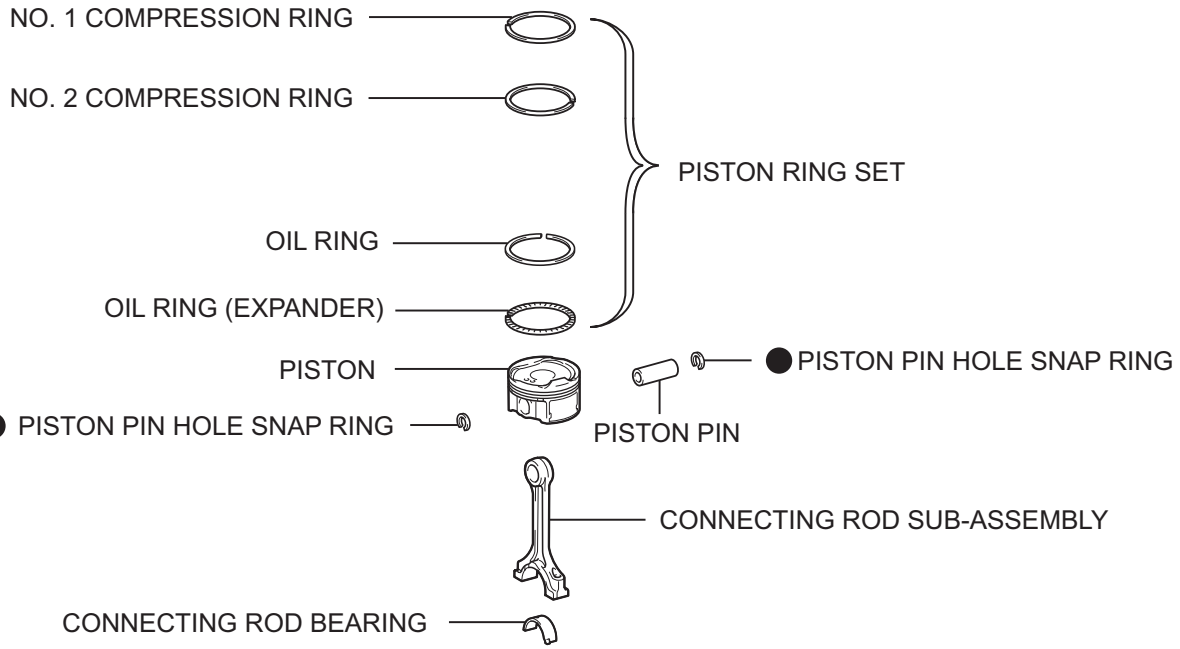

N*m (kgf*cm, ft.*lbf) : Specified torque

● Non-reusable part