

- (i) Remove the gasket from the intake manifold.

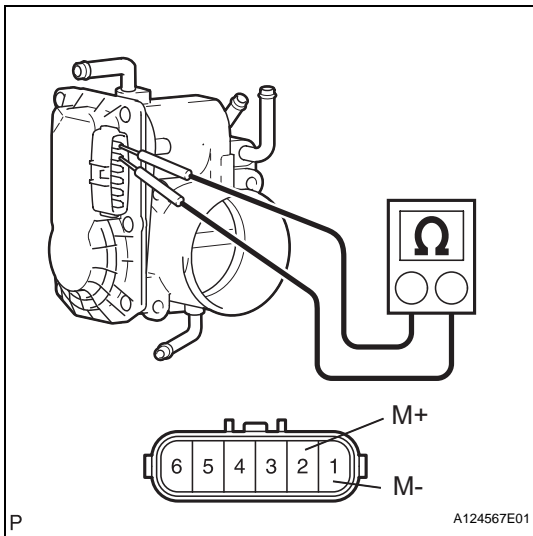

INSPECTION

1. INSPECT THROTTLE BODY

- (a) Measure the resistance of the throttle control motor.

Standard resistance

Tester Connection	Specified Condition
1 (M-) - 2 (M+)	0.3 to 100 Ω at 20°C (68°F)

If the result is not as specified, replace the throttle body.

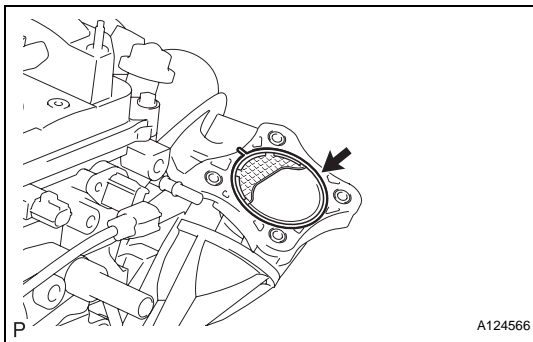

INSTALLATION

1. INSTALL THROTTLE BODY

- (a) Install a new gasket onto the intake manifold.

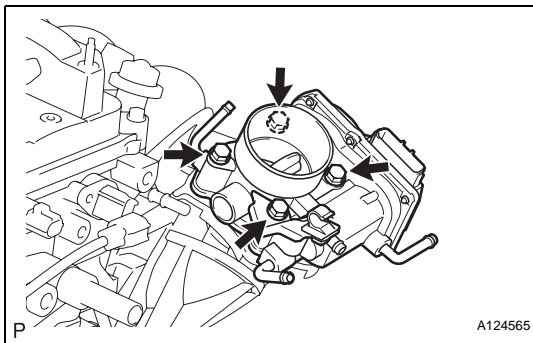

- (b) Install the throttle body and fuel pipe clamp with the 4 bolts.

Torque: 30 N*m (305 kgf*cm, 22 ft.*lbf)

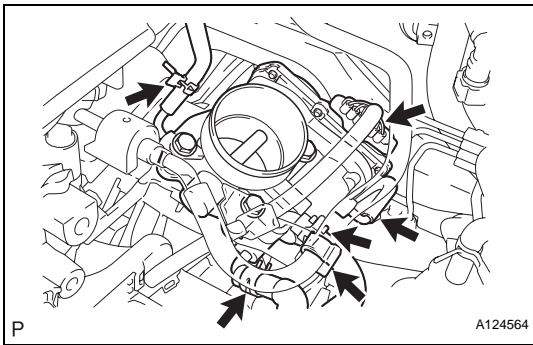

- (c) Connect the fuel tube into the clamp.
- (d) Connect the wire harness clamp.
- (e) Connect the throttle position sensor and control motor connector.
- (f) Connect the No. 1 throttle body hose to the throttle body.
- (g) Connect the No. 2 water by-pass hose to the throttle body.
- (h) Connect the water by-pass hose to the throttle body.
- (i) Connect the purge line hose to the throttle body.

2. INSTALL AIR CLEANER CAP

- (a) Install the air cleaner filter element onto the air cleaner case.
- (b) Insert the hinge part of the air cleaner cap into the air cleaner case, then hang the 2 hook clamps.

ES

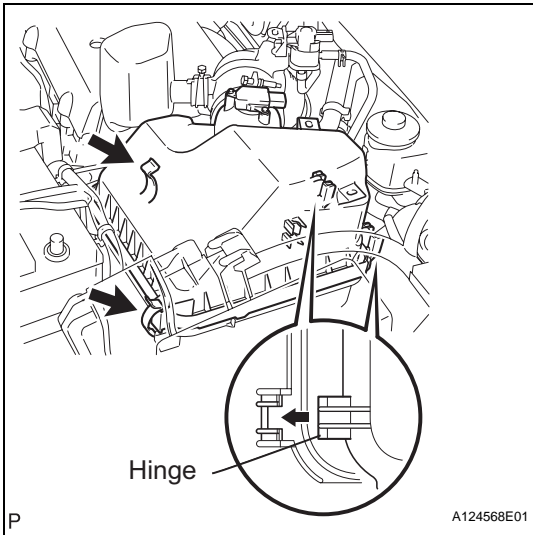

- (c) Align the matchmarks of the No. 1 air cleaner hose and throttle body, and then connect the air cleaner hose No. 1 to the throttle body and unfasten the No. 1 air cleaner hose clamp.

NOTICE:

Make sure that the hose clamp is at the correct angle.

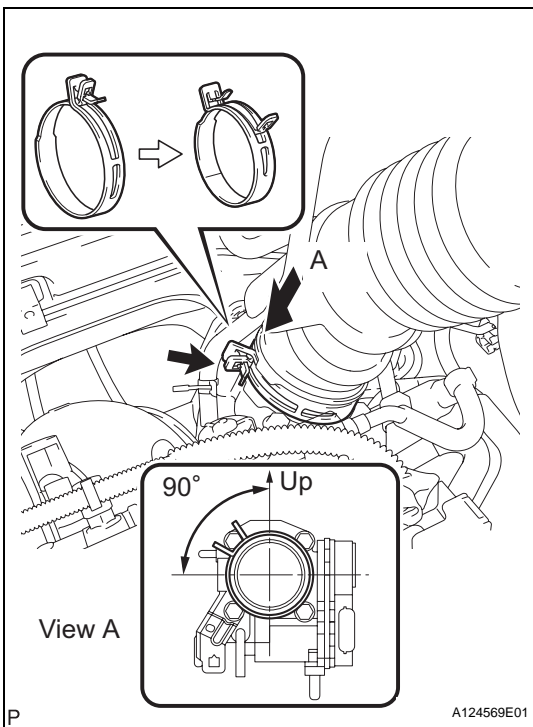

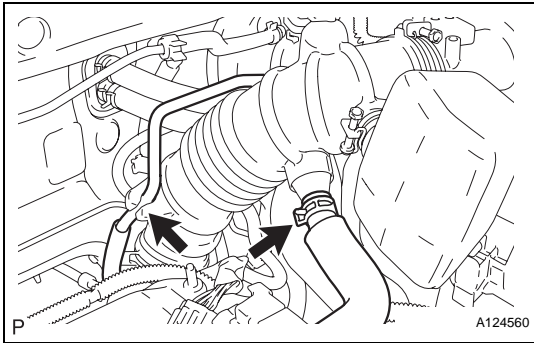

- (d) Connect the purge line hose to the clamp.
- (e) Connect the No. 2 ventilation hose to the air cleaner hose.

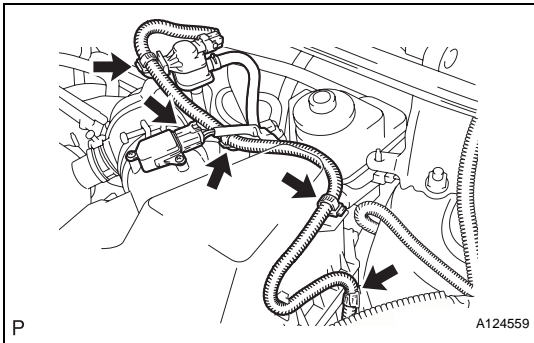

- (f) Install the 4 wire harness clamps.
- (g) Connect the mass air flow meter connector.

3. CONNECT CABLE TO NEGATIVE BATTERY TERMINAL

4. ADD ENGINE COOLANT (See page CO-6)

5. CHECK FOR ENGINE COOLANT LEAKAGE (See page CO-1)

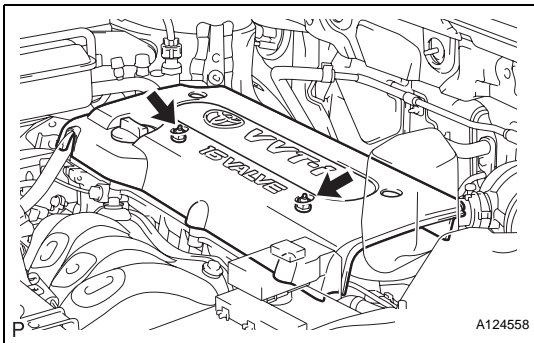

6. INSTALL NO. 1 ENGINE COVER

- (a) Install the cover with the 2 nuts.
Torque: 7.0 N*m (71 kgf*cm, 62 in.*lbf)