

# CIRCUIT OPENING RELAY

## ON-VEHICLE INSPECTION

1. DISCONNECT CABLE FROM NEGATIVE BATTERY TERMINAL

**CAUTION:**

Wait at least 90 seconds after disconnecting the cable from the negative (-) battery terminal to prevent airbag and seat belt pretensioner activation.

2. INSPECT INSTRUMENT PANEL JUNCTION BLOCK

**NOTICE:**

The circuit opening relay is built into the instrument panel junction block.

- (a) Measure the resistance between the terminals.

**ES**

Instrument Panel Junction Block (Front View)

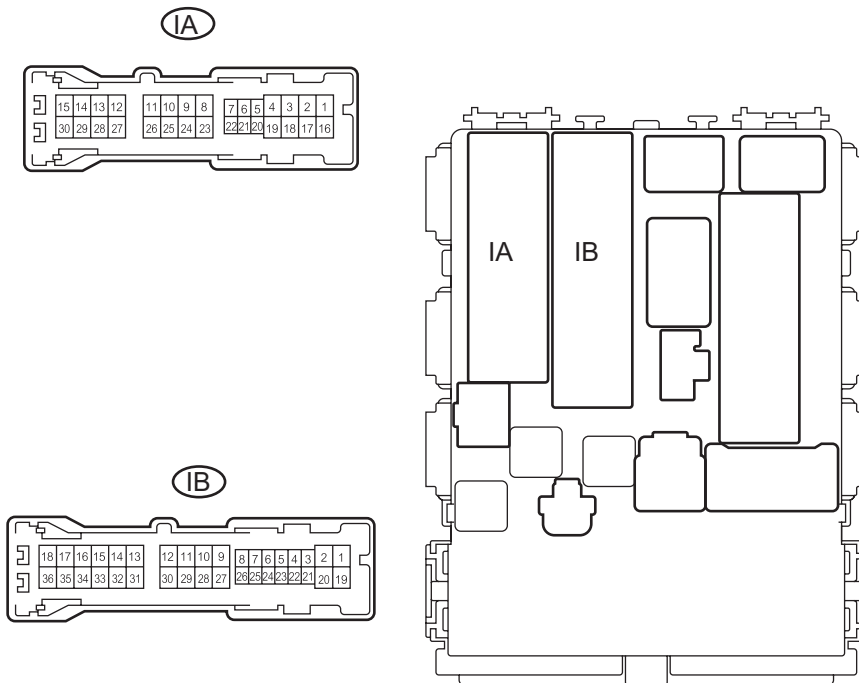

**Standard resistance**

| Tester Connection | Specified Condition  |
|-------------------|--|
| 1B-11 - 1A-8      | 10 k $\Omega$ or higher  |
| 1B-11 - 1A-8      | Below 1 $\Omega$<br>(when battery voltage is applied to terminals 1E-5 and 1D-1) |

If the result is not as specified, replace the instrument panel junction block.

- 3. CONNECT CABLE TO NEGATIVE BATTERY TERMINAL**