

CAMSHAFT TIMING OIL CONTROL VALVE ASSEMBLY COMPONENTS

ES

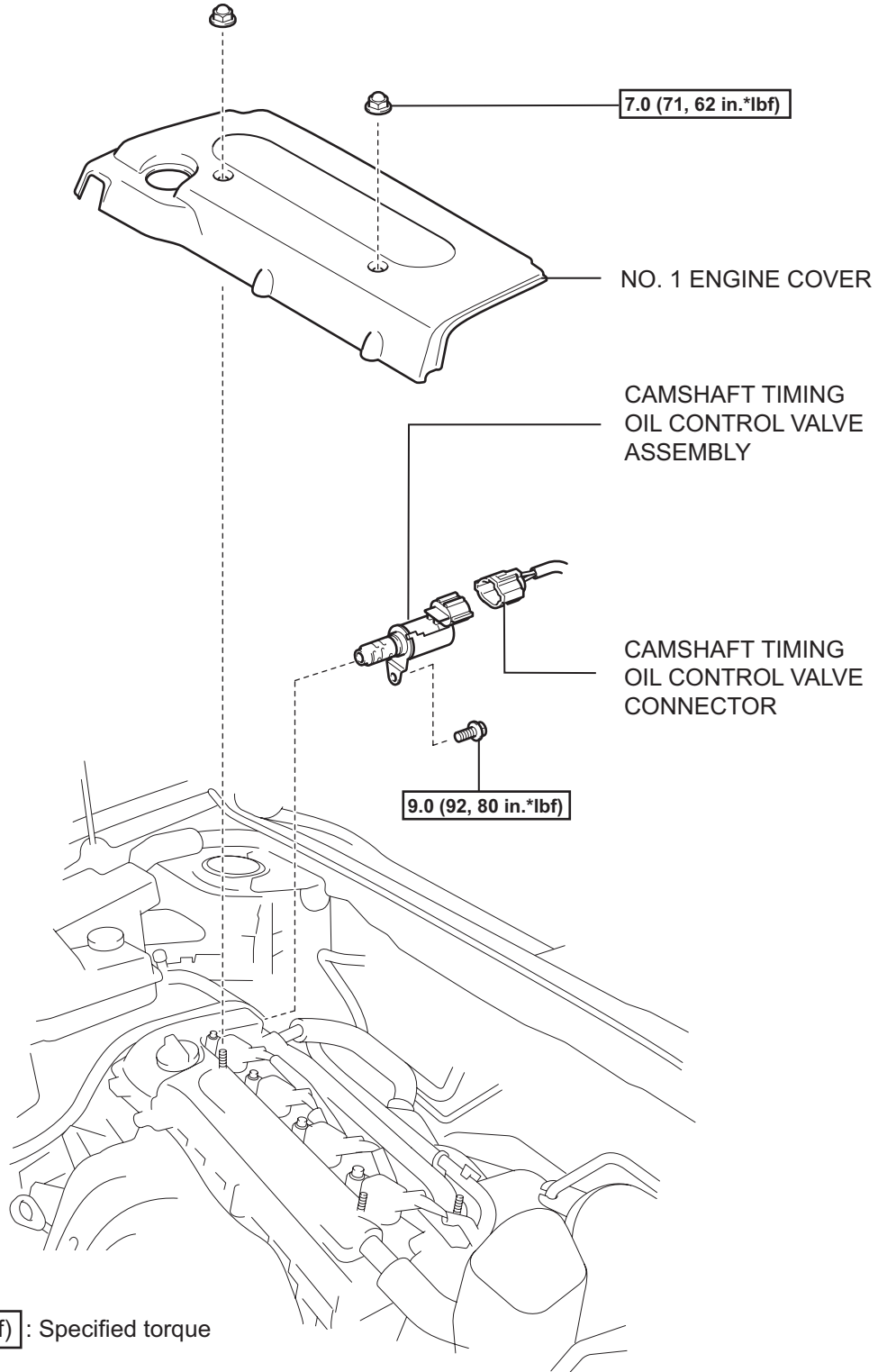

N*m (kgf*cm, ft.*lbf) : Specified torque

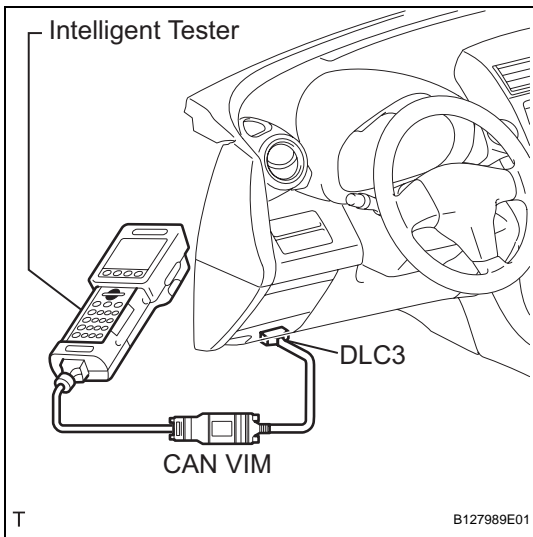

ON-VEHICLE INSPECTION

1. CHECK CAMSHAFT TIMING OIL CONTROL VALVE ASSEMBLY

- (a) Check the operation.
 - (1) Connect the intelligent tester to the DLC3.
 - (2) Turn the ignition switch ON.
 - (3) Turn the intelligent tester main switch ON.
 - (4) Start and warm up the engine.
 - (5) Select the menu items: DIAGNOSIS / ENHANCED OBD II / ACTIVE TEST / VVT CTRL B1.
 - (6) Operate the OCV using the intelligent tester, and then check the engine speed.

Standard condition

Tester Operation	Specified Condition
OCV is OFF	Normal engine speed
OCV is ON	Rough idling or engine stalls

If the operation is not as specified, check the oil control valve, wire harness and ECM.