

ACCELERATOR PEDAL ROD

COMPONENTS

ES

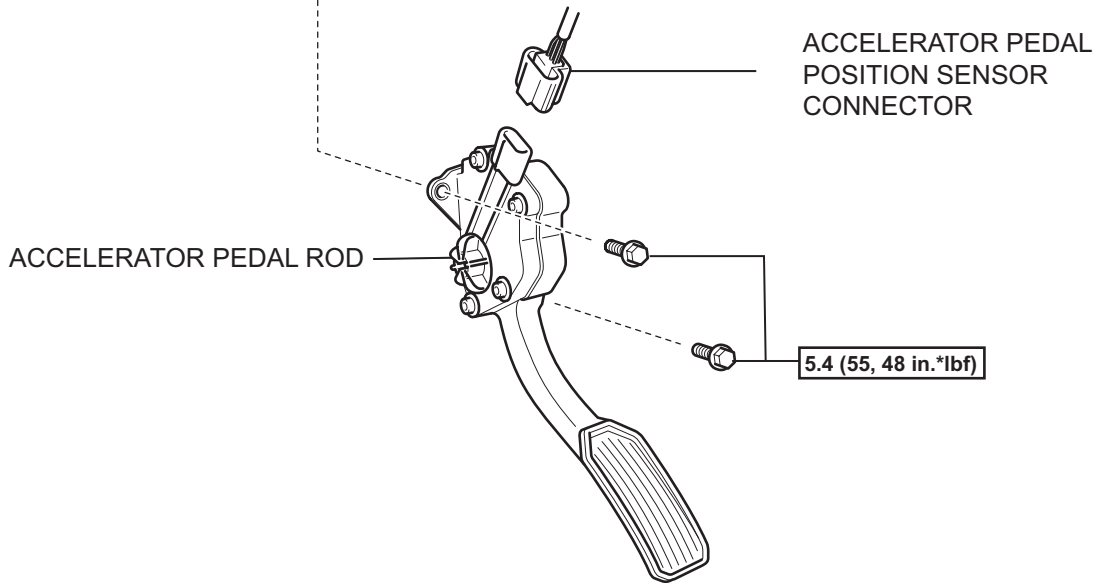
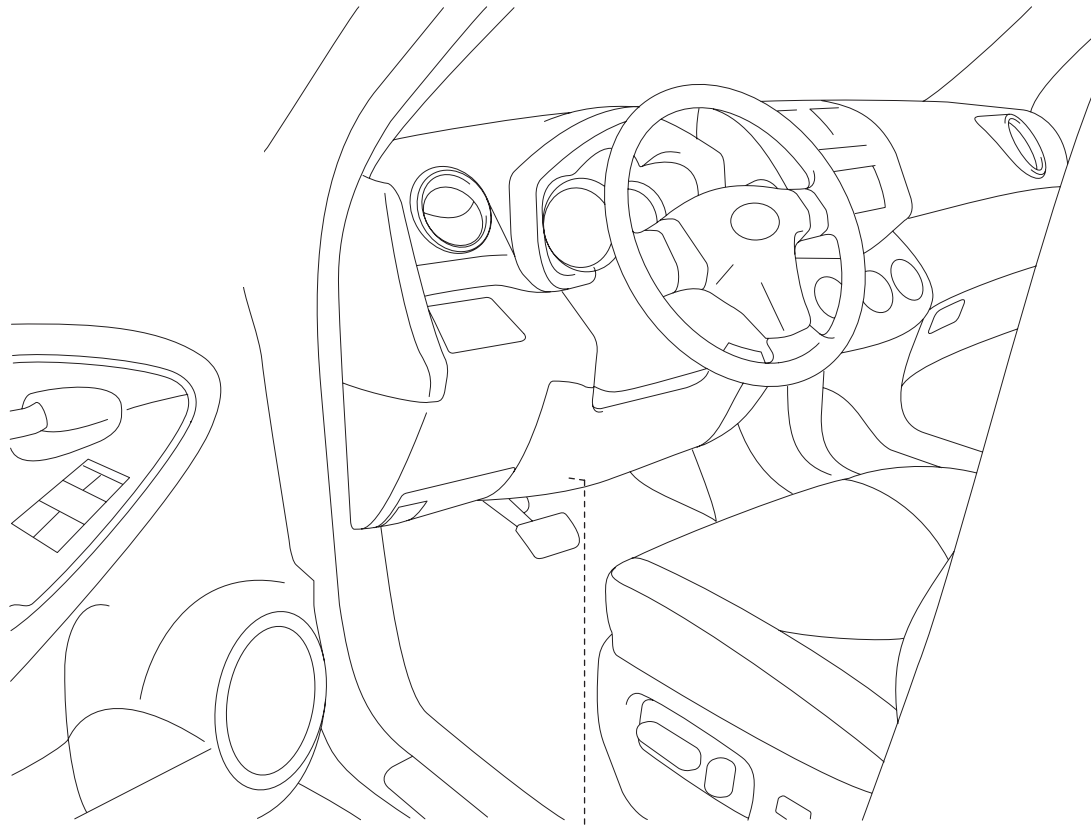

N*m (kgf*cm, ft.*lbf) : Specified torque

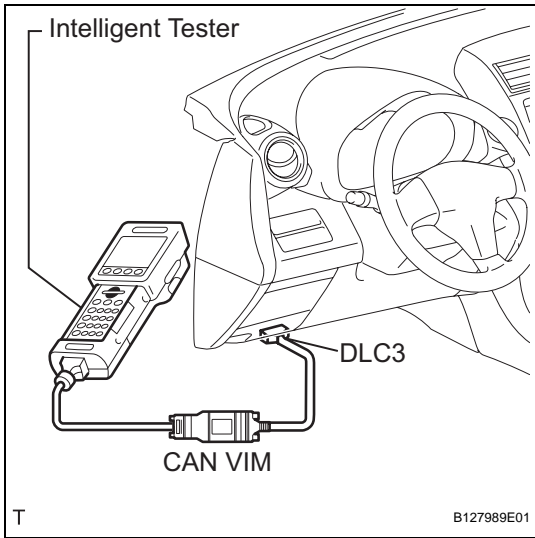

ON-VEHICLE INSPECTION

1. CHECK ACCELERATOR PEDAL ROD

- (a) Check the voltage.
 - (1) Connect the intelligent tester to the DLC3.
 - (2) Turn the ignition switch ON.
 - (3) Turn the intelligent tester ON.
 - (4) Select the menu items: DIAGNOSIS / ENHANCED OBD II / DATA LIST / ALL / ACCEL POS #1, ACCEL POS #2.
 - (5) Operate the accelerator pedal, and then check that the ACCEL POS #1 and ACCEL POS #2 values are within the specifications.

Standard voltage (ACCEL POS #1)

Accelerator Pedal Condition	Specified Condition
Released	0.5 to 1.1 V
Depressed	2.5 to 4.5 V

Standard voltage (ACCEL POS #2)

Accelerator Pedal Condition	Specified Condition
Released	1.2 to 2.0 V
Depressed	3.4 to 5.0 V

If the result is not as specified, check the accelerator pedal rod, wire harness or ECM.