

VACUUM SWITCHING VALVE

COMPONENTS

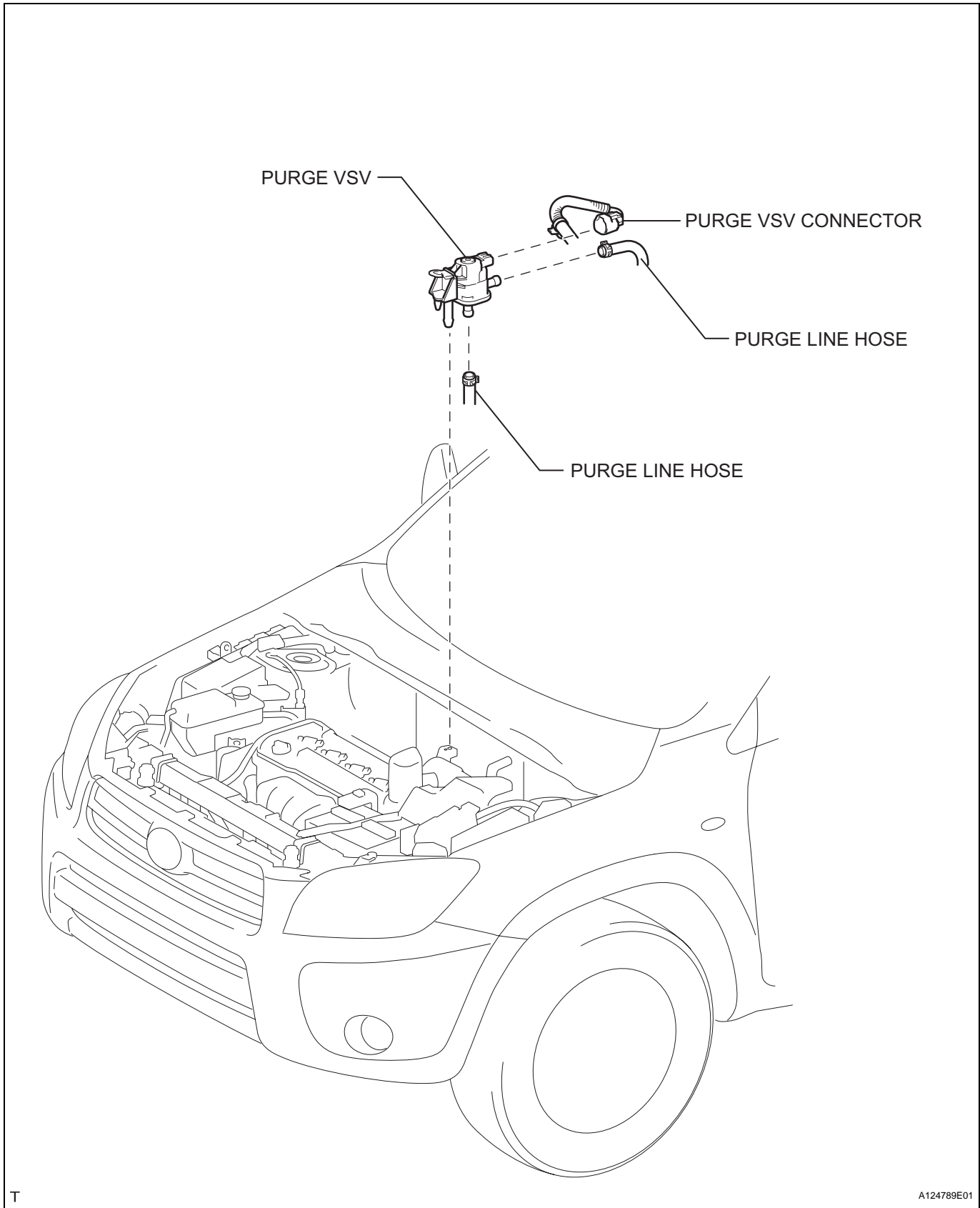

REMOVAL

1. DISCONNECT CABLE FROM NEGATIVE BATTERY TERMINAL

CAUTION:

Wait at least 90 seconds after disconnecting the cable from the negative (-) battery terminal to prevent airbag and seat belt pretensioner activation.

2. REMOVE PURGE VSV

- Disconnect the purge VSV connector.
- Disconnect the wire harness clamp.
- Disconnect the 2 purge line hoses from the purge VSV.
- Remove the purge VSV from the air cleaner hose.

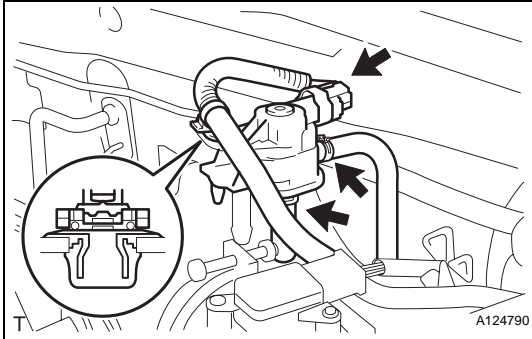

INSPECTION

1. INSPECT PURGE VSV

- Measure the resistance of the purge VSV.

Standard resistance

Tester Connection	Specified Condition
1 - 2	23 to 26 Ω at 20°C (68°F)
1 - Body ground 2 - Body ground	10 M Ω or higher

If the result is not as specified, replace the purge VSV.

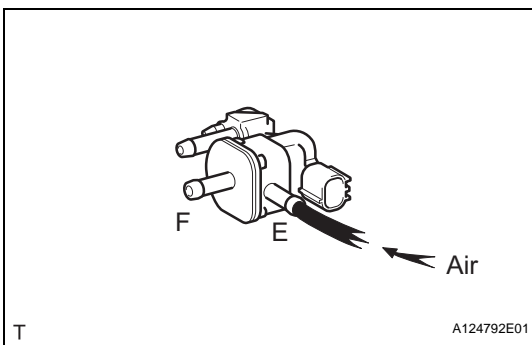
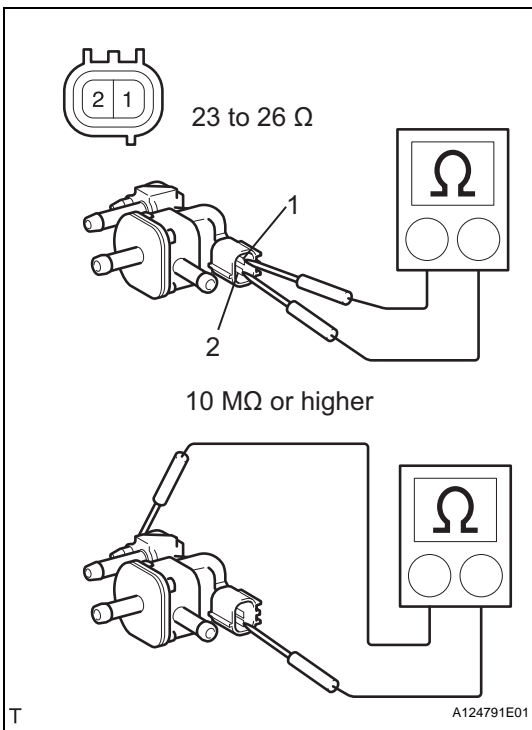

- Check the operation of the purge VSV.
 - Check that air does not flow from port E to port F.

EC

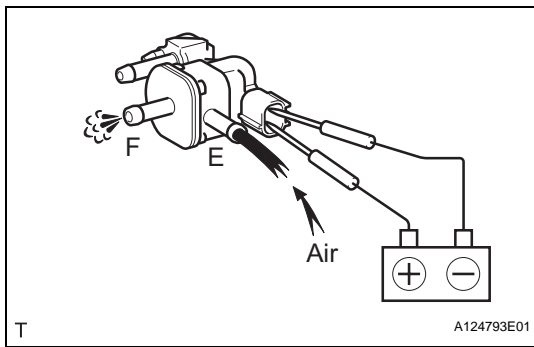

- (2) Apply battery voltage across terminals.
- (3) Check that air flows from port E to port F.
If the result is not as specified, replace the purge VSV.

INSTALLATION

1. INSTALL PURGE VSV

- (a) Install the purge VSV onto the air cleaner hose.

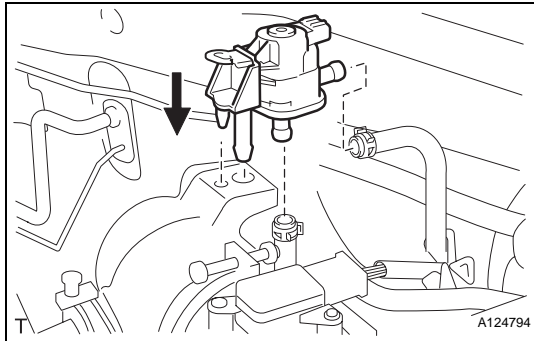

- (b) Connect the 2 purge line hoses to the purge VSV.
- (c) Connect the wire harness clamp.
- (d) Connect the purge VSV connector.

2. CONNECT CABLE TO NEGATIVE BATTERY TERMINAL

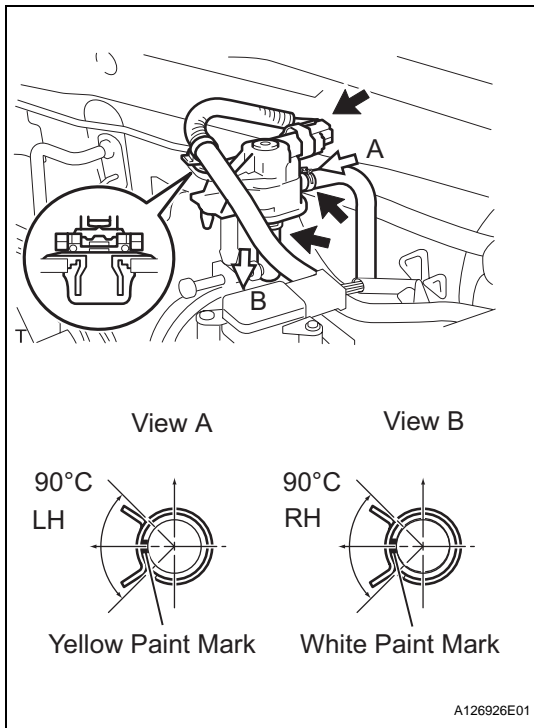

EC