

# THERMOSTAT COMPONENTS

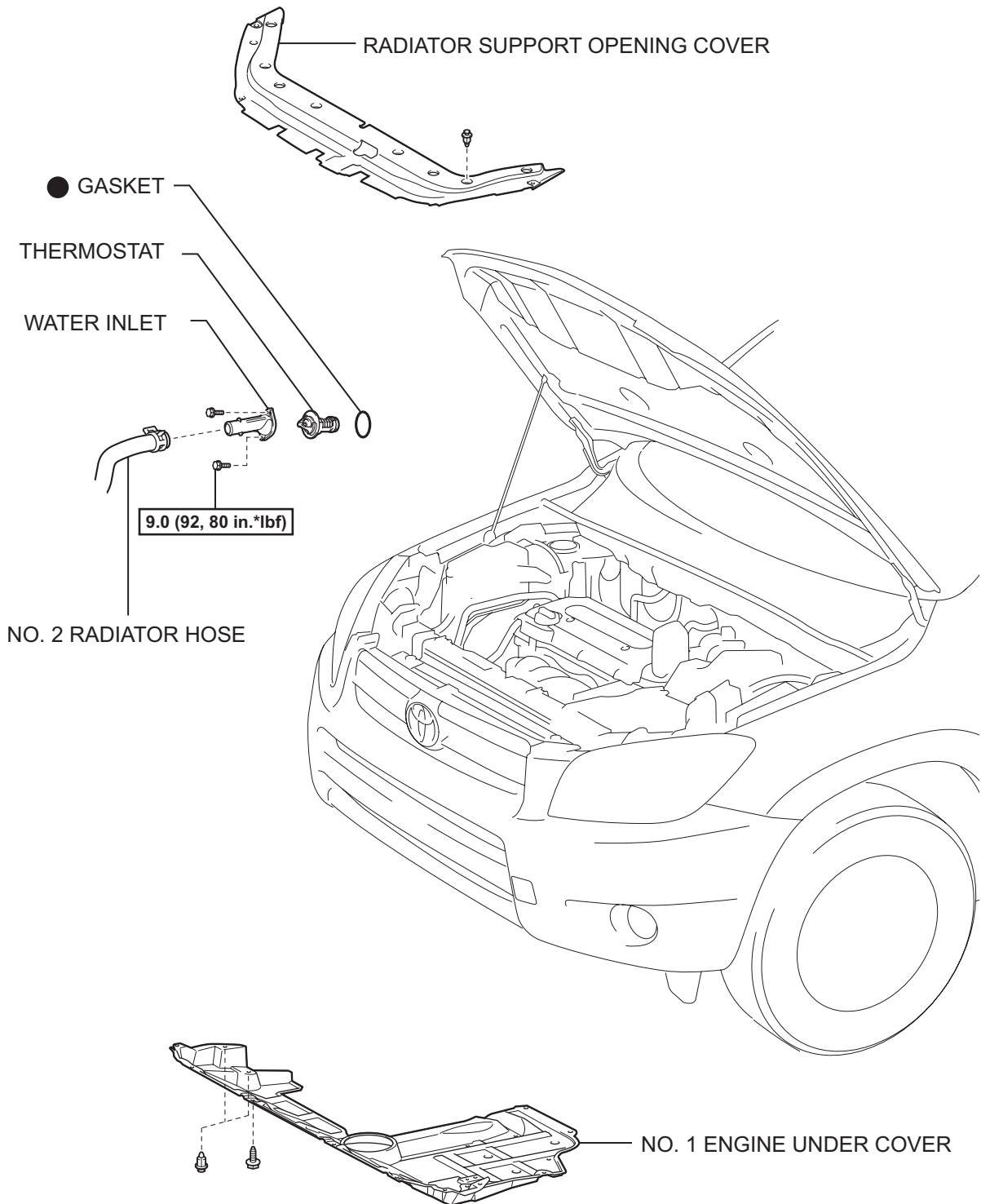

N\*m (kgf\*cm, ft.\*lbf) : Specified torque

● Non-reusable part

CO

## REMOVAL

1. REMOVE NO. 1 ENGINE UNDER COVER
2. DRAIN ENGINE COOLANT (See page CO-6)
3. REMOVE RADIATOR SUPPORT OPENING COVER
4. DISCONNECT NO. 2 RADIATOR HOSE
5. REMOVE WATER INLET
  - (a) Remove the 2 nuts and disconnect the water inlet from the cylinder block.
6. REMOVE THERMOSTAT
  - (a) Remove the gasket from the thermostat.

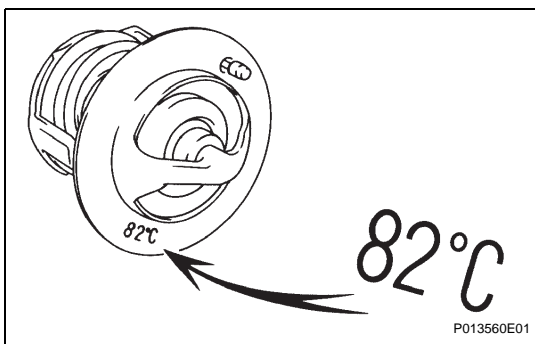
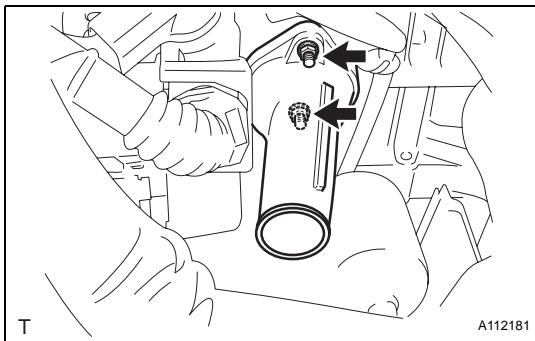

## INSPECTION

1. INSPECT THERMOSTAT

### HINT:

The valve opening temperature is inscribed on the thermostat.

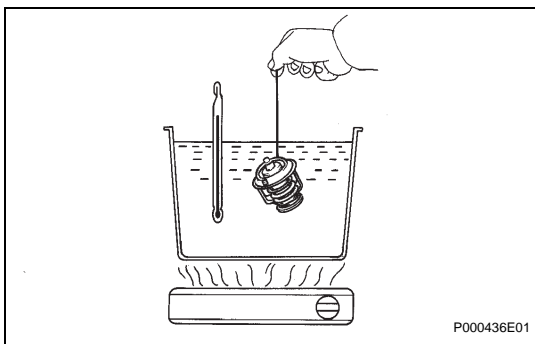

- (a) Immerse the thermostat in water, and then gradually heat the water.

- (b) Check the valve opening temperature of the thermostat.

### Standard valve opening temperature:

**80 to 84°C (176 to 183°F)**

If the valve opening temperature is not as specified, replace the thermostat.

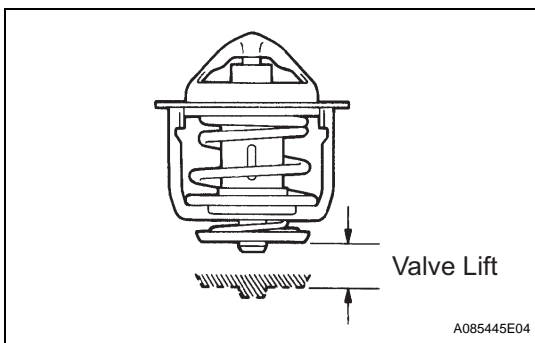

- (c) Check the valve lift.

### Standard valve lift:

**10 mm (0.39 in.) or more at 95°C (203°F)**

If the valve lift is not as specified, replace the thermostat.

- (d) Check that the valve is fully closed when the thermostat is at low temperatures (below 77°C (171°F).

If it is not fully closed, replace the thermostat.