

REPLACEMENT

CAUTION:

- Before and after the work, be sure to check DTCs and confirm that no DTCs is output.
 - If the tank has any malfunctions, the tank surface gets hot. To prevent burn injury, do not touch the tank.
 - The coolant heat storage tank assembly is prohibited from being disassembled and can be disassembled only as instructed.
1. REMOVE REAR FLOOR BOARD NO.2 (See page 21-116)
 2. REMOVE DECK FLOOR BOX REAR (See page 21-116)
 3. REMOVE REAR FLOOR BOARD NO.3 (See page 21-116)
 4. DISCONNECT BATTERY NEGATIVE TERMINAL (See page 21-116)
 5. REMOVE RADIATOR SUPPORT OPENING COVER (See page 16-11)
 6. REMOVE ENGINE UNDER COVER LH
 7. REMOVE ENGINE UNDER COVER RH
 8. REMOVE FRONT BUMPER COVER (See page 76-2)
 9. REMOVE FRONT FENDER LINER LH
 - (a) Remove the front fender liner LH partly.

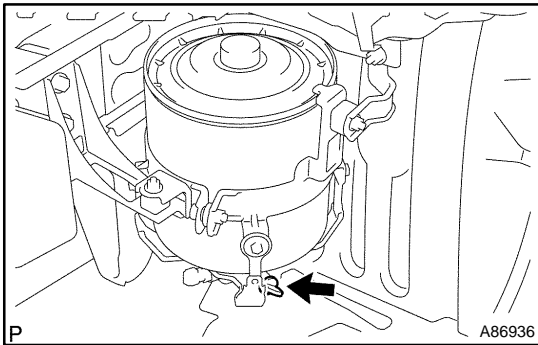

10. DRAIN ENGINE COOLANT

- (a) Loosen the drain cock plug, then drain the coolant.

CAUTION:

Even if the engine is cold, the coolant in the coolant heat storage tank assembly is still hot. Be careful of the hot coolant when draining.

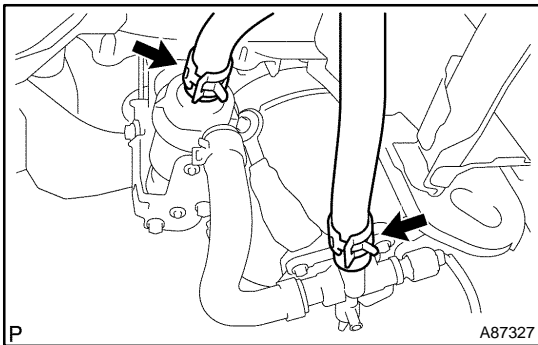

11. REMOVE COOLANT HEAT STORAGE TANK ASSY

- (a) Disconnect the 2 hoses shown in the illustration.

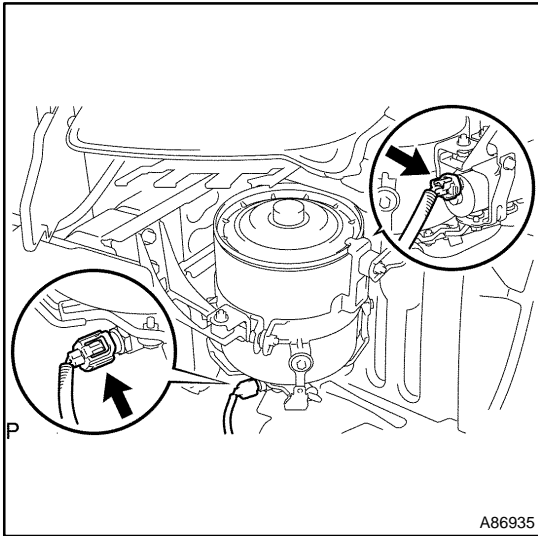

- (b) Disconnect the 2 connectors of the water pump motor and temperature sensor.

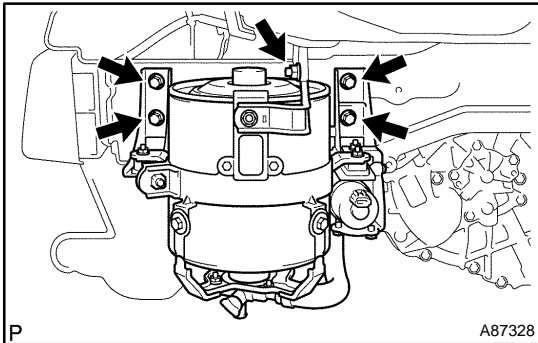

- (c) Remove the nut and 4 bolts shown in the illustration.

NOTICE:

The coolant heat storage tank bracket can be easily bent. Hold the coolant heat storage tank assembly tightly when removing.

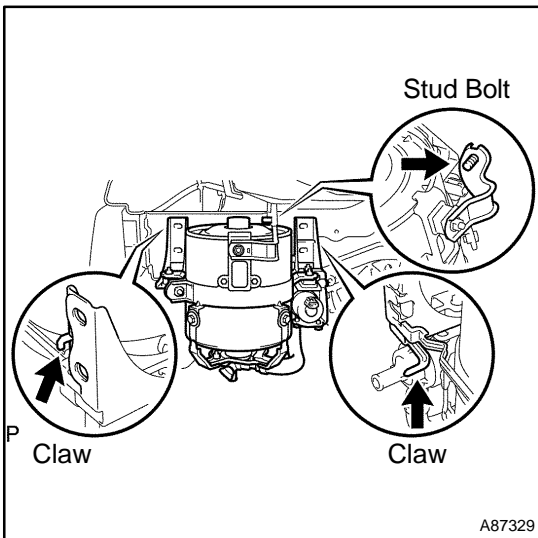

- (d) Separate the stud bolt and 2 claws shown in the illustration, then remove the coolant heat storage tank assembly.

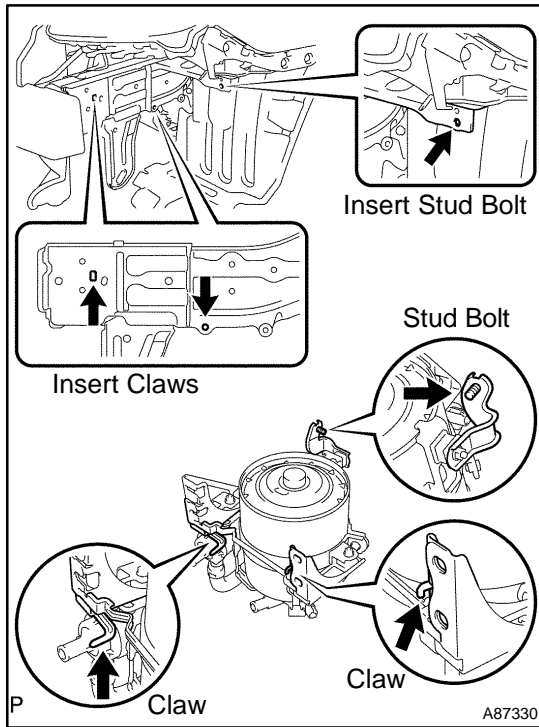

12. INSTALL COOLANT HEAT STORAGE TANK ASSY

- (a) Insert the 2 claws shown in the illustration to the vehicle side, then insert the stud bolt to the vehicle side.

NOTICE:

The coolant heat storage tank bracket can be easily bent. Hold the coolant heat storage tank assembly tightly when installing.

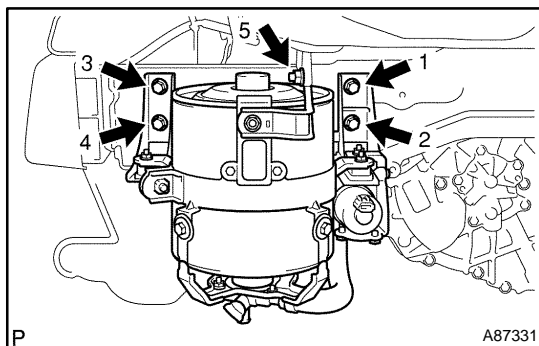

- (b) Tighten the 4 bolts and nut shown in the illustration.

Torque: 19 N·m (194 kgf·cm, 14 ft·lbf)

NOTICE:

- When tightening bolt 1 and 2, push the coolant heat storage tank bracket to the vehicle front.
- The coolant heat storage tank bracket can be easily bent. Hold the coolant heat storage tank assembly tightly when installing.

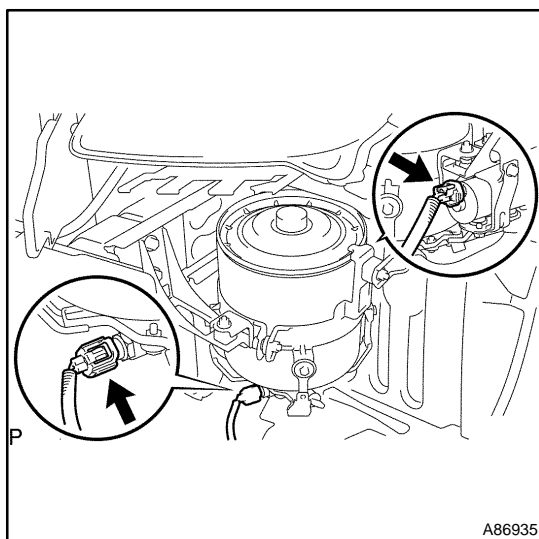

- (c) Connect the 2 connectors of the water pump motor and temperature sensor.

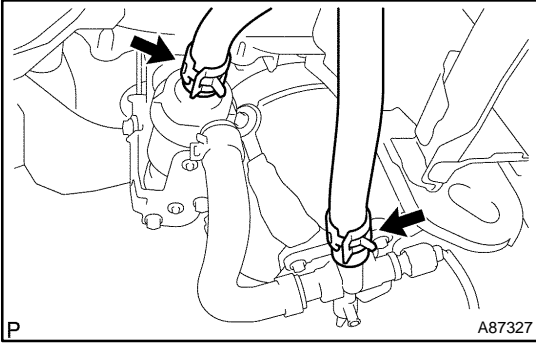

(d) Connect the 2 hoses shown in the illustration.

13. **CONNECT BATTERY NEGATIVE TERMINAL**
Torque: 6.0 N·m (61 kgf·cm, 53 in·lbf)
14. **INSTALL REAR FLOOR BOARD NO.3**
15. **INSTALL DECK FLOOR BOX REAR**
16. **INSTALL REAR FLOOR BOARD NO.2**
17. **ADD ENGINE COOLANT (See page 16-11)**
18. **CHECK FOR ENGINE COOLANT LEAKS**
19. **INSTALL FRONT FENDER LINER LH**
20. **INSTALL FRONT BUMPER COVER (See page 76-2)**
21. **INSTALL ENGINE UNDER COVER RH**
22. **INSTALL ENGINE UNDER COVER LH**
23. **INSTALL RADIATOR SUPPORT OPENING COVER**
24. **POWER WINDOW CONTROL SYSTEM INITIALIZE (See page 01-28)**