

# REPLACEMENT

1. DISCHARGE FUEL SYSTEM PRESSURE (See page 11-3)
2. REMOVE REAR FLOOR BOARD NO.2 (See page 19-2)
3. REMOVE DECK FLOOR BOX REAR (See page 19-2)
4. REMOVE REAR FLOOR BOARD NO.3 (See page 19-2)
5. DISCONNECT ENGINE WIRE NO.3 (BATTERY NEGATIVE TERMINAL) (See page 19-2)
6. REMOVE WINDSHIELD WIPER ARM COVER
7. REMOVE FR WIPER ARM RH (See page 66-14)
8. REMOVE FR WIPER ARM LH (See page 66-14)
9. REMOVE HOOD TO COWL TOP SEAL (See page 66-14)
10. REMOVE COWL TOP VENTILATOR LOUVER LH (See page 66-14)
11. REMOVE COWL TOP VENTILATOR LOUVER RH (See page 66-14)
12. REMOVE WINDSHIELD WIPER LINK ASSY (See page 66-14)

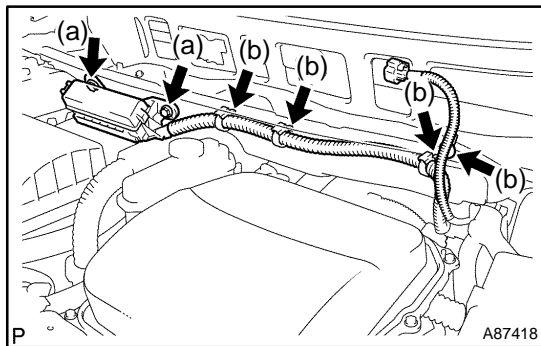

## 13. REMOVE COWL TOP PANEL SUB-ASSY OUTER FRONT

- (a) Remove the 2 bolts then remove the engine room relay block No. 2.
- (b) Remove the 4 wire harness clamps.

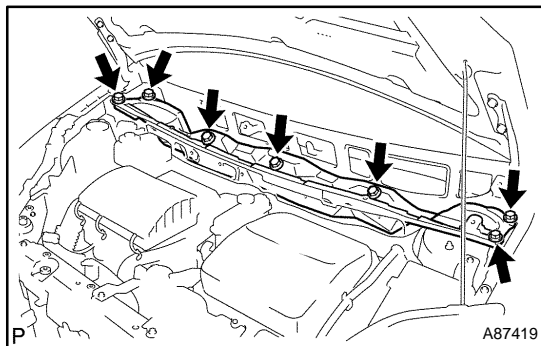

- (c) Remove the 7 bolts, then remove the cowl top panel outer front.

## 14. REMOVE AIR CLEANER ASSY (See page 10-15)

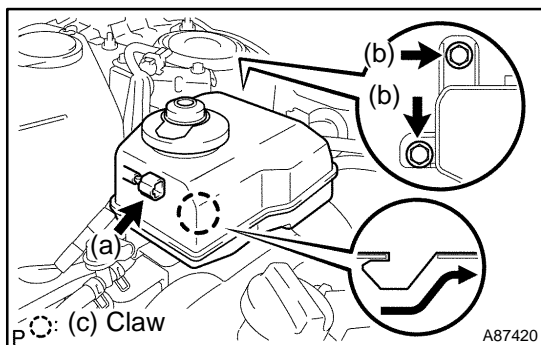

## 15. REMOVE BRAKE MASTER CYLINDER RESERVOIR SUB-ASSY

- (a) Disconnect the brake fluid level switch connector.
- (b) Remove the 2 bolts.
- (c) Separate the claw fitting, then remove the brake master cylinder reservoir.

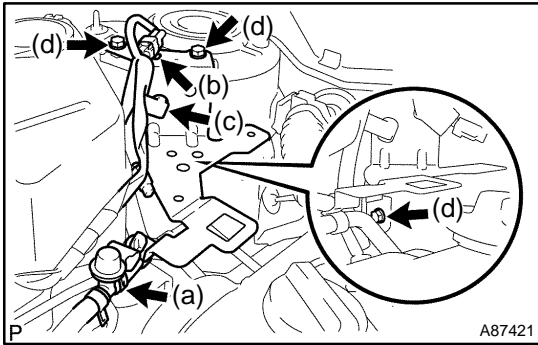

**16. REMOVE RESERVOIR BRACKET**

- (a) Remove the fuel vapor feed hose No. 2 from the hose clamp.
- (b) Remove the connector clamp.
- (c) Remove the wire harness clamp.
- (d) Remove the 3 bolts, then remove the reservoir bracket.

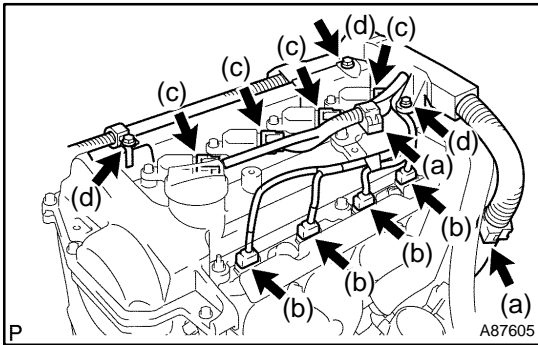

**17. REMOVE CYLINDER HEAD COVER SUB-ASSY**

- (a) Remove the 2 wire harness clamps.
- (b) Disconnect the 4 fuel injector connectors.
- (c) Disconnect the 4 ignition coil connectors.
- (d) Remove the 3 bolts, then remove the engine wire and brake master cylinder reservoir cover.

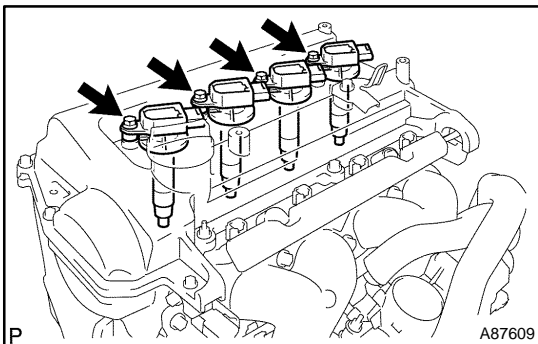

- (e) Remove the 4 bolts, then remove the 4 ignition coils.

**HINT:**

Each ignition coil is installed with 1 bolt.

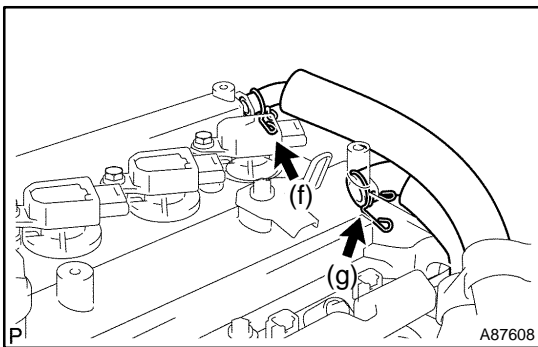

- (f) Disconnect the ventilation hose from the ventilation valve.
- (g) Disconnect the ventilation hose No. 2 from the cylinder head cover.

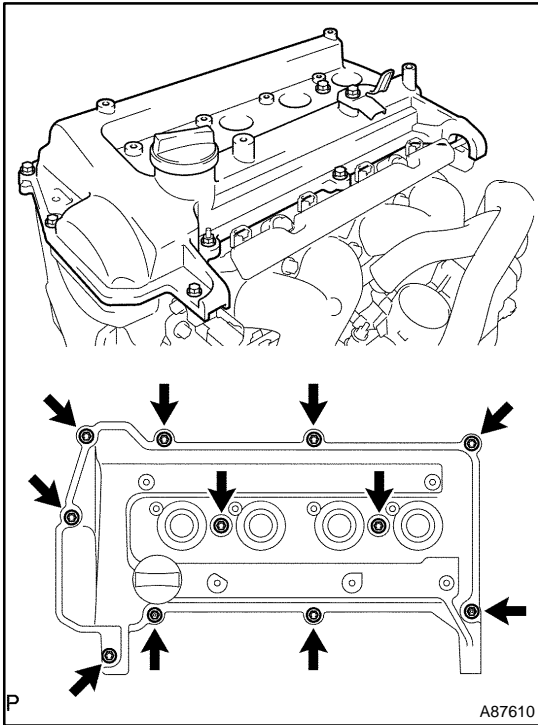

(h) Remove the 9 bolts, 2 seal washers and 2 nuts, then remove the cylinder head cover.

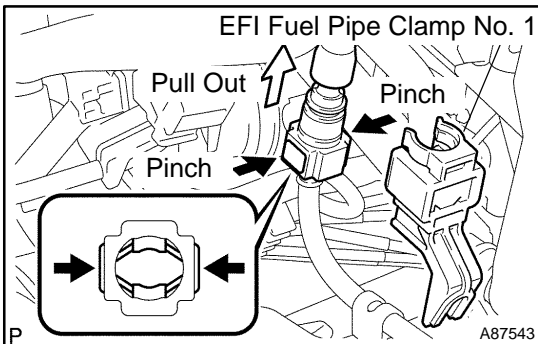

**18. REMOVE FUEL DELIVERY PIPE SUB-ASSY**

- (a) Disconnect the fuel tube from the fuel delivery pipe.
- (1) Remove the EFI fuel pipe clamp No. 1.
  - (2) Pinch the retainer of the fuel tube connector, then pull out the fuel tube connector to disconnect the fuel tube from the fuel delivery pipe.

**NOTICE:**

- Remove dirt or foreign objects on the fuel tube connector before this work.
- Do not allow any scratches or foreign objects on the parts when disconnecting as the fuel tube connector has the O-ring that seals the pipe.
- Perform this work by hand. Do not use any tools.
- Do not forcibly bend, twist or turn the nylon tube.
- Protect the connected part by covering it with a vinyl bag after disconnecting the fuel tube.
- If the fuel tube connector and pipe are stuck, push and pull them to release.

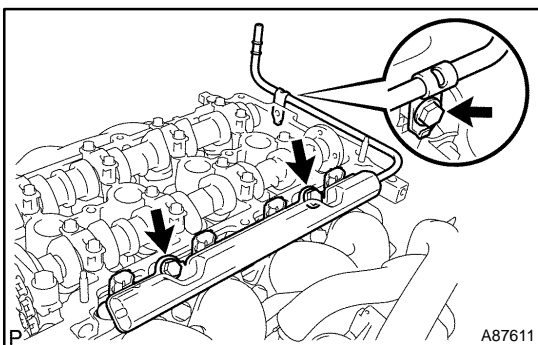
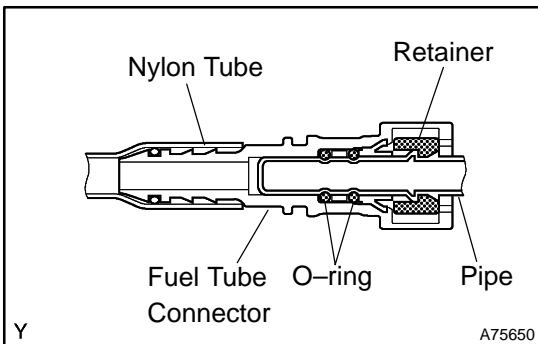

(b) Remove the 3 bolts, then remove the fuel delivery pipe together with the 4 fuel injectors.

**NOTICE:**

Do not drop the fuel injectors when removing the fuel delivery pipe.

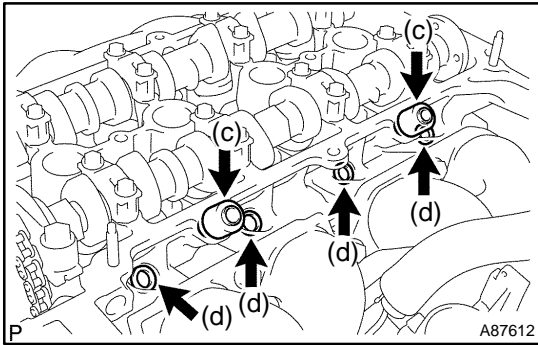

- (c) Remove the 2 delivery pipe No. 1 spacers from the cylinder head.
- (d) Remove the 4 insulators from the cylinder head.

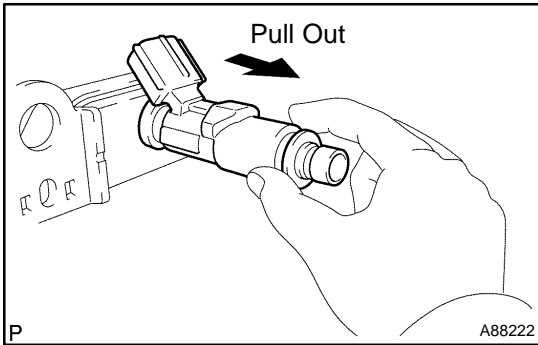

**19. REMOVE FUEL INJECTOR ASSY**

- (a) Pull out the 4 fuel injectors from the fuel delivery pipe.

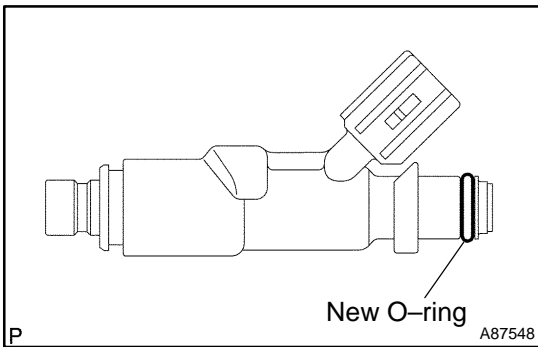

**20. INSTALL FUEL INJECTOR ASSY**

- (a) Apply a light coat of spindle oil or gasoline to a new O-ring, then install it to each fuel injector.

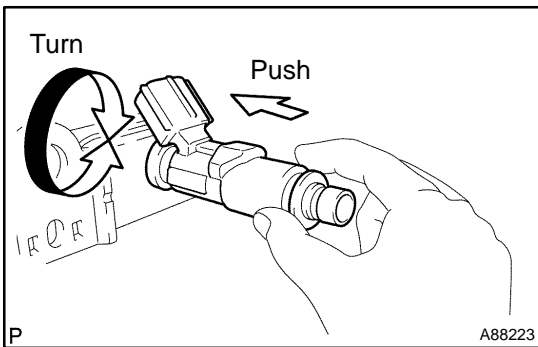

- (b) Apply a light coat of spindle oil or gasoline to the surface of the fuel delivery pipe which contacts the O-ring of the fuel injector.
- (c) Apply a light coat of spindle oil or gasoline to the O-ring again, then turning the fuel injector right and left to the fuel delivery pipe.

**NOTICE:**

**Be careful that the O-ring is not cracked or jammed when installing.**

- (d) Check that the fuel injector rotates smoothly. If the fuel injector does not rotate, replace the O-ring.

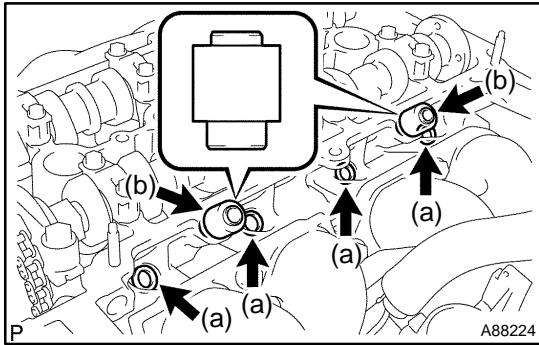

**21. INSTALL FUEL DELIVERY PIPE SUB-ASSY**

- (a) Install 4 new insulators to the cylinder head.
- (b) Install the 2 delivery pipe No. 1 spacers to the cylinder head.

**NOTICE:**

**Be careful of the installation direction of the delivery pipe spacer.**

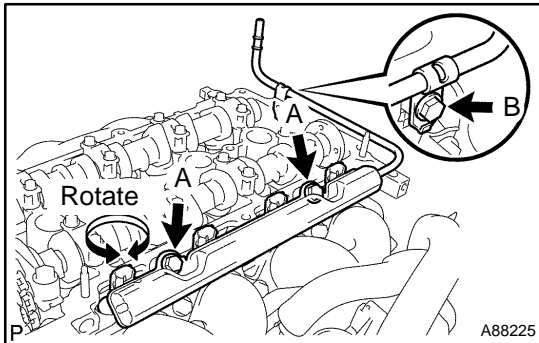

- (c) Install the fuel delivery pipe together with the 4 fuel injectors, then temporarily tighten the 3 bolts.

**NOTICE:**

**Do not drop the fuel injectors when installing the fuel delivery pipe.**

- (d) Check that the fuel injector rotates smoothly. If the fuel injector does not rotate, replace the O-ring.
- (e) Retighten the 3 bolts with the specified torque.

**Torque:**

**19 N·m (194 kgf·cm, 14 ft·lbf) for bolt A**

**9.0 N·m (92 kgf·cm, 80 in·lbf) for bolt B**

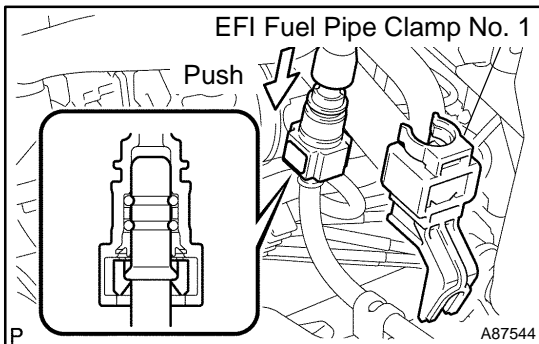

- (f) Connect the fuel tube to the fuel delivery pipe.
  - (1) Align the fuel tube connector with the pipe, then push in the fuel tube connector until the retainer makes a "click" sound to connect the fuel tube to the fuel delivery pipe.

**NOTICE:**

- Check that there are no scratches or foreign objects around the connected part of the fuel tube connector and pipe before this work.
- After connecting the fuel tube, check that the fuel tube connector and pipe are securely connected by pulling them.
- (2) Install the EFI fuel pipe clamp No. 1.

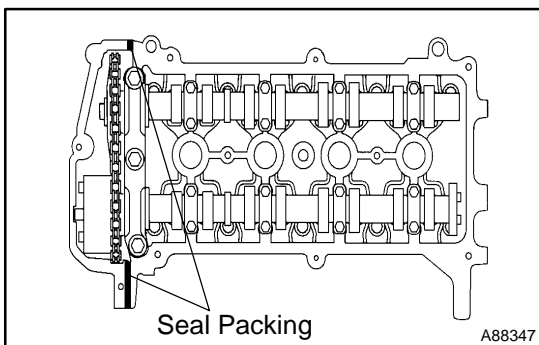

**22. INSTALL CYLINDER HEAD COVER SUB-ASSY**

- (a) Apply seal packing to the cylinder head as illustrated. **Seal packing: Part No. 08826-00080 or equivalent**

**NOTICE:**

- Remove any oil from the contact surface.
- Install the cylinder head cover within 3 minutes after applying seal packing.
- Do not start the engine within 2 hours of installation.

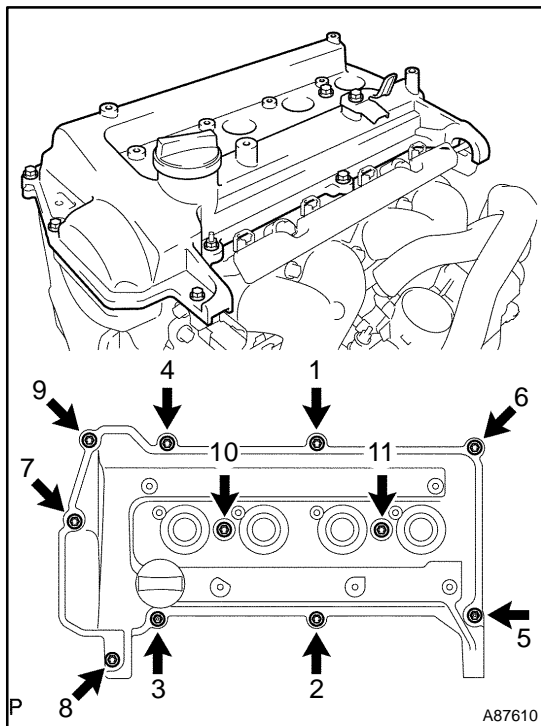

- (b) Tighten the 9 bolts, 2 seal washers and 2 nuts in the sequence shown in the illustration to install the cylinder head cover.  
**Torque: 10 N·m (102 kgf·cm, 7 ft·lbf)**
- (c) Connect the ventilation hose No. 2 to the cylinder head cover.
- (d) Connect the ventilation hose to the ventilation valve.
- (e) Install the 4 ignition coils with the 4 bolts.  
**Torque: 9.0 N·m (92 kgf·cm, 80 in·lbf)**
- (f) Install the engine wire and brake master cylinder reservoir cover with the 3 bolts.  
**Torque: 9.0 N·m (92 kgf·cm, 80 in·lbf)**
- (g) Connect the 4 ignition coil connectors.
- (h) Connect the 4 fuel injector connectors.
- (i) Install the 2 wire harness clamps.

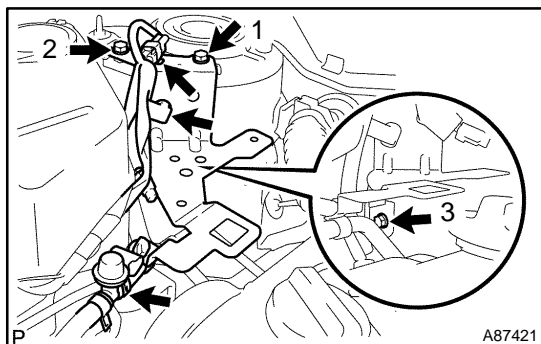

### 23. INSTALL RESERVOIR BRACKET

- (a) Temporarily install the reservoir bracket with the bolt 1.
- (b) Tighten the 3 bolts with the specified torque in the sequence shown in the illustration.  
**Torque: 8.5 N·m (87 kgf·cm, 75 in·lbf)**
- (c) Install the connector clamp.
- (d) Install the wire harness clamp.
- (e) Install the fuel vapor feed hose No. 2 to the hose clamp.

### 24. INSTALL BRAKE MASTER CYLINDER RESERVOIR SUB-ASSY

**Torque: 8.5 N·m (87 kgf·cm, 75 in·lbf)**

### 25. INSTALL AIR CLEANER ASSY (See page 10-15)

### 26. INSTALL COWL TOP PANEL SUB-ASSY OUTER FRONT

**Torque: 6.4 N·m (65 kgf·cm, 57 in·lbf)**

### 27. INSTALL WINDSHIELD WIPER LINK ASSY (See page 66-14)

### 28. CONNECT ENGINE WIRE NO.3 (BATTERY NEGATIVE TERMINAL) (See page 19-2)

### 29. CHECK FOR FUEL LEAKS (See page 11-3)

### 30. CHECK FOR ENGINE OIL LEAKS

### 31. INSTALL COWL TOP VENTILATOR LOUVER RH

### 32. INSTALL COWL TOP VENTILATOR LOUVER LH

### 33. INSTALL HOOD TO COWL TOP SEAL

### 34. INSTALL FR WIPER ARM LH (See page 66-14)

### 35. INSTALL FR WIPER ARM RH (See page 66-14)

### 36. INSTALL WINDSHIELD WIPER ARM COVER

### 37. INSTALL REAR FLOOR BOARD NO.3

### 38. INSTALL DECK FLOOR BOX REAR

### 39. INSTALL REAR FLOOR BOARD NO.2

### 40. POWER WINDOW CONTROL SYSTEM INITIALIZE (See page 01-28)