

# INSPECTION

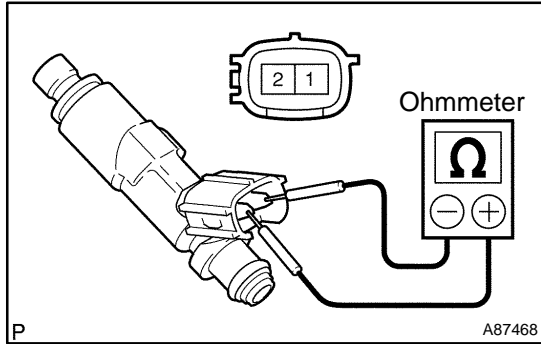

## 1. INSPECT FUEL INJECTOR ASSY

(a) Inspect the resistance.

- (1) Using an ohmmeter, measure the resistance between the terminals.

**Standard:**

Tester Connection	Specified Condition
1 - 2	13.45 to 14.15 Ω at 21°C (68°F)

If the resistance is not as specified, replace the fuel injector.

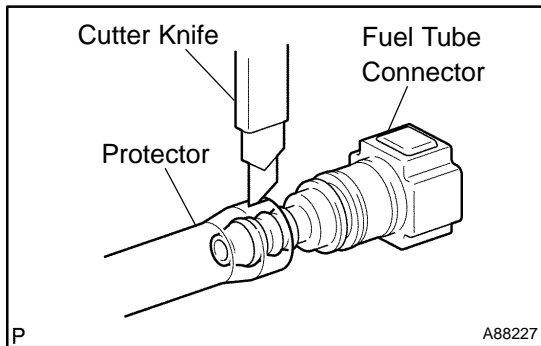

(b) Inspect the injection volume.

**NOTICE:**

- Perform the test in a well-ventilated area and watch out for flames.
- Carefully handle the fuel tube connector.

- (1) Prepare a new fuel tube.

**HINT:**

Part No. 23901-21080

- (2) Using a cutter knife, cut off the protector of the fuel tube as illustrated. Tear off the protector by hand, then remove the fuel tube connector.

**NOTICE:**

**If the protector is cut too deeply using a cutter, the O-ring of the fuel tube connector will be damaged.**

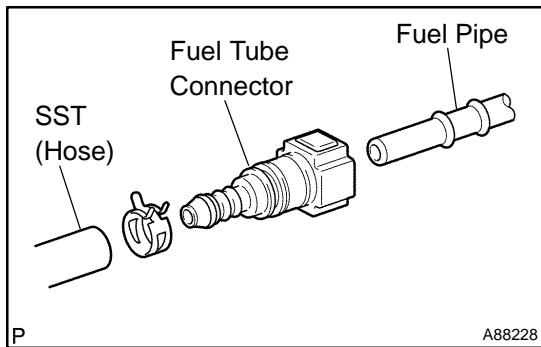

- (3) Install SST to the fuel tube connector, then connect the fuel tube connector to the fuel pipe (the vehicle side).

SST 09268-41047 (95336-08070)

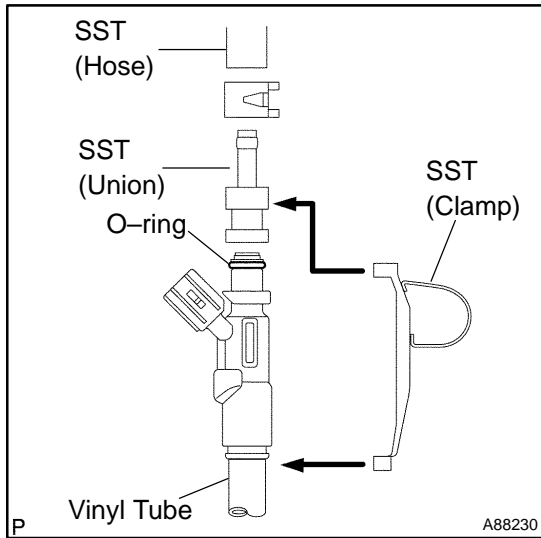

- (4) Install a new O-ring to the fuel injector.
- (5) Install SST and the vinyl tube to the fuel injector.  
SST 09268-41047 (09268-41110, 09268-41300)

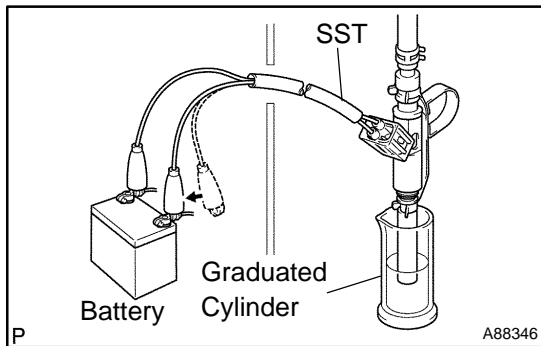

- (6) Set the fuel injector to a graduated cylinder.
- (7) Actuate the fuel pump (see page 11-7).
- (8) Install SST to the fuel injector.  
SST 09842-30080
- (9) Connect SST to the battery, then measure the injection volume for 15 seconds. Perform the inspection 2 or 3 times, then calculate the average.

**Standard:**

Injection Volume	Difference between each fuel injector
36 to 46 cm <sup>3</sup> (2.1 to 2.8 cu in.)	10 cm <sup>3</sup> (0.6 cu in.) or less

**NOTICE:**

**Always do the switching at the battery side.**

If the injection volume is not as specified, replace the fuel injector.

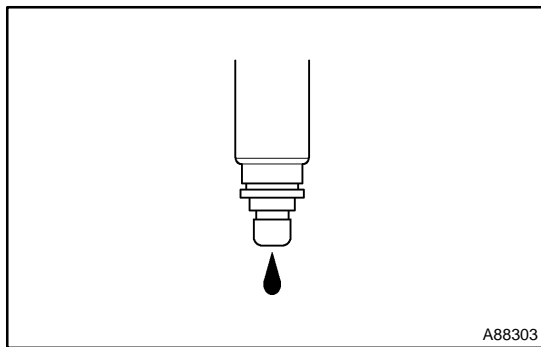

- (c) Inspect the leakage.
  - (1) In the condition that the injection volume was inspected, remove SST from the battery. Inspect the fuel leakage from the fuel injector.

**Standard: 1 drop or less per 12 minutes**

If the fuel leakage is not as specified, replace the fuel injector.

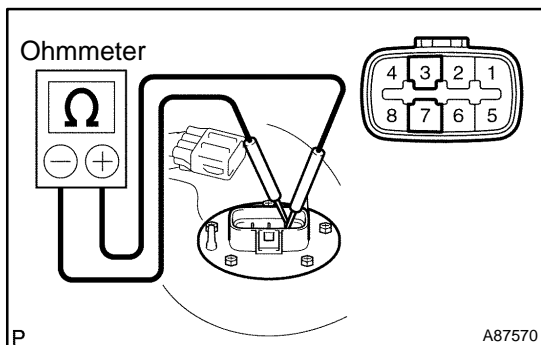

**2. INSPECT FUEL TANK ASSY (FUEL PUMP)**

- (a) Inspect the resistance.
  - (1) Using an ohmmeter, measure the resistance between the terminals.

**Standard:**

Tester Connection	Specified Condition
3 - 7	0.2 to 3.0 Ω at 20°C (68°F)

If the resistance is not as specified, replace the fuel tank.

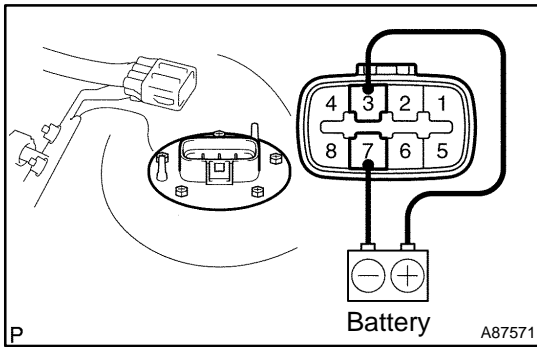

- (b) Check the operation.
- (1) Check that the motor operates when battery voltage is applied across the terminals.

**NOTICE:**

- **Perform the check quickly (shorter than 10 seconds).**
- **Keep the battery as far away the fuel tank as possible.**
- **Always do the switching at the battery side.**

If the motor does not operate, replace the fuel tank.