

WATER PUMP COMPONENTS

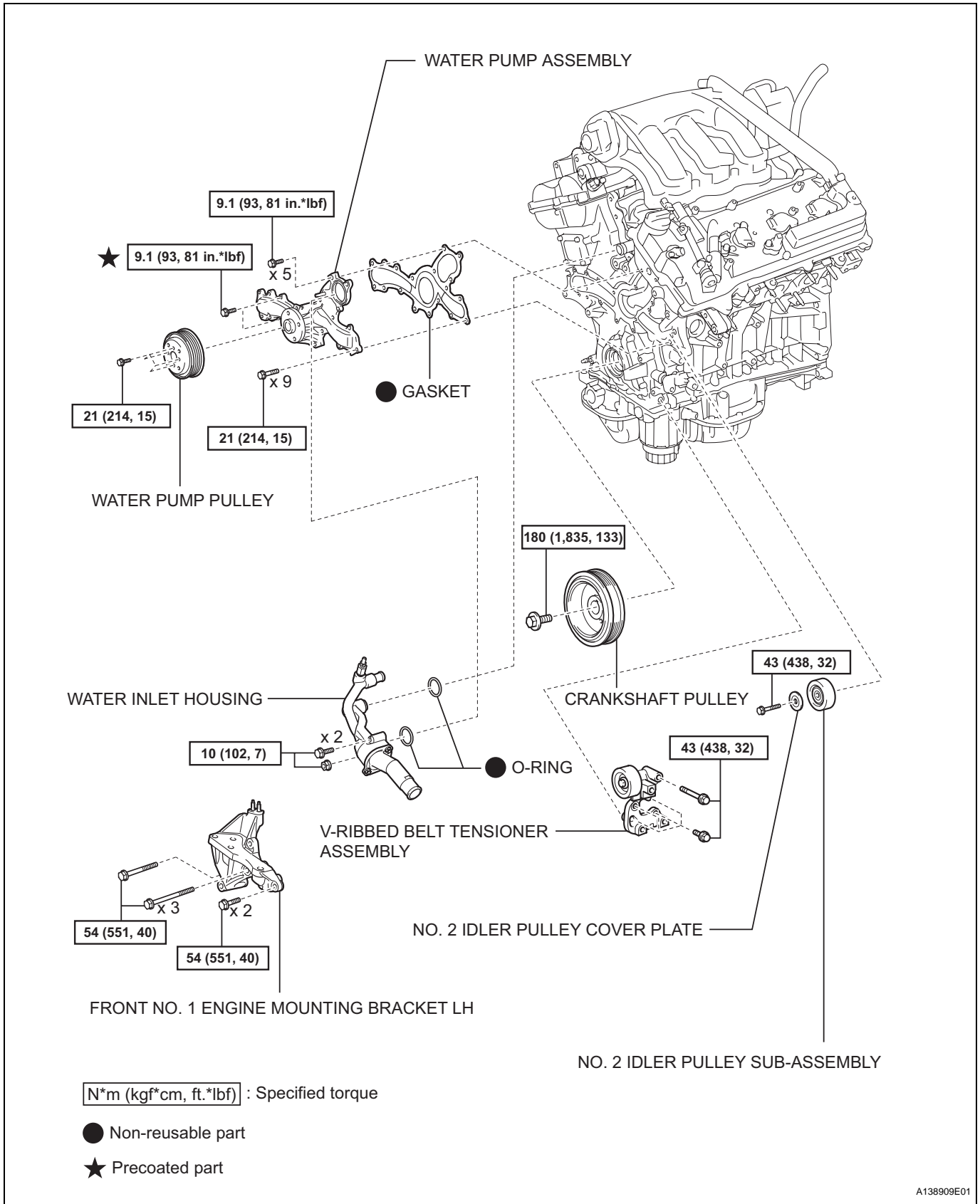

CO

REMOVAL

1. REMOVE ENGINE ASSEMBLY

- (a) Remove the engine (see page [EM-21](#)).

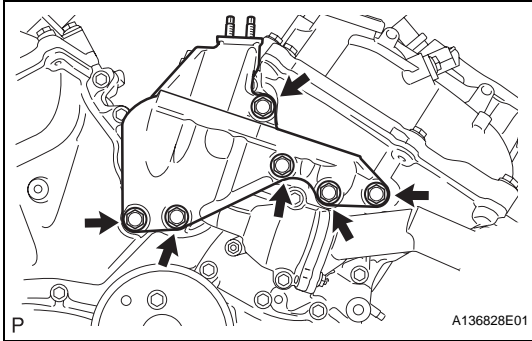

2. REMOVE FRONT NO. 1 ENGINE MOUNTING BRACKET LH

- (a) Remove the 6 bolts and mounting bracket.

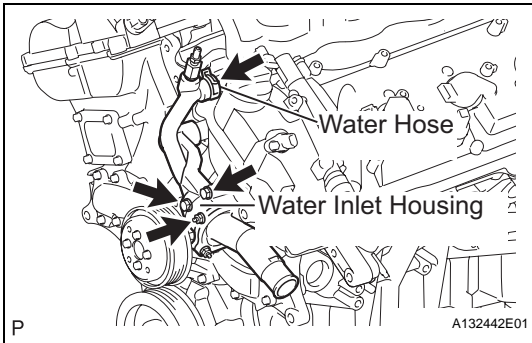

3. REMOVE WATER INLET HOUSING

- (a) Disconnect the water hose.
 (b) Remove the 2 bolts, nut and water inlet housing.

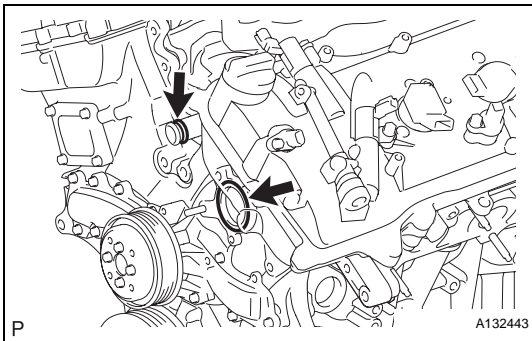

- (c) Remove the water inlet housing No. 1 gasket and water outlet pipe O-ring.

4. REMOVE CRANKSHAFT PULLEY (See page [EM-54](#))

5. REMOVE WATER PUMP PULLEY

- (a) Using SST, hold the water pump pulley.
SST 09960-10010 (09962-01000, 09963-00700)
 (b) Remove the 4 bolts and water pump pulley.

