

# REAR WIPER MOTOR

## COMPONENTS

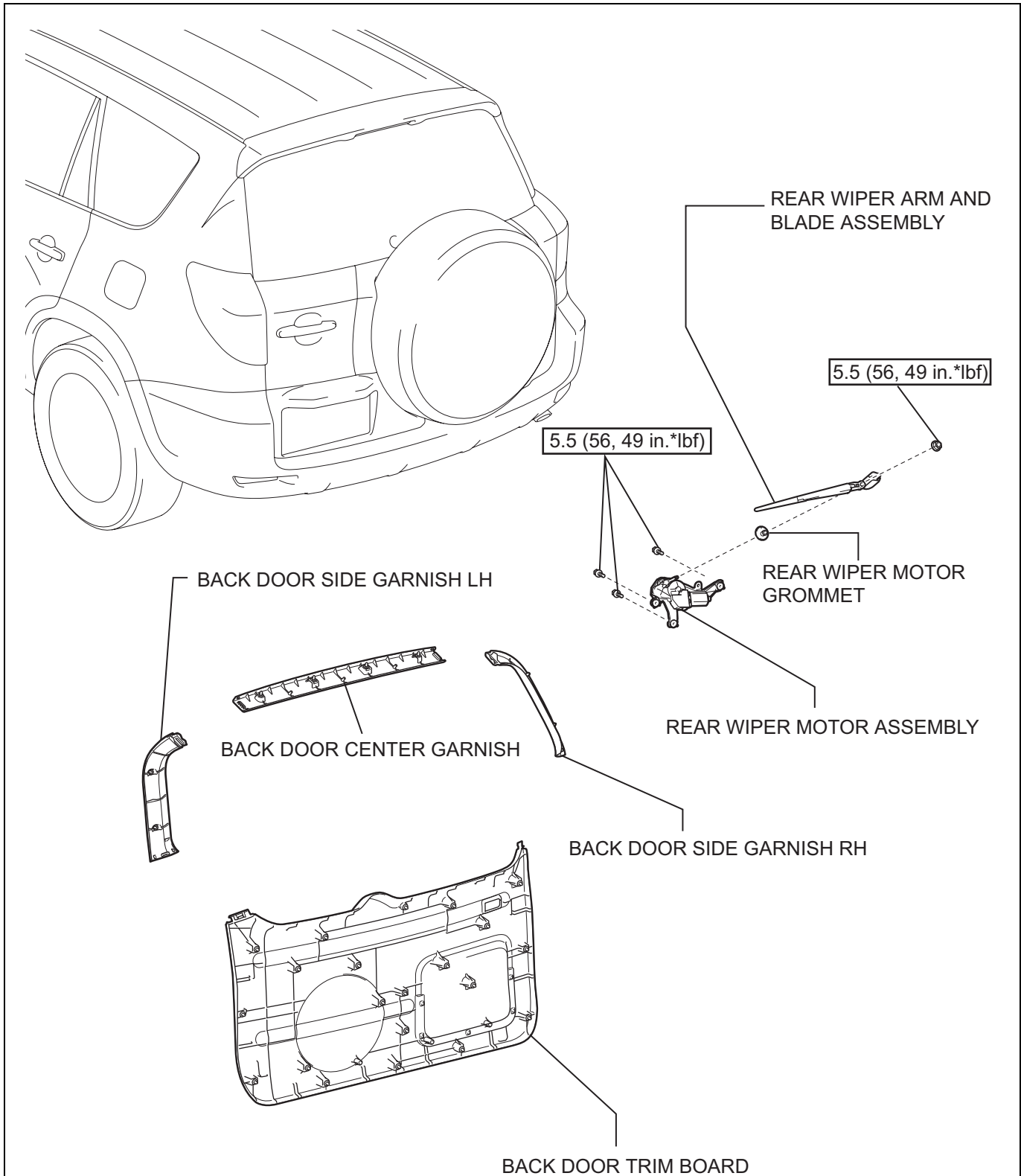

**N\*m (kgf\*cm, ft.\*lbf)** : Specified torque

WW

## REMOVAL

1. DISCONNECT CABLE FROM NEGATIVE BATTERY TERMINAL

### CAUTION:

Wait at least 90 seconds after disconnecting the cable from the negative (-) battery terminal to prevent airbag and seat belt pretensioner activation.

2. REMOVE BACK DOOR CENTER GARNISH (See page [ED-59](#))
3. REMOVE BACK DOOR SIDE GARNISH LH (See page [ED-59](#))
4. REMOVE BACK DOOR SIDE GARNISH RH (See page [ED-59](#))
5. REMOVE BACK DOOR TRIM BOARD (See page [ED-59](#))
6. REMOVE REAR WIPER ARM AND BLADE ASSEMBLY

(a) Widen each end of the cap 5 mm (0.19in).

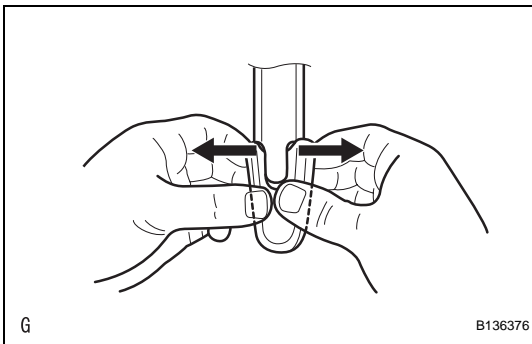

(b) Lift the both widened ends of the cap.

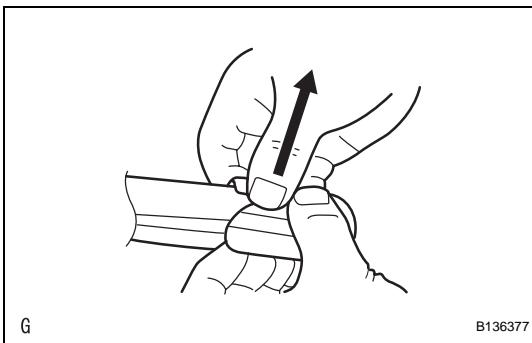

(c) Rotate the cap. Fix the cap in place.

