

UNDERDRIVE CLUTCH

COMPONENTS

AX

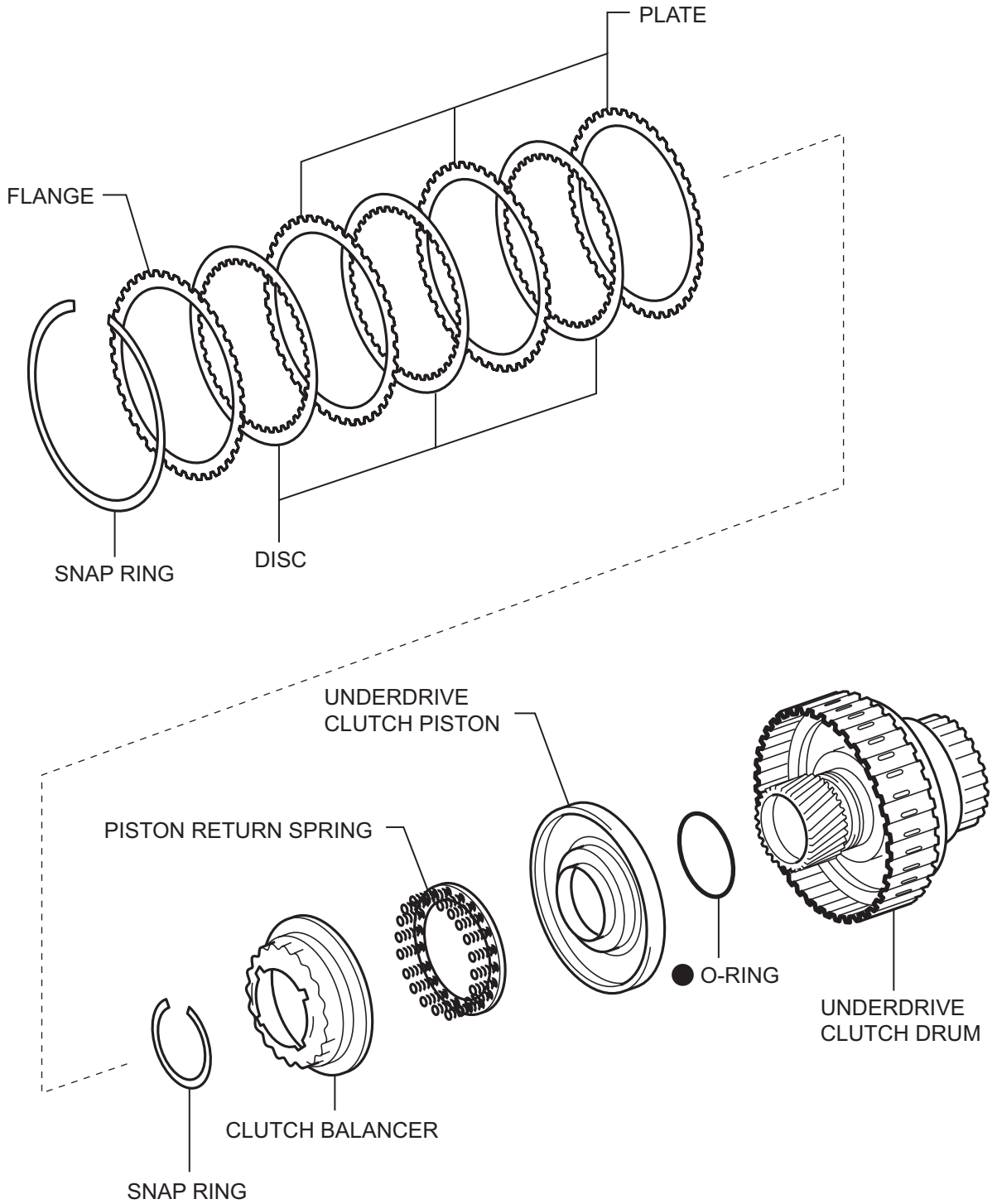

● Non-reusable part

DISASSEMBLY

1. **INSPECT UNDERDRIVE PACK CLEARANCE** (See page [AX-247](#))

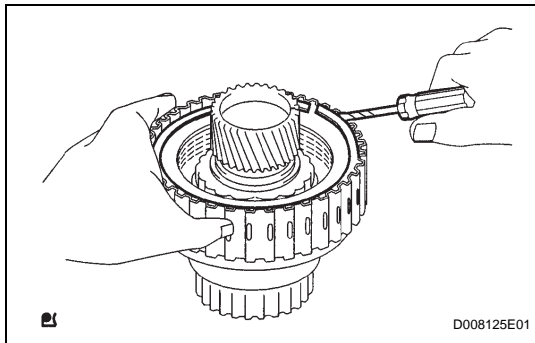

2. **REMOVE NO. 1 UNDERDRIVE CLUTCH DISC**
 - (a) Using a screwdriver, pry out the snap ring.

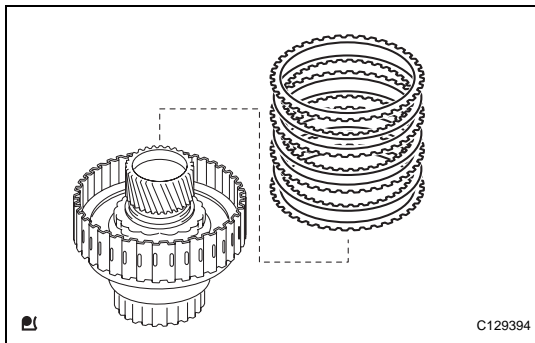

- (b) Remove the flange, 3 discs and 3 plates from the underdrive clutch drum.

3. **INSPECT NO. 1 UNDERDRIVE CLUTCH DISC** (See page [AX-248](#))

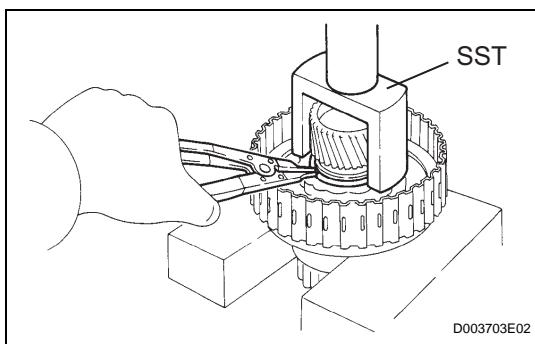

4. **REMOVE UNDERDRIVE CLUTCH PISTON SET**

- (a) Place SST on the clutch balancer and compress the spring with a press.

SST 09350-32014 (09351-32070)

- (b) Using a snap ring expander, remove the snap ring.

NOTICE:

- Stop the press when the spring sheet is lowered to the place 1 to 2 mm (0.039 to 0.078 in.) from the snap ring groove.
- This prevents the spring sheet from being deformed.
- Do not expand the snap ring excessively.

- (c) Remove the clutch balancer and piston return spring from the underdrive clutch drum.

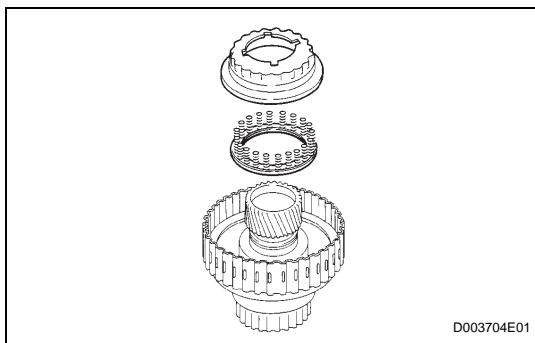

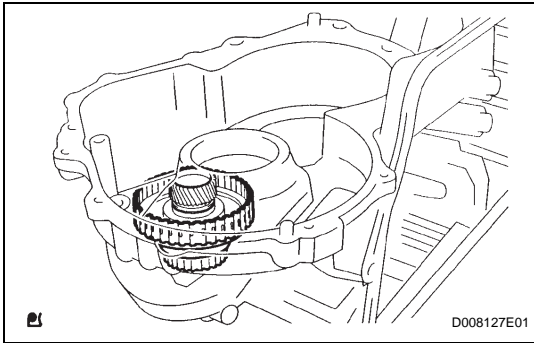

(d) Install the underdrive clutch to the transaxle case.

NOTICE:

Be careful not to damage the oil seal rings.

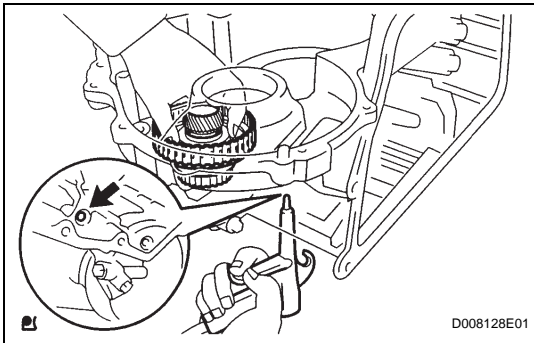

(e) Holding the underdrive clutch piston with your hand, apply compressed air (392 kPa, 4.0 kgf/cm², 57 psi) to the transaxle case to remove the underdrive clutch piston.

5. **INSPECT UNDERDRIVE CLUTCH RETURN SPRING SUB-ASSEMBLY** (See page [AX-248](#))

6. **REMOVE UNDERDRIVE CLUTCH DRUM O-RING**

7. **INSPECT UNDERDRIVE CLUTCH DRUM SUB-ASSEMBLY** (See page [AX-248](#))

