

INSTALLATION

1. INSTALL REAR NO. 1 SEAT ASSEMBLY RH (w/o Rear No. 2 Seat)

- (a) Fully tilt the seatback forward.
- (b) Place the seat in the cabin.

NOTICE:

Be careful not to damage the vehicle body.

- (c) Connection procedures of seat to lock cable when reusing seat:

- (1) Using a screwdriver, detach the claw and remove the connector case from the seat.

HINT:

Tape the screwdriver tip before use.

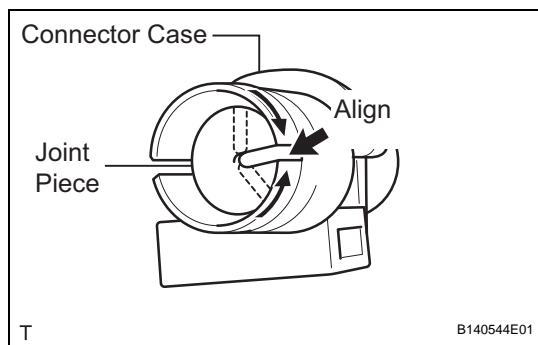
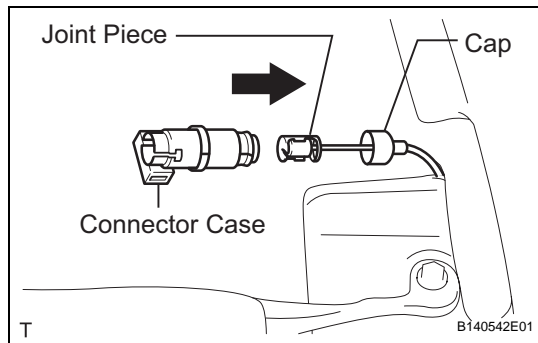
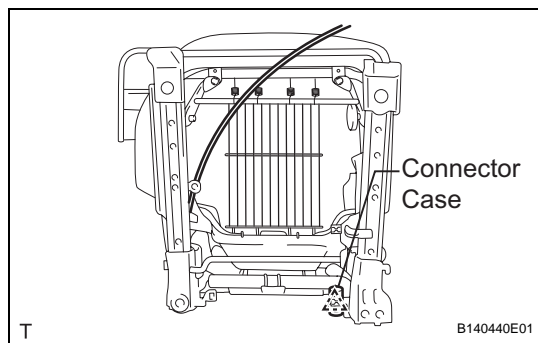
SE

- (2) Install the connector case to the body's cap.

- (3) Pull out the joint piece. Align the slits of the joint piece and connector case.

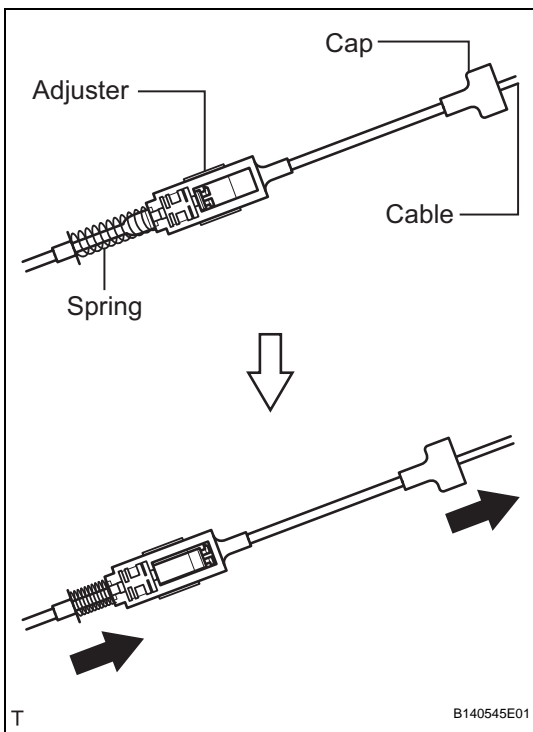

- (4) Compress the spring of the adjuster, and pull out the cable from the seat's cap.

HINT:

Perform this procedure with the lock of the adjuster released.

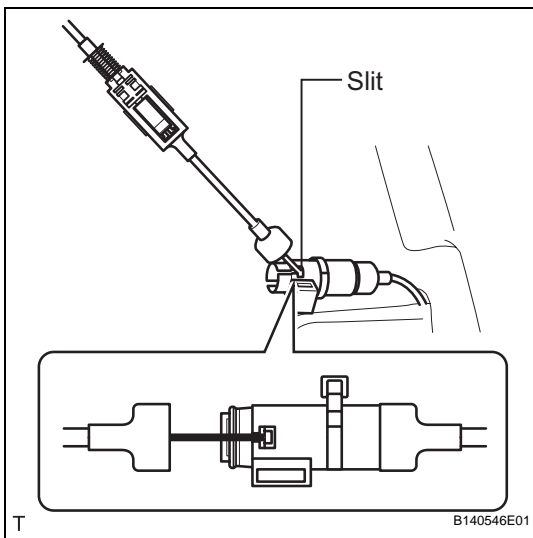

- (5) Install the seat cable's end part to the connector case's slit.

HINT:

Position the joint piece cable's end part as shown in the illustration.

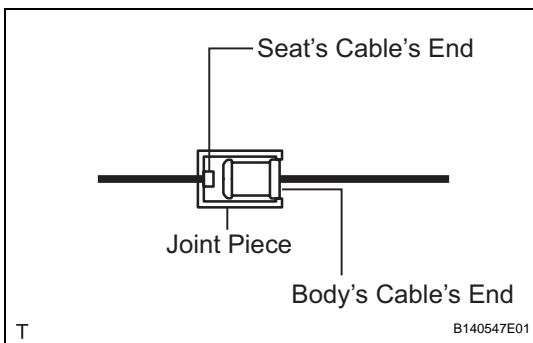

SE

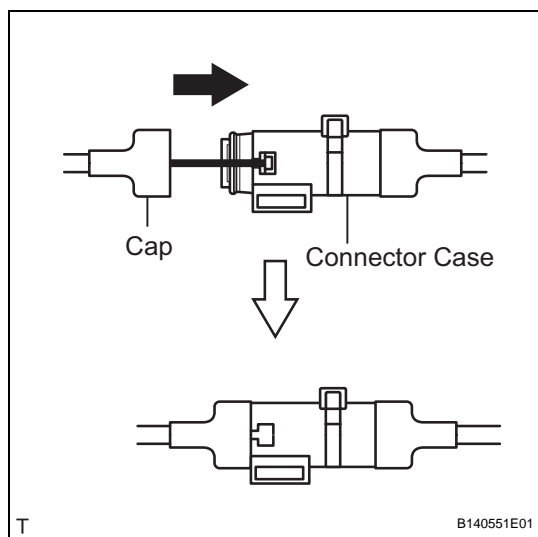

- (6) Install the seat's cap to the connector case.
- (7) Temporarily place the seat into the vehicle where it will be installed.

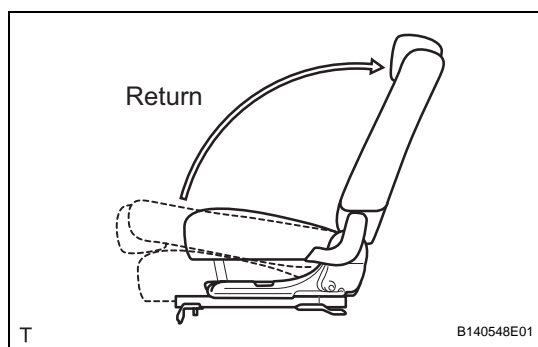

- (8) Return the seatback to the upright position.

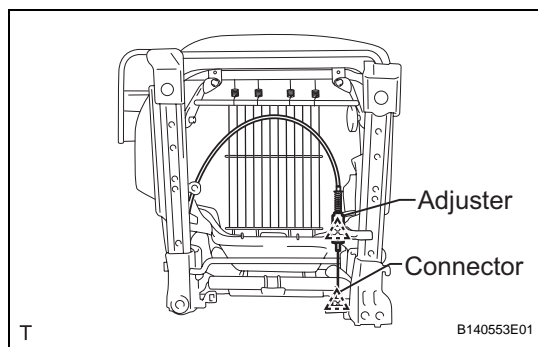

- (9) Attach the claws of the connector and adjuster, and install them to the seat.

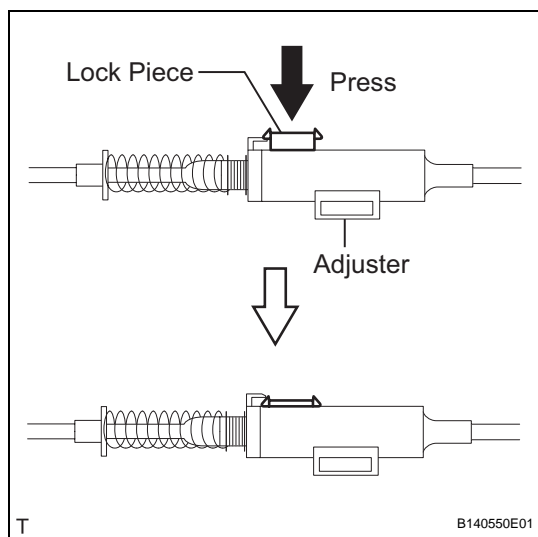

- (10) Press the adjuster's lock piece to lock it.

NOTICE:

When pressing the lock piece, make sure the adjuster's spring is not compress.

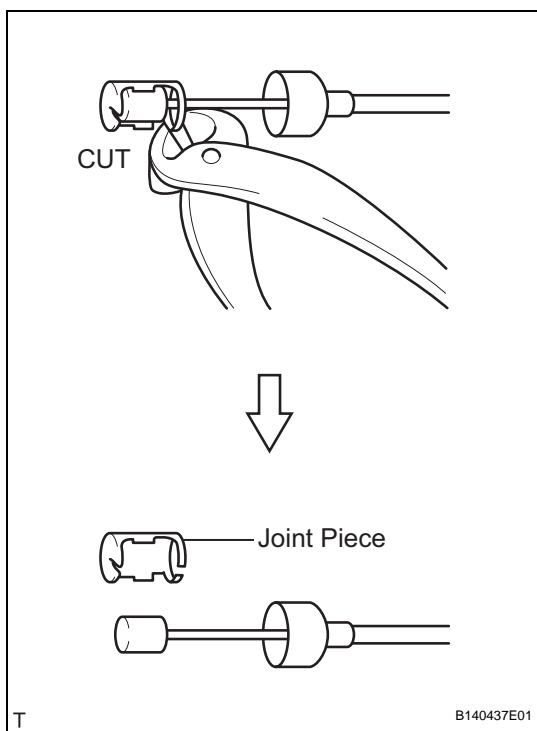

(d) Connection procedures of seat to lock cable when replacing seat:

- (1) Cut the joint piece on the lock cable, and remove it.

HINT:

- A joint piece is included with new seats.
- This procedure is not necessary when the lock cable is replaced with a new one.

- (2) Temporarily place the seat into the vehicle where it will be installed.

SE

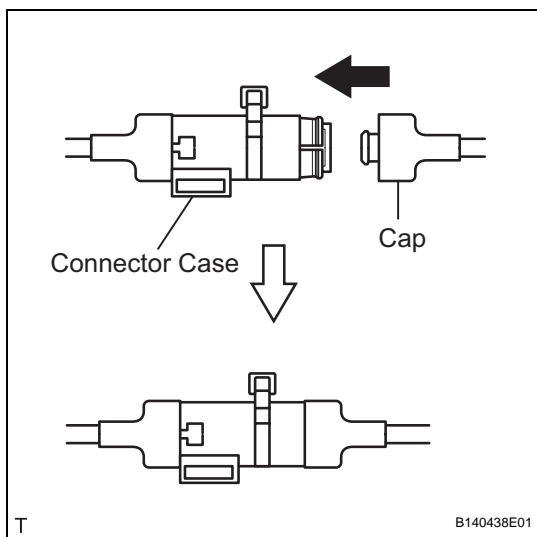

- (3) Install the body's cap to the connector case.

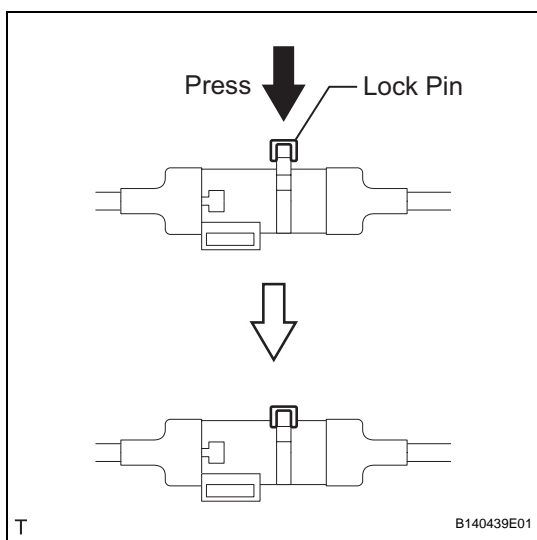

- (4) Press the adjuster's lock pin.

SE

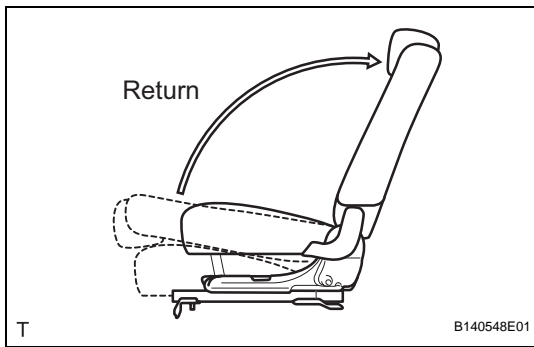

- (5) Return the seatback to the upright position.

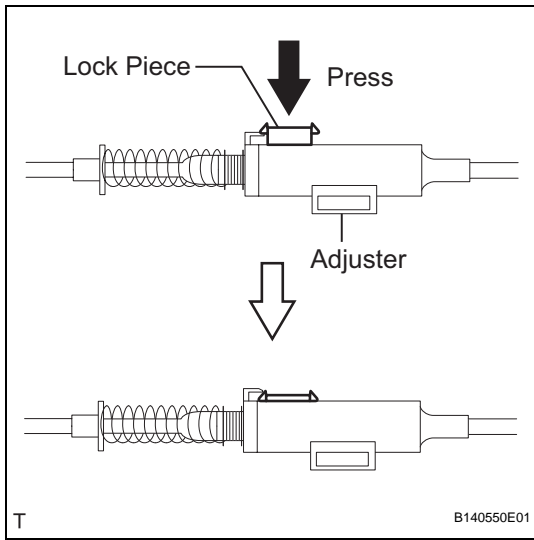

- (6) Press the adjuster's lock piece to lock it.

NOTICE:

When pressing the lock piece, make sure the adjuster's spring is not compressed.

- (e) Lift up the seat track adjusting handle and move the seat to the foremost position.

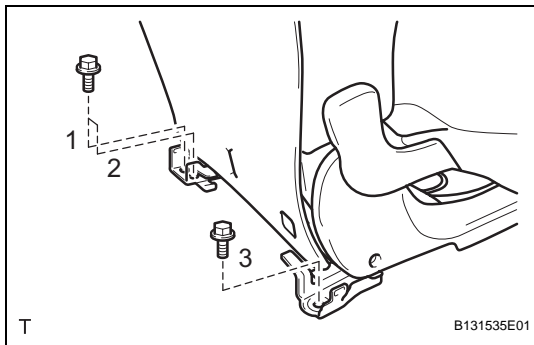

- (f) Tighten the 2 bolts on the rear side of the seat.

Torque: 42 N*m (428 kgf*cm, 31 ft.*lbf)

HINT:

Tighten the bolts in the order indicated in the illustration.

- (g) Lift up the seat track adjusting handle and move the seat to the rearmost position.

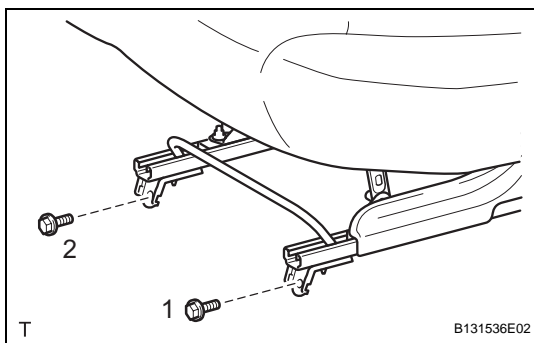

- (h) Tighten the 2 bolts on the front side of the seat.

Torque: 42 N*m (428 kgf*cm, 31 ft.*lbf)

HINT:

Tighten the bolts in the order indicated in the illustration.

2. INSTALL REAR NO. 1 SEAT ASSEMBLY RH (w/ Rear No. 2 Seat)

- (a) Fully tilt the seatback forward.

- (b) Place the seat in the cabin.

NOTICE:

Be careful not to damage the vehicle body.

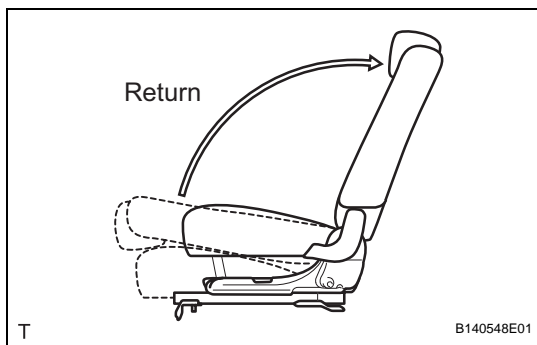

- (c) Return the seatback to the upright position.
- (d) Lift up the seat track adjusting handle and move the seat to the foremost position.

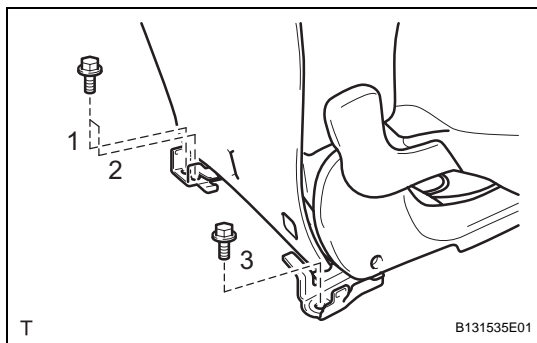

- (e) Tighten the 2 bolts on the rear side of the seat.
Torque: 42 N*m (428 kgf*cm, 31 ft.*lbf)
HINT:
Tighten the bolts in the order indicated in the illustration.
- (f) Lift up the seat track adjusting handle and move the seat to the rearmost position.

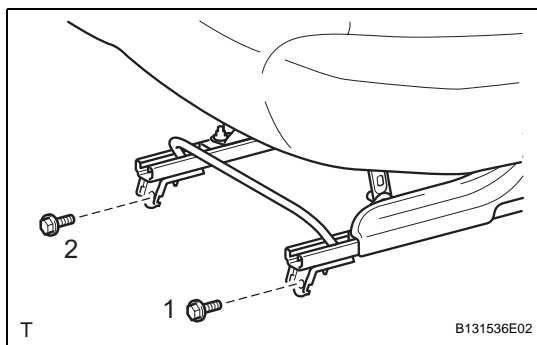

- (g) Tighten the 2 bolts on the front side of the seat.
Torque: 42 N*m (428 kgf*cm, 31 ft.*lbf)
HINT:
Tighten the bolts in the order indicated in the illustration.

3. INSTALL REAR NO. 1 SEAT LOCK CABLE ASSEMBLY (w/o Rear No. 2 Seat)

- (a) Attach the clamps and install the cable to the vehicle body.

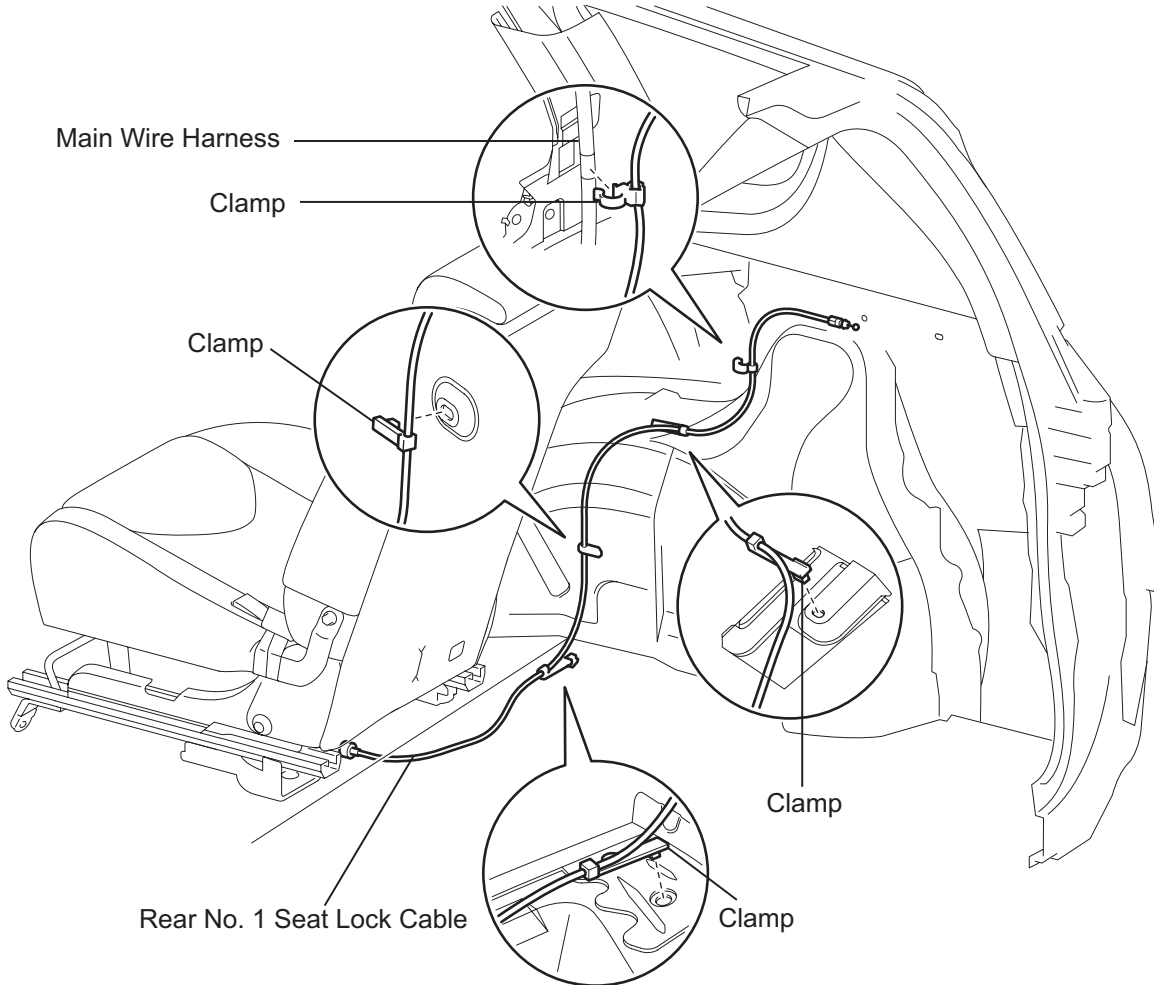

T

B132540E01

4. INSTALL REAR SEAT LEG COVER

- (a) Attach the 8 claws to install the 2 leg covers.

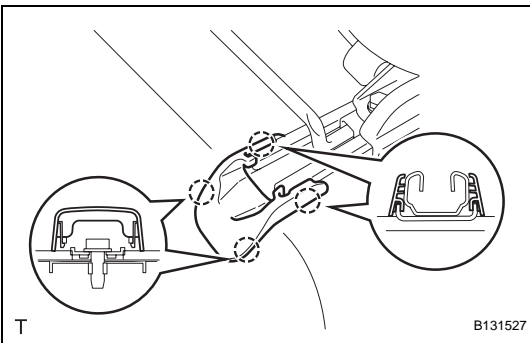

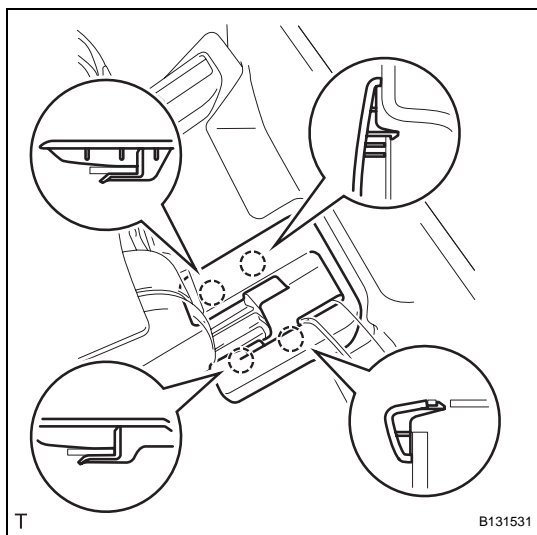

5. INSTALL REAR NO. 3 SEAT LEG SIDE COVER (w/ Rear No. 2 Seat)

- (a) Attach the 4 claws to install the rear No. 3 seat leg side cover.

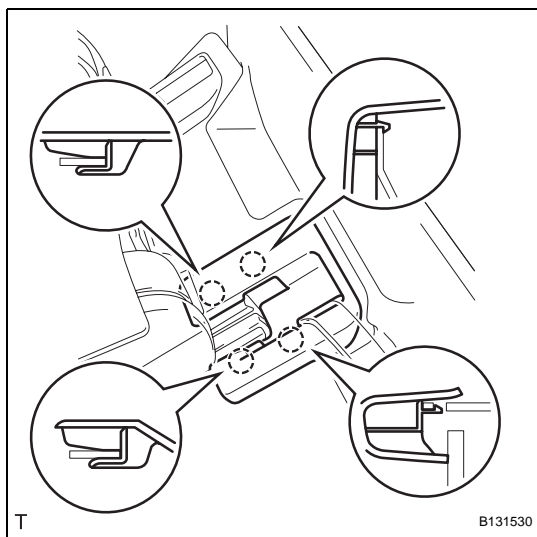

6. INSTALL REAR NO. 3 SEAT LEG SIDE COVER (w/o Rear No. 2 Seat)

- (a) Attach the 4 claws to install the No. 3 rear seat leg side cover.

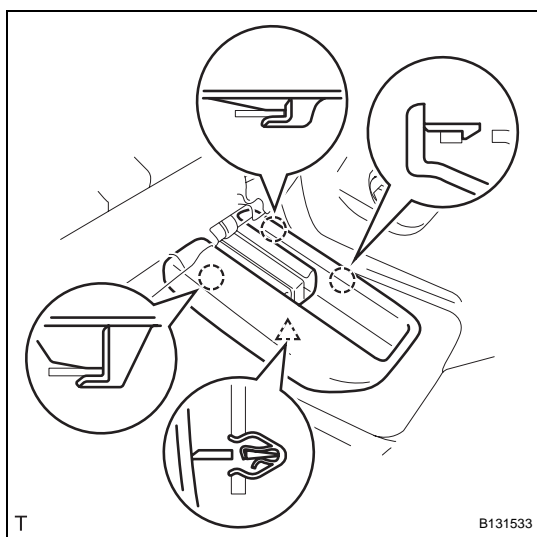

7. INSTALL REAR NO. 2 SEAT LEG SIDE COVER

- (a) Attach the 3 claws and clip to install the rear No. 2 seat leg side cover.

8. INSTALL RECLINING REMOTE CONTROL LEVER SUB-ASSEMBLY RH (w/o Rear No. 2 Seat)

- (a) Connect the rear No. 1 seat lock cable to the lever.

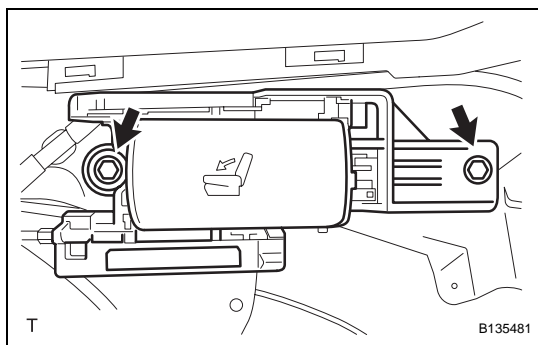

(b) Install the lever with the 2 bolts.

Torque: 18 N*m (184 kgf*cm, 13 ft.*lbf)

9. INSTALL DECK TRIM SIDE PANEL ASSEMBLY RH (w/o Rear No. 2 Seat) (See page [IR-53](#))

10. INSTALL TETHER ANCHOR BRACKET SUB-ASSEMBLY (w/o Rear No. 2 Seat) (See page [IR-54](#))

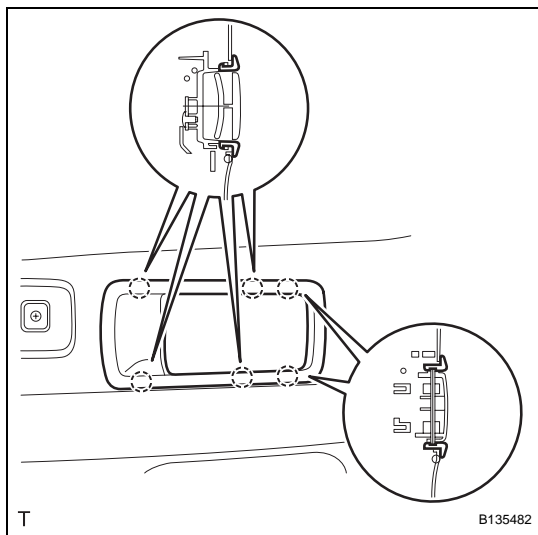

11. INSTALL RECLINING REMOTE CONTROL LEVER BEZEL RH (w/o Rear No. 2 Seat)

(a) Attach the 6 claws to install the bezel.

12. INSTALL REAR FLOOR FINISH PLATE (w/o Rear No. 2 Seat) (See page [IR-55](#))

13. INSTALL BACK DOOR WEATHERSTRIP (w/o Rear No. 2 Seat)

14. INSTALL REAR FLOOR NO. 1 MAT SUPPORT SIDE PLATE (w/o Rear No. 2 Seat) (See page [IR-55](#))

15. INSTALL REAR FLOOR NO. 3 BOARD (w/o Rear No. 2 Seat)

16. INSTALL REAR FLOOR NO. 2 BOARD (w/o Rear No. 2 Seat)

17. INSTALL DECK BOARD ASSEMBLY (w/o Rear No. 2 Seat)

18. INSTALL REAR FLOOR NO. 1 BOARD (w/o Rear No. 2 Seat)

19. INSTALL TONNEAU COVER ASSEMBLY (w/o Rear No. 2 Seat)

20. INSTALL PACKAGE TRAY TRIM POCKET SUB-ASSEMBLY (w/o Rear No. 2 Seat)