

## REASSEMBLY

**CAUTION:**

Wear protective gloves. Sharp areas on the seatback frame, seat cushion frame and reclining adjuster may injure your hands.

**HINT:**

A bolt without a torque specification is shown in the standard bolt chart (see page [SS-2](#)).

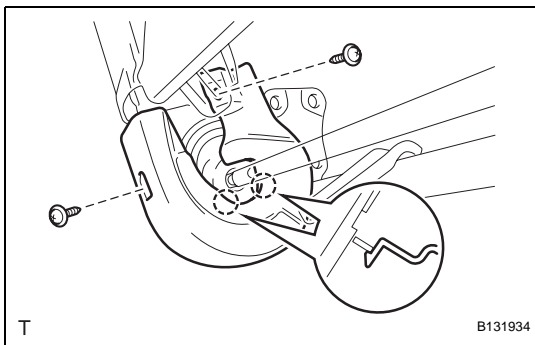
**1. INSTALL REAR SEATBACK COVER RH**

- (a) Attach the 2 claws to install the cover.
- (b) Install the 2 screws.

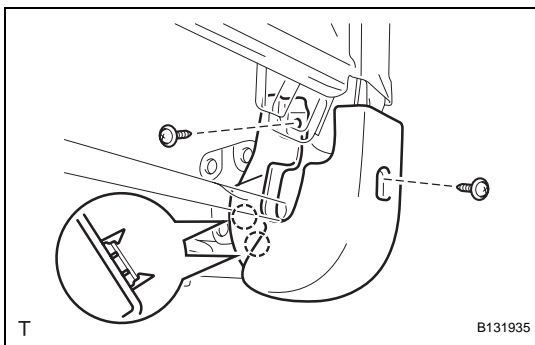
**2. INSTALL REAR SEAT COVER (w/o Rear No. 2 Seat)**

- (a) Attach the 2 claws to install the cover.
- (b) Install the 2 screws.

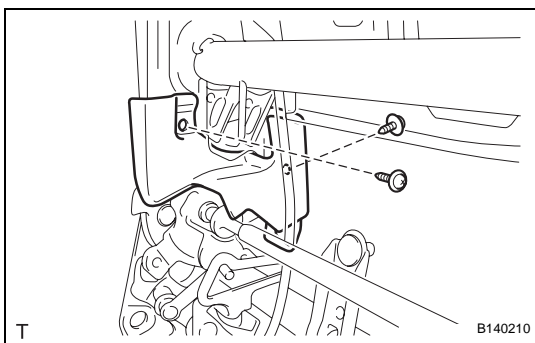
**3. INSTALL REAR SEAT COVER (w/ Rear No. 2 Seat)**

- (a) Install the cover with the 2 screws.

**4. INSTALL REAR NO. 1 SEATBACK COVER****NOTICE:**

- Be careful not to damage the cover.
- When installing the hog rings, avoid wrinkling the cover.

SE

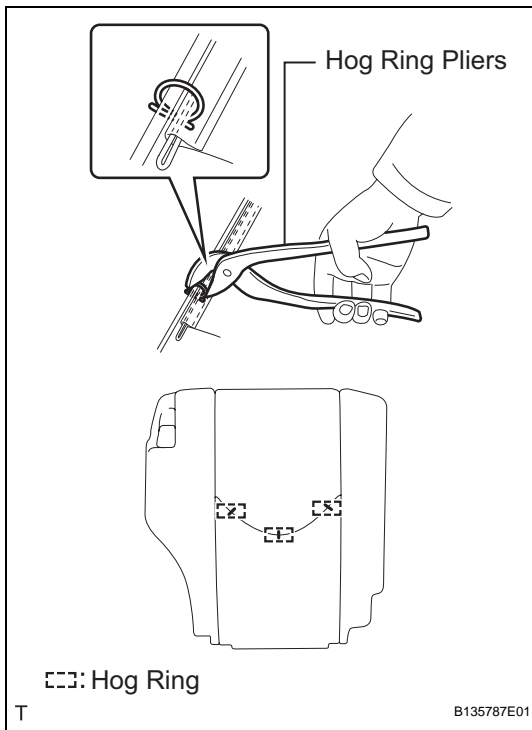

- (a) Using hog ring pliers, install the seatback cover to the seatback pad with 3 new hog rings.
- (b) Install the seatback cover (with pad) to the seatback frame.

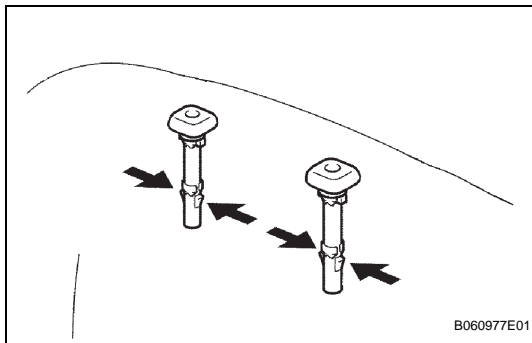

- (c) Attach the 4 claws to install the 2 headrest supports.

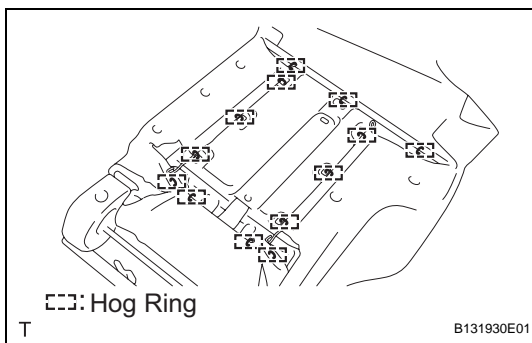

- (d) Lift up the seatback cover and install the 13 hog rings.

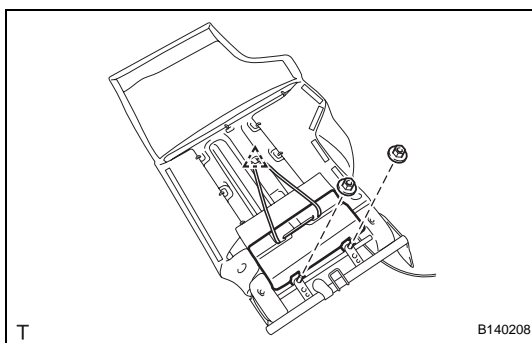

## 5. INSTALL REAR SEATBACK PROTECTOR

- (a) Install the protector with the 2 nuts.  
**Torque: 20 N\*m (204 kgf\*cm, 15 ft.\*lbf)**
- (b) Attach the clip.

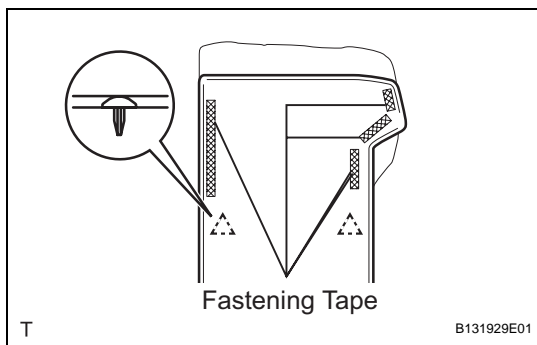

(c) Attach the 2 clips and close the fastening tape.

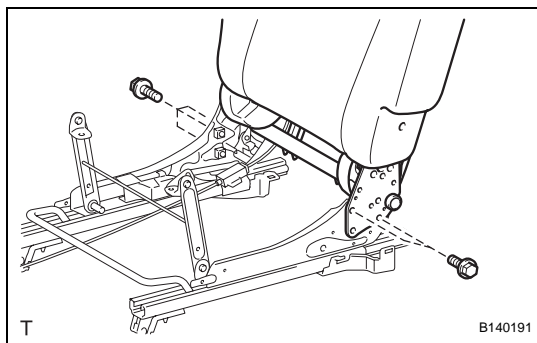

**6. INSTALL REAR NO. 1 SEATBACK ASSEMBLY RH (w/ o Rear No. 2 Seat)**

- (a) Install the seatback with the 5 bolts.  
**Torque: 42 N\*m (428 kgf\*cm, 31 ft.\*lbf)**

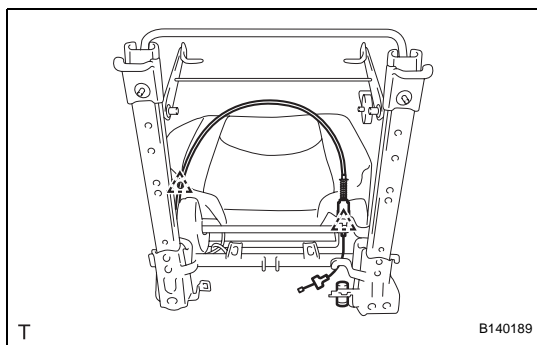

- (b) Attach the 2 clamps and connect the cable to the reclining adjuster.

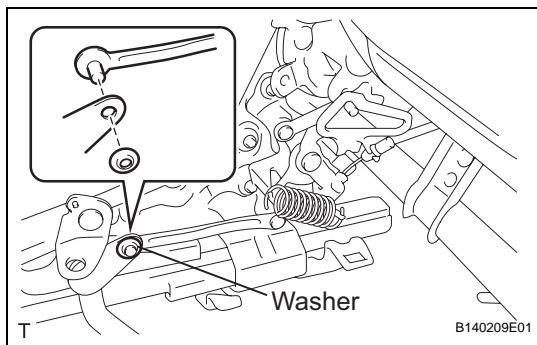

**7. INSTALL REAR NO. 1 SEATBACK ASSEMBLY RH (w/ Rear No. 2 Seat)**

- (a) Connect the W/I unit to the reclining adjuster with the washer.

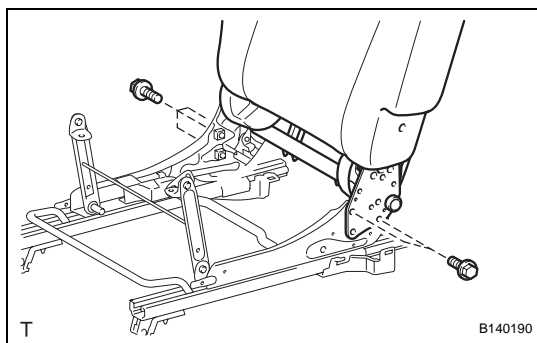

- (b) Install the seatback with the 5 bolts.  
**Torque: 42 N\*m (428 kgf\*cm, 31 ft.\*lbf)**

SE

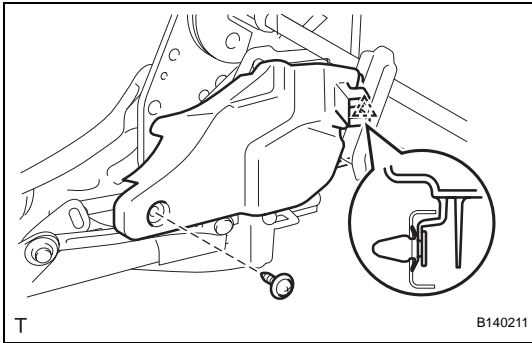

### 8. INSTALL REAR SEAT RECLINING INNER PROTECTOR RH (w/ Rear No. 2 Seat)

- Attach the clip to install the inner protector.
- Install the screw.

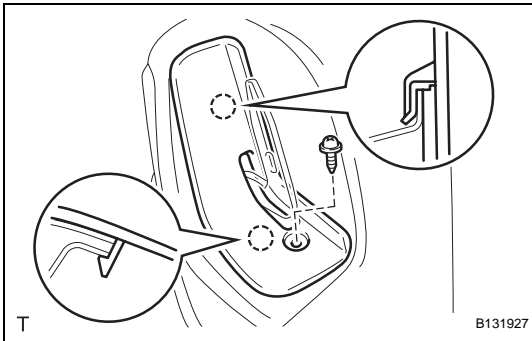

### 9. INSTALL REAR SEATBACK LOCK CONTROL LEVER BASE RH (w/o Rear No. 2 Seat)

- Attach the 2 claws to install the lever base.
- Install the screw.

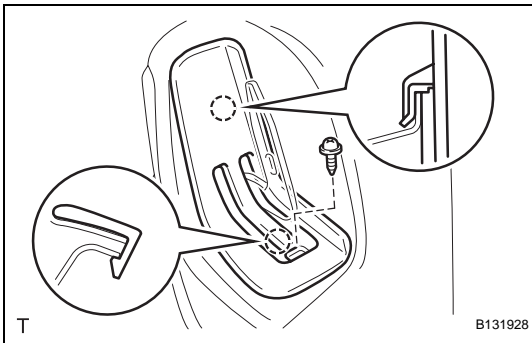

### 10. INSTALL REAR SEATBACK LOCK CONTROL LEVER BASE RH (w/ Rear No. 2 Seat)

- Attach the 2 claws to install the lever base.
- Install the screw.

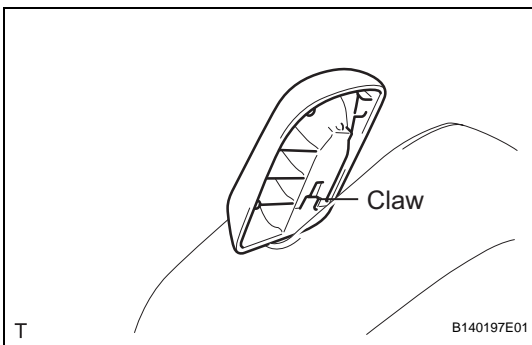

### 11. INSTALL REAR SEAT RECLINING RELEASE LEVER (w/o Rear No. 2 Seat)

- Attach the claw to install the release lever.

- Install the cover with the 2 screws.

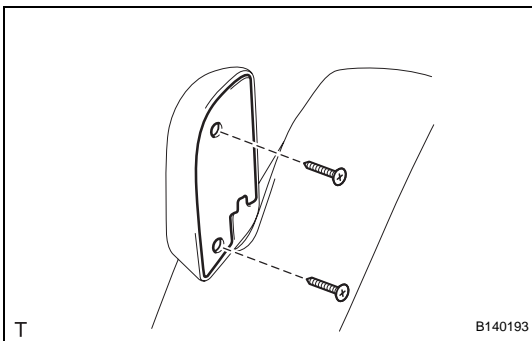

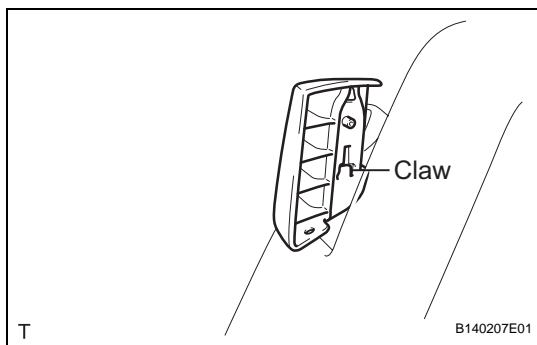
**12. INSTALL REAR SEAT RECLINING CONTROL LEVER (w/ Rear No. 2 Seat)**

(a) Attach the claw to install the control lever.

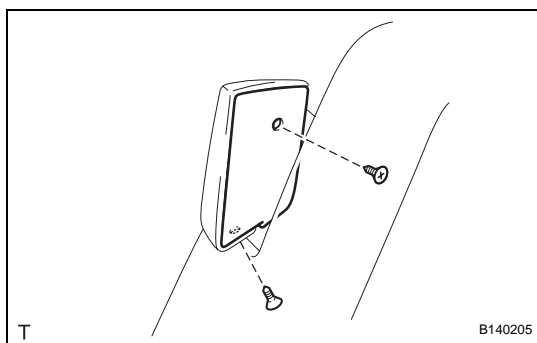

(b) Install the cover with the 2 screws.

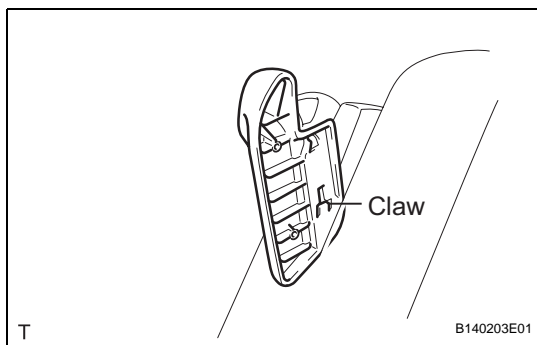
**13. INSTALL REAR SEAT RECLINING RELEASE LEVER (w/ Rear No. 2 Seat)**

(a) Attach the claw to install the release lever.

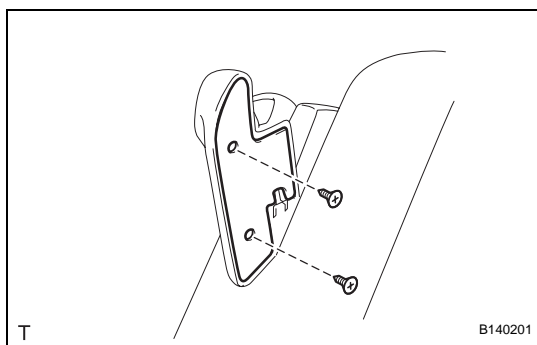

(b) Install the cover with the 2 screws.

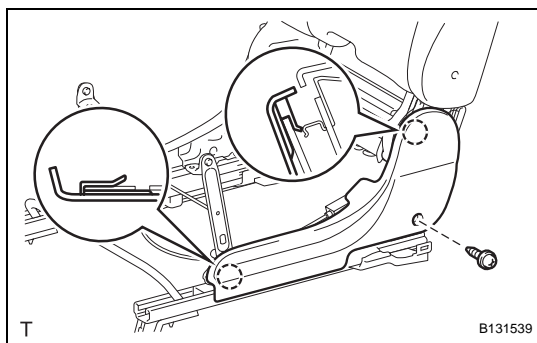
**14. INSTALL REAR SEAT CUSHION REAR MOULDING RH**

(a) Attach the 2 claws to install the moulding.

(b) Install the screw.

**15. INSTALL REAR SEAT CUSHION MOULDING RH**

HINT:

Use the same procedures described for the rear seat cushion rear moulding RH.

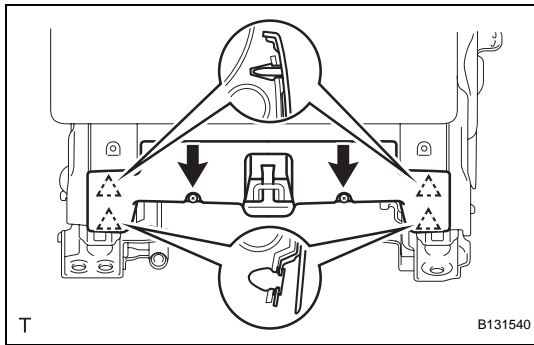
**16. INSTALL REAR SEAT REAR BRACKET COVER RH**

- (a) Open the lower part of the seatback cover. Then attach the 4 clips to install the bracket cover.
- (b) Install the 2 screws.

**17. INSTALL REAR NO. 1 SEAT CUSHION COVER****NOTICE:**

- Be careful not to damage the cover.
- When installing the hog rings, avoid wrinkling the cover.

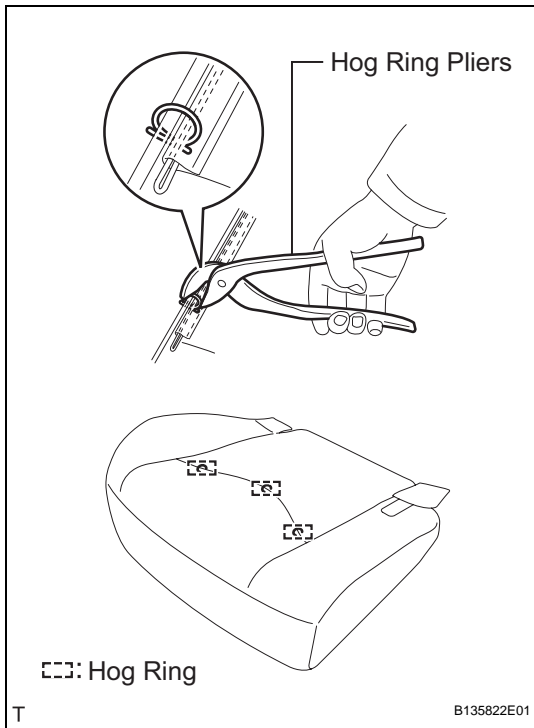

- (a) Using hog ring pliers, install the seat cushion cover to the seat cushion pad with 3 new hog rings.

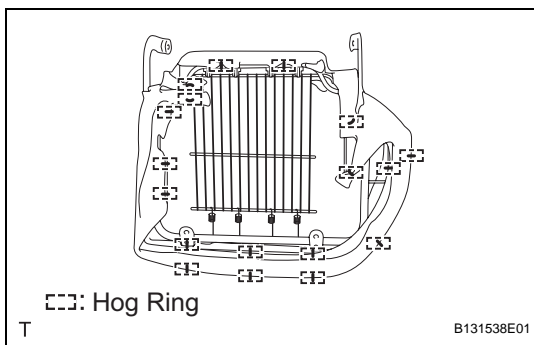

- (b) Using hog ring pliers, install the seat cushion cover (with pad) to the seat cushion frame with 18 new hog rings.

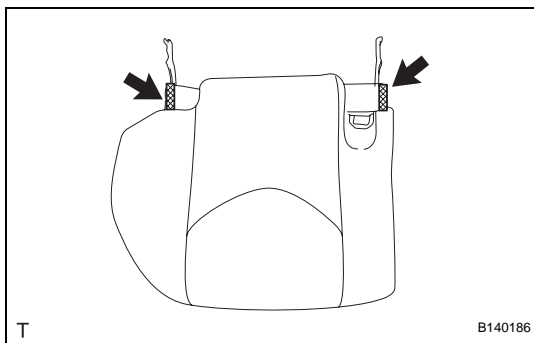

- (c) Attach the 2 hooks.

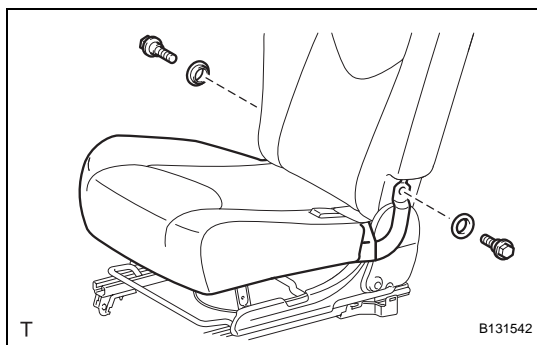
**18. INSTALL REAR NO. 1 SEAT CUSHION ASSEMBLY RH**

- (a) Install the cushion with the 2 bushes and 2 bolts.  
**Torque: 21 N\*m (214 kgf\*cm, 15 ft.\*lbf)**

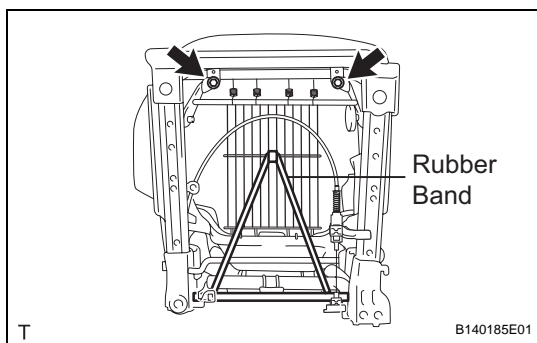

- (b) Install the 2 bolts.  
**Torque: 21 N\*m (214 kgf\*cm, 15 ft.\*lbf)**  
(c) Connect the rubber band of the seatback cover to the seat cushion frame.

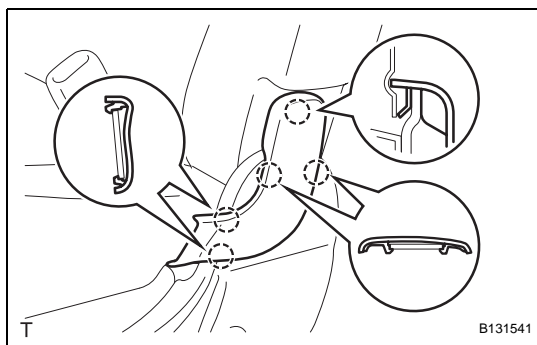
**19. INSTALL REAR SEAT INNER BELT ASSEMBLY RH (See page [SB-41](#))****20. INSTALL REAR NO. 2 SEAT CUSHION HINGE COVER**

- (a) Attach the 5 claws to install the hinge cover.

**21. INSTALL REAR NO. 1 SEAT CUSHION HINGE COVER**  
**HINT:**

Use the same procedures described for the rear No. 2 seat cushion hinge cover.

**22. INSTALL REAR SEAT HEADREST ASSEMBLY**