

## INSTALLATION

### 1. INSTALL REAR NO. 1 SEAT ASSEMBLY LH (w/o Rear No. 2 Seat)

- (a) Fully tilt the seatback forward.
- (b) Place the seat in the cabin.

**NOTICE:**

**Be careful not to damage the vehicle body.**

- (c) Connection procedures of seat to lock cable when reusing seat:

- (1) Using a screwdriver, detach the claw and remove the connector case from the seat.

**HINT:**

Tape the screwdriver tip before use.

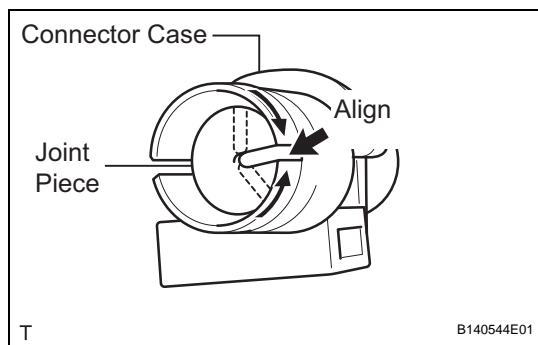
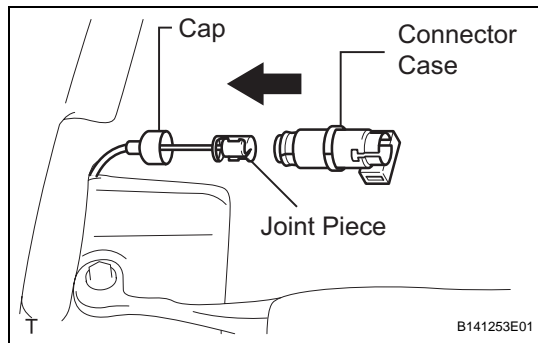
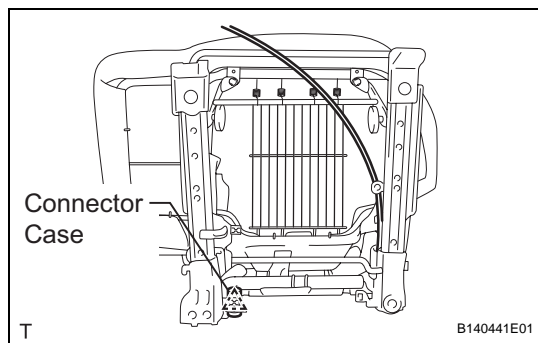
**SE**

- (2) Install the connector case to the body's cap.

- (3) Pull out the joint piece. Align the slits of the joint piece and connector case.

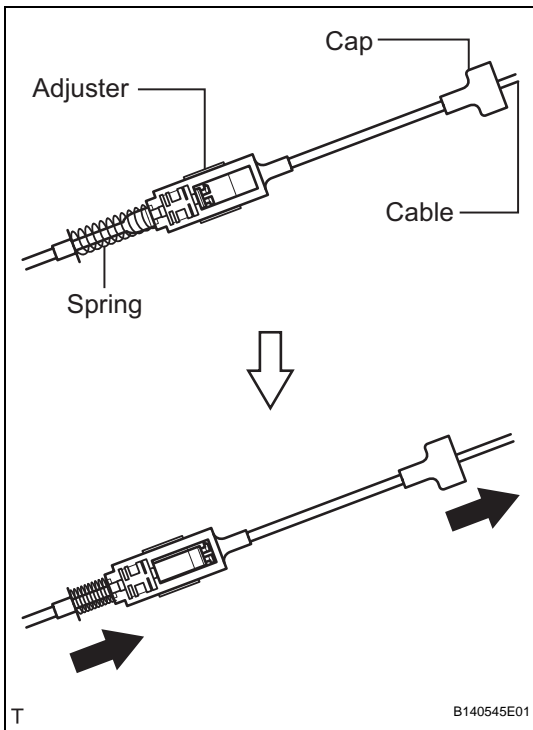

- (4) Compress the spring of the adjuster, and pull out the cable from the seat's cap.

HINT:

Perform this procedure with the lock of the adjuster released.

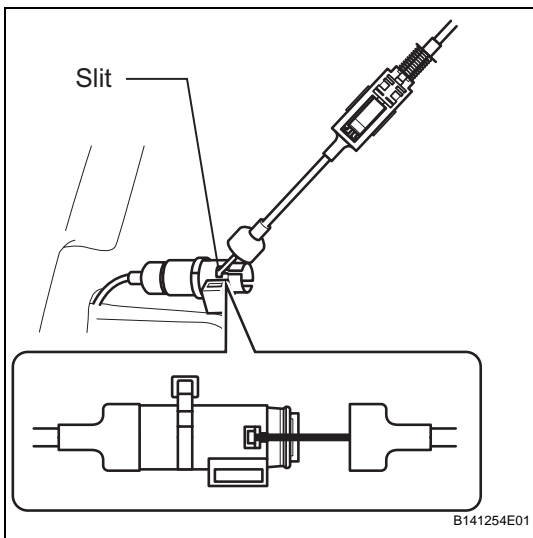

- (5) Install the seat cable's end part to the connector case's slit.

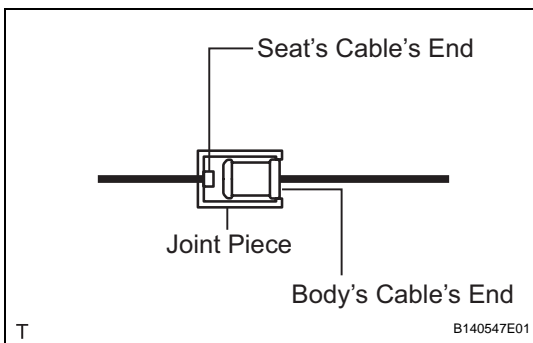

HINT:

Position the joint piece cable's end part as shown in the illustration.

SE

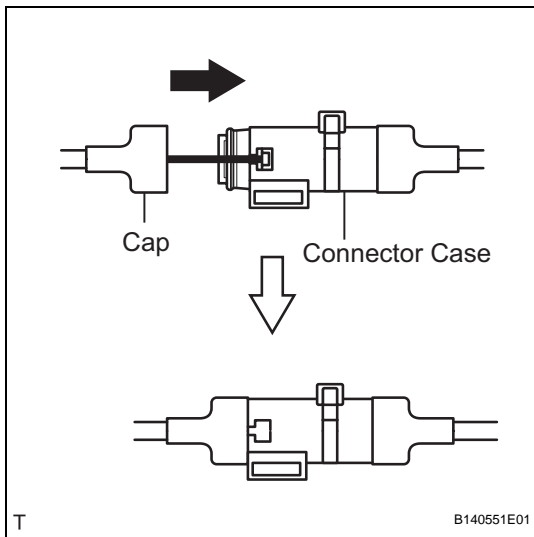

- (6) Install the seat's cap to the connector case.
- (7) Temporarily place the seat into the vehicle where it will be installed.

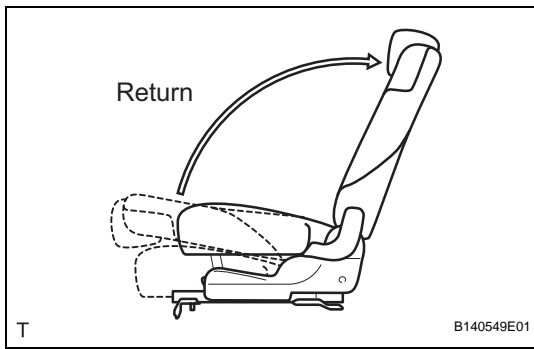

- (8) Return the seatback to the upright position.

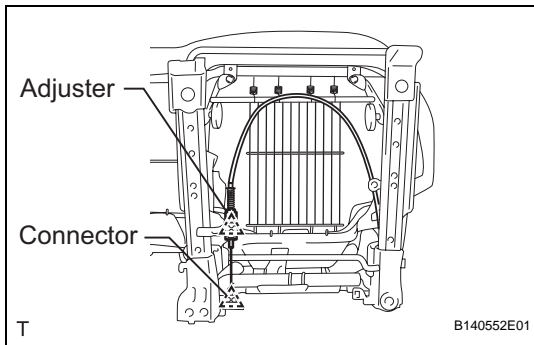

- (9) Attach the claws of the connector and adjuster, and install them to the seat.

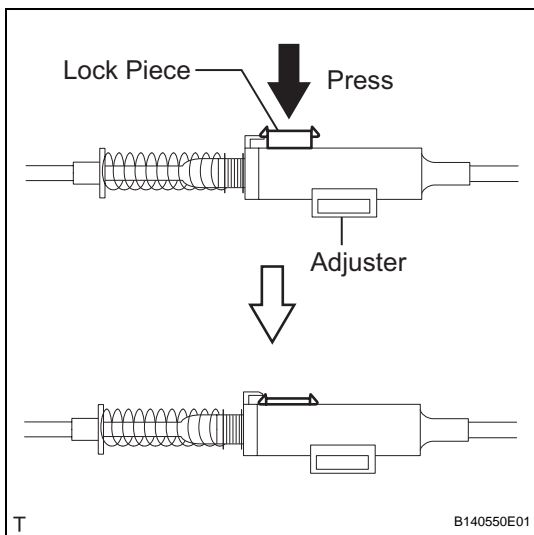

- (10) Press the adjuster's lock piece to lock it.

**NOTICE:**

**When pressing the lock piece, make sure the adjuster's spring is not compress.**

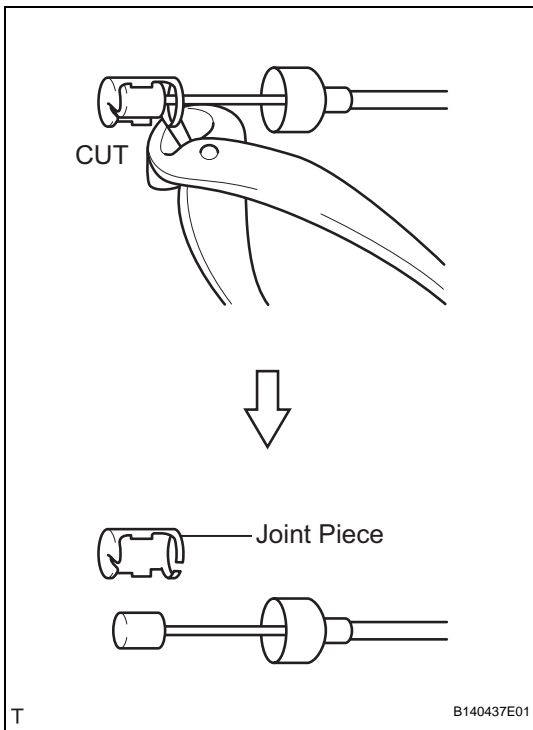

(d) Connection procedures of seat to lock cable when replacing seat:

- (1) Cut the joint piece on the lock cable, and remove it.

HINT:

- A joint piece is included with new seats.
- This procedure is not necessary when the lock cable is replaced with a new one.

- (2) Temporarily place the seat into the vehicle where it will be installed.

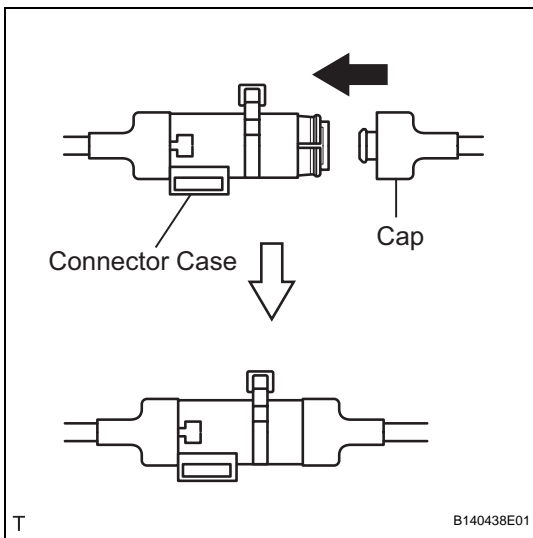

- (3) Install the body's cap to the connector case.

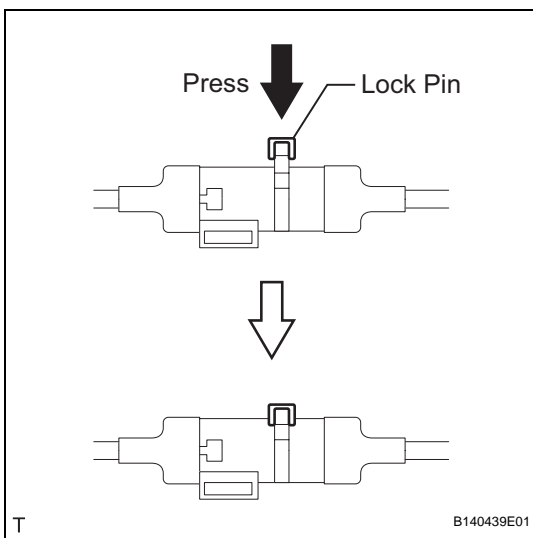

- (4) Press the adjuster's lock pin.

SE

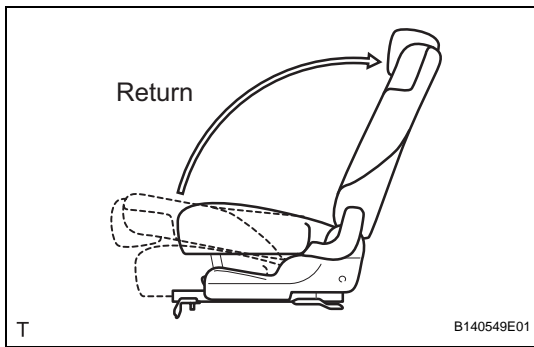

- (5) Return the seatback to the upright position.

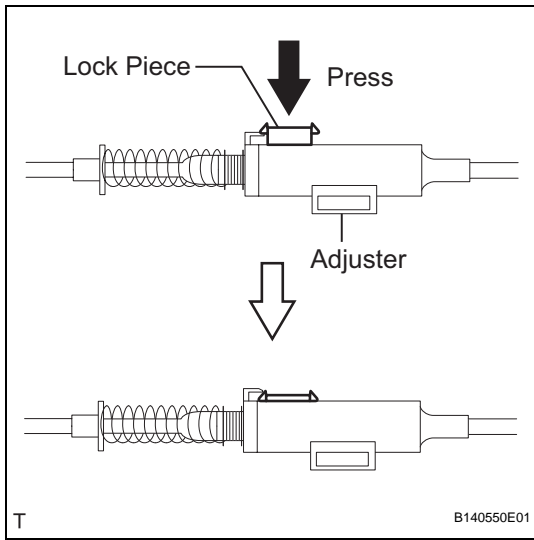

- (6) Press the adjuster's lock piece to lock it.

**NOTICE:**

**When pressing the lock piece, make sure the adjuster's spring is not compress.**

- (e) Lift up the seat track adjusting handle and move the seat to the foremost position.

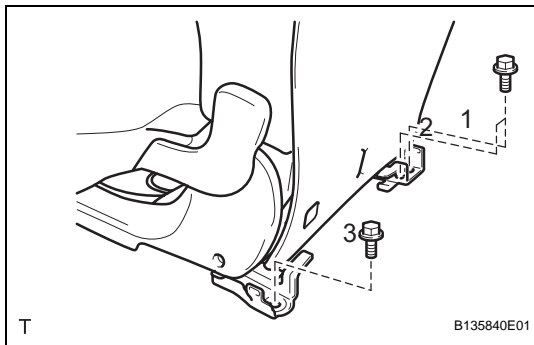

- (f) Tighten the 3 bolts on the rear side of the seat.

**Torque: 42 N\*m (428 kgf\*cm, 31 ft.\*lbf)**

**HINT:**

Tighten the bolts in the order indicated in the illustration.

- (g) Lift up the seat track adjusting handle and move the seat to the rearmost position.

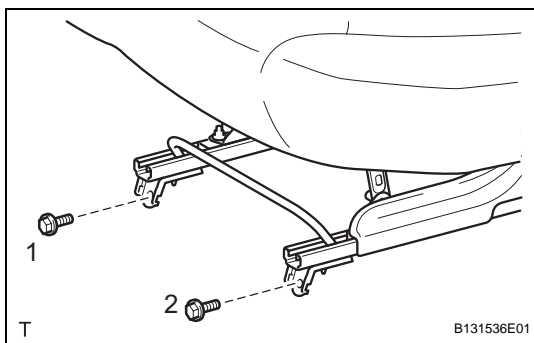

- (h) Tighten the 2 bolts on the front side of the seat.

**Torque: 42 N\*m (428 kgf\*cm, 31 ft.\*lbf)**

**HINT:**

Tighten the bolts in the order indicated in the illustration.

## 2. INSTALL REAR NO. 1 SEAT ASSEMBLY LH (w/ Rear No. 2 Seat)

- (a) Fully tilt the seatback forward.

- (b) Place the seat in the cabin.

**NOTICE:**

**Be careful not to damage the vehicle body.**

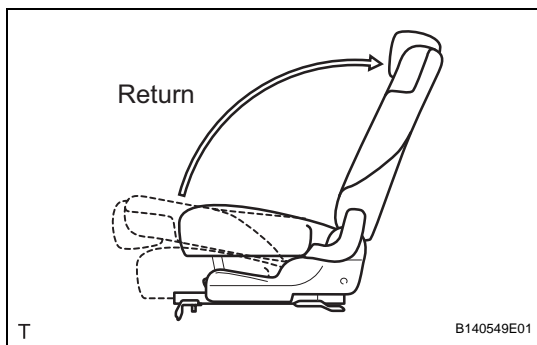

- (c) Return the seatback to the upright position.
- (d) Lift up the seat track adjusting handle and move the seat to the foremost position.

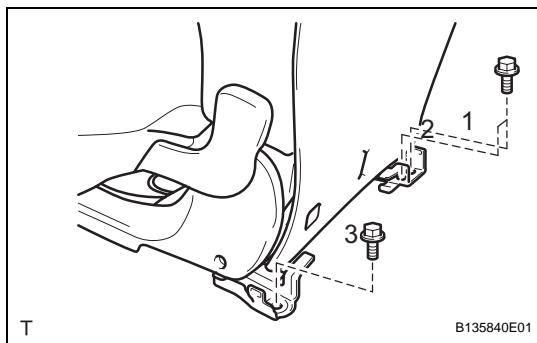

- (e) Tighten the 3 bolts on the rear side of the seat.  
**Torque: 42 N\*m (428 kgf\*cm, 31 ft.\*lbf)**  
HINT:  
Tighten the bolts in the order indicated in the illustration.
- (f) Lift up the seat track adjusting handle and move the seat to the rearmost position.

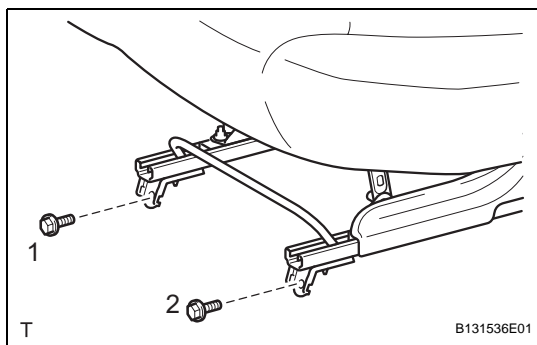

- (g) Tighten the 2 bolts on the front side of the seat.  
**Torque: 42 N\*m (428 kgf\*cm, 31 ft.\*lbf)**  
HINT:  
Tighten the bolts in the order indicated in the illustration.

### 3. INSTALL REAR NO. 1 SEAT LOCK CABLE ASSEMBLY (w/o Rear No. 2 Seat)

- (a) Attach the clamps and install the cable to the vehicle body.

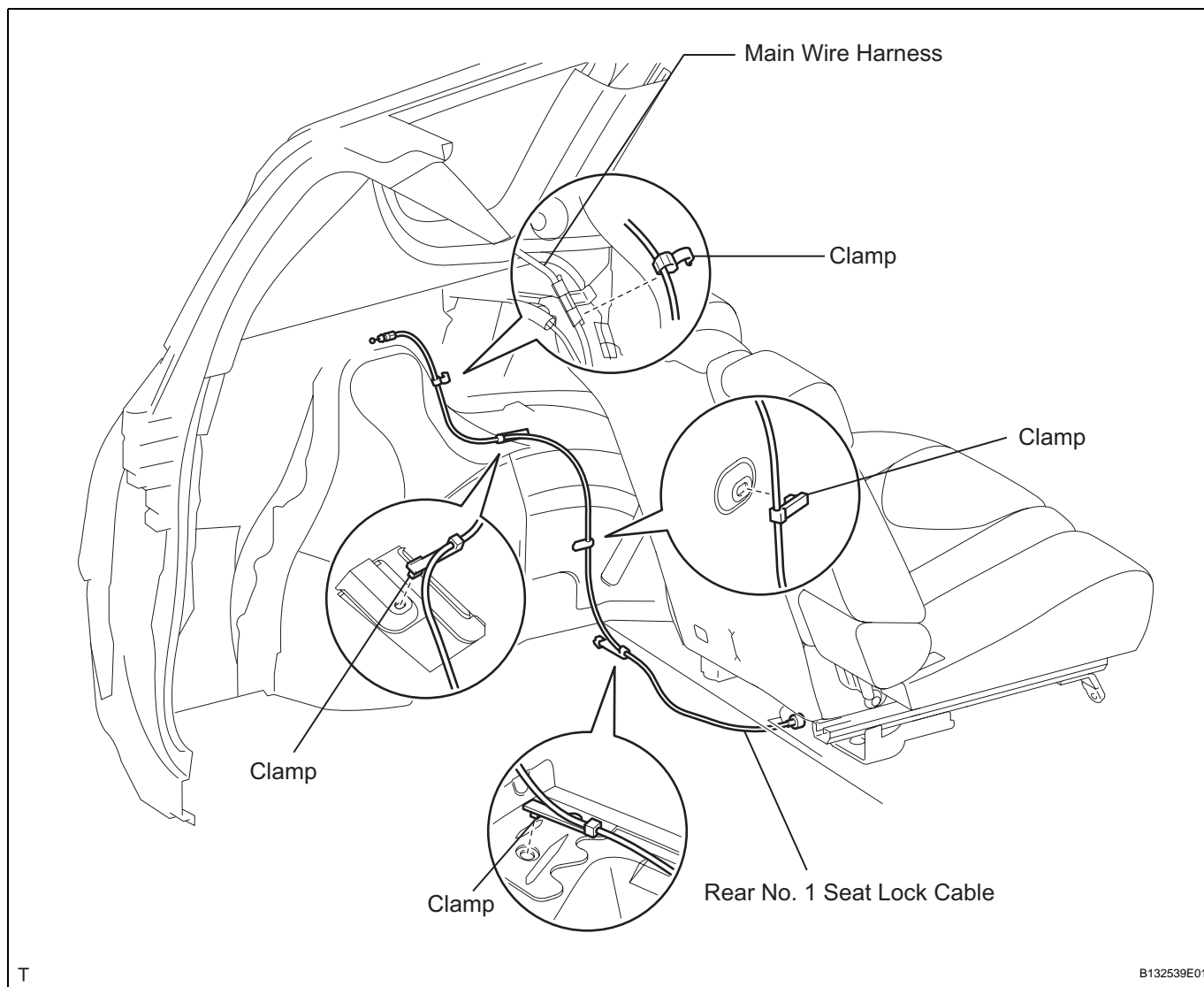

### 4. INSTALL REAR SEAT LAP TYPE BELT ASSEMBLY CENTER RH (w/ Rear No. 2 Seat) (See page [SB-42](#))

### 5. INSTALL REAR SEAT LAP TYPE BELT CENTER ASSEMBLY RH (w/o Rear No. 2 Seat) (See page [SB-42](#))

### 6. INSTALL REAR SEAT LEG COVER

- (a) Attach the 8 claws to install the 2 leg covers.

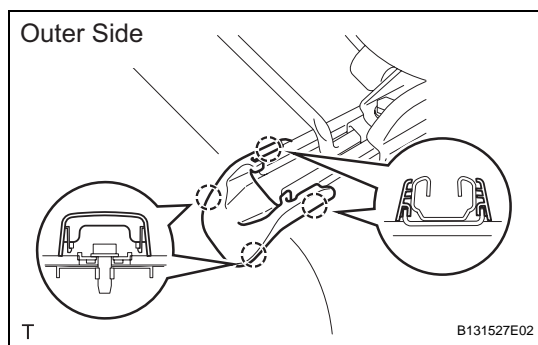

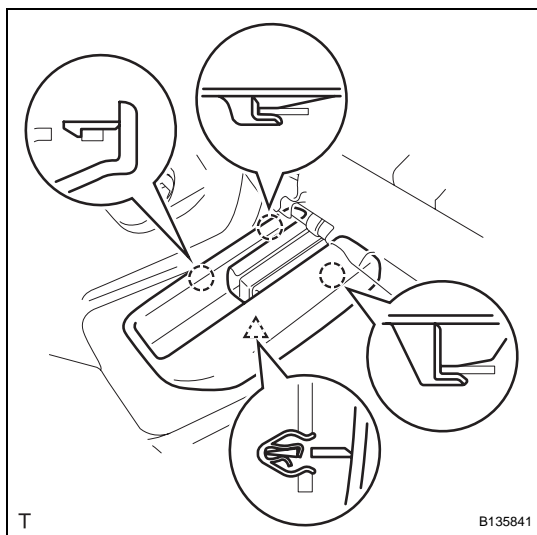
**7. INSTALL REAR NO. 5 SEAT LEG SIDE COVER**

- (a) Attach the 3 claws and clip to install the side cover.

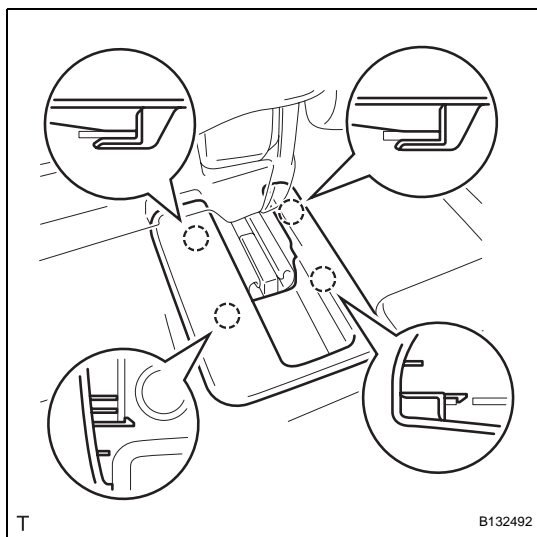
**8. INSTALL REAR NO. 4 SEAT LEG SIDE COVER (w/ Rear No. 2 Seat)**

- (a) Attach the 4 claws to install the side cover.

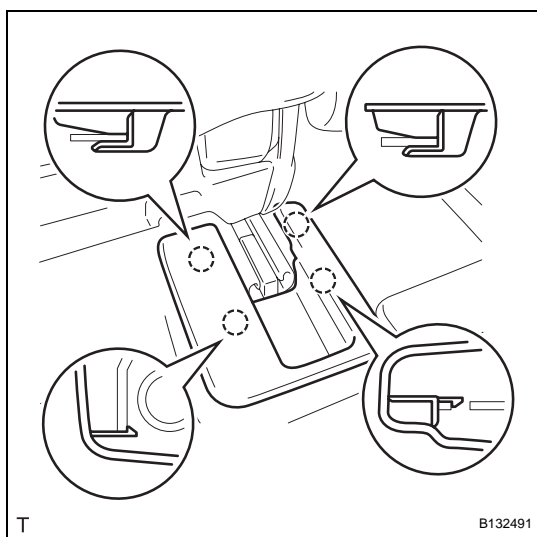
**9. INSTALL REAR NO. 4 SEAT LEG SIDE COVER (w/o Rear No. 2 Seat)**

- (a) Attach the 4 claws to install the rear No. 4 seat leg side cover.



SE

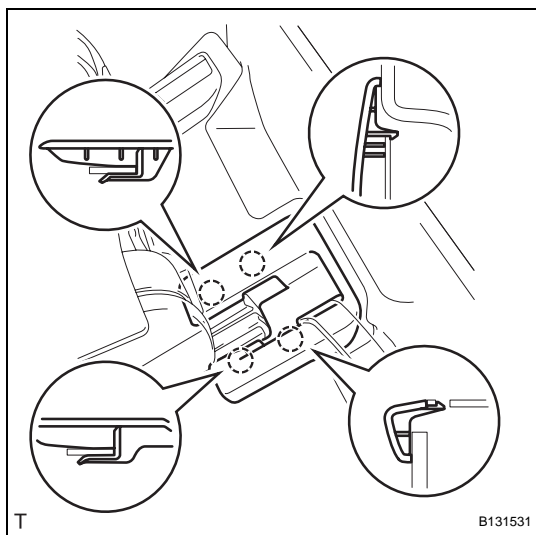

# 10. INSTALL REAR NO. 3 SEAT LEG SIDE COVER (w/ Rear No. 2 Seat)

- (a) Attach the 4 claws to install the side cover.

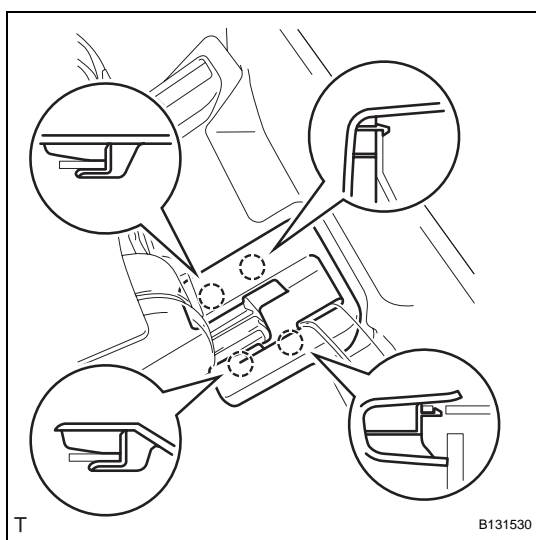

# 11. INSTALL REAR NO. 3 SEAT LEG SIDE COVER (w/o Rear No. 2 Seat)

- (a) Attach the 4 claws to install the side cover.

# 12. INSTALL RECLINING REMOTE CONTROL LEVER SUB-ASSEMBLY LH (w/o Rear No. 2 Seat)

- (a) Connect the rear No. 1 seat lock cable to the lever.

- (b) Install the lever with the 2 bolts.

**Torque: 18 N\*m (184 kgf\*cm, 13 ft.\*lbf)**

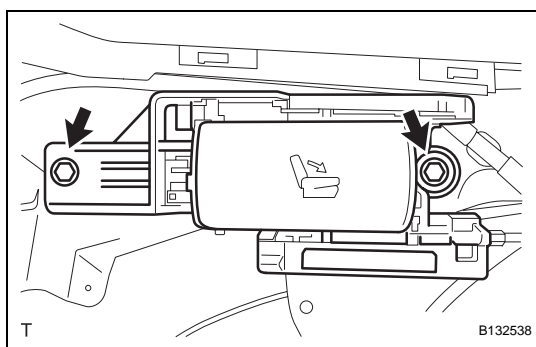

# 13. INSTALL DECK TRIM SIDE PANEL ASSEMBLY LH (w/o Rear No. 2 Seat) (See page [IR-52](#))

# 14. INSTALL TETHER ANCHOR BRACKET SUB-ASSEMBLY (w/o Rear No. 2 Seat) (See page [IR-54](#))

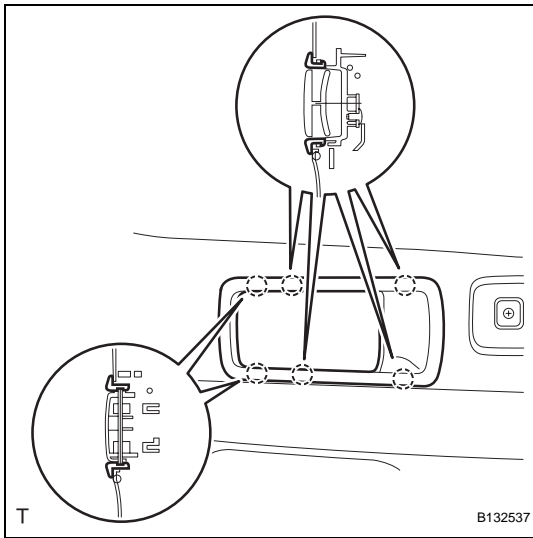

15. **INSTALL RECLINING REMOTE CONTROL LEVER BEZEL LH (w/o Rear No. 2 Seat)**  
(a) Attach the 6 claws to install the bezel.
16. **INSTALL REAR FLOOR FINISH PLATE (w/o Rear No. 2 Seat) (See page [IR-55](#))**
17. **INSTALL BACK DOOR WEATHERSTRIP (w/o Rear No. 2 Seat)**
18. **INSTALL REAR FLOOR NO. 1 MAT SUPPORT SIDE PLATE (w/o Rear No. 2 Seat) (See page [IR-55](#))**
19. **INSTALL REAR FLOOR NO. 3 BOARD (w/o Rear No. 2 Seat)**
20. **INSTALL REAR FLOOR NO. 2 BOARD (w/o Rear No. 2 Seat)**
21. **INSTALL DECK BOARD ASSEMBLY (w/o Rear No. 2 Seat)**
22. **INSTALL REAR FLOOR NO. 1 BOARD (w/o Rear No. 2 Seat)**
23. **INSTALL TONNEAU COVER ASSEMBLY (w/o Rear No. 2 Seat)**
24. **INSTALL PACKAGE TRAY TRIM POCKET SUB-ASSEMBLY (w/o Rear No. 2 Seat)**