

INSTALLATION

HINT:

Use the same procedures for the LH and RH side.

1. INSTALL FRONT SEAT ASSEMBLY

- (a) Place the seat in the cabin.
- (b) Connect the connectors under the seat.
- (c) Connect the cable to the negative (-) battery terminal.
- (d) Operate the power seat switch knob and move the seat to the rearmost position.
- (e) Tighten the 2 bolts on the front side of the seat.

Torque: 37 N*m (377 kgf*cm, 27 ft.*lbf)

HINT:

Tighten the 2 bolts in the order indicated in the illustration.

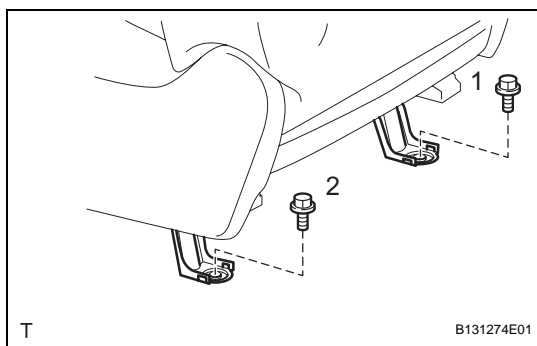
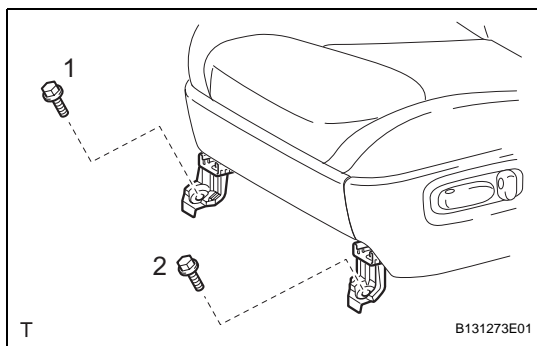

- (f) Operate the power seat switch knob and move the seat to the foremost position.
- (g) Tighten the 2 bolts on the rear side of the seat.

Torque: 37 N*m (377 kgf*cm, 27 ft.*lbf)

HINT:

Tighten the 2 bolts in the order indicated in the illustration.

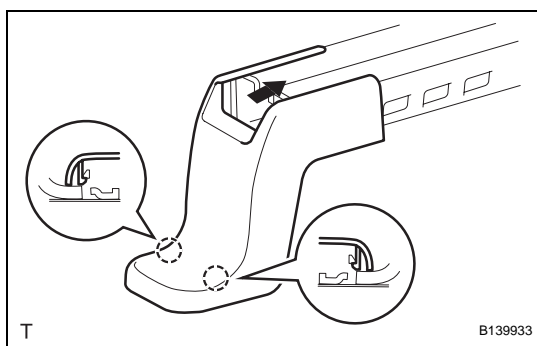

- (h) Install the front seat track bracket outer cover in the direction indicated by the arrow in the illustration and attach the 2 claws.

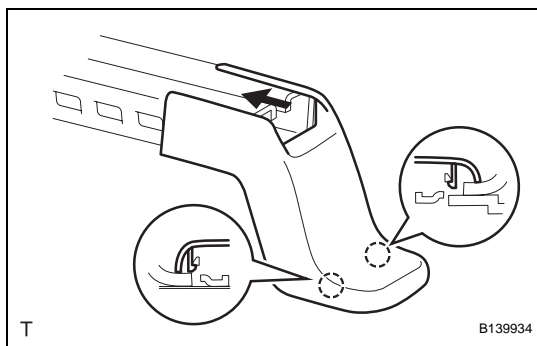

- (i) Install the front seat track bracket inner cover in the direction indicated by the arrow in the illustration and attach the 2 claws.

2. INSTALL FRONT SEAT HEADREST ASSEMBLY

3. CHECK SRS WARNING LIGHT (w/ Front Seat Side Airbag)

Check the SRS warning light (see page [RS-37](#)).

4. INSPECT FRONT SEAT ASSEMBLY

- (a) Check the power seat operation.
- (b) w/ Seat Heater System:
Check the seat heater operation.

- (1) Turn the ignition switch on (IG).
- (2) Push the seat heater switch ON.
- (3) Wait 5 minutes or more and confirm that the seat surface becomes warm.