

REMOVAL

HINT:

- Use the same procedures for the RH side and LH side.
- The procedures listed below are for the RH side.

1. REMOVE FRONT SEAT HEADREST ASSEMBLY

2. REMOVE FRONT SEAT ASSEMBLY

- (a) Operate the power seat switch knob and move the seat to the foremost position.

- (b) Using a screwdriver, detach the 2 claws.

HINT:

Tape the screwdriver tip before use.

- (c) Remove the front seat track bracket outer cover in the direction indicated by the arrow in the illustration.

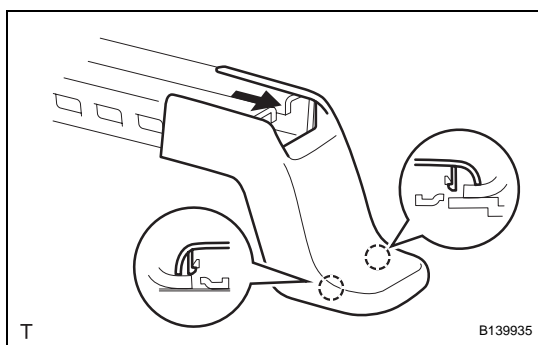
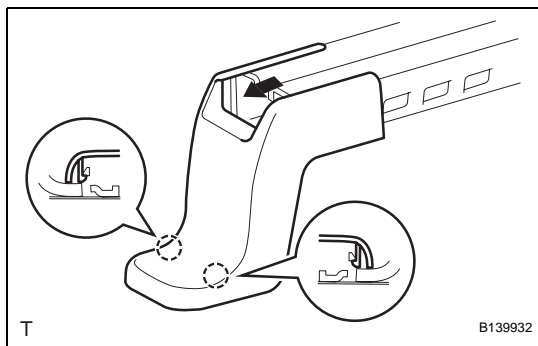

- (d) Using a screwdriver, detach the 2 claws.

HINT:

Tape the screwdriver tip before use.

- (e) Remove the front seat track bracket inner cover in the direction indicated by the arrow in the illustration.

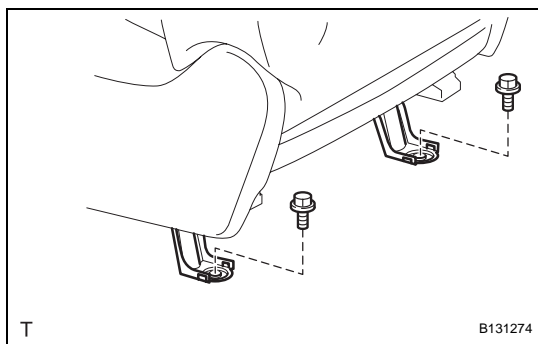

- (f) Remove the 2 bolts on the rear side of the seat.

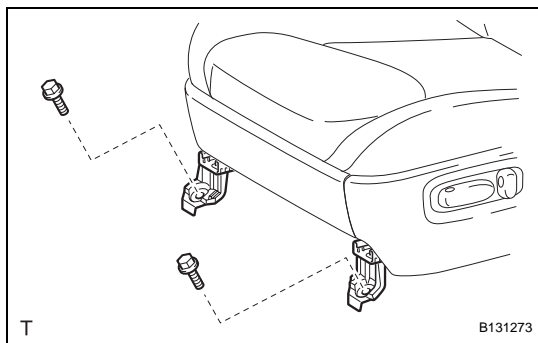

- (g) Operate the power seat switch knob and move the seat to the rearmost position.

- (h) Remove the 2 bolts on the front side of the seat.

- (i) Operate the power seat switch knob and move the seat to the center position. Then, operate the power seat switch knob and move the seatback to the upright position.

- (j) Disconnect the cable from the negative (-) battery terminal.

CAUTION:

Wait at least 90 seconds after disconnecting the cable from the negative (-) battery terminal to prevent airbag and seat belt pretensioner activation.

- (k) Disconnect the connectors under the seat. Then remove the seat.