

REMOVAL

HINT:

- Use the same procedures for the RH side and LH side.
- The procedures listed below are for the LH side.

1. DISCONNECT CABLE FROM NEGATIVE BATTERY TERMINAL

CAUTION:

Wait at least 90 seconds after disconnecting the cable from the negative (-) battery terminal to prevent airbag and seat belt pretensioner activation.

2. REMOVE FRONT SEAT HEADREST ASSEMBLY

3. REMOVE FRONT SEAT TRACK BRACKET OUTER COVER LH

- (a) Lift up the seat track adjusting handle and move the seat to the foremost position.

- (b) Using a screwdriver, detach the 4 claws.

HINT:

Tape the screwdriver tip before use.

- (c) Remove the outer cover in the direction indicated by the arrow in the illustration.

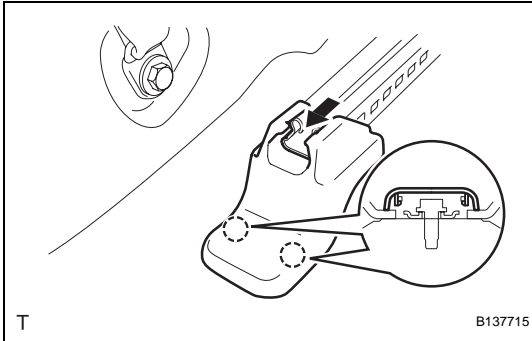

4. REMOVE FRONT SEAT TRACK BRACKET INNER COVER LH

- (a) Using a screwdriver, detach the 2 claws.

HINT:

Tape the screwdriver tip before use.

- (b) Remove the inner cover in the direction indicated by the arrow in the illustration.

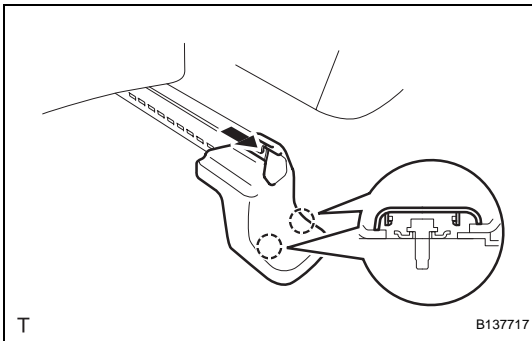

5. REMOVE FRONT SEAT ASSEMBLY

- (a) Remove the 2 bolts on the rear side of the seat.
- (b) Lift up the seat track adjusting handle and move the seat to the rearmost position.

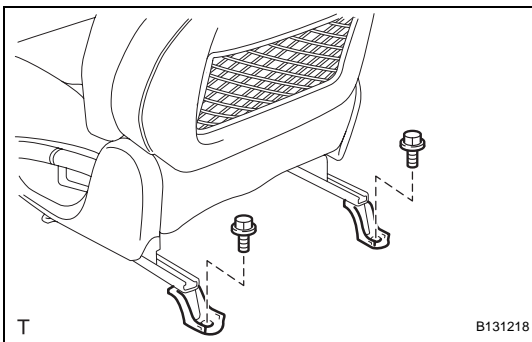

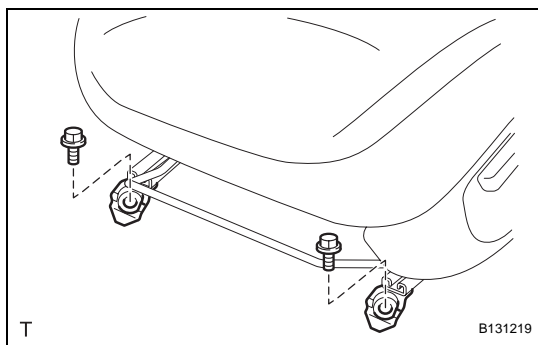

- (c) Remove the 2 bolts on the front side of the seat.
- (d) Lift up the seat track adjusting handle and move the seat to the center position. Also, operate the reclining adjuster release handle and move the seatback to the upright position.
- (e) Disconnect the connector under the seat.
- (f) Remove the seat.

NOTICE:

Be careful not to damage the vehicle body.