

INSTALLATION

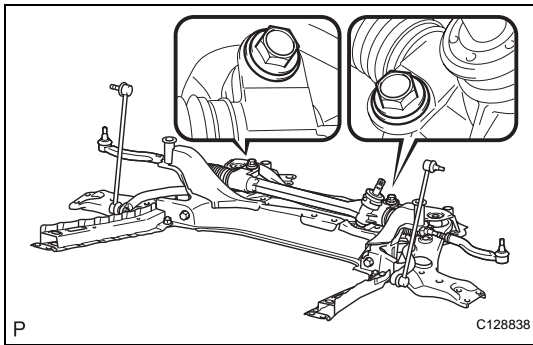

1. INSTALL STEERING GEAR ASSEMBLY

- (a) Install the steering gear onto the front suspension crossmember with the 2 bolts and 2 nuts.

Torque: 138 N*m (1407 kgf*cm, 102 ft.*lbf)

NOTICE:

Keep the nut from rotating while turning the bolt.

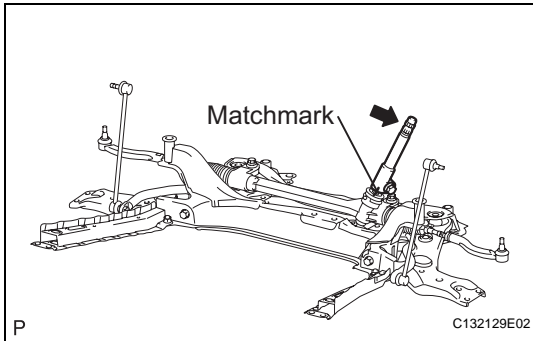

2. INSTALL INTERMEDIATE SHAFT

- (a) Align the matchmarks and install the intermediate shaft onto the steering gear.

Torque: 35 N*m (360 kgf*cm, 26 ft.*lbf)

3. INSTALL NO. 1 STEERING COLUMN HOLE COVER SUB-ASSEMBLY

- (a) Install the column hole cover onto the steering gear with a new clamp.

4. INSTALL ENGINE ASSEMBLY WITH TRANSAXLE

- (a) Install the engine with transaxle (see page [EM-105](#)).

5. INSTALL NO. 1 STEERING COLUMN HOLE COVER SUB-ASSEMBLY

- (a) Attach clip B onto the body portion and install the No. 1 hole cover onto the body portion with clip A.

NOTICE:

Make sure that the lip portion of the No. 1 hole cover is not damaged.

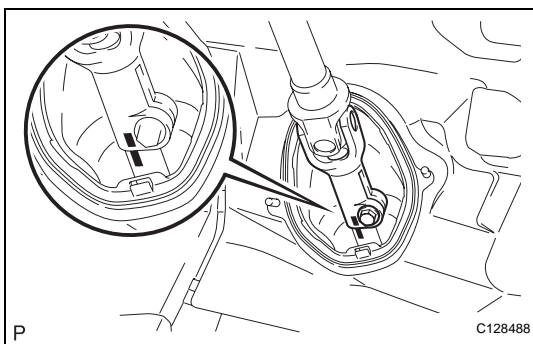
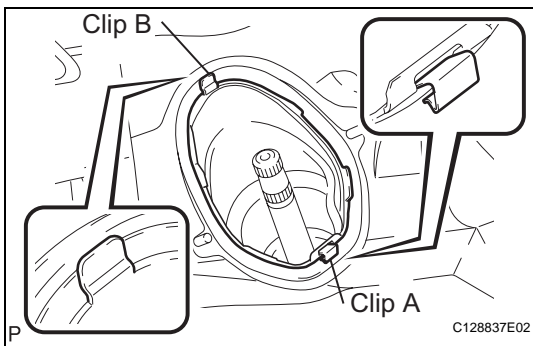

6. CONNECT STEERING SLIDING YOKE SUB-ASSEMBLY

- (a) Align the matchmarks and install the sliding yoke onto the intermediate shaft.

Torque: 35 N*m (360 kgf*cm, 26 ft.*lbf)

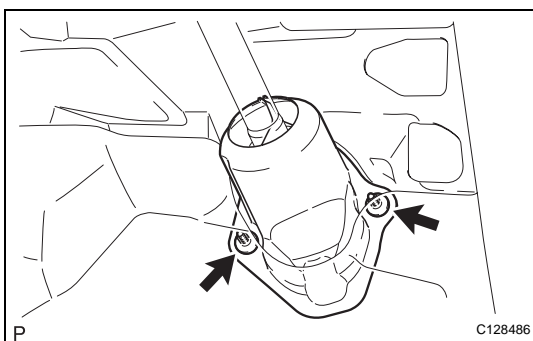

7. INSTALL COLUMN HOLE COVER SILENCER SHEET

- (a) Install the column hole cover silencer sheet with the 2 clips.

- (b) Install the floor carpet.

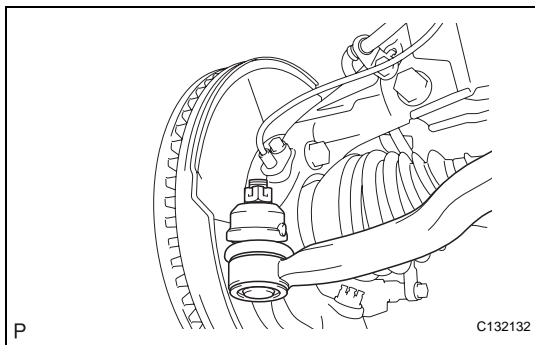
**8. CONNECT TIE ROD END SUB-ASSEMBLY LH**

- (a) Connect the tie rod end onto the steering knuckle with the castle nut.

Torque: 49 N*m (500 kgf*cm, 36 ft.*lbf)

NOTICE:

If the holes for the clip are not aligned, tighten the nut up to 60° further.

- (b) Install a new cotter pin.

9. CONNECT TIE ROD END SUB-ASSEMBLY RH**HINT:**

Use the same procedure for the RH side as for the LH side.

10. INSTALL FRONT WHEEL

Torque: 103 N*m (1,050 kgf*cm, 76 ft.*lbf)

11. CONNECT CABLE TO NEGATIVE BATTERY TERMINAL**12. POSITION FRONT WHEELS FACING STRAIGHT AHEAD****13. INSPECT AND ADJUST FRONT WHEEL ALIGNMENT**

- (a) Inspect and adjust the wheel alignment (see page [SP-3](#)).