

## REMOVAL

1. POSITION FRONT WHEELS FACING STRAIGHT AHEAD
2. DISCONNECT CABLE FROM NEGATIVE BATTERY TERMINAL  
CAUTION:  
Wait at least 90 seconds after disconnecting the cable from the negative (-) battery terminal to prevent airbag and seat belt pretensioner activation.

3. REMOVE FRONT WHEEL

4. DISCONNECT TIE ROD END SUB-ASSEMBLY LH
  - (a) Remove the cotter pin and castle nut.
  - (b) Using SST, disconnect the tie rod end from the steering knuckle.

**SST 09628-62011**

**NOTICE:**

**Do not damage the tie rod end dust cover.**

5. DISCONNECT TIE ROD END SUB-ASSEMBLY RH  
HINT:  
Use the same procedure for the RH side as for the LH side.

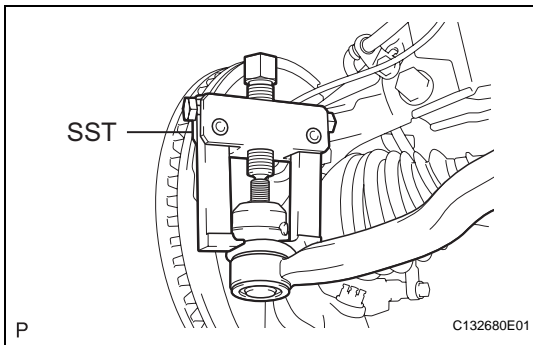

6. REMOVE COLUMN HOLE COVER SILENCER SHEET
  - (a) Remove the floor carpet, 2 clips and column hole cover silencer.

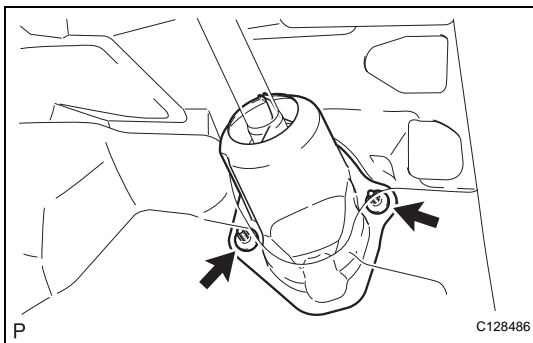

7. DISCONNECT STEERING SLIDING YOKE SUB-ASSEMBLY

- (a) Use a seat belt to fix the steering wheel in place to avoid breakage of the spiral cable.

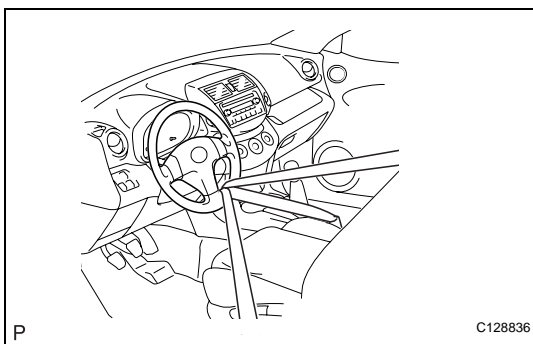

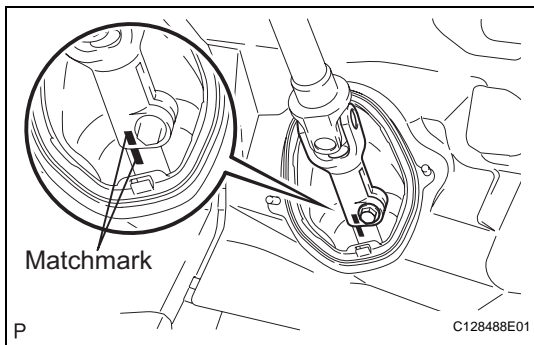

- (b) Place matchmarks on the sliding yoke of the steering intermediate shaft.
- (c) Remove the bolt and disconnect the sliding yoke.

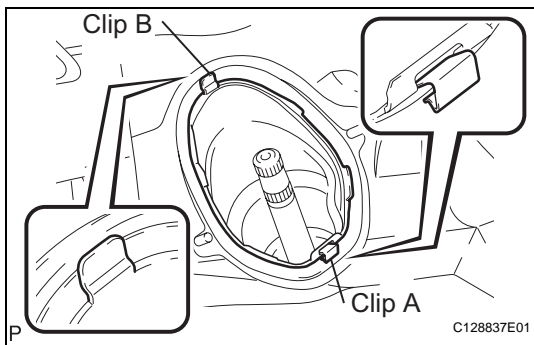

#### 8. DISCONNECT NO. 1 STEERING COLUMN HOLE COVER SUB-ASSEMBLY

- (a) Remove clip A, detach clip B from the body and disconnect the No. 1 steering column hole cover.

**NOTICE:**

Do not damage clips A and B.

#### 9. REMOVE ENGINE ASSEMBLY WITH TRANSAXLE

- (a) Remove the engine with transaxle (see page [EM-98](#)).

#### 10. REMOVE NO. 1 STEERING COLUMN HOLE COVER SUB-ASSEMBLY

- (a) Remove the clamp and disconnect the column hole cover from the steering gear.

#### 11. REMOVE INTERMEDIATE SHAFT

- (a) Place matchmarks on the intermediate shaft of the steering gear.
- (b) Remove the bolt and disconnect the steering intermediate shaft from the steering gear.

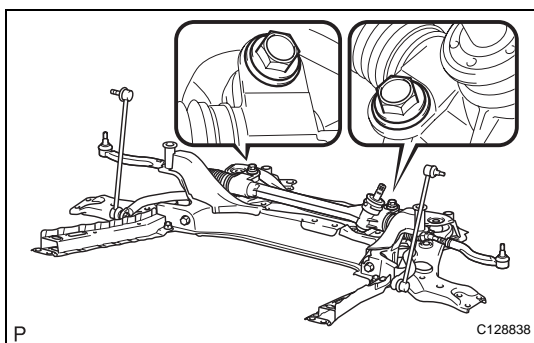
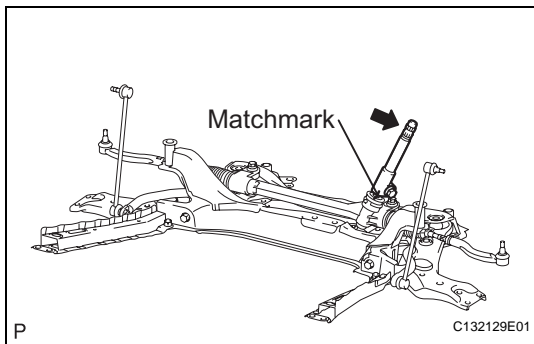

#### 12. REMOVE STEERING GEAR ASSEMBLY

- (a) Remove the 2 bolts, 2 nuts and steering gear from the suspension crossmember.

**NOTICE:**

Keep the nut from rotating while turning the bolt.