

# REAR BUMPER COMPONENTS

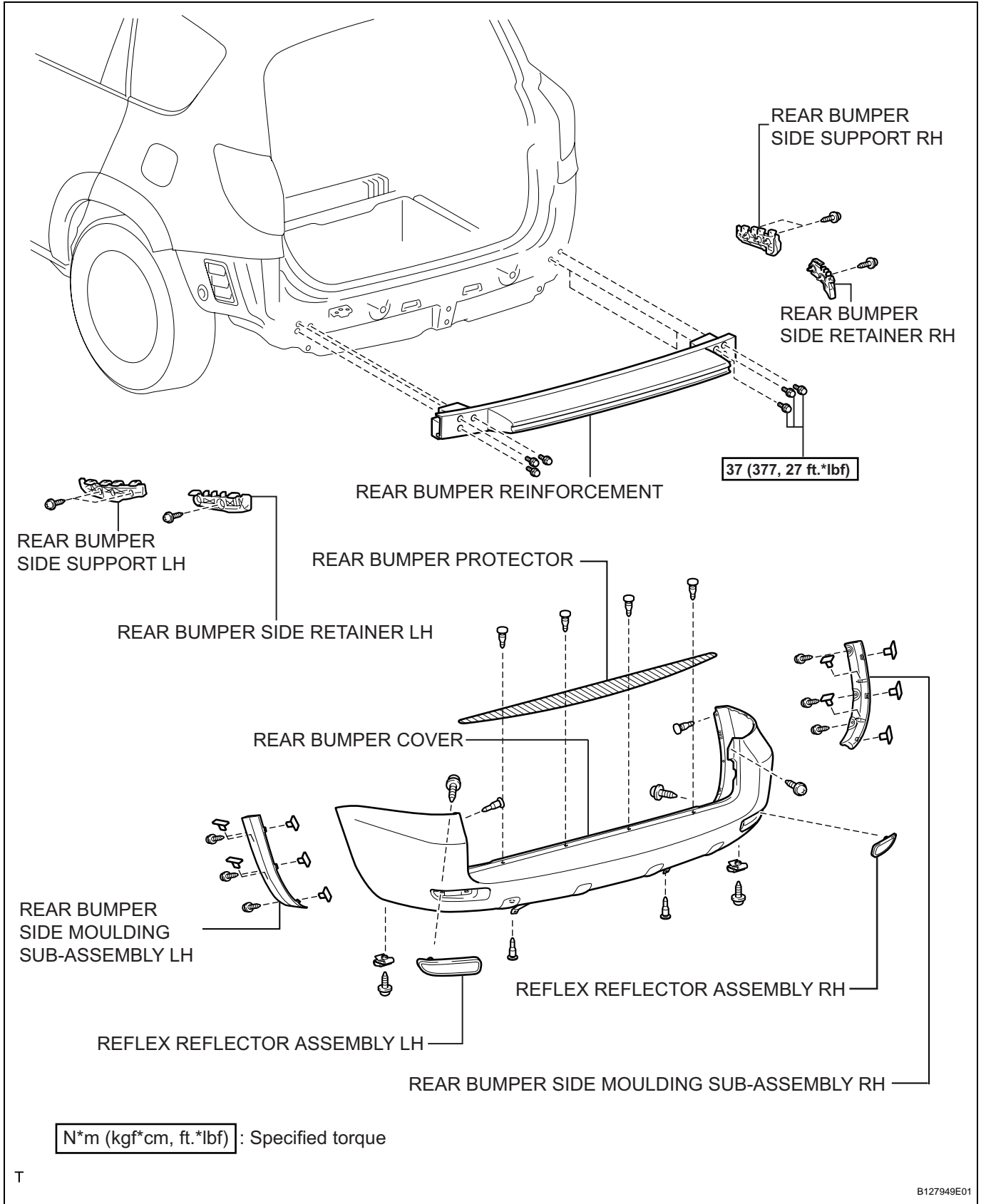

**REMOVAL****1. REMOVE REAR BUMPER COVER**

- (a) Remove the 9 screws and 7 clips.
- (b) Put protective tape under the quarter panel.

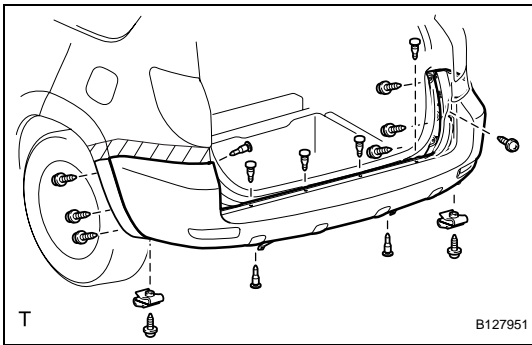

- (c) Detach the 12 claws and remove the bumper cover.

**2. REMOVE REAR BUMPER PROTECTOR****HINT:**

When removing the bumper protector, heat the bumper protector.

**Standard heating temperature**

Item	Specified Condition
bumper protector	40 to 60°C (104 to 140°F)

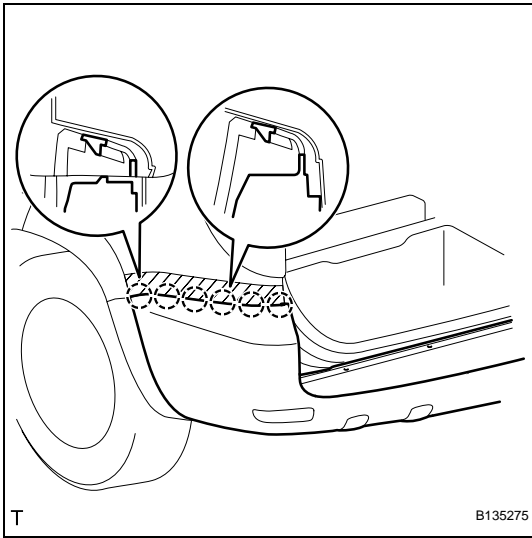

- (a) Using a moulding remover, remove the bumper protector.

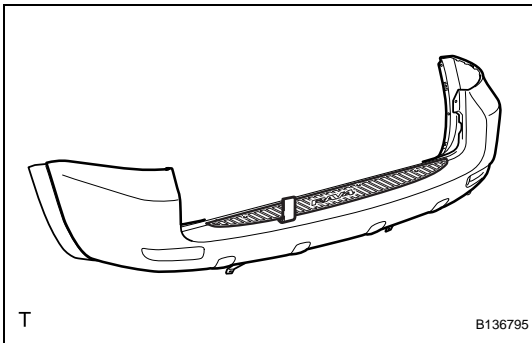
**3. REMOVE REFLEX REFLECTOR ASSEMBLY LH**

- (a) Remove the screw and reflex reflector.

**4. REMOVE REFLEX REFLECTOR ASSEMBLY RH****HINT:**

Use the same procedures described for the LH side.

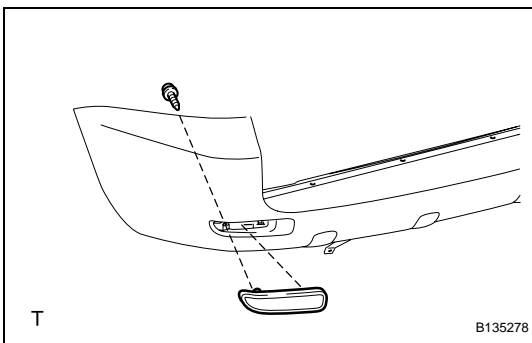

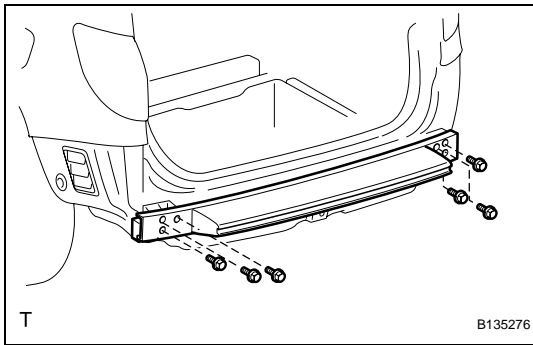

### 5. REMOVE REAR BUMPER REINFORCEMENT

- (a) Remove the 6 bolts and reinforcement.

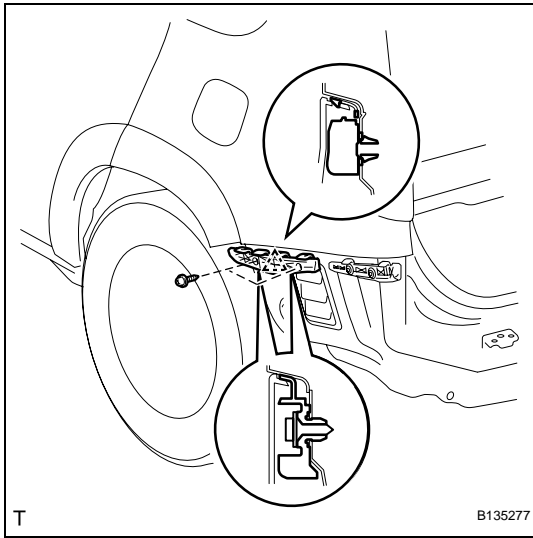

### 6. REMOVE REAR BUMPER SIDE SUPPORT LH

- (a) Remove the 2 screws.  
 (b) Using a screwdriver, detach the claw and remove the bumper side support.

HINT:

Tape the screwdriver tip before use.

### 7. REMOVE REAR BUMPER SIDE SUPPORT RH

HINT:

Use the same procedures described for the LH side.

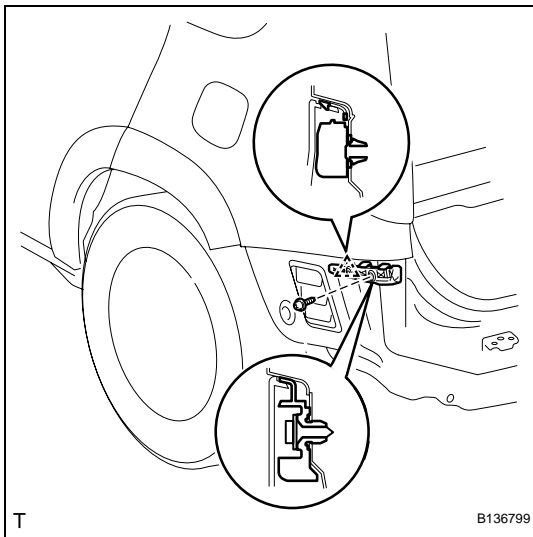

### 8. REMOVE REAR BUMPER SIDE RETAINER LH

- (a) Remove the screw.  
 (b) Using a screwdriver, detach the claw and remove the side retainer.

HINT:

Tape the screwdriver tip before use.

### 9. REMOVE REAR BUMPER SIDE RETAINER RH

HINT:

Use the same procedures described for the LH side.

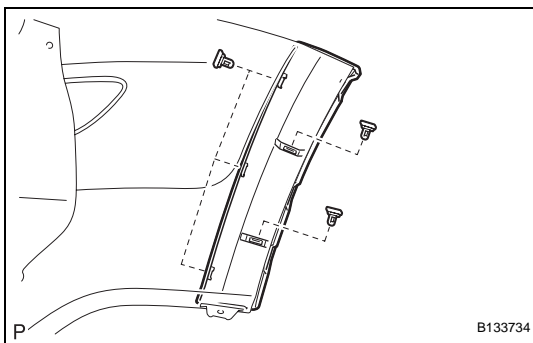

### 10. REMOVE REAR BUMPER SIDE MOULDING SUB-ASSEMBLY LH (for Wide Body)

- (a) Detach the 5 outside moulding retainers and remove the moulding.

**NOTICE:**

- If reusing the extension, take care not to damage the moulding.
- Be careful not to damage the vehicle body.

**11. REMOVE REAR BUMPER SIDE MOULDING SUB-ASSEMBLY RH (for Wide Body)**

HINT:

Use the same procedures described for the LH side.

**INSTALLATION****1. INSTALL REAR BUMPER SIDE MOULDING SUB-ASSEMBLY LH (for Wide Body)**

(a) Attach the 5 outside moulding retainers to install the moulding.

**2. INSTALL REAR BUMPER SIDE MOULDING SUB-ASSEMBLY RH (for Wide Body)**

HINT:

Use the same procedures described for the LH side.

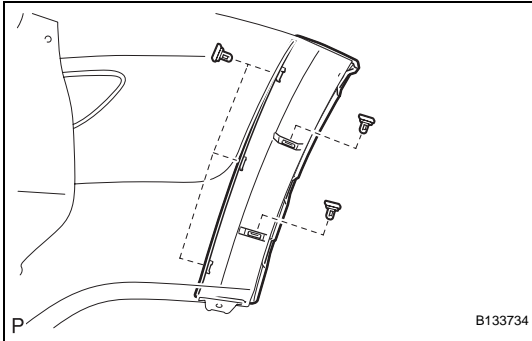
**3. INSTALL REAR BUMPER SIDE RETAINER LH**

(a) Attach the claw to install the side retainer.

(b) Install the screw.

**4. INSTALL REAR BUMPER SIDE RETAINER RH**

HINT:

Use the same procedures described for the LH side.

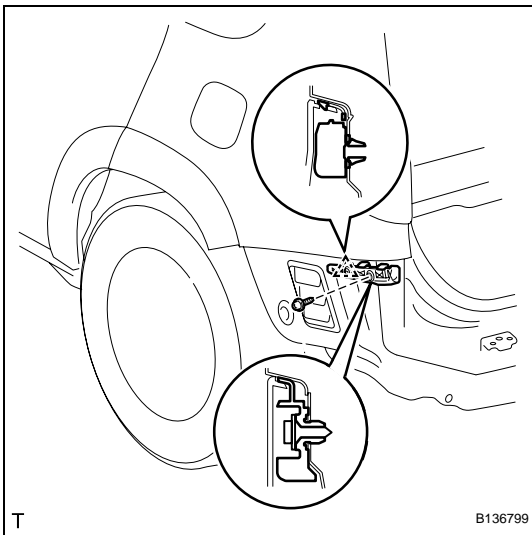
**5. INSTALL REAR BUMPER SIDE SUPPORT LH**

(a) Attach the claw to install the bumper side support.

(b) Install the 2 screws.

**6. INSTALL REAR BUMPER SIDE SUPPORT RH**

HINT:

Use the same procedures described for the LH side.

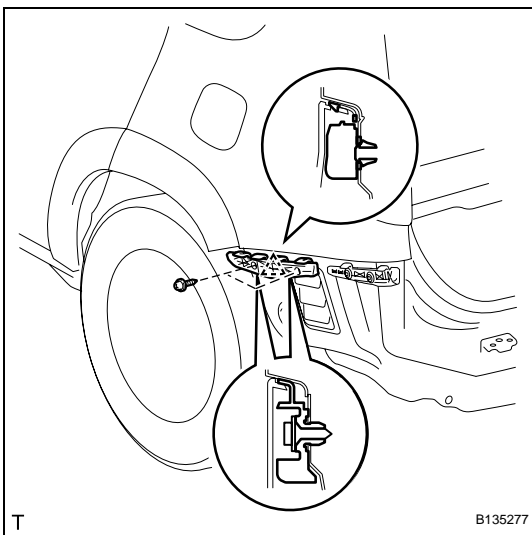

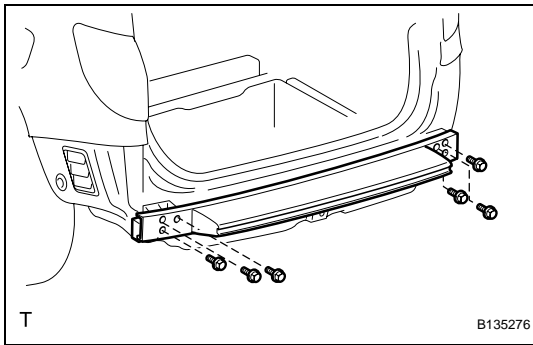
**7. INSTALL REAR BUMPER REINFORCEMENT**

- (a) Install the bumper reinforcement with the 6 bolts.  
**Torque: 37 N\*m (377 kgf\*cm, 27 ft.\*lbf)**

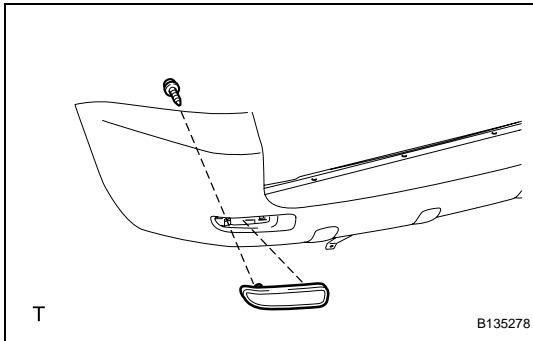
**8. INSTALL REFLEX REFLECTOR ASSEMBLY LH**

- (a) Install the reflex reflector with the screw.

**9. INSTALL REFLEX REFLECTOR ASSEMBLY RH**

**HINT:**

Use the same procedures described for the LH side.

**10. INSTALL REAR BUMPER PROTECTOR**

**HINT:**

When removing the double-side tape, heat the rear bumper.

**Standard heating temperature**

Item	Specified Condition
Rear bumper	40 to 60°C (104 to 140°F)

- (a) Clean the bumper surface.
- (1) Using a heat light, heat the bumper surface.
  - (2) Remove the double-sided tape from the bumper.
  - (3) Wipe off any tape adhesive residue with cleaner.

- (b) Install the new bumper protector.

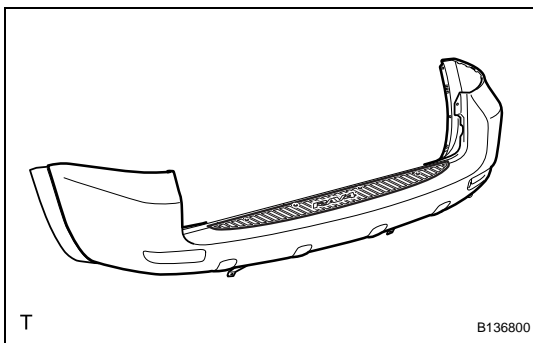

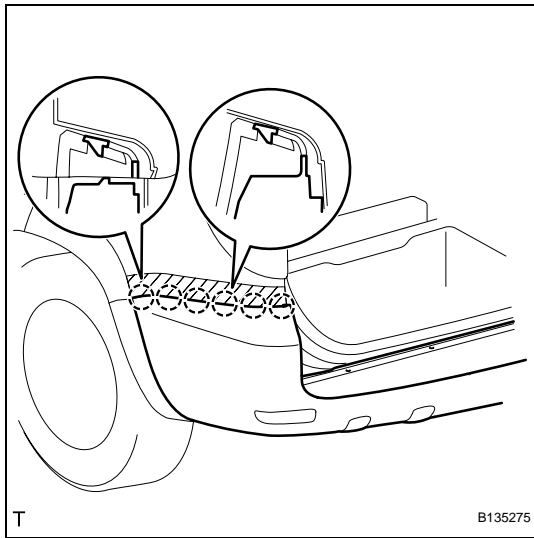
**11. INSTALL REAR BUMPER COVER**

- (a) Put protective tape under the quarter panel.
- (b) Attach the 12 claws to install the bumper cover.

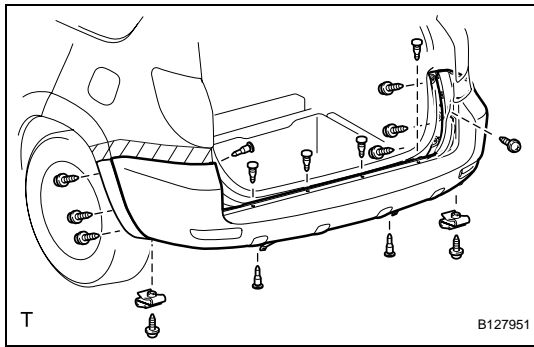

- (c) Install the 9 screws and 7 clips.