

## DISASSEMBLY

### HINT:

- Use the same procedures for the RH side and LH side.
- The procedures listed below are for the LH side.

#### 1. REMOVE REAR DRIVE SHAFT INBOARD JOINT BOOT NO. 2 CLAMP LH

- (a) Using needle-nose pliers, remove the inboard joint boot clamp, as shown in the illustration.

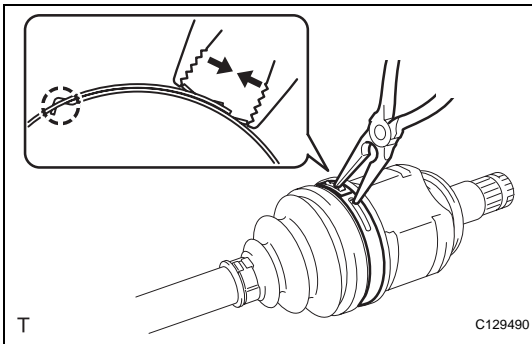

#### 2. REMOVE REAR DRIVE SHAFT INBOARD JOINT BOOT CLAMP LH

- (a) Using needle-nose pliers, remove the inboard joint boot clamp, as shown in the illustration.

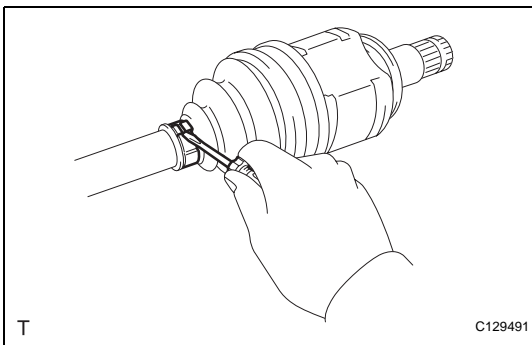

#### 3. REMOVE REAR AXLE INBOARD JOINT BOOT

- (a) Remove the boot from the inboard joint.

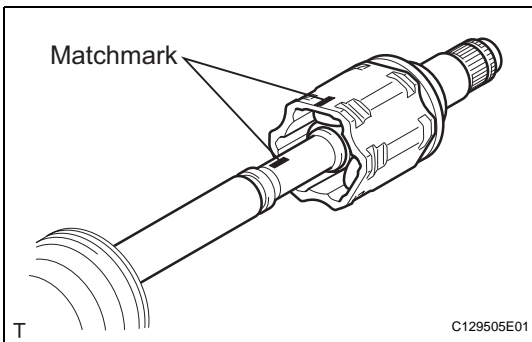

#### 4. REMOVE REAR DRIVE SHAFT INBOARD JOINT ASSEMBLY LH

- (a) Remove any old grease from the inboard joint.
- (b) Put matchmarks on the inboard joint and outboard joint shaft.

### NOTICE:

**Do not punch the marks.**

- (c) Remove the inboard joint from the outboard joint shaft.

- (d) Using a snap ring expander, remove the shaft snap ring.

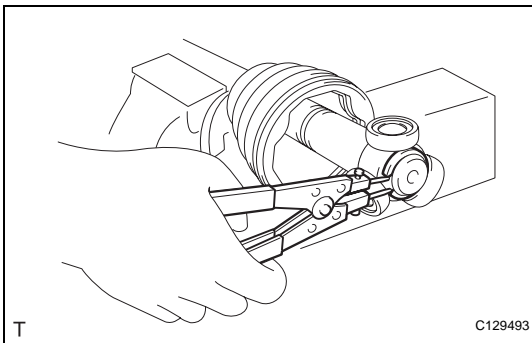

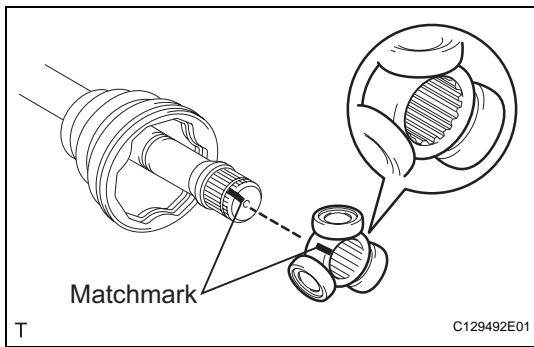

- (e) Put matchmarks on the outboard joint shaft and tripod joint.

**NOTICE:**

**Do not punch the marks.**

- (f) Using a brass bar and hammer, tap out the tripod joint from the outboard joint shaft.

**NOTICE:**

**Do not tap the rollers.**

- (g) Remove the inboard joint boot.

**5. REMOVE REAR DRIVE SHAFT INBOARD JOINT LH SHAFT SNAP RING**

- (a) Using a screwdriver, remove the hole snap ring.

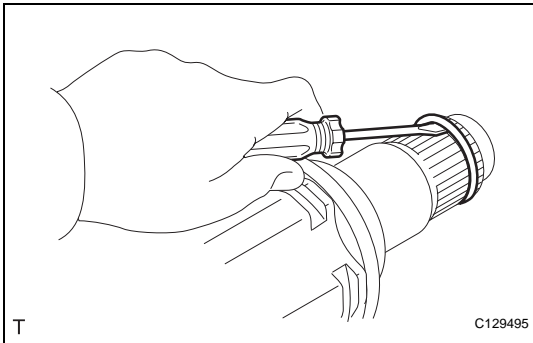

**6. REMOVE REAR DRIVE SHAFT DUST COVER LH**

- (a) Using SST and a press, press out the shaft dust cover.

**SST 09950-00020**

**NOTICE:**

**Be careful not to drop the inboard joint.**

