

# REAR SPEED SENSOR (for 4WD)

## COMPONENTS

BC

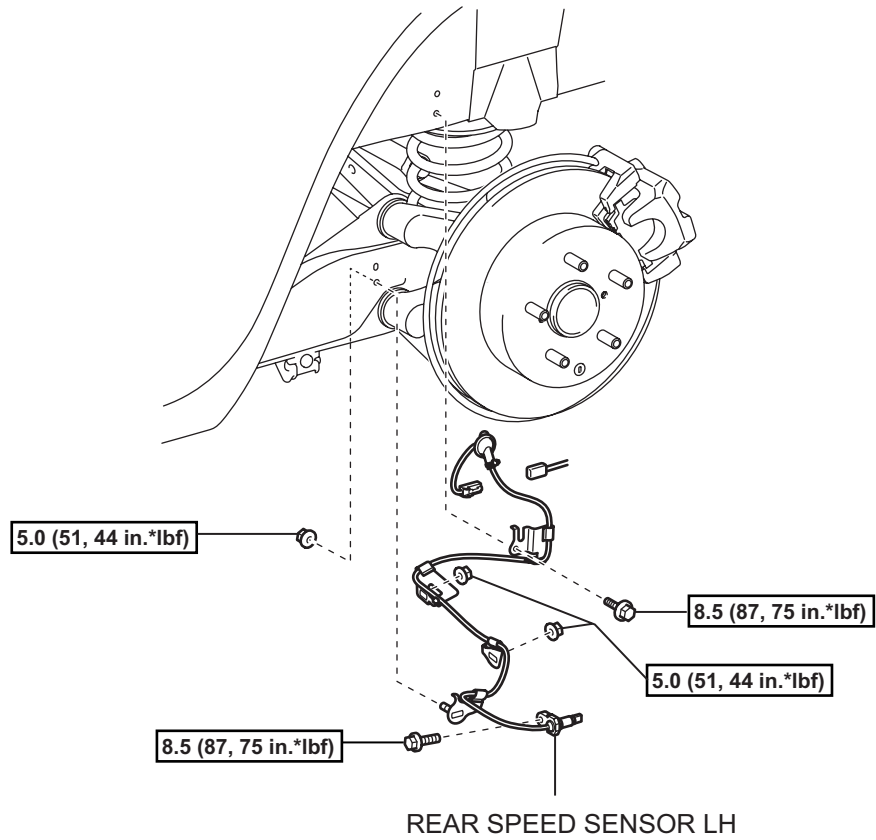

**N\*m (kgf\*cm, ft.\*lbf)** : Specified torque

## REMOVAL

### HINT:

- Use the same procedures for the LH side and RH side.
- The procedures listed below are for the LH side.

### 1. DISCONNECT CABLE FROM NEGATIVE BATTERY TERMINAL

#### CAUTION:

Wait at least 90 seconds after disconnecting the cable from the negative (-) battery terminal to prevent airbag and seat belt pretensioner activation.

### 2. REMOVE REAR WHEEL

### 3. REMOVE DECK TRIM SIDE PANEL ASSEMBLY LH

- (a) Remove the deck trim side panel LH (see page [IR-26](#)).

#### HINT:

Refer to the procedures from the removal of the rear door scuff plate LH up until the removal of the deck trim side panel assembly LH.

### 4. REMOVE REAR SPEED SENSOR LH

- (a) Disconnect the speed sensor connector.

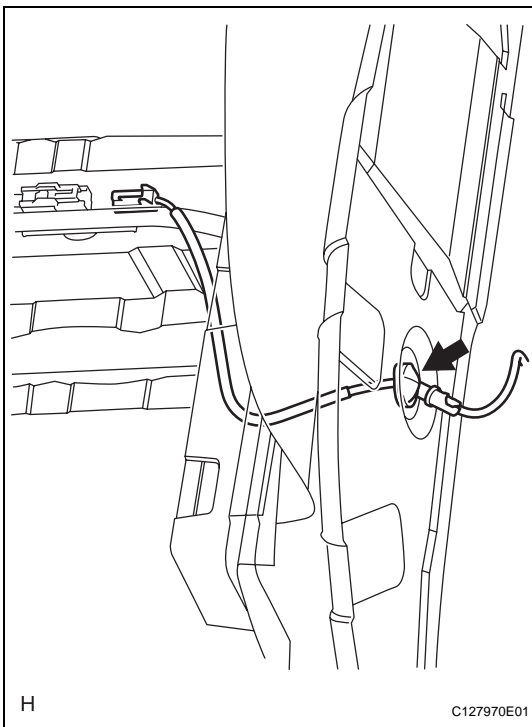
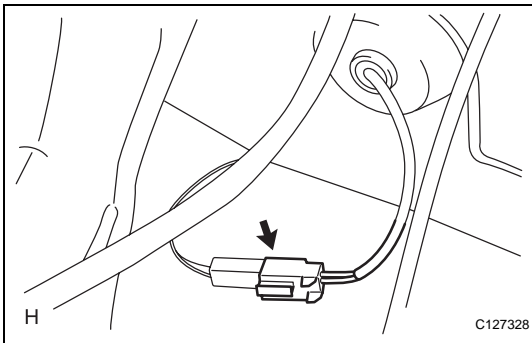

- (b) Disconnect the grommet of the speed sensor wire from the hole of the wheel house.

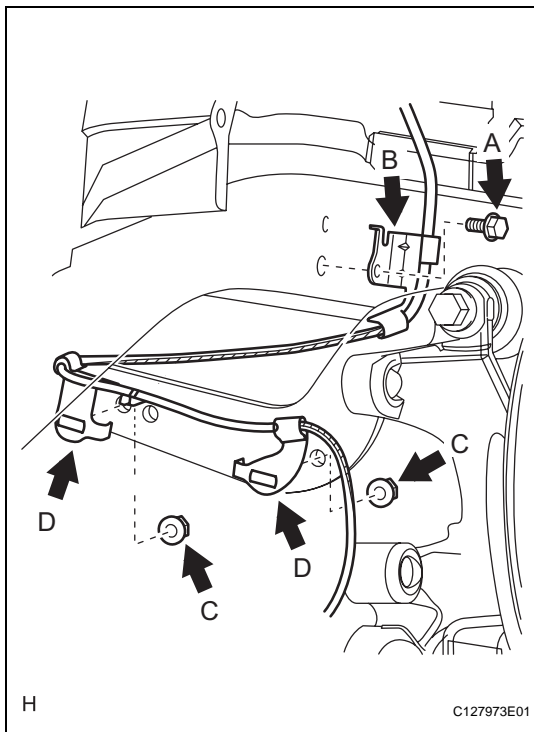

- (c) Remove the bolt (labeled A) and sensor clamp (labeled B) from the side member.
- (d) Remove the 2 nuts (labeled C) and sensor clamps (labeled D) from the upper arm.

BC

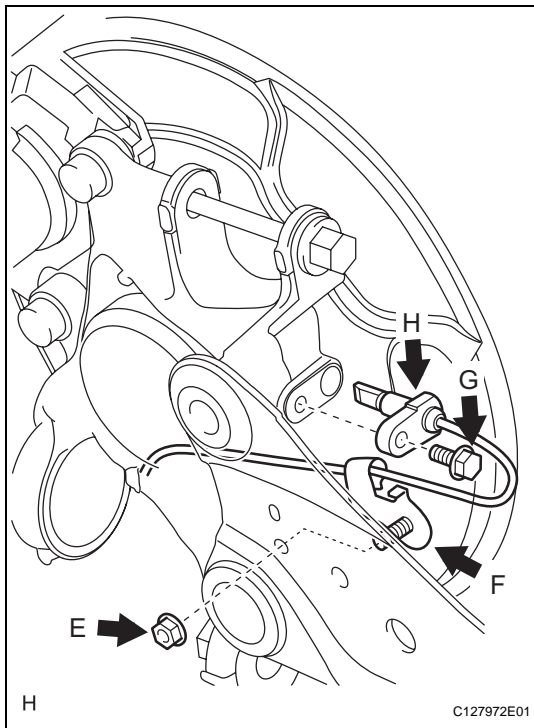

- (e) Remove the nut (labeled E) and sensor clamp (labeled F) from the trailing arm.
- (f) Remove the bolt (labeled G) and sensor body (labeled H) from the carrier.

**NOTICE:**

**Keep the sensor tip and sensor installation hole free from foreign matter.**