

INSTALLATION

(2005/11-2006/01)

HINT:

- Use the same procedures for the RH side and LH side.
- The procedures listed below are for the LH side.

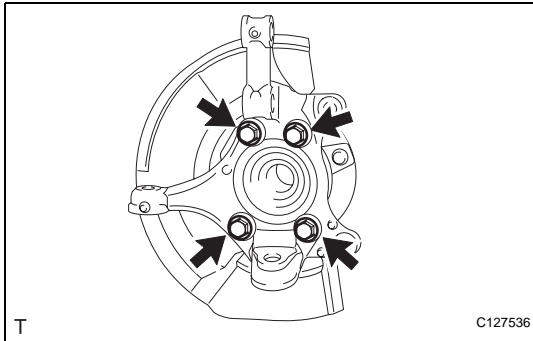

1. INSTALL FRONT AXLE HUB SUB-ASSEMBLY LH

- (a) Install the dust cover to the steering knuckle.
- (b) Install the axle hub with the 4 bolts.

Torque: 96 N*m (979 kgf*cm, 1 ft.*lbf)

NOTICE:

Do not place the hub and bearing's magnet rotor side so that it is facing downward, and do not allow the magnet rotor side to become damaged or contact foreign matter.

2. INSTALL FRONT LOWER BALL JOINT ASSEMBLY LH (See page [SP-28](#))

3. INSTALL STEERING KNUCKLE WITH AXLE HUB

- (a) Align the shaft splines and drive in the drive shaft.
- (b) Install the steering knuckle with axle hub with the 2 bolt and 2 nuts.

Torque: 240 N*m (2,447 kgf*cm, 177 ft.*lbf)

NOTICE:

Do not tighten the nuts.

4. CONNECT FRONT SUSPENSION NO. 1 LOWER ARM SUB-ASSEMBLY LH

- (a) Connect the lower arm to the ball joint with the 2 bolts and nut.

Torque: 92 N*m (938 kgf*cm, 68 ft.*lbf)

5. CONNECT TIE ROD END SUB-ASSEMBLY LH (See page [PS-45](#))

6. INSTALL FRONT SPEED SENSOR LH (See page [BC-193](#))

7. CHECK FRONT AXLE HUB BEARING

- (a) Check the axle hub bearing (see page [AH-6](#)).

8. INSTALL FRONT DISC (See page [BR-43](#))

9. INSTALL FRONT DISC BRAKE CYLINDER ASSEMBLY LH (See page [BR-46](#))

10. INSTALL FRONT AXLE HUB NUT

- (a) Install a new hub nut.

Torque: 216 N*m (2,203 kgf*cm, 159 ft.*lbf)

AH

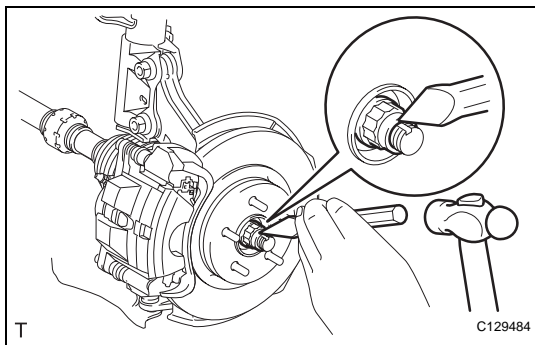

(b) Using a chisel and hammer, stake the hub nut.

11. INSTALL FRONT WHEEL

Torque: 103 N*m (1,050 kgf*cm, 6 ft.*lbf)

12. INSPECT AND ADJUST FRONT WHEEL ALIGNMENT

(a) Inspect and adjust the wheel alignment (see page [SP-3](#)).

13. CONNECT CABLE TO NEGATIVE BATTERY TERMINAL

14. CHECK SPEED SENSOR SIGNAL

(a) Check the speed sensor signal (see page [BC-44](#)).

INSTALLATION

(2006/01-)

HINT:

- Use the same procedures for the RH side and LH side.
- The procedures listed below are the LH side.

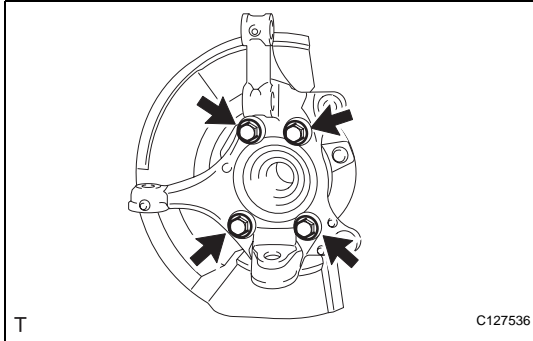

1. INSTALL FRONT AXLE HUB SUB-ASSEMBLY LH

- (a) Install the dust cover to the steering knuckle.
- (b) Install the axle hub with the 4 bolts.

Torque: 96 N*m (979 kgf*cm, 71 ft.*lbf)

NOTICE:

Do not place the hub and bearing's magnet rotor side so that it is facing downward, and do not allow the magnet rotor side to become damaged or contact foreign matter.

2. INSTALL FRONT LOWER BALL JOINT ASSEMBLY LH (See page [SP-28](#))

3. INSTALL STEERING KNUCKLE WITH AXLE HUB

- (a) Align the shaft splines and drive in the drive shaft.
- (b) Install the steering knuckle with axle hub with the 2 bolts and 2 nuts.

Torque: 240 N*m (2,447 kgf*cm, 177 ft.*lbf)

NOTICE:

Do not tighten the bolts.

4. CONNECT FRONT SUSPENSION NO. 1 LOWER ARM SUB-ASSEMBLY LH

- (a) Connect the lower arm to the ball joint with the bolt and 2 nuts.

Torque: 92 N*m (938 kgf*cm, 68 ft.*lbf)

5. CONNECT TIE ROD END SUB-ASSEMBLY LH (See page [PS-45](#))

6. INSTALL FRONT SPEED SENSOR LH (See page [BC-193](#))

7. CHECK FRONT AXLE HUB BEARING

- (a) Check the axle hub bearing (see page [AH-6](#)).

8. INSTALL FRONT DISC (See page [BR-43](#))

9. INSTALL FRONT DISC BRAKE CYLINDER ASSEMBLY LH (See page [BR-46](#))

10. INSTALL FRONT AXLE HUB LH NUT

- (a) Install a new hub nut.

Torque: 216 N*m (2,203 kgf*cm, 159 ft.*lbf) for ϕ 26 for 2AZ-FE

292 N*m (2,978 kgf*cm, 215 ft.*lbf) for ϕ 30 for 2GR-FE

AH

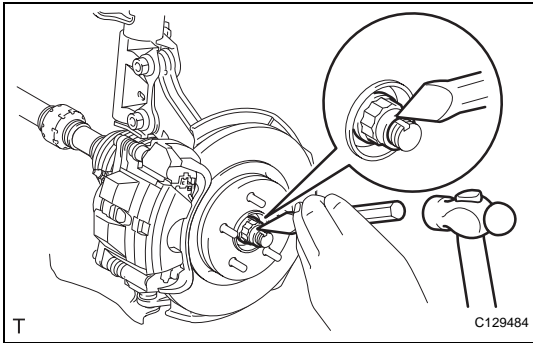

(b) Using a chisel and hammer, stake the hub nut.

11. ADD AUTOMATIC TRANSAXLE FLUID

- (a) Add the automatic transaxle for U140F (see page [AX-152](#)).
- (b) Add the automatic transaxle for U241E (see page [AX-151](#)).
- (c) Add the automatic transaxle for U151E (see page [AX-177](#)).
- (d) Add the automatic transaxle for U151F (see page [AX-178](#)).

12. CHECK FOR AUTOMATIC TRANSAXLE FLUID LEAKAGE

13. INSTALL FRONT WHEEL

Torque: 103 N*m (1,050 kgf*cm, 76 ft.*lbf)

14. INSPECT AND ADJUST FRONT WHEEL ALIGNMENT

- (a) Inspect and adjust the front wheel alignment (see page [SP-3](#)).

15. CONNECT CABLE TO NEGATIVE BATTERY TERMINAL

16. CHECK SPEED SENSOR SIGNAL

- (a) Check the speed sensor signal (see page [BC-44](#)).