

REMOVAL

(2006/01-)

HINT:

- Use the same procedures for the RH side and LH side.
- The procedures listed below are the LH side.

1. REMOVE FRONT WHEEL

2. DRAIN AUTOMATIC TRANSAXLE FLUID

- Drain the automatic transaxle fluid for U140F (see page [AX-147](#)).
- Drain the automatic transaxle fluid for U241E (see page [AX-146](#)).
- Drain the automatic transaxle fluid for U151E (see page [AX-172](#)).
- Drain the automatic transaxle fluid for U151F (see page [AX-173](#)).

3. DISCONNECT CABLE FROM NEGATIVE BATTERY TERMINAL

CAUTION:

Wait at least 90 seconds after disconnecting the cable from the negative (-) battery terminal to prevent airbag and seat belt pretensioner activation.

4. REMOVE FRONT AXLE HUB LH NUT

- Using SST and a hammer, unstake the staked part of the nut.

SST 09930-00010

NOTICE:

Loosen the staked part of the nut completely, otherwise the screw of the drive shaft may be damaged.

- While applying the brakes, remove the lock axle hub nut.

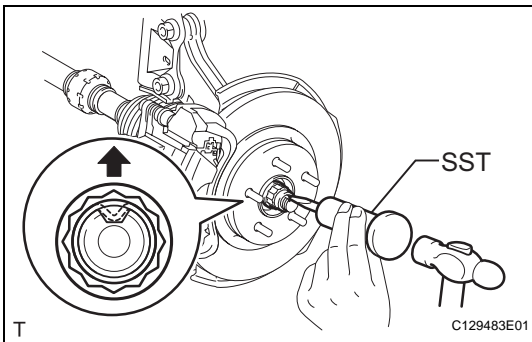

5. REMOVE FRONT SPEED SENSOR LH (See page [BC-191](#))

6. REMOVE FRONT DISC BRAKE CYLINDER ASSEMBLY LH (See page [BR-40](#))

7. REMOVE FRONT DISC (See page [BR-42](#))

8. DISCONNECT TIE ROD END SUB-ASSEMBLY LH (See page [PS-42](#))

9. DISCONNECT FRONT SUSPENSION NO. 1 LOWER ARM SUB-ASSEMBLY LH

- Remove the bolt and 2 nuts.
- Disconnect the lower arm from the ball joint.

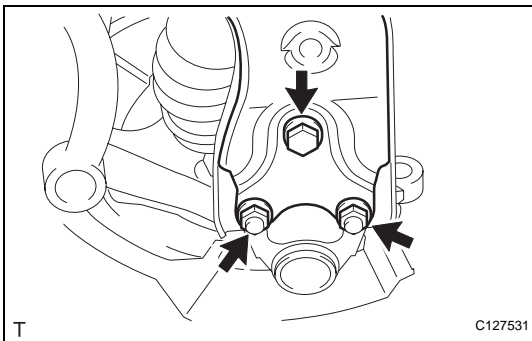

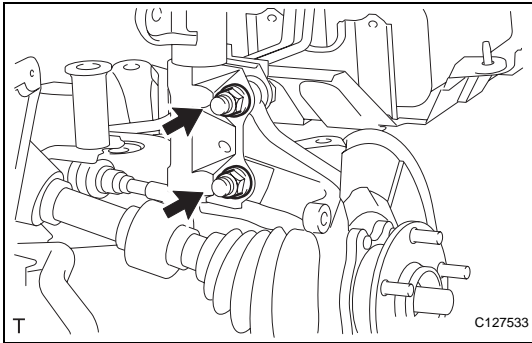

10. REMOVE STEERING KNUCKLE WITH AXLE HUB

- (a) Remove the 2 bolts and 2 nuts, and disconnect the shock absorber from the steering knuckle.

HINT:

While fixing the nuts in place, loosen and remove the bolts.

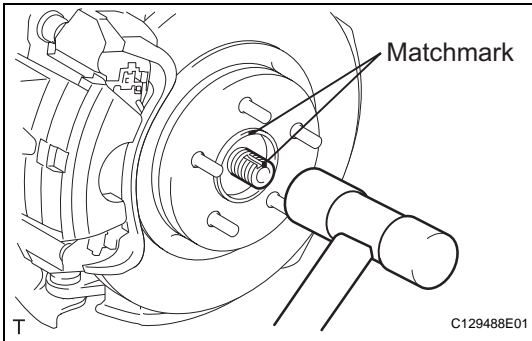

- (b) Put matchmarks on the drive shaft and axle hub.
- (c) Using a plastic-faced hammer, remove the steering knuckle with axle hub.

NOTICE:

Be careful not to damage the boot and speed sensor rotor. Do not excessively push out the drive shaft from the axle assembly.

11. REMOVE FRONT LOWER BALL JOINT ASSEMBLY LH (See page [SP-27](#))

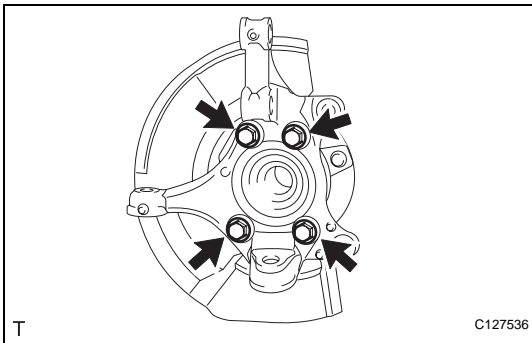

12. REMOVE FRONT AXLE HUB SUB-ASSEMBLY LH

- (a) Remove the 4 bolts and axle hub from the steering knuckle.

NOTICE:

Do not place the hub and bearing's magnet rotor side so that it is facing downward, and do not allow the magnet rotor side to become damaged or contact foreign matter.

- (b) Remove the dust cover from the steering knuckle.