

AMBIENT TEMPERATURE SENSOR (for Automatic Air Conditioning System)

COMPONENTS

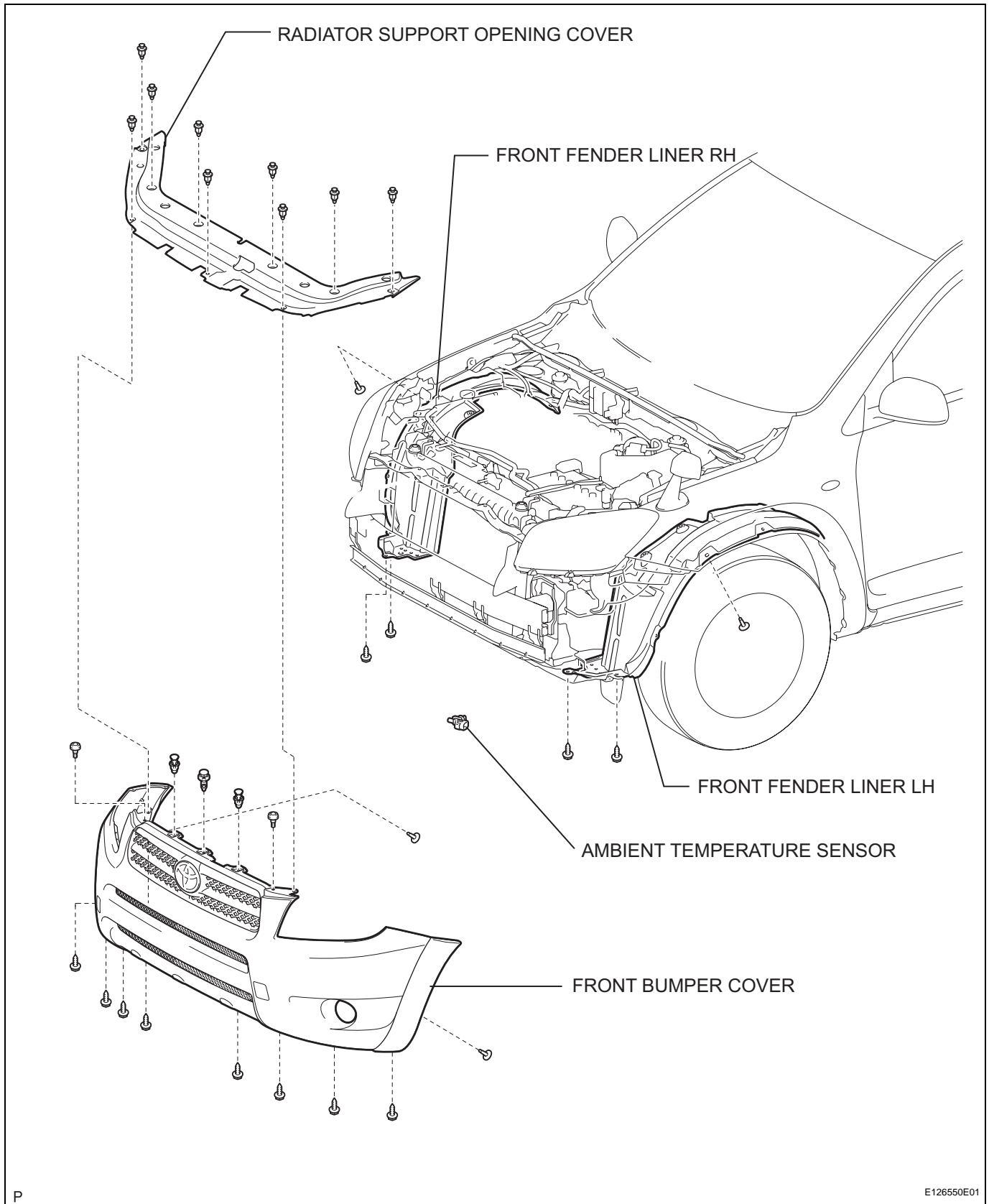

AC

REMOVAL

1. DISCONNECT CABLE FROM NEGATIVE BATTERY TERMINAL

CAUTION:

Wait at least 90 seconds after disconnecting the cable from the negative (-) battery terminal to prevent airbag and seat belt pretensioner activation.

2. REMOVE FRONT BUMPER COVER

(a) Remove the front bumper cover (see page ET-4).

3. REMOVE AMBIENT TEMPERATURE SENSOR

(a) Using a screwdriver, pull out the sensor, then disconnect the connector.

HINT:

Tape the screwdriver tip before use.

INSPECTION

1. INSPECT AMBIENT TEMPERATURE SENSOR

(a) Measure the resistance of the sensor.

Standard resistance

Tester Connection	Condition	Specified Condition
1 - 2	10°C (50°F)	3.00 to 3.73 kΩ
1 - 2	15°C (59°F)	2.45 to 2.88 kΩ
1 - 2	20°C (68°F)	1.95 to 2.30 kΩ
1 - 2	25°C (77°F)	1.60 to 1.80 kΩ
1 - 2	30°C (86°F)	1.28 to 1.47 kΩ
1 - 2	35°C (95°F)	1.00 to 1.22 kΩ
1 - 2	40°C (104°F)	0.80 to 1.00 kΩ
1 - 2	45°C (113°F)	0.65 to 0.85 kΩ
1 - 2	50°C (122°F)	0.50 to 0.70 kΩ
1 - 2	55°C (131°F)	0.44 to 0.60 kΩ
1 - 2	60°C (140°F)	0.36 to 0.50 kΩ

NOTICE:

- Touching the sensor even slightly may change the resistance value. Hold the connector of the sensor.
- When measuring the resistance, the sensor temperature must be the same as the ambient temperature.

HINT:

As the temperature increases, the resistance decreases (see the graph).

If the result is not as specified, replace the ambient temperature sensor.

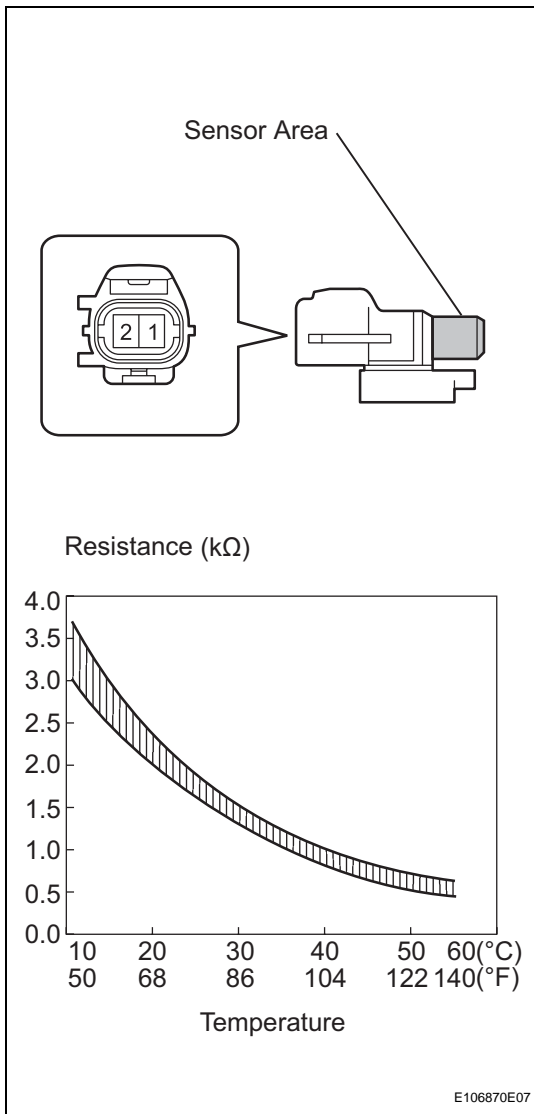

AC