

AIR INLET CONTROL SERVO MOTOR

COMPONENTS

AIR INLET CONTROL SERVO MOTOR
(for Automatic Air Conditioning System)

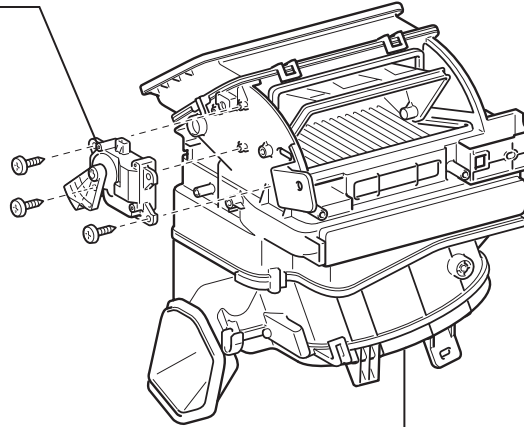

BLOWER ASSEMBLY

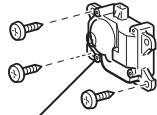

AIR INLET CONTROL SERVO MOTOR
(for Manual Air Conditioning System)

AC

REMOVAL

1. REMOVE BLOWER ASSEMBLY

- Remove the blower (see page [AC-203](#)).

2. REMOVE AIR INLET CONTROL SERVO MOTOR (See page [AC-210](#))

INSPECTION

1. INSPECT AIR INLET CONTROL SERVO MOTOR (for Automatic Air Conditioning System)

- Inspect the servo motor operation.

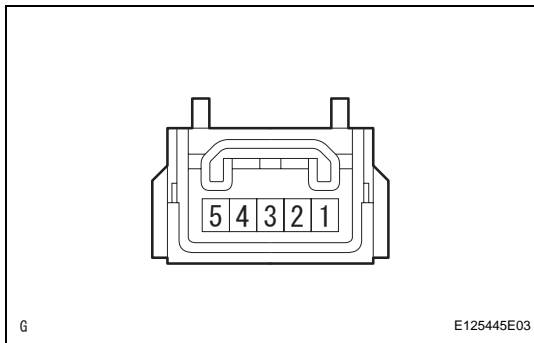
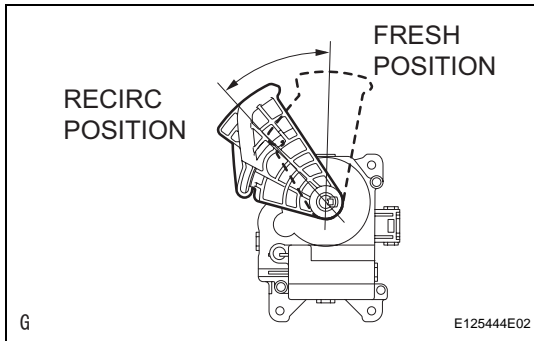

- Connect the positive (+) lead from the battery to terminal 4 and negative (-) lead to terminal 5, and then check that the arm turns to the "FRESH" side smoothly.
- Connect the positive (+) lead from the battery to terminal 5 and negative (-) lead to terminal 4, and then check that the arm turns to the "RECIRCULATION" side smoothly. If the operation is not as specified, replace the air inlet control servo motor.

2. INSPECT AIR INLET CONTROL SERVO MOTOR (for Manual Air Conditioning System)

- Inspect the servo motor operation.

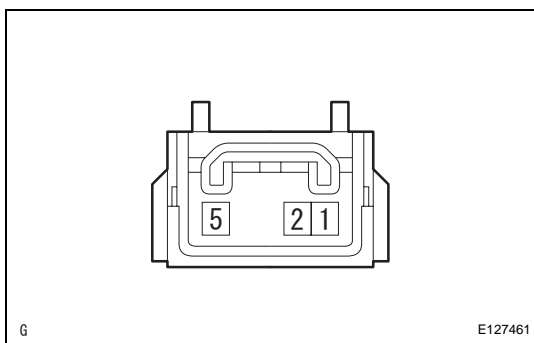
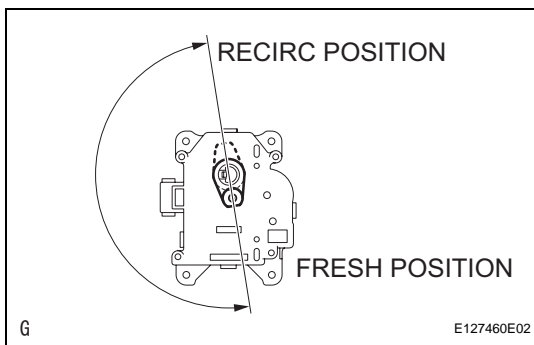

- Connect the positive (+) lead from the battery to terminal 5 and negative (-) lead to terminal 1, and then check that the arm turns to the "FRESH" side smoothly.
- Connect the positive (+) lead from the battery to terminal 1 and negative (-) lead to terminal 5, and then check that the arm turns to the "RECIRCULATION" side smoothly. If the operation is not as specified, replace the air inlet servo motor.