

## INSTALLATION

### 1. INSTALL FRONT EXHAUST PIPE ASSEMBLY

- (a) Install a new gasket.
- (b) Install the front exhaust pipe with the 2 nuts.

**Torque: 62 N\*m (632 kgf\*cm, 46 ft.\*lbf)**

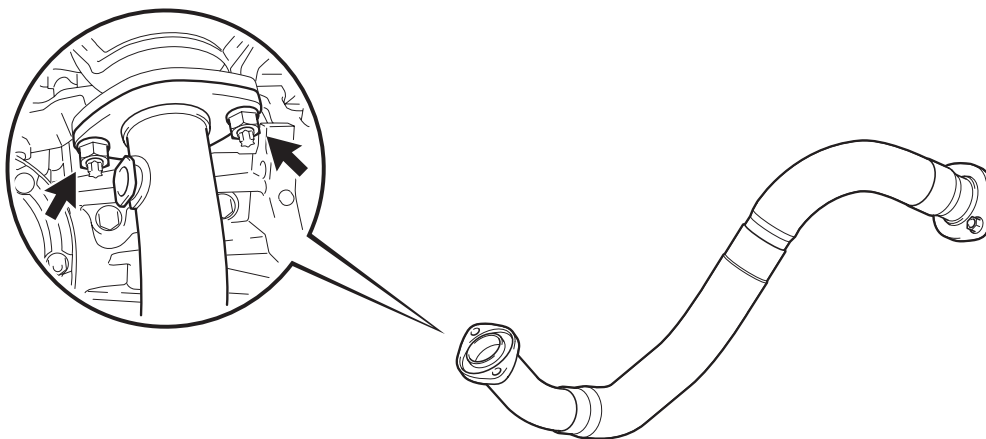

P

A132401

**EX**

### 2. INSTALL NO. 1 FRONT EXHAUST PIPE SUPPORT BRACKET

- (a) Install the No. 1 front exhaust pipe support bracket with the 2 bolts.

**Torque: 21 N\*m (214 kgf\*cm, 16 ft.\*lbf)**

### 3. INSTALL CENTER EXHAUST PIPE ASSEMBLY

- (a) Install 2 new gaskets.
- (b) Connect the 3 exhaust pipe supports, and install the center exhaust pipe.
- (c) Install the 2 bolts and 2 nuts.

**Torque: 43 N\*m (440 kgf\*cm, 32 ft.\*lbf)**

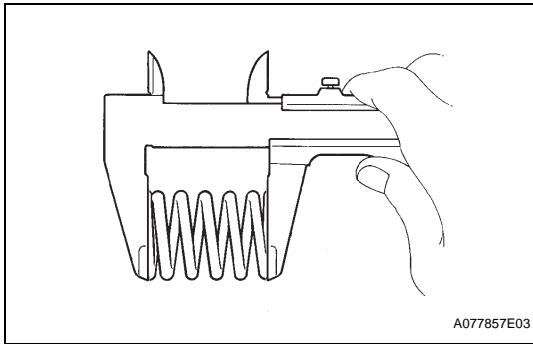
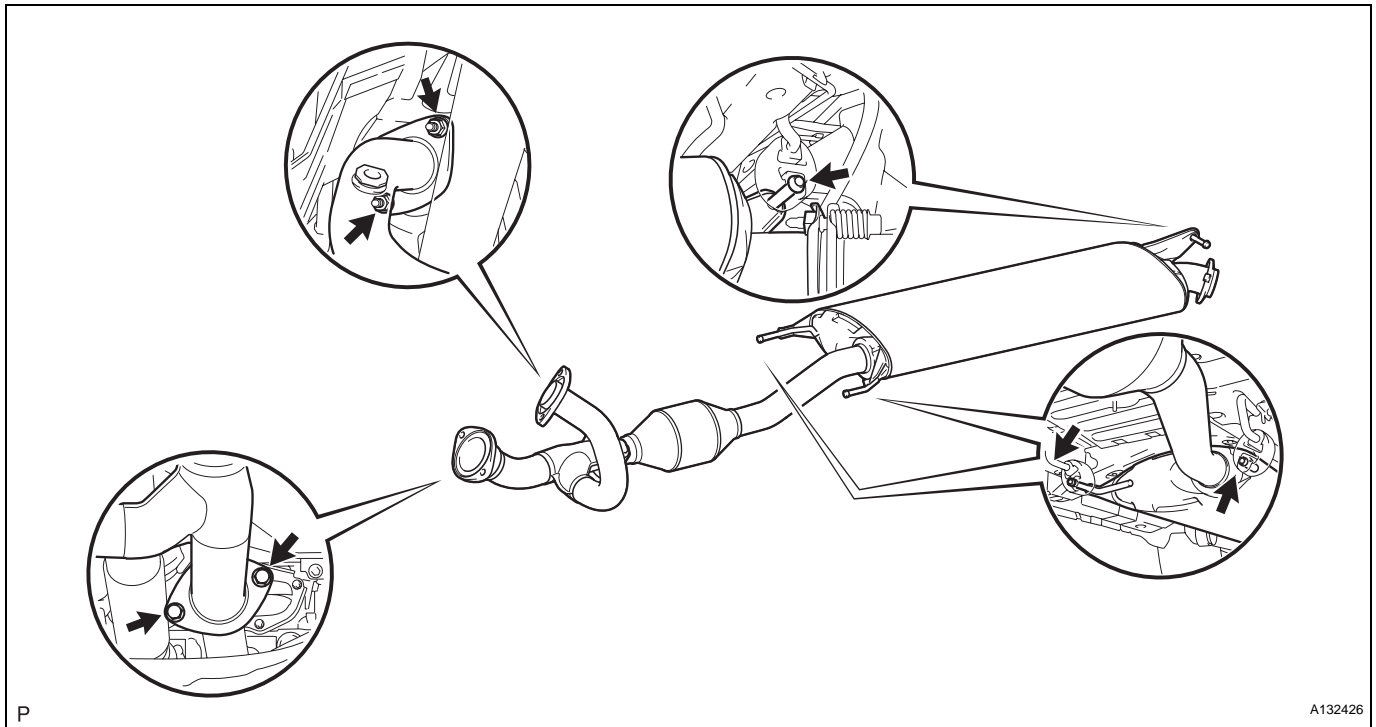

#### 4. INSTALL TAILPIPE ASSEMBLY

- (a) Using a vernier caliper, measure the free length of the compression spring.

**Minimum length:**

**38.5 mm (1.516 in.)**

If the length is less than the minimum, replace the compression spring.

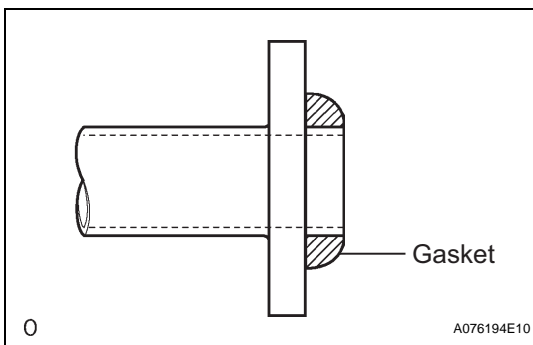

- (b) Install a new gasket by hand so that its surface is flush with the center exhaust pipe.

**NOTICE:**

- Tap in the gasket in the correct direction.
- Do not reuse the removed gasket.
- Do not push in the gasket while installing the tailpipe.

- (c) Connect the 2 exhaust pipe supports, and install the tailpipe.

- (d) Install the 2 compression springs and 2 bolts.

**Torque: 43 N\*m (440 kgf\*cm, 32 ft.\*lbf)**

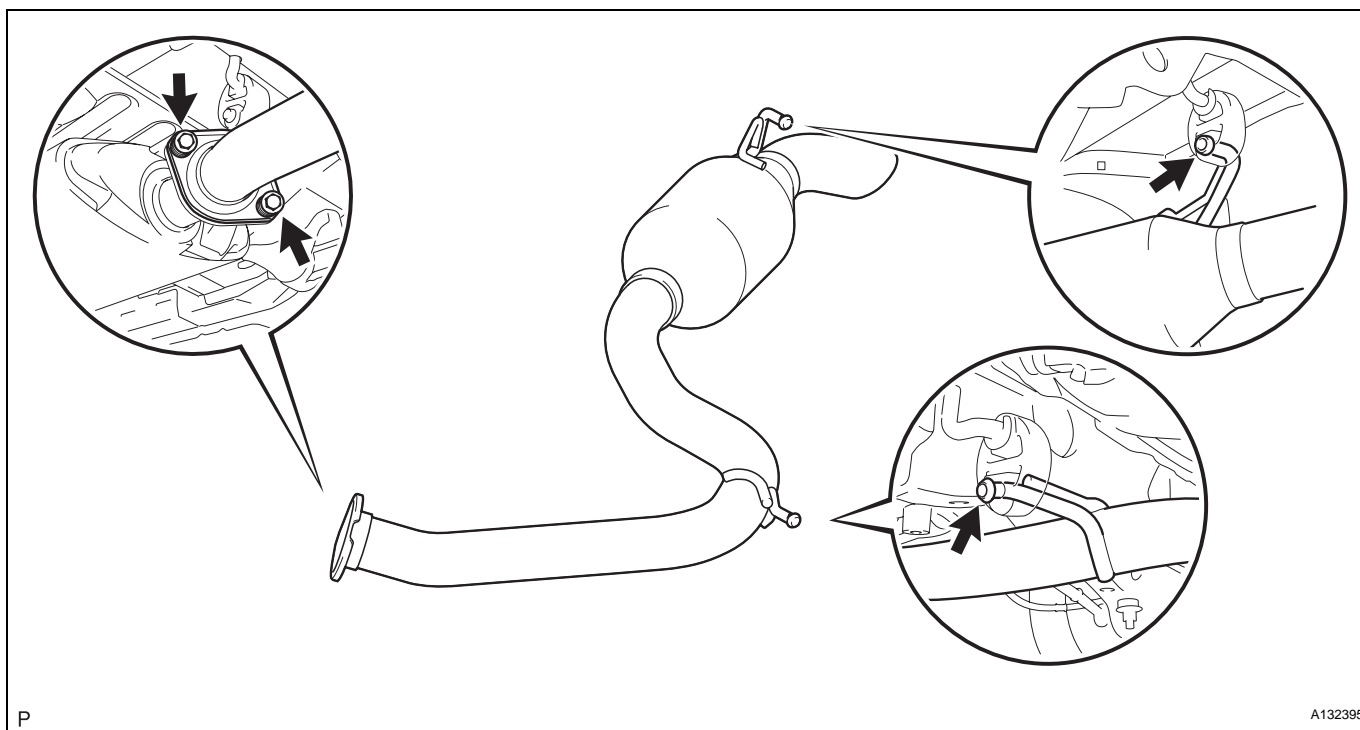

5. **INSTALL HEATED OXYGEN SENSOR (for Sensor 2)**  
(See page [EC-27](#))
6. **CONNECT CABLE TO NEGATIVE BATTERY TERMINAL**
7. **CHECK FOR EXHAUST GAS LEAKS**  
If gas is leaking, tighten the problem areas to stop the leak. Replace damaged parts as necessary.