

# ACCELERATOR PEDAL ROD

## COMPONENTS

ES

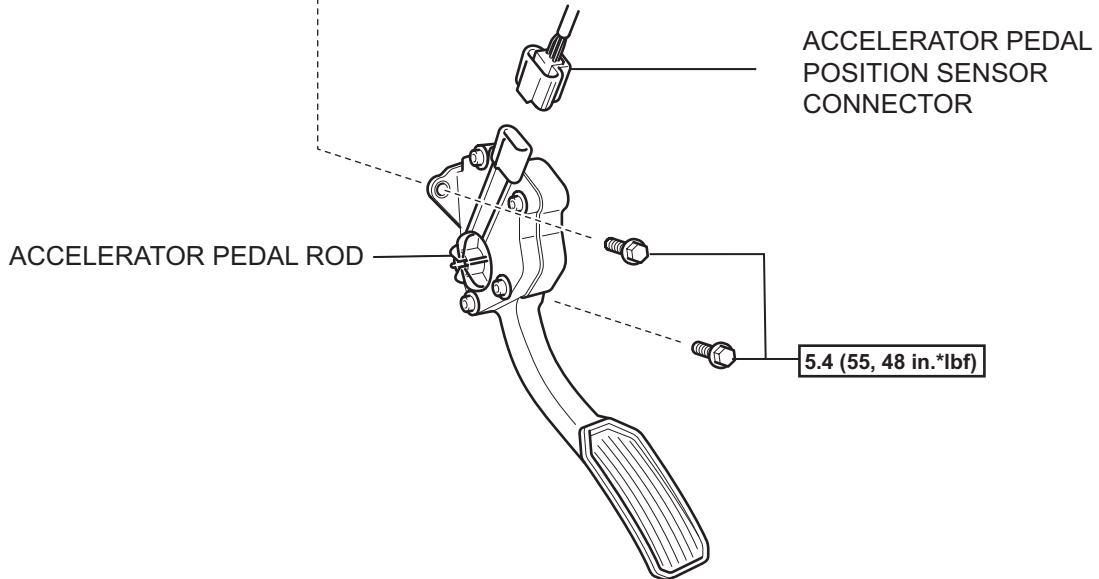
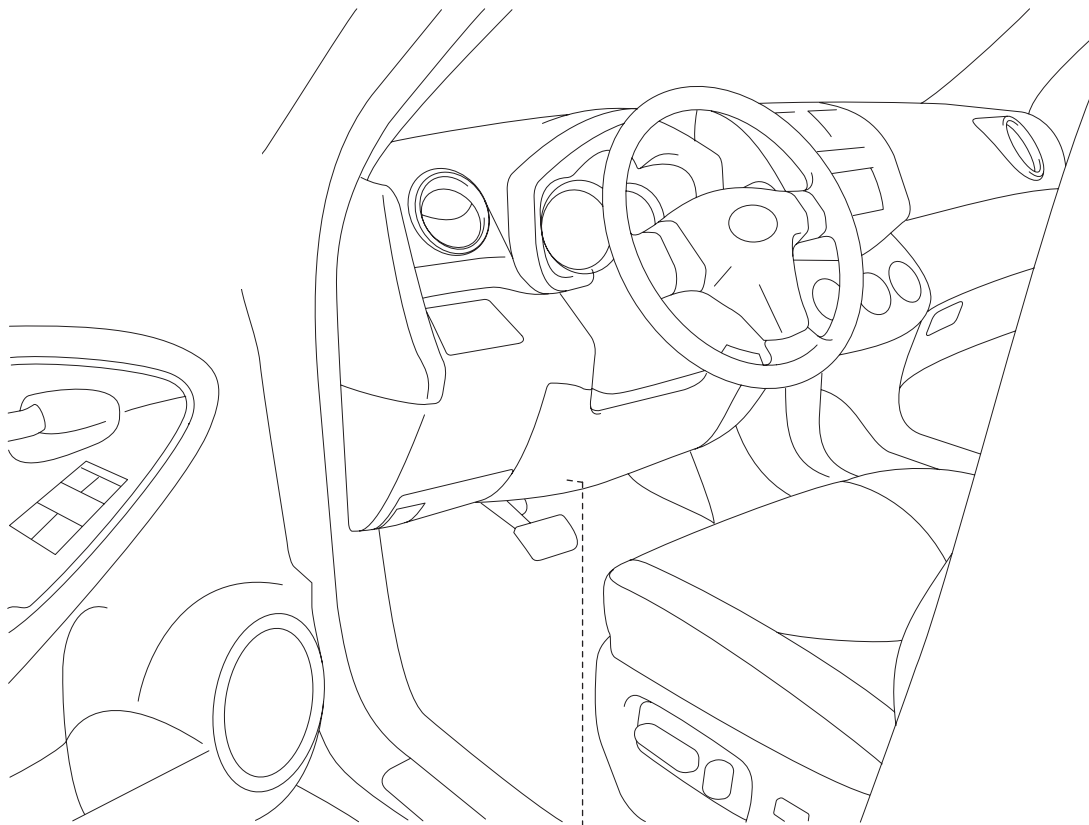

**N\*m (kgf\*cm, ft.\*lbf)** : Specified torque

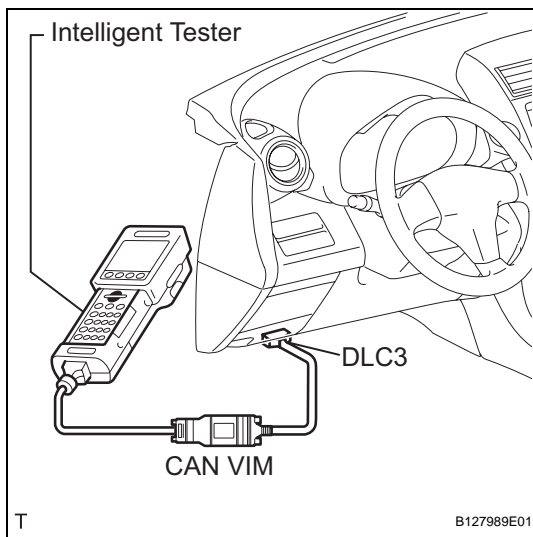

## ON-VEHICLE INSPECTION

### 1. CHECK ACCELERATOR PEDAL ROD

- (a) Check the voltage.
  - (1) Connect the intelligent tester to the DLC3.
  - (2) Turn the ignition switch ON.
  - (3) Turn the intelligent tester ON.
  - (4) Select the menu items: DIAGNOSIS / ENHANCED OBD II / DATA LIST / ALL / ACCEL POS #1, ACCEL POS #2.
  - (5) Operate the accelerator pedal, and then check that the ACCEL POS #1 and ACCEL POS #2 values are within the specifications.

#### Standard voltage:

##### ACCEL POS #1

Accelerator Pedal Condition	Specified Condition
Released	0.5 to 1.1 V
Depressed	2.5 to 4.5 V

##### ACCEL POS #2

Accelerator Pedal Condition	Specified Condition
Released	1.2 to 2.0 V
Depressed	3.4 to 5.0 V

If the result is not as specified, check the accelerator pedal rod, wire harness or ECM.